

INDEX OF SHEETS

- S1. General Plan and Elevation
- S2. General Notes, Bill of Materials, Index of Sheets, and Details

GENERAL NOTES

1. Plan dimensions and details relative to existing plans are subject to nominal construction variations. The Contractor shall field verify existing dimensions and details affecting new construction and make necessary approved adjustments prior to construction or ordering of materials. Such variations shall not be cause for additional compensation for a change in scope of the work, however, the Contractor will be paid for the quantity actually furnished at the unit price bid for the work.
2. Staged construction shall be utilized to maintain traffic during construction. See Civil Drawings.
3. The Contractor shall exercise care during removal of existing joints to ensure that the slab, beams and diaphragms' integrity will not be detrimentally impacted. The Contractor shall repair any damage(s) to the slab, beams or diaphragms caused by his operation as directed by the Engineer at no additional cost to the Department.
4. Joint openings shall be adjusted according to Article 520.04 of the Std. Specs. when the deck is poured at an ambient temperature other than 50° F.
5. Cost for removal and disposal of existing expansion joints is included in the cost of Silicone Joint Sealer 1 3/4" or Silicone Joint Sealer 2", based on the proposed repairs at the joint.
6. The Contractor must take extra care to achieve proper bondage at the ends of the joint repair to the existing joint assembly.
7. Existing reinforcement bars extending into the concrete removal area shall be cleaned, straightened, and incorporated into the new construction. Any reinforcement bars damaged during concrete removal shall be replaced with an approved bar splicer or anchorage system. Cost included with Concrete Removal.

BILL OF MATERIAL

| ITEM DESCRIPTION | UNIT | QUANTITY |
|-------------------------------|---------|----------|
| Concrete Removal | Cu. Yd. | 0.3 |
| Silicone Joint Sealer, 1 3/4" | Foot | 164.0 |
| Silicone Joint Sealer, 2" | Foot | 78.0 |
| Polymer Concrete | Cu. Ft. | 12.5 |

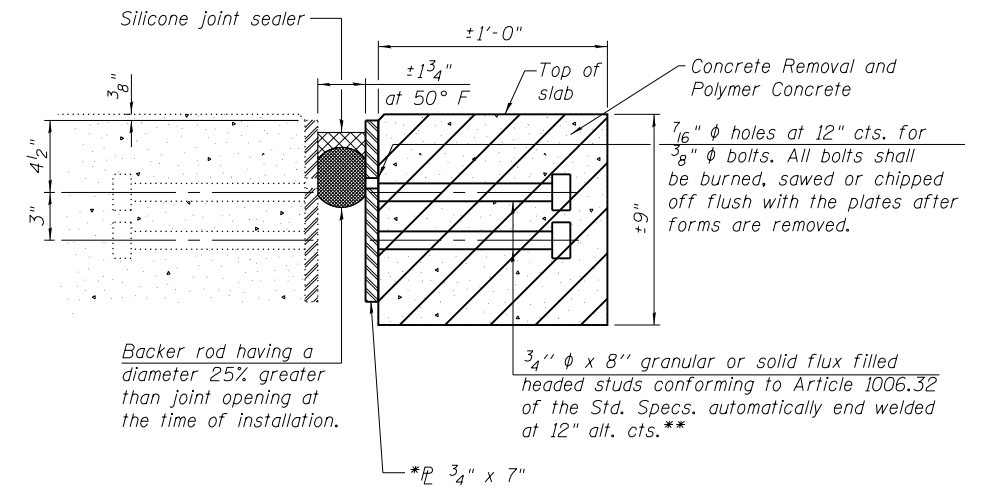

SECTION THROUGH PROPOSED PJS JOINT REPLACEMENT DETAIL 3

- * Maximum space between installed segments shall be 3/16". Seal space with Silicone Sealant suitable for Structural Steel. Cost included in pay item for Silicone Joint Sealer, 1 3/4"
- ** Cost included in pay item for Silicone Joint Sealer, 1 3/4"

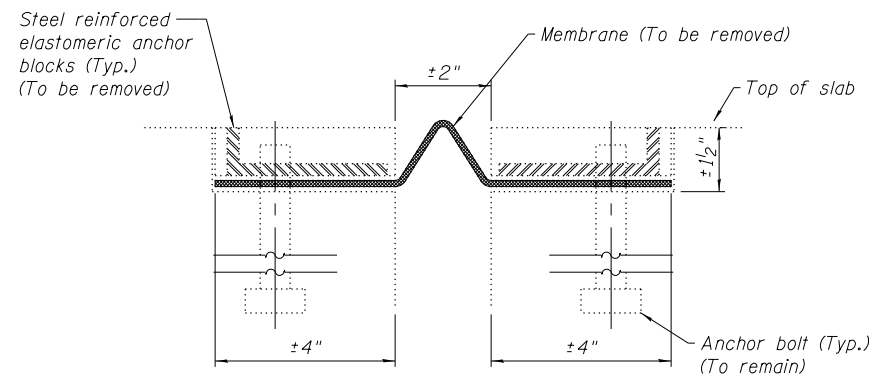

SECTION THROUGH EXISTING NEOPRENE JOINT DETAIL 1

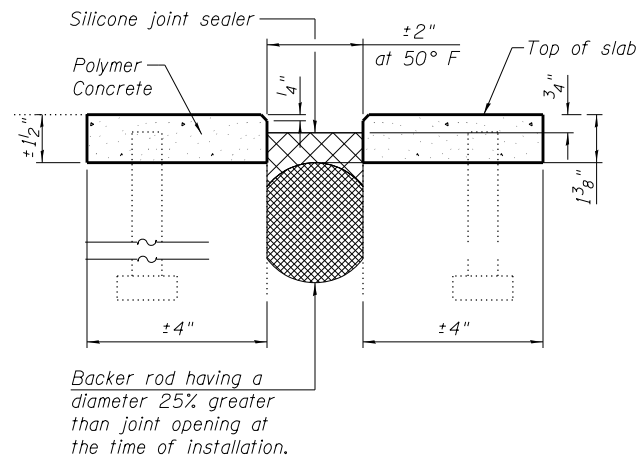

SECTION THROUGH PROPOSED SILICONE JOINT SEALER

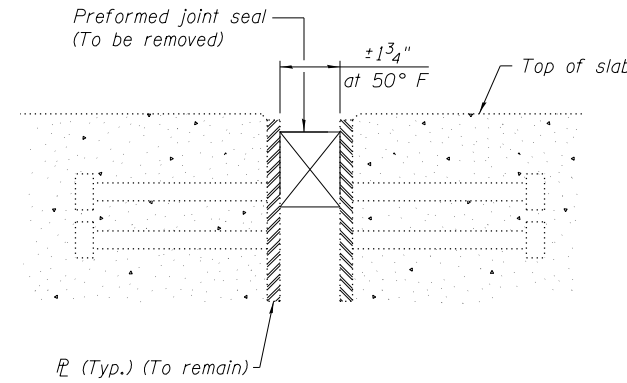

SECTION THROUGH EXISTING PJS JOINT DETAIL 2

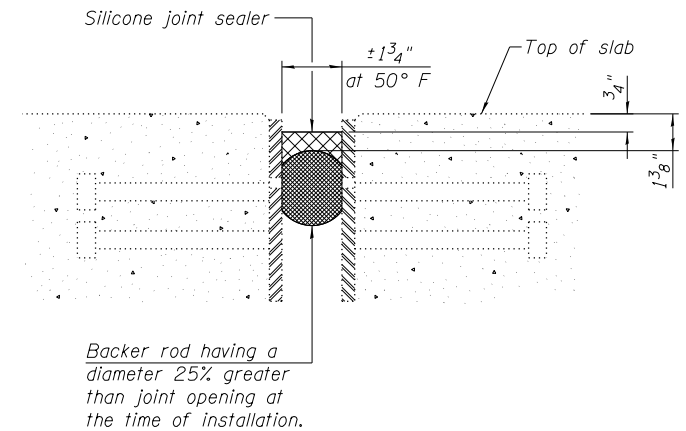

SECTION THROUGH PROPOSED SILICONE JOINT SEALER

| | | |
|----------------------|----------------|-----------|
| USER NAME = | DESIGNED - AMS | REVISED - |
| DRAWN - AMS | REVISED - | |
| CHECKED - JMH | REVISED - | |
| DATE - DECEMBER 2012 | REVISED - | |

| | | | | |
|---------------------------|--------------------|-------------|--------------------|--------------|
| F.A.I. RTÉ. 90/94 | SECTION 2012-055BR | COUNTY COOK | TOTAL SHEETS 107 | SHEET NO. 99 |
| ILLINOIS FED. AID PROJECT | | | CONTRACT NO. 60V58 | |