

FINAL SURVEY	NO.	DATE
CHECKED	BY	
NOTED	DATE	
AREAS CHECKED	DATE	

ORIGINAL SURVEY	NO.	DATE
CHECKED	BY	
NOTED	DATE	
AREAS CHECKED	DATE	

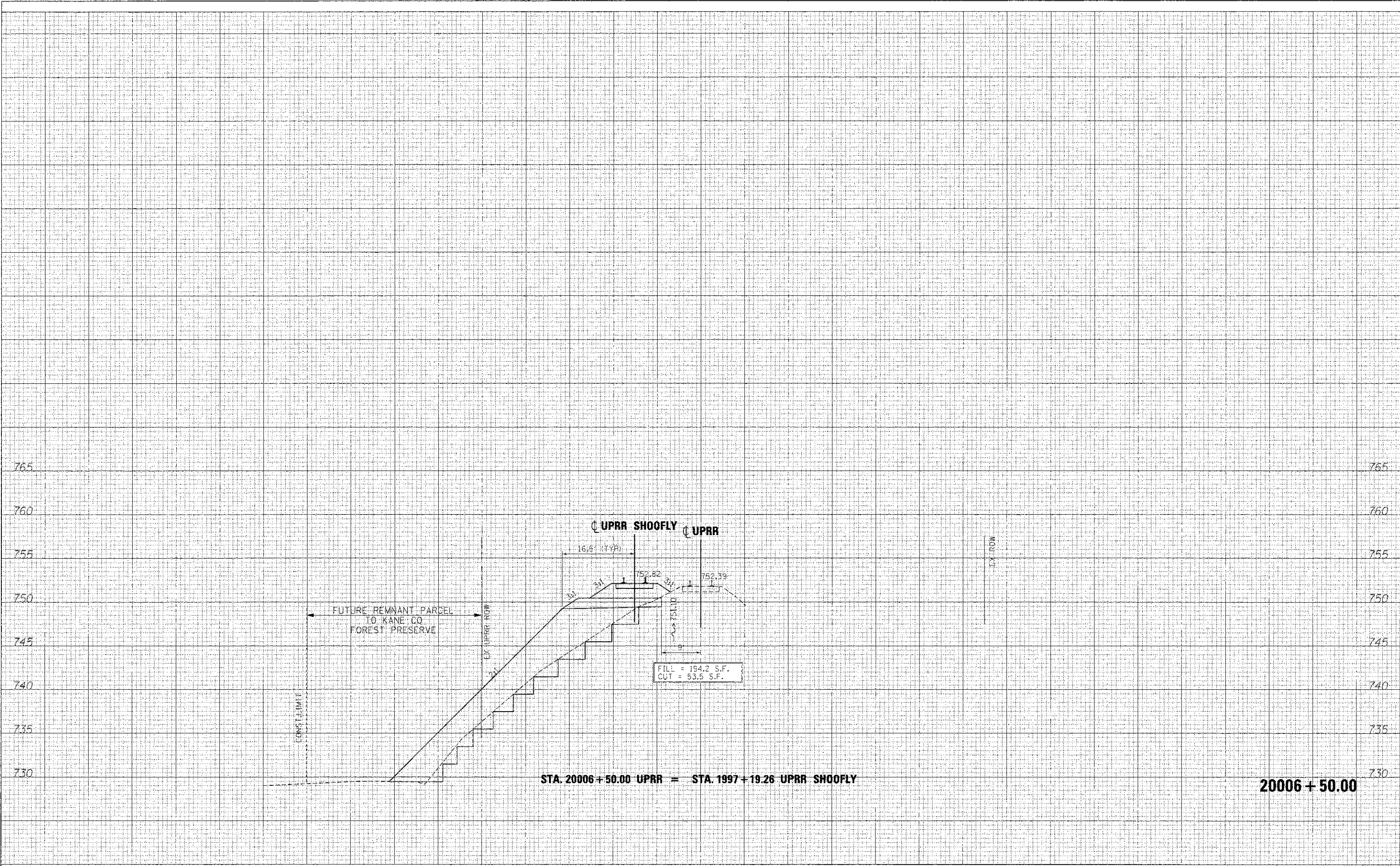

STA. 20006+50.00 UPRR = STA. 1997+19.26 UPRR SHOOFLY

20006 + 50.00

FILE NAME =	DESIGNED - AFS	REVISED - ADDENDUM A 04/15/2013
...\\dib3396-30UPRR-STG-xsec.dgn	DRAWN - TMB	REVISED -
USER NAME = toedblank	CHECKED - JMM	REVISED -
PLOT DATE = 4/15/2013	DATE - 01/18/2013	REVISED -



STATE OF ILLINOIS  
DIVISION OF TRANSPORTATION

CROSS SECTIONS  
UPRR SHOOFLY

SCALE: H 1"=10', V 1"=5' SHEET NO. 6 OF 20 SHEETS STA. 20006+50.00 TO STA. 20506+50.00

F.A.P. R.T.E.	SECTION	COUNTY	TOTAL SHEETS
361	05-00214-18-RP	KANE	451 408
			CONTRACT NO. 63598

ILLINOIS FED. AID PROJECT