

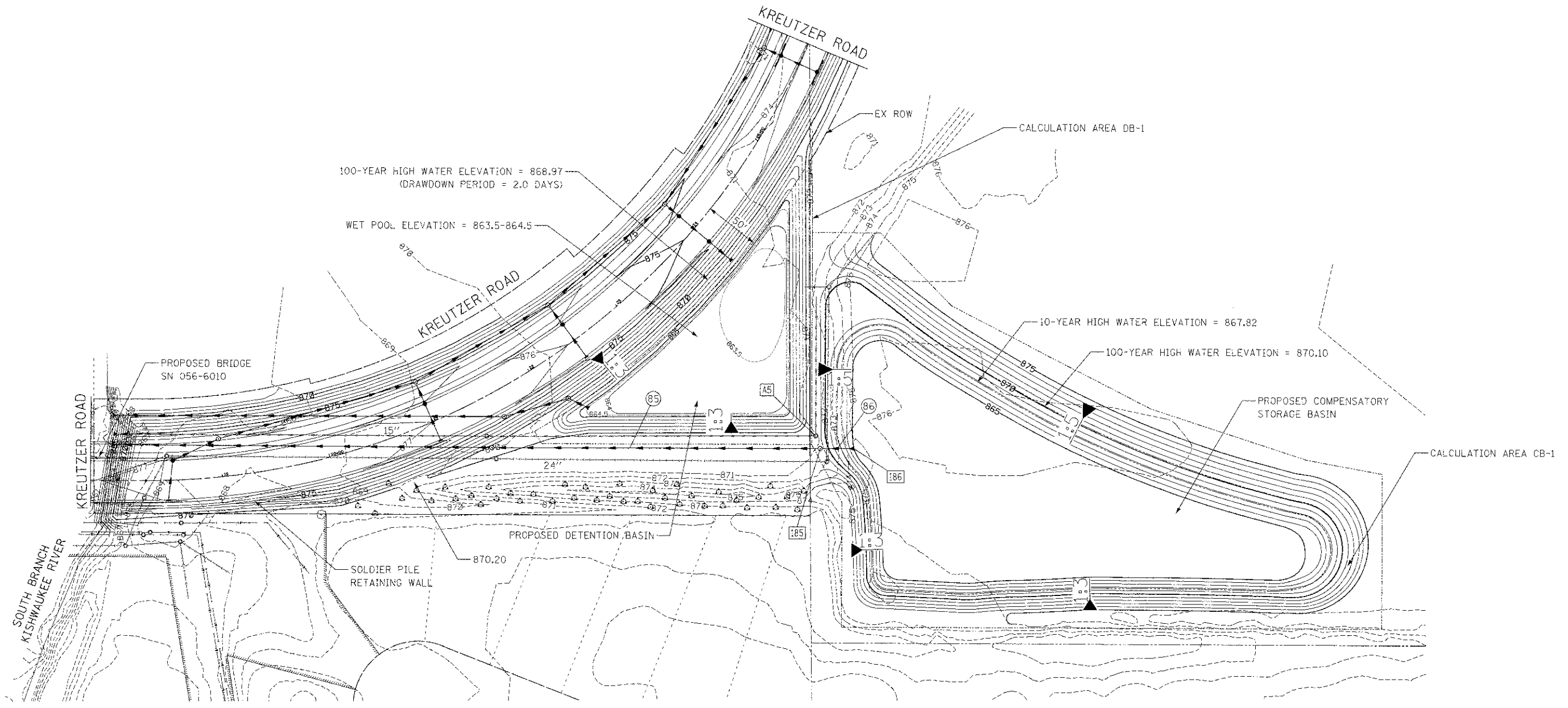

- 185 STA. 23+41, 222.0' RT
MAN TA 4 DIA TIF CL
RJM = 871.00
INV = 864.95 (N)
INV = 864.95 (S)
- 186 STA. 23+63, 236.0' RT
PRC FLAR END SEC 24
GRATING-C FL END S 24
INV = 865.00
- A5 STA. 23+45, 211.1' RT
EX MANHOLE
INV = 865.10 EX (N)
INV = 865.20 EX (E)
- 85 296' - STORM SEW CL A 2, 24" @ 0.19%
TBF = 0.0 CU YD
- 86 24' - STORM SEW CL A 2, 24" @ 0.21%
TBF = 0.0 CU YD



LEGEND

EXISTING INDEX CONTOUR	---875---
EXISTING INTERMEDIATE CONTOUR	-----
PROPOSED INDEX CONTOUR	---865---
PROPOSED INTERMEDIATE CONTOUR	-----

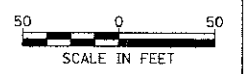

FILE NAME =
...2473.sht-details-01-basin.dgn

USER NAME = bas
PLOT SCALE = 50.0000' / 1" / 11"
PLOT DATE = 10/18/2012

DESIGNED - BAS
DRAWN - BAS
CHECKED - GAB
DATE - 10/22/12

REVISED -
REVISED -
REVISED -
REVISED -

**STATE OF ILLINOIS
DEPARTMENT OF TRANSPORTATION**

SOUTH COMPENSATORY AND DETENTION STORAGE DETAIL

SCALE: 1" = 50' SHEET NO. 1 OF 1 SHEETS STA. TO STA.

F.A.U. RTE.	SECTION	COUNTY	TOTAL SHEET SHEETS, NO.
4068	07-0031-00-PV	MCHEMRY	167 113
FED. ROAD DIST. NO. 1 ILLINOIS			CONTRACT NO. 63743
FED. AID PROJECT XXX-----			