

FINAL SURVEY	DATE
SURVEYED	BY
PLOTTED	
NOTE BOOK	
AREAS CHECKED	
NO.	

ORIGINAL SURVEY	DATE
PLOTTED	BY
NOTE BOOK	
AREAS CHECKED	
NO.	

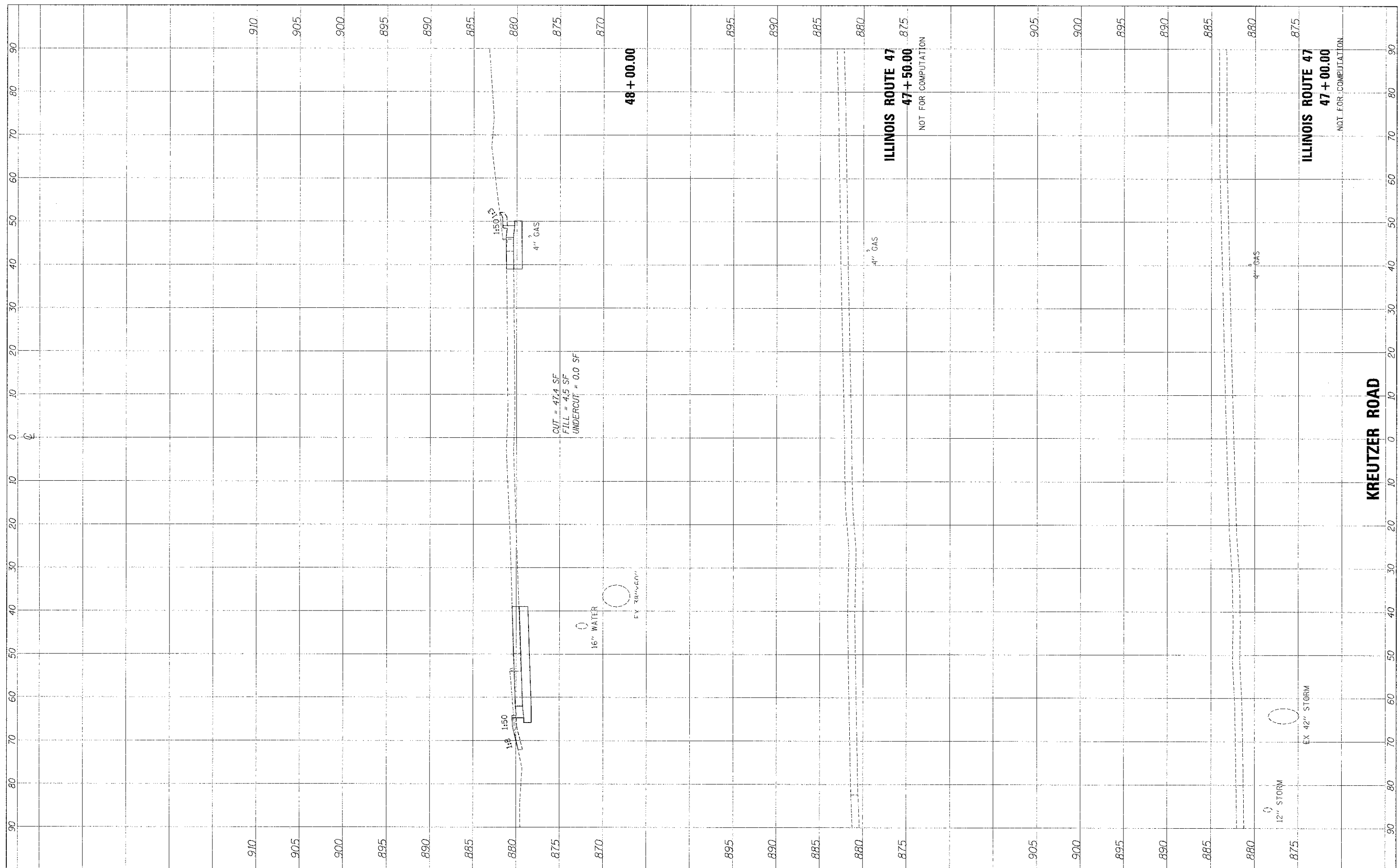

FILE NAME = ... \2473\sh\krc\kreutzer.dgn

USER NAME = gae  
 DESIGNED - BAS  
 DRAWN - BAS  
 CHECKED - GAB  
 DATE - 10/22/12

REVISED -  
 REVISED -  
 REVISED -  
 REVISED -

**STATE OF ILLINOIS  
 DEPARTMENT OF TRANSPORTATION**

**CROSS SECTIONS**

SCALE: 10' H : 5' V SHEET NO. 22 OF 24 SHEETS STA. 47+00.00 TO STA. 48+00.00

F.A.U. RTE. 4068	SECTION 07-0031-00-PV	COUNTY McHENRY	TOTAL SHEETS 167	SHEET NO. 159
FED. ROAD DIST. NO. 1 ILLINOIS			CONTRACT NO. 63743	
FED. AID PROJECT XXX				