

PROP. CURVE MAPLE-CL-1
 PI STA. = 127+43.77
 Δ = 8° 31' 44" (RT)
 D = 5° 43' 48"
 R = 999.94'
 T = 74.56'
 L = 148.85'
 E = 2.78'
 e = NC
 T.R. = NA
 S.E. RUN = NA
 P.C. STA = 126+69.21
 P.T. STA = 128+18.06

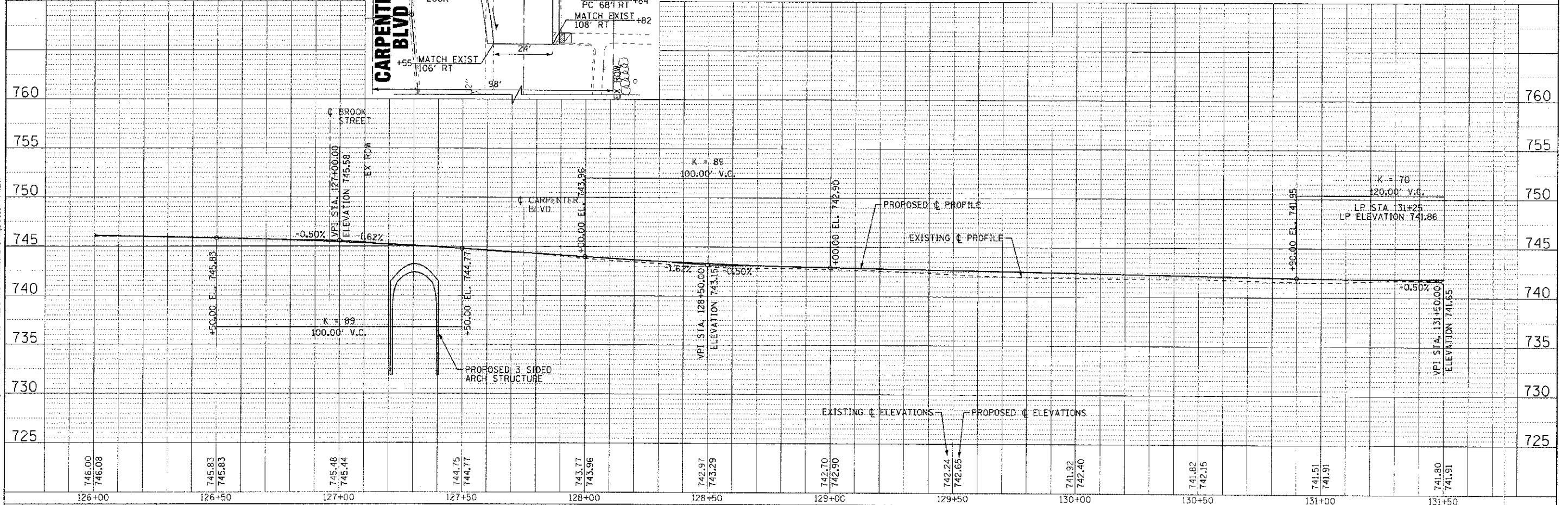
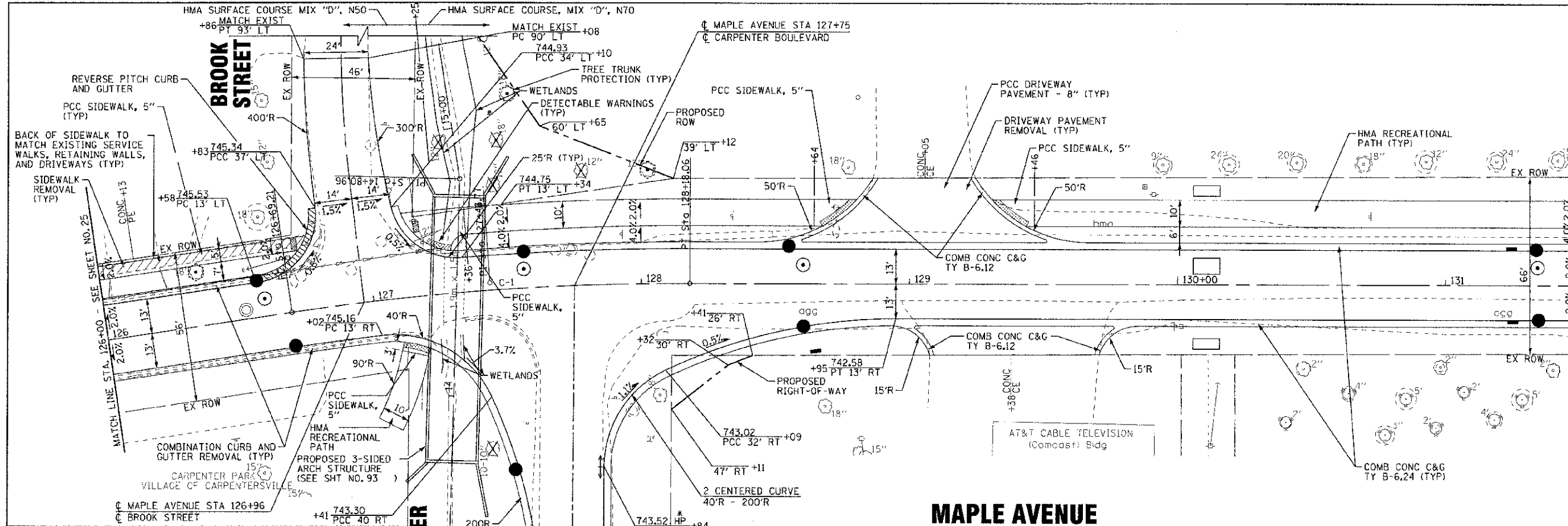

DESIGNED - DJS
 DRAWN - UKB
 CHECKED - RWL
 DATE - 06/20/12

REVISED - PER IDOT 10/13/12
 REVISED -
 REVISED -
 FILE - 110994-PP4.sh

STATE OF ILLINOIS
 DEPARTMENT OF TRANSPORTATION

GEOMETRIC PLAN AND PROFILE
 MAPLE AVENUE

F.A. RTE.	SECTION	COUNTY	TOTAL SHEETS	SHEET NO.
4006	95-00049-00-PV	KANE	139	26
FED. ROAD DIST. NO. 1 ILLINOIS; FED. AID PROJECT W-8003 (096)			CONTRACT NO. 63745	

SCALE: H: 1"=20' V: 1"=5'
 STA. 126+00 TO STA. 131+50

Copyright © 2012 by BAKER & BOGDANS, INC.
 STATE OF ILLINOIS - PROFESSIONAL DESIGN FIRM
 LICENSE NO. 046-03081 - EXPIRES 12/31/2013
 225 S. ZION
 CHICAGO, IL 60604
 www.bakerandbogdans.com