

DATE	
BY	
REVISIONS	
NO.	
DATE	
BY	
REVISIONS	
NO.	
DATE	
BY	
REVISIONS	
NO.	

DATE	
BY	
REVISIONS	
NO.	
DATE	
BY	
REVISIONS	
NO.	
DATE	
BY	
REVISIONS	
NO.	

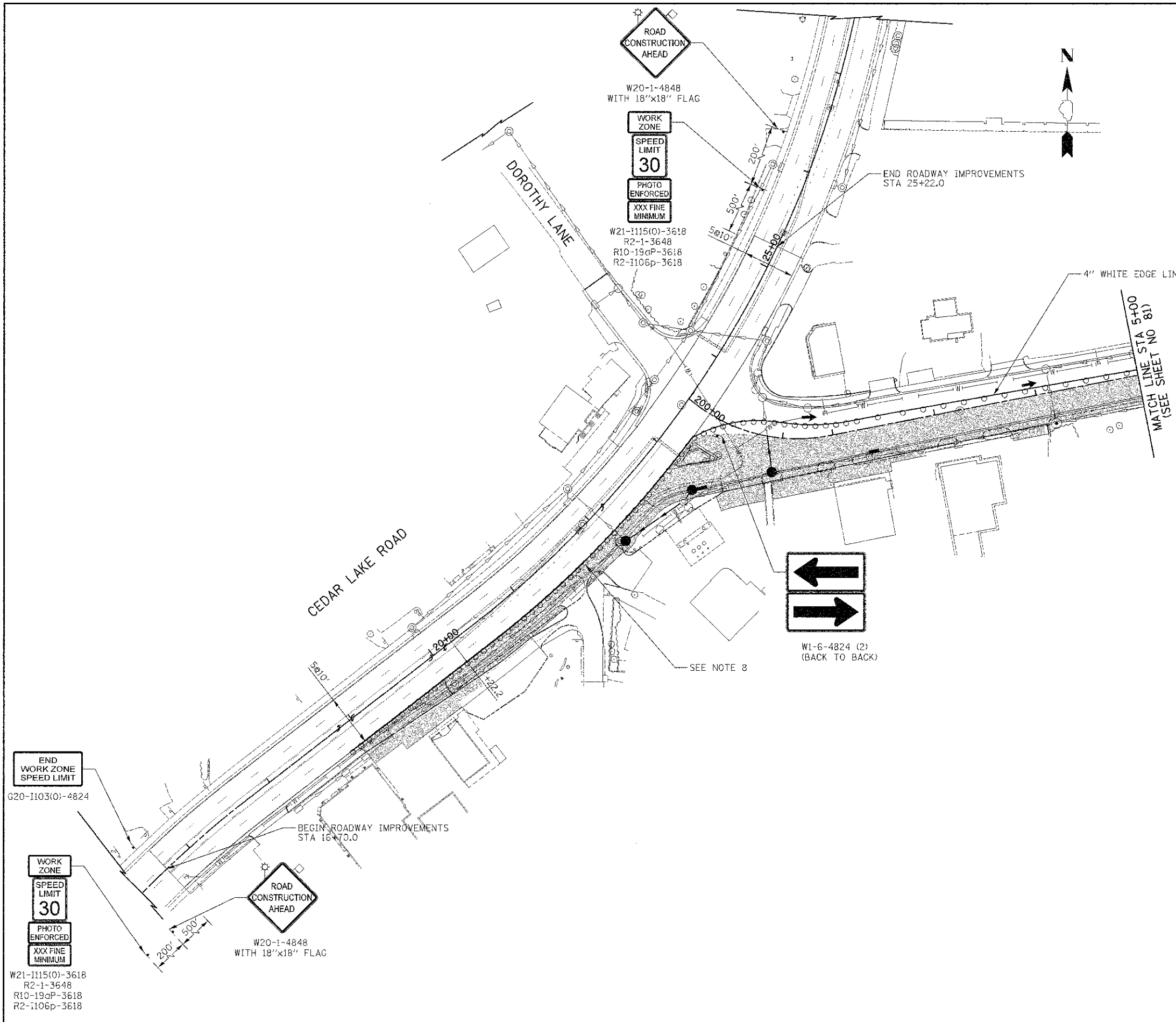

LEGEND

	PERMANENT PAVING DURING STAGE 2
	STORM SEWER INSTALLED DURING STAGE 2
	EXISTING STORM SEWER AT BEGINNING OF STAGE 2
	TYPE II BARRICADES WITH MONO-DIRECTIONAL STEADY-BURN LIGHTS @ 50' CTRS (20' SPACING IN TAPERS, 10' SPACING IN CORNER RADII)
	DIRECTION OF TRAFFIC PATTERNS DURING STAGE 2
	DRUMS OR TYPE II BARRICADES WITH MONO-DIRECTIONAL STEADY-BURN LIGHTS & DIRECTION INDICATOR PANELS @ 25' CTRS
	TYPE III BARRICADE WITH FLASHING LIGHTS
	TEMPORARY TRAFFIC SIGN ON PERMANENT SUPPORT
	AMBER FLASHING LIGHT
	18" x 18" FLAG
TA (PE)	TEMPORARY ACCESS (PRIVATE ENTRANCE)
TA (CE)	TEMPORARY ACCESS (COMMERCIAL ENTRANCE)

- NOTE:**
- SEE STAGES OF CONSTRUCTION TYPICAL SECTIONS FOR CONSTRUCTION PROCEDURE.
 - TEMPORARY TRAFFIC SIGNS SHALL BE PLACED PER IDOT STANDARD 701901.
 - REFERENCE IDOT STANDARDS FOR TAPERS.
 - EXISTING DRAINAGE TO BE MAINTAINED AT CROSS ROAD CULVERT LOCATIONS. CULVERTS TO BE CONSTRUCTED USING DAILY LANE CLOSURES & TEMPORARY PAVEMENT PATCHES.
 - ALL PROPOSED PAVEMENT MARKINGS ON THIS SHEET SHALL BE "TEMPORARY PAVEMENT MARKINGS" IN ACCORDANCE WITH ARTICLE 703.05 OF THE "STANDARD SPECIFICATIONS", EXCEPT AS SHOWN.
 - RAISED REFLECTIVE PAVEMENT MARKERS WHICH CONFLICT WITH STAGE 1 TRAFFIC SHALL BE REMOVED.
 - ALL TEMPORARY ACCESS LOCATIONS SHALL BE SIGNED ACCORDING TO LAKE COUNTY DETAIL, LC7201.
 - BINDER COURSE ON THE RIGHT TURN LANE ALONG CEDAR LAKE ROAD SHALL BE PLACED MAINTAINING TRAFFIC ON CEDAR LAKE ROAD PER STANDARD 70306. AFTER THE COMPLETION OF THIS WORK TYPE II BARRICADES SHALL BE PROVIDED JUST OUTSIDE OF CEDAR LAKE ROAD EDGE OF PAVEMENT.
 - TRAFFIC CONTROL FOR ALL INTERSECTIONS (SIDE ROADS) ALONG WASHINGTON STREET SHALL FOLLOW LCDOT DETAIL LC7004. SEE SHEET 75 FOR 'TYPICAL INTERSECTION ALONG WASHINGTON STREET' DETAIL.

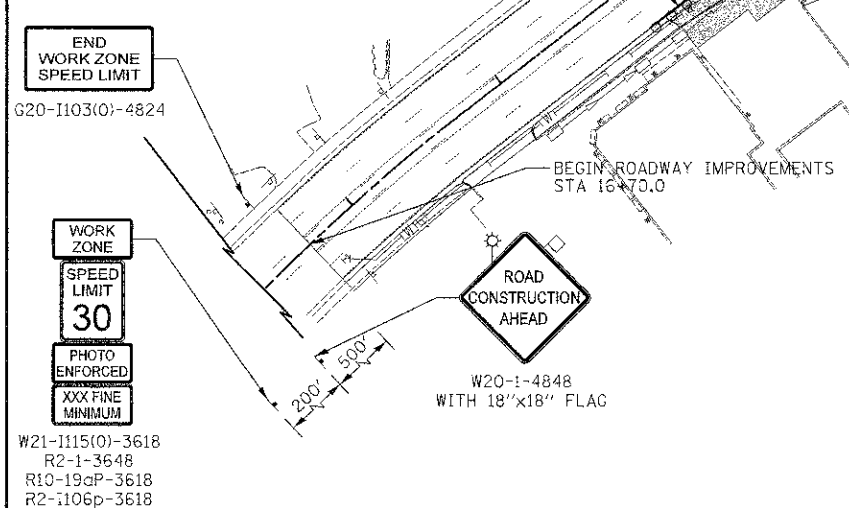

CIVILTECH
 450 E Devon Ave, Suite 300
 Itasca, Illinois 60143
 Tel: 630.773.3900 Fax: 630.773.3975
 www.civiltechinc.com

DESIGNED - PK	REVISED -
DRAWN - JRR	REVISED -
CHECKED - RTM	REVISED -
DATE - 1/7/2013	REVISED -

**STATE OF ILLINOIS
 DEPARTMENT OF TRANSPORTATION**

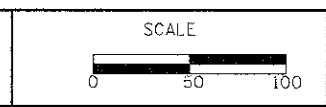

STAGES OF CONSTRUCTION STAGE II

SHEET NO. 4 OF 4 SHEETS STA. 200+00 TO STA. 5+00

F.A.U. RTE.	SECTION	COUNTY	TOTAL SHEETS	SHEET NO.
0187	C5-00121-07-WR	LAKE	223	80
CONTRACT NO. 63765				
FED. ROAD DIST. NO. 1 ILLINOIS FED. AID PROJECT				

WASHINGTON STREET