

NOTE:

1. VERIFY WHETHER THE AIR RELIEF VALVE VAULT HAS AN ECCENTRIC OR CONCENTRIC CONE TO DETERMINE IF THE CONE CAN BE ROTATED TO AVOID THE CURB. THE CONE SECTION MAY BE REPLACED TO AN ECCENTRIC TYPE IF IT'S CURRENTLY A CONCENTRIC TYPE AS LONG AS THE ADJUSTMENTS DO NOT CONFLICT WITH THE ABILITY TO ACCESS THE AIR RELIEF VALVE FROM THE TOP OF THE STRUCTURE AS IT NEEDS TO BE ACCESSIBLE FOR MAINTENANCE. VALVE VAULT SHALL BE PROVIDED WITH ADJUSTING RINGS NO LESS THAN TWO INCH HIGH AND NO MORE THAN A TOTAL OF TEN INCHES HIGH.



DATE	
BY	
FINAL SURVEY	
PLOTTED	
TEMPLATE	
NOTE BOOK	
AREAS CHECKED	
NO.	

DATE	
BY	
ORIGINAL SURVEY	
PLOTTED	
TEMPLATE	
NOTE BOOK	
AREAS CHECKED	
NO.	

MATCH LINE STA 15+00  
(SEE SHEET NO 93)

MATCH LINE STA 20+00  
(SEE SHEET NO 95)

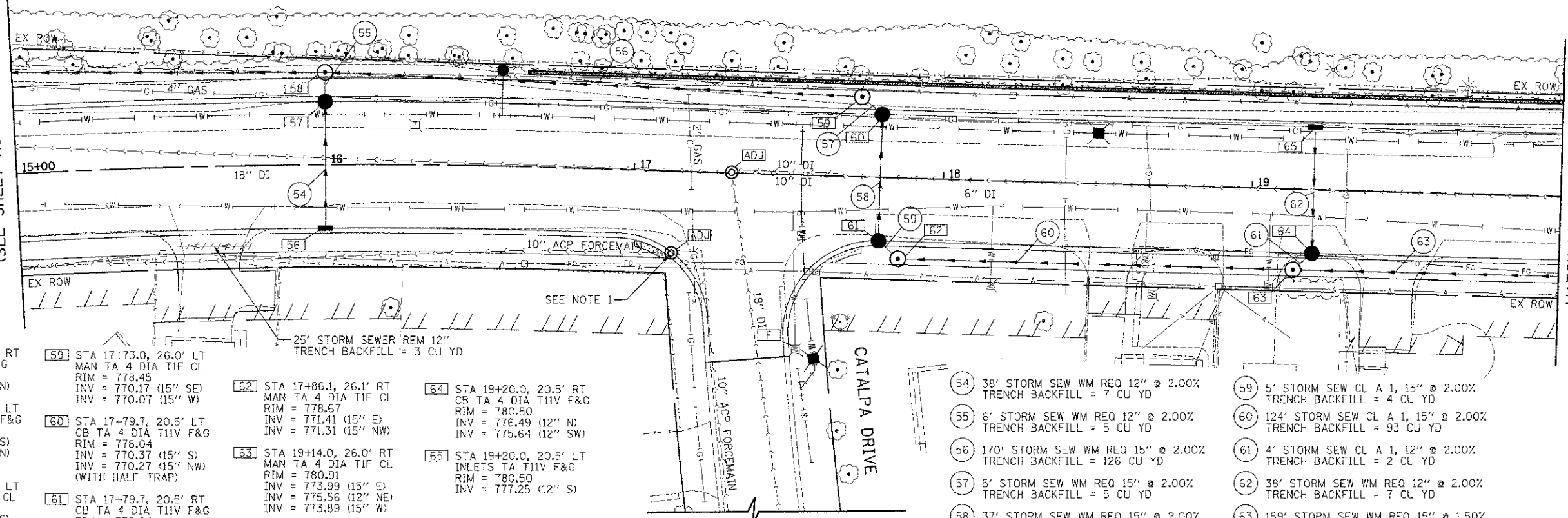

- |   |  |  |   |  |  |
|---|--|--|---|--|--|
| <p>[56] STA 16+00.0, 20.5' RT<br/>INLETS TA T11V F&amp;G<br/>RIM = 774.98<br/>INV = 770.98 (12" N)</p> <p>[57] STA 16+00.0, 20.5' LT<br/>CB TA 4 DIA T11V F&amp;G<br/>RIM = 774.98<br/>INV = 770.22 (12" S)<br/>INV = 768.69 (12" N)<br/>(WITH HALF TRAP)</p> <p>[58] STA 16+00.0, 30.0' LT<br/>MAN TA 4 DIA TIF CL<br/>RIM = 775.93<br/>INV = 768.57 (12" S)<br/>INV = 766.67 (15" E)<br/>INV = 766.57 (15" W)</p> | <p>[59] STA 17+73.0, 26.0' LT<br/>MAN TA 4 DIA TIF CL<br/>RIM = 778.45<br/>INV = 770.17 (15" SE)<br/>INV = 770.07 (15" W)</p> <p>[60] STA 17+79.7, 20.5' LT<br/>CB TA 4 DIA T11V F&amp;G<br/>RIM = 778.04<br/>INV = 770.37 (15" S)<br/>INV = 770.27 (15" NW)<br/>(WITH HALF TRAP)</p> <p>[61] STA 17+79.7, 20.5' RT<br/>CB TA 4 DIA T11V F&amp;G<br/>RIM = 778.04<br/>INV = 771.21 (15" SE)<br/>INV = 771.11 (15" N)</p> | <p>[62] STA 17+86.1, 26.1' RT<br/>MAN TA 4 DIA TIF CL<br/>RIM = 778.67<br/>INV = 771.41 (15" E)<br/>INV = 771.31 (15" NW)</p> <p>[63] STA 19+14.0, 26.0' RT<br/>MAN TA 4 DIA TIF CL<br/>RIM = 780.91<br/>INV = 773.99 (15" E)<br/>INV = 773.89 (15" W)</p> | <p>[64] STA 19+20.0, 20.5' RT<br/>CB TA 4 DIA T11V F&amp;G<br/>RIM = 780.50<br/>INV = 776.49 (12" N)<br/>INV = 775.64 (12" SW)</p> <p>[65] STA 19+20.0, 20.5' LT<br/>INLETS TA T11V F&amp;G<br/>RIM = 780.50<br/>INV = 777.25 (12" S)</p> | <p>[54] 38' STORM SEW WM REQ 12" @ 2.00%<br/>TRENCH BACKFILL = 7 CU YD</p> <p>[55] 6' STORM SEW WM REQ 12" @ 2.00%<br/>TRENCH BACKFILL = 5 CU YD</p> <p>[56] 170' STORM SEW WM REQ 15" @ 2.00%<br/>TRENCH BACKFILL = 126 CU YD</p> <p>[57] 5' STORM SEW WM REQ 15" @ 2.00%<br/>TRENCH BACKFILL = 5 CU YD</p> <p>[58] 37' STORM SEW WM REQ 15" @ 2.00%<br/>TRENCH BACKFILL = 29 CU YD</p> | <p>[59] 5' STORM SEW CL A 1, 15" @ 2.00%<br/>TRENCH BACKFILL = 4 CU YD</p> <p>[60] 124' STORM SEW CL A 1, 15" @ 2.00%<br/>TRENCH BACKFILL = 93 CU YD</p> <p>[61] 4' STORM SEW CL A 1, 12" @ 2.00%<br/>TRENCH BACKFILL = 2 CU YD</p> <p>[62] 38' STORM SEW WM REQ 12" @ 2.00%<br/>TRENCH BACKFILL = 7 CU YD</p> <p>[63] 159' STORM SEW WM REQ 15" @ 1.50%<br/>TRENCH BACKFILL = 121 CU YD</p> |
|---|--|--|---|--|--|

WASHINGTON STREET

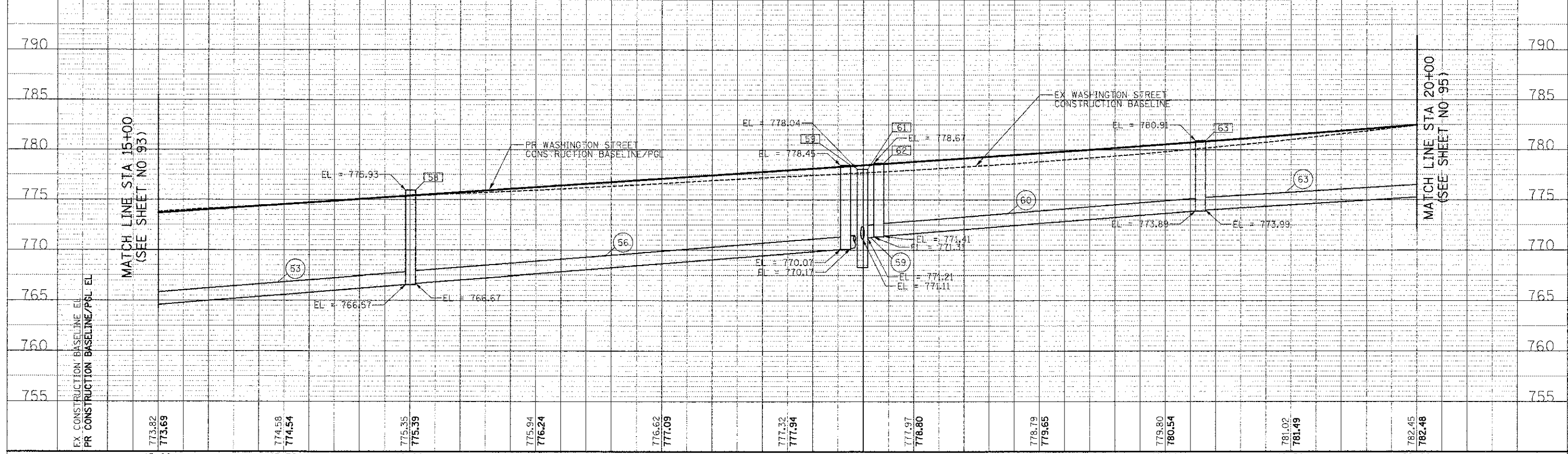

MATCH LINE STA 20+00  
(SEE SHEET NO 95)

EX CONSTRUCTION BASELINE/PG&E EL	773.82	773.69	774.58	774.54	775.35	775.39	775.94	776.24	776.62	777.09	777.32	777.94	777.97	778.80	778.79	779.65	779.80	780.54	781.02	781.49	782.45	782.48
	15+00		15+50		16+00		16+50		17+00		17+50		18+00		18+50		19+00		19+50		20+00	

**CIVILTECH**  
450 E Devon Ave, Suite 300  
Itasca, Illinois 60143  
Tel: 630.773.3900 Fax: 630.773.3975  
www.civiltechinc.com

DESIGNED - PK	REVISED -
DRAWN - JRR	REVISED -
CHECKED - RTM	REVISED -
DATE - 12/17/2012	REVISED -

**STATE OF ILLINOIS**  
**DEPARTMENT OF TRANSPORTATION**

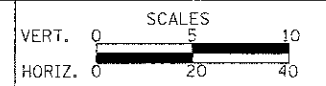

**DRAINAGE AND UTILITIES**

SHEET NO. 4 OF 15 SHEETS STA. 15+00 TO STA. 20+00

F.A.U. RTE.	SECTION	COUNTY	TOTAL SHEETS	SHEET NO.
0187	05-00121-07-WR	LAKE	223	94
CONTRACT NO. 63765			FED. ROAD DIST. NO. 1 [ILLINOIS] FED. AID PROJECT	