

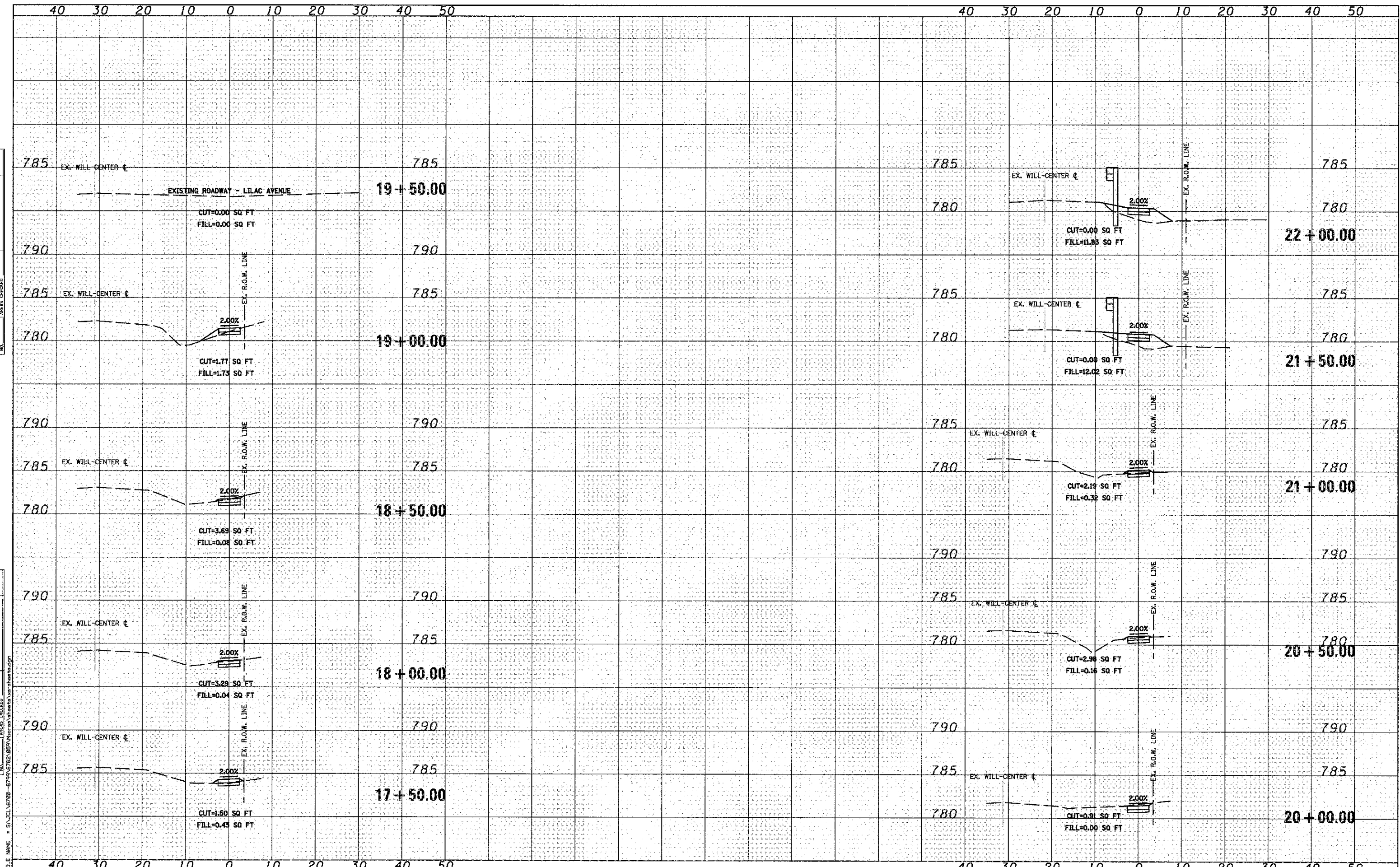

DATE	
BY	
FINISHED	
SURVEYED	
PLOTTED	
TEMPLATE	
NOTE BOOK	
AREAS CHECKED	
NO.	

DATE	
BY	
ORIGINAL	
SURVEYED	
PLOTTED	
TEMPLATE	
NOTE BOOK	
AREAS CHECKED	
NO.	



 1170 SOUTH HOUBOLT ROAD
 JOLIET, ILLINOIS 60431
 (815) 744-4200

USER NAME = akwarrn	DESIGNED - AAN	REVISED -
PLLOT SCALE = 20.0000' / IN.	DRAWN - AJJ	REVISED -
PLLOT DATE = 12/26/2012	CHECKED - MAG	REVISED -
	DATE - 10/02/2012	REVISED -

STATE OF ILLINOIS
DEPARTMENT OF TRANSPORTATION

CROSS SECTIONS	
SCALE:	SHEET OF SHEETS
STA. 17+50.00 TO STA. 22+00.00	

MUN. RTE.	SECTION	COUNTY	TOTAL SHEETS	SHEET NO.
1007	09-00021-00-SW	WILL	22	21
CONTRACT NO. 63772				
FED. ROAD DIST. NO. 1 ILLINOIS FED. AID PROJECT				