

WAUBONSIE VALLEY
HIGH SCHOOL

STADIUM DRIVE

EOLA ROAD

16' TRAFFIC SIGNAL POST
STA 1169+65, 45.1' LT
42' COMBINATION MAST ARM
WITH 36" FOUNDATION (MA-3)
STA 1169+52, 45.6' LT

30' COMBINATION MAST ARM
WITH 36" FOUNDATION (MA-1)
STA 1170+41, 60.8' LT

16' TRAFFIC SIGNAL POST
STA 1170+67, 53.2' LT

PROPOSED INTERSECTION
AND SAMPLING (SYSTEM)
VIDEO DETECTION ZONE

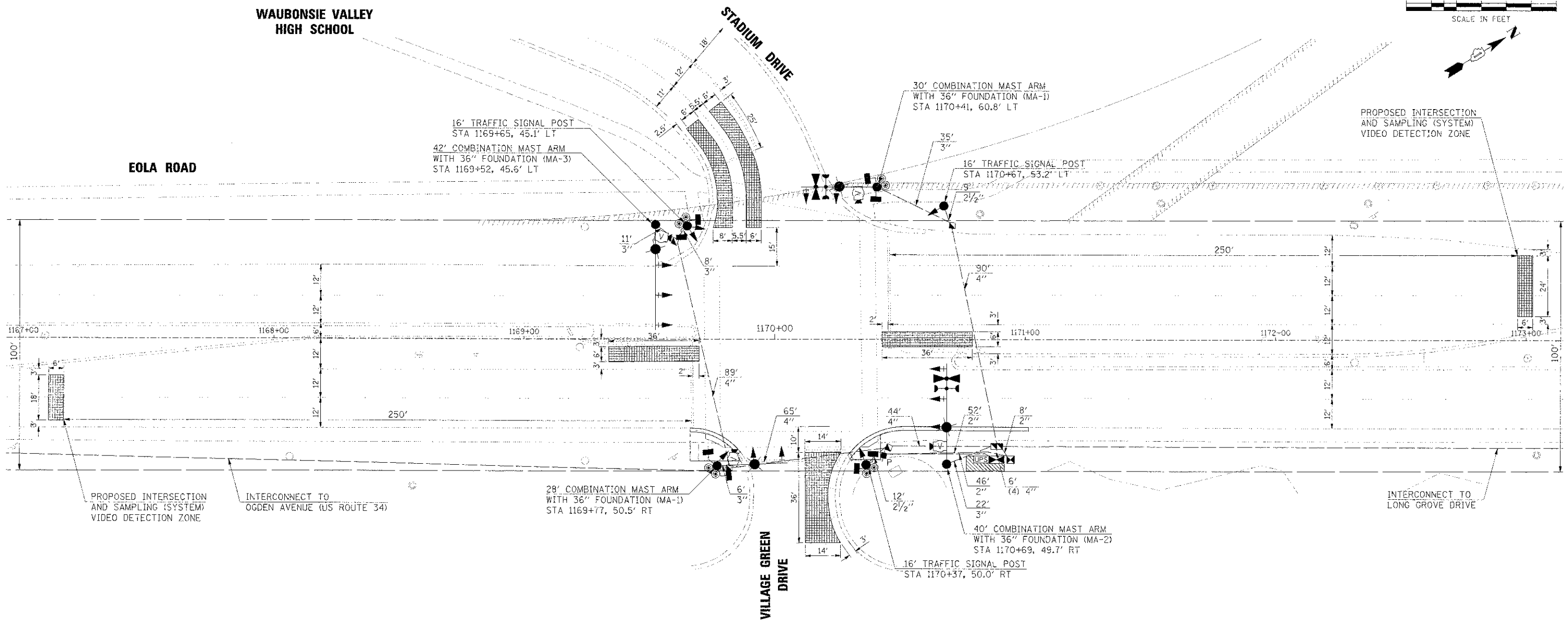

PROPOSED INTERSECTION
AND SAMPLING (SYSTEM)
VIDEO DETECTION ZONE

INTERCONNECT TO
OGDEN AVENUE (US ROUTE 34)

28' COMBINATION MAST ARM
WITH 36" FOUNDATION (MA-1)
STA 1169+77, 50.5' RT

VILLAGE GREEN
DRIVE

40' COMBINATION MAST ARM
WITH 36" FOUNDATION (MA-2)
STA 1170+69, 49.7' RT

16' TRAFFIC SIGNAL POST
STA 1170+37, 50.0' RT

INTERCONNECT TO
LONG GROVE DRIVE

- NOTES:
1. ALL PROPOSED TRAFFIC SIGNAL MAST ARMS AND POSTS SHALL BE PAINTED BLACK.
 2. THE PHOTOCELL SHALL BE MOUNTED ON THE LIGHTING CONTROLLER CABINET AWAY FROM DIRECT SUNLIGHT. THIS WORK AND THE COST OF THE LIGHTING CONTROLLER CABINET AND FOUNDATION SHALL BE INCLUDED IN THE COST OF THE LIGHTING CONTROLLER.
 3. AN ETHERNET SWITCH SHALL BE INSTALLED WITHIN THE PROPOSED TRAFFIC SIGNAL CONTROLLER CABINET AT VILLAGE GREEN DRIVE / STADIUM DRIVE (SEE SPECIAL PROVISIONS).

THE TRAFFIC SIGNAL CONTROL EQUIPMENT FOR THIS PROJECT SHALL BE "ECONOLITE" TO MATCH THE EXISTING ADJACENT SYSTEM.

THE EMERGENCY VEHICLE PREEMPTION EQUIPMENT FOR THIS PROJECT SHALL BE OPTICOM AS REQUIRED BY THE CITY OF AURORA. LIGHT DETECTOR AMPLIFIERS SHALL BE OPTICOM MODEL 764 MULTIMODE PHASE SELECTORS.

RESTORATION OF WORK AREA:
RESTORATION OF THE TRAFFIC SIGNAL WORK AREA SHALL BE INCIDENTAL TO THE RELATED PAY ITEM SUCH AS FOUNDATION, CONDUIT, HANDHOLE, TRENCH AND BACKFILL, ETC., AND NO EXTRA COMPENSATION SHALL BE ALLOWED. ALL ROADWAY SURFACES SUCH AS SHOULDERS, MEDIANS, SIDEWALKS, PAVEMENT, ETC. SHALL BE REPLACED IN KIND. ALL DAMAGE TO MOWED LAWNS SHALL BE REPLACED WITH AN APPROVED SOD, AND ALL DAMAGE TO UNMOWED FIELDS SHALL BE SEEDED IN ACCORDANCE WITH STANDARD SPECIFICATIONS 252 AND 250 RESPECTIVELY.

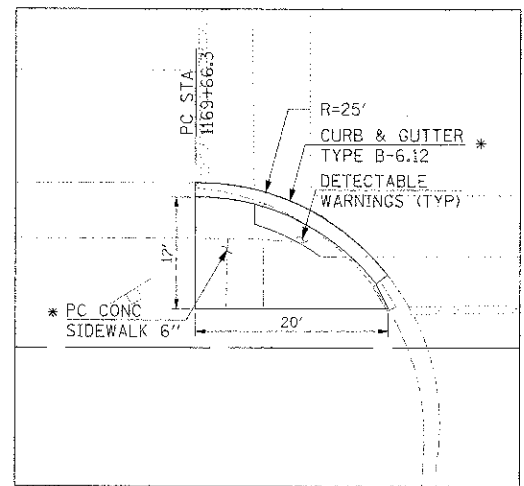

SE CORNER DETAIL

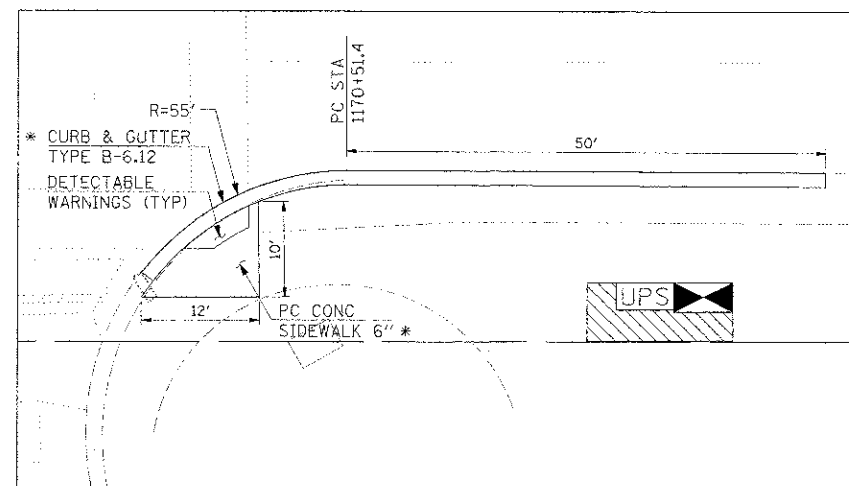

NE CORNER DETAIL

* A 4" LAYER OF MECHANICALLY COMPACTED CRUSHED STONE (CA-6) SHALL BE PROVIDED BENEATH THE PROPOSED SIDEWALK AND CURB AND GUTTER. THE COST OF THIS WORK WILL NOT BE PAID FOR SEPARATELY BUT SHALL BE INCLUDED IN THE UNIT BID PRICES FOR PORTLAND CEMENT CONCRETE SIDEWALK AND COMBINATION CONCRETE CURB AND GUTTER.

- NOTES:
1. THE TRANSITION FROM FULL HEIGHT CURB TO DEPRESSED CURB SHALL BE IN ACCORDANCE WITH ARTICLE 606.07 OF THE STANDARD SPECIFICATIONS.
 2. ANY REQUIRED SAWCUTTING SHALL BE INCLUDED IN THE UNIT BID PRICES OF THE CONTRACT.

LEGEND

	EXISTING RIGHT-OF-WAY
	EXISTING PERMANENT EASEMENT

PLAN	SURVEYED	DATE
	BY	
	NOTED	
	DATE	

PROJECT	DATE
BY	
NOTED	
DATE	