

RESTORATION OF WORK AREA

RESTORATION OF THE TRAFFIC SIGNAL WORK AREA SHALL BE INCIDENTAL TO THE RELATED PAY ITEM SUCH AS FOUNDATION, CONDUIT, HANDHOLE, TRENCH AND BACKFILL, ETC., AND NO EXTRA COMPENSATION SHALL BE ALLOWED. ALL ROADWAYS SURFACES SUCH AS SHOULDERS, MEDIANS, SIDEWALKS, PAVEMENT, ETC. SHALL BE REPLACED IN KIND. ALL DAMAGE TO MOWED LAWNS SHALL BE REPLACED WITH AN APPROVED SOD AND ALL DAMAGE TO UNMOWED LAWNS SHALL BE SEEDED IN ACCORDANCE WITH STANDARD SPECIFICATIONS 252 AND 250 RESPECTIVELY.

NOTE

THE TRAFFIC SIGNAL CONTROL EQUIPMENT FOR THIS PROJECT SHALL BE "EAGLE" TO MATCH THE EXISTING ADJACENT SYSTEM.

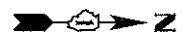
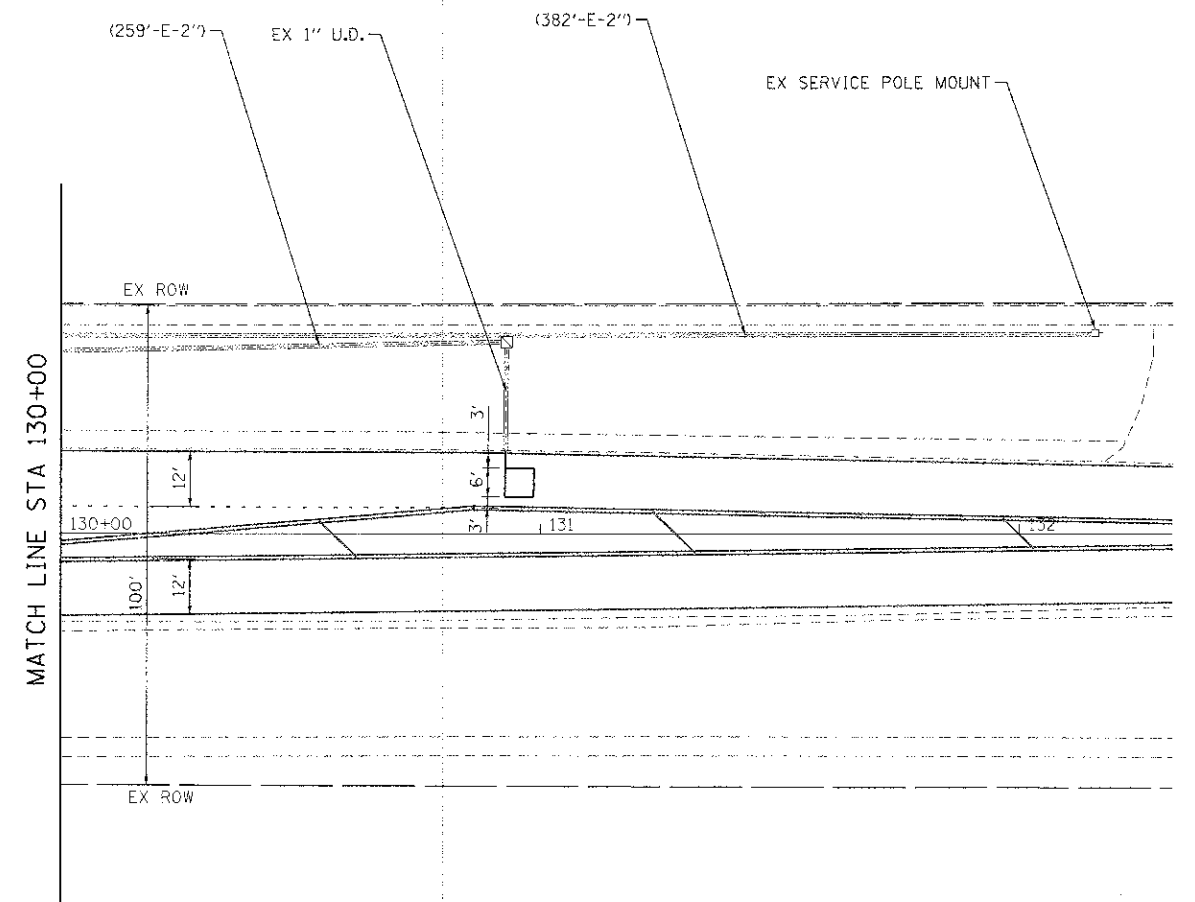
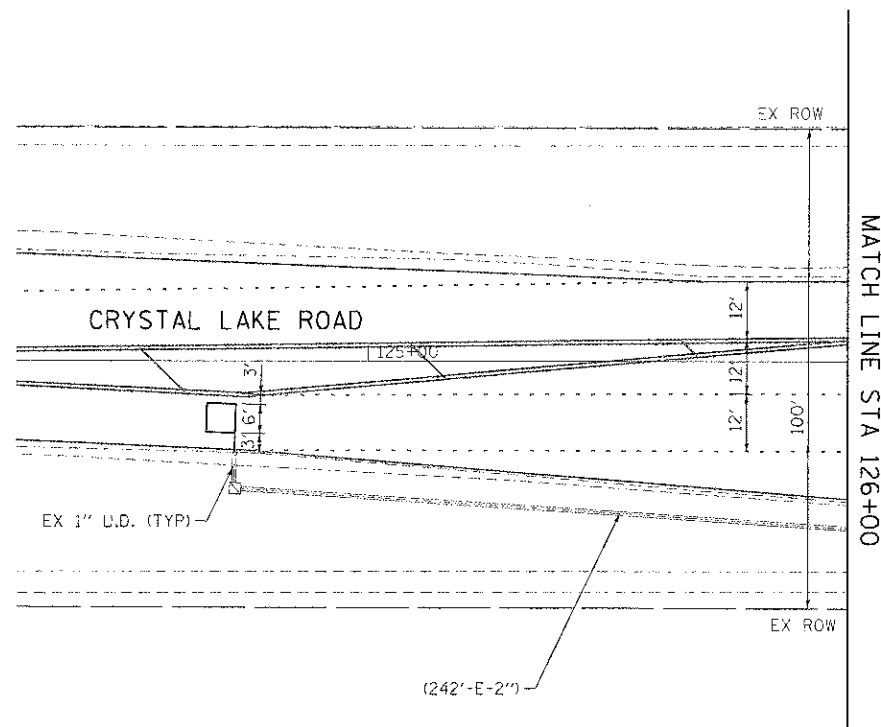

GRAPHIC SCALE



COMPANY NAME: HRGreen.com
 PROJECT CONTACT: J. J. Strickland
 DATE PLOTTED: 3/27/17 PM
 FILE NAME: 8610363.dwg
 PLOT DRIVER: PLOTDRIVER
 PLOT DATE: 3/27/17

	USER NAME = jstrick	DESIGNED - JJS	REVISED -	CITY OF MCHENRY	TRAFFIC SIGNAL INSTALLATION PLAN CRYSTAL LAKE ROAD AT WINDING CREEK DRIVE	F.A. RTE. 0085	SECTION 11-00073-00-RS	COUNTY MCHENRY	TOTAL SHEETS 44	SHEET NO. 28		
	PLOT SCALE = 1"=20'	CHECKED - CP	REVISED -			SCALE: 1"=20'	SHEET NO. 2 OF 2 SHEETS	STA. NA	TO STA. NA	CONTRACT NO. 63794		
	PLOT DATE = .DATE1.	DATE -	REVISED -					FED. ROAD DIST. NO.	ILLINOIS FED. AID PROJECT			