

**RESTORATION OF WORK AREA**

RESTORATION OF THE TRAFFIC SIGNAL WORK AREA SHALL BE INCIDENTAL TO THE RELATED PAY ITEM SUCH AS FOUNDATION, CONDUIT, HANDHOLE, TRENCH AND BACKFILL, ETC., AND NO EXTRA COMPENSATION SHALL BE ALLOWED. ALL ROADWAYS SURFACES SUCH AS SHOULDERS, MEDIANS, SIDEWALKS, PAVEMENT, ETC. SHALL BE REPLACED IN KIND. ALL DAMAGE TO MOWED LAWNS SHALL BE REPLACED WITH AN APPROVED SOD AND ALL DAMAGE TO UNMOWED LAWNS SHALL BE SEEDING IN ACCORDANCE WITH STANDARD SPECIFICATIONS 252 AND 250 RESPECTIVELY.

**NOTE**

THE TRAFFIC SIGNAL CONTROL EQUIPMENT FOR THIS PROJECT SHALL BE "EAGLE" TO MATCH THE EXISTING ADJACENT SYSTEM.

**NOTE**

THE NEW PEDESTRIAN SIGNAL HEADS WITH COUNTDOWN TIMERS AND NEW BRACKETS SHALL BE PAINTED BLACK WHICH WILL BE INCLUDED IN THE CONTRACT UNIT COST FOR THE PEDESTRIAN SIGNAL HEADS.

1. ALL NEW TRAFFIC SIGNAL EQUIPMENT INCLUDING POSTS AND MAST ARMS SHALL ARRIVE AT THE PROJECT SITE WITH A BLACK FACTORY FINISH IN ACCORDANCE WITH THE SPECIFICATIONS.
2. STOP BARS ARE NOT TO BE PLACED PRIOR TO THE PROPOSED TRAFFIC SIGNALS BEING OPERATIONAL, THEY WILL BE INSTALLED AT THE TIME OF TRAFFIC SIGNAL TURN-ON.
3. THE EMERGENCY VEHICLE PREEMPTION EQUIPMENT FOR THIS PROJECT SHALL BE TOMAR OR AN APPROVED EQUAL AS REQUIRED BY THE MCHENRY TOWNSHIP FIRE DEPARTMENT.
4. THE CONCRETE APRON AND EARTH EXCAVATION REQUIRED AT THE CONTROLLER WILL BE INCLUDED IN THE COST FOR UNINTERRUPTIBLE POWER SUPPLY SPECIAL.

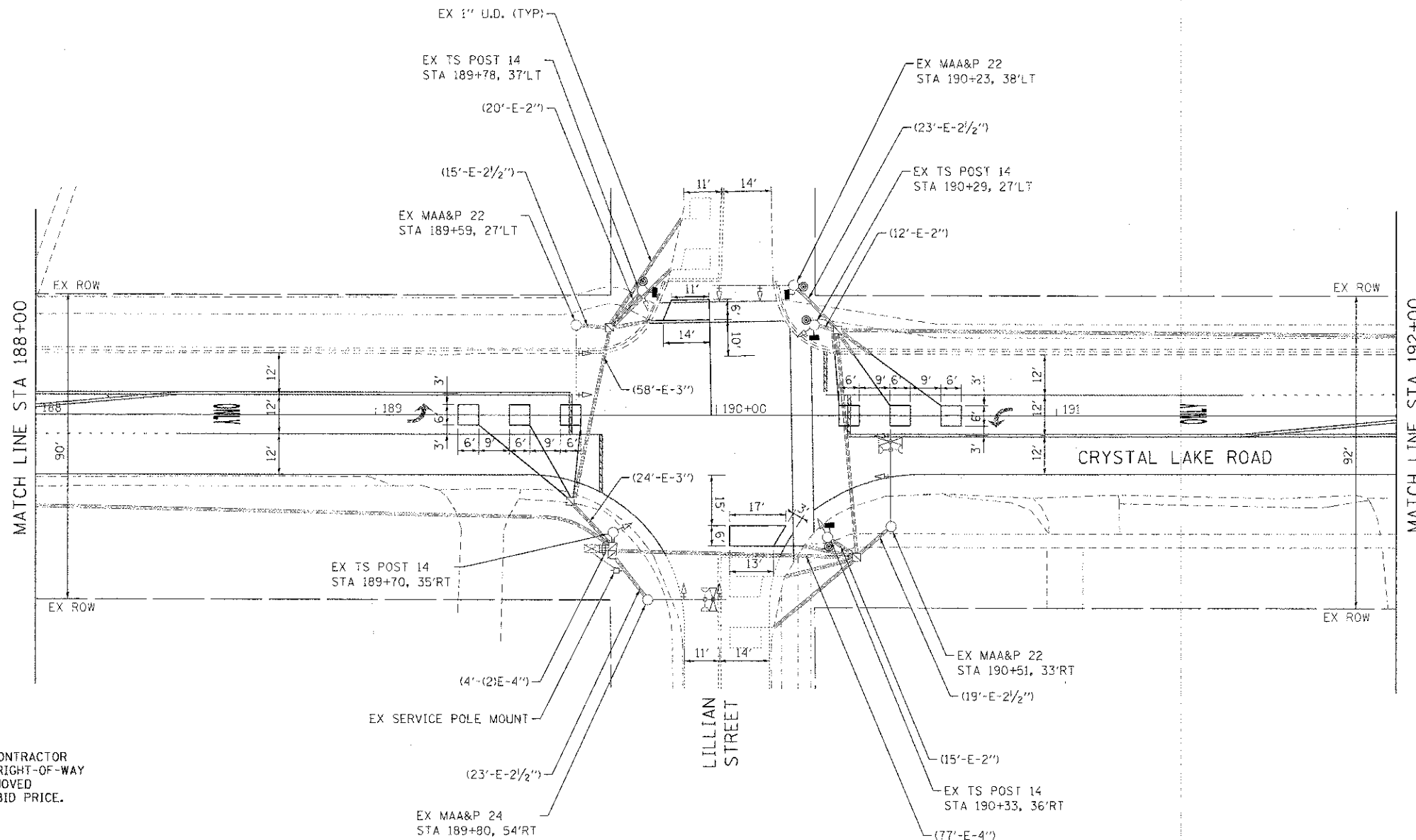

THE FOLLOWING ITEMS SHALL BE REMOVED BY THE CONTRACTOR AND SHALL BE DISPOSED OF BY THEM OUTSIDE THE RIGHT-OF-WAY AT THEIR EXPENSE. THE SALVAGE VALUE OF THE REMOVED EQUIPMENT SHALL BE REFLECTED IN THE CONTRACT BID PRICE.

- 4 EACH PEDESTRIAN SIGNAL HEAD
- 4 EACH PEDESTRIAN PUSH BUTTON

THE FOLLOWING EXISTING TRAFFIC SIGNAL EQUIPMENT SHALL BE PAINTED IN PLACE IN ACCORDANCE WITH SECTION 851 OF THE STANDARD SPECIFICATIONS, EXCEPT THAT THE STEEL MAST ARM ASSEMBLIES AND POLES, SIGNAL POSTS, SIGNAL HOUSINGS, AND BRACKETS SHALL BE PAINTED WITH TWO COATS OF 'BLACK' PAINT. THE CONTRACTOR SHALL BE RESPONSIBLE FOR PROVIDING TRAFFIC CONTROL DURING PAINTING OPERATIONS, WHICH SHALL BE CONSIDERED AS INCLUDED IN THE PAINTING PAY ITEMS.

- 4 EACH STEEL MAST ARM ASSEMBLY AND POLE, UNDER 40 FEET
- 4 EACH TRAFFIC SIGNAL POST
- 12 EACH SIGNAL HEADS (DOORS, VISORS, HOUSINGS & BRACKETS)
- 8 EACH SIGNAL BACKPLATES

COMPANY NAME: HRGreen  
 PROJECT CONTACT: HRGreen.com  
 DATE: 2/1/2013 7:48:47 AM  
 FILE NAME: 86110363\_sigsig01.dgn  
 PLOT DRIVER: PLOT.DWT  
 PEN TABLE: STANDARD-FRANK.TBL



USER NAME = jstrze2	DESIGNED - JJS	REVISED -
PLOT SCALE = 1"=20'	DRAWN - JJS	REVISED -
PLOT DATE = 2/1/2013	CHECKED - CP	REVISED -
	DATE - 11/12/12	REVISED -

**CITY OF MCHENRY**

**TRAFFIC SIGNAL INSTALLATION PLAN  
CRYSTAL LAKE ROAD AT LILLIAN STREET**

SCALE: 1"=20' SHEET NO. 1 OF 2 SHEETS STA. NA TO STA. NA

P.A. RTE. 0085	SECTION 11-00073-00-RS	COUNTY MCHENRY	TOTAL SHEETS 44	SHEET NO. 33
FED. ROAD DIST. NO.			ILLINOIS FED. AID PROJECT	
			CONTRACT NO. 63794	