

STATE OF ILLINOIS
DEPARTMENT OF TRANSPORTATION
DIVISION OF HIGHWAYS

**PLANS FOR PROPOSED
FEDERAL AID HIGHWAY**

**VARIOUS LOCAL ROADS
SIDEWALK INSTALLATION
PROJECT NO.: SRTS-4009(174)
SECTION NO.: 12-00066-00-SW
VILLAGE of BRIDGEVIEW
COOK COUNTY
C-91-480-12**

F. A. L. I. NO.	SECTION	COUNTY	TOTAL SHEETS	SHEET NO.
N/A	12-00066-00-SW	COOK	11	1
STA.	TO STA.			
FED. ROAD DIST. NO. 1	ILLINOIS	FED. AID PROJECT	SRTS-4009(174)	

CONTRACT #63800

INDEX OF SHEETS

1. COVER SHEET, INDEX OF SHEETS & HIGHWAY STANDARDS
2. SUMMARY OF QUANTITIES & GENERAL NOTES
3. TYPICAL SECTIONS
- 4.-9. SIDEWALK PLAN & PROFILE
- 10.-11. IDOT DISTRICT 1 STANDARD DETAILS

HIGHWAY STANDARDS

- 000001-06 STANDARD SYMBOLS, ABBREVIATIONS AND PATTERNS
- 424001-07 PERPENDICULAR CURB RAMPS
- 424011-01 CORNER PARALLEL CURB RAMPS FOR SIDEWALKS
- 424016-01 MID-BLOCK CURB AND RAMPS FOR SIDEWALKS
- 606001-05 CONCRETE CURB TYPE B AND COMBINATION CONCRETE CURB AND GUTTER
- 701501-06 URBAN LANE CLOSURE, 2L, 2W, UNDIVIDED
- 701801-05 SIDEWALK, CORNER OR CROSSWALK CLOSURE
- 701901-02 TRAFFIC CONTROL DEVICES

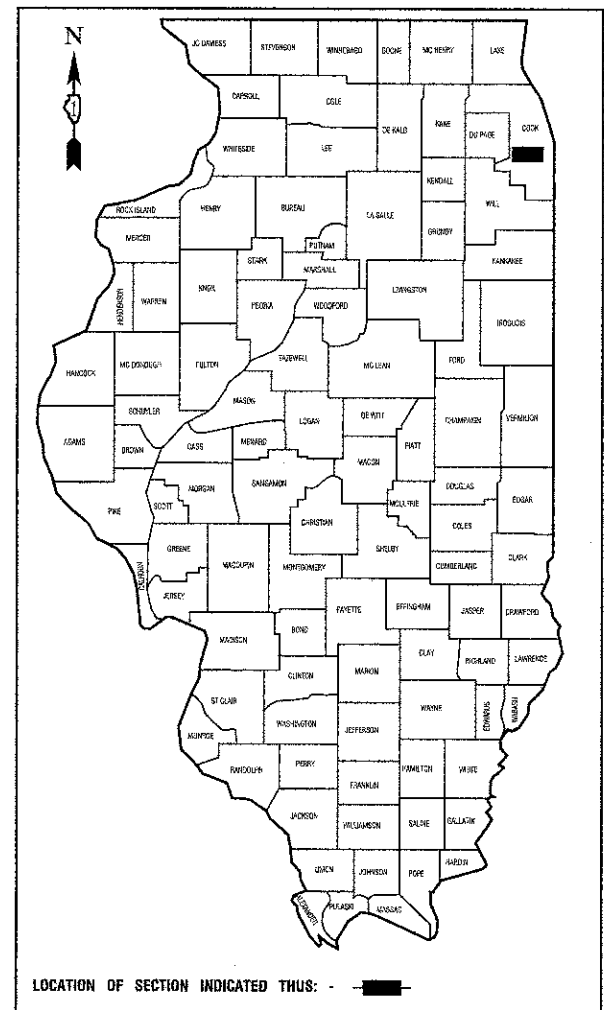

STATE OF ILLINOIS DEPARTMENT OF TRANSPORTATION
DIVISION OF HIGHWAYS

Approved: 1-30-2013
Steve Usher
President, Village of Bridgeview

Passed: 2-27-2013
C. P. H. H.
District 1 Engineer of Local Roads & Streets

Released for Bid Based on Limited Review: MARCH 4, 2013
John Fortman
Deputy Director of Highways, Region 1 Engineer

PRINTED BY THE AUTHORITY OF THE STATE OF ILLINOIS

PREPARED BY OR UNDER THE DIRECT SUPERVISION OF:
John K. B...
1-31-2013

REGISTERED PROFESSIONAL ENGINEER
LICENSE EXPIRES: 11/30/13

PROGRAM AND OFFICE ENGINEER: CHARLES F. RIDDLE, P.E. 847-705-4406, SCHAMBURG, IL.
CONSULTANTS: ROBINSON ENGINEERING, LTD. 708-331-6700

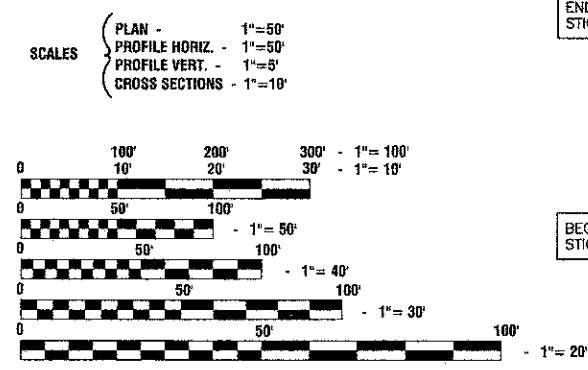

FULL SIZE PLANS HAVE BEEN PREPARED USING STANDARD ENGINEERING SCALES, REDUCED SIZED PLANS WILL NOT CONFORM TO STANDARD SCALES, IN MAKING MEASUREMENTS ON REDUCED PLANS, THE ABOVE SCALES MAY BE USED.

J. U. L. I. E.
JOINT UTILITY LOCATION INFORMATION FOR EXCAVATION
1-800-892-0123 or 811

CONTRACT NO. 63800

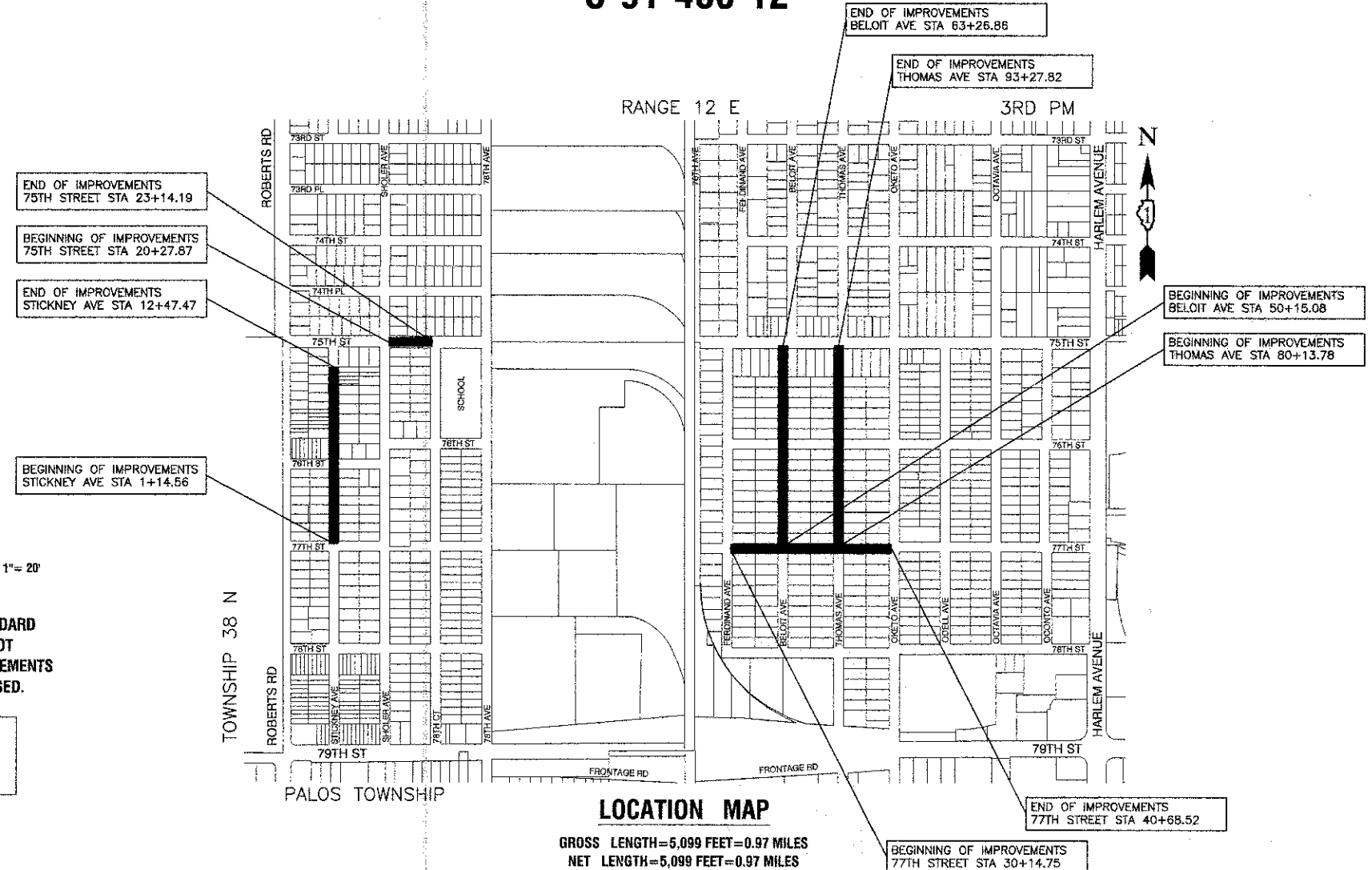

SUMMARY OF QUANTITIES					CONSTRUCTION TYPE CODE
S.I.	CODE NO.	PAY ITEM	UNIT	QUAN	0021
	20100110	TREE REMOVAL (6 TO 15 UNITS DIAMETER)	UNIT	62	62
	20100210	TREE REMOVAL (OVER 15 UNITS DIAMETER)	UNIT	163	163
~	21101615	TOPSOIL FURNISH AND PLACE, 4"	SQ YD	874	874
~	25000100	SEEDING, CLASS 1	ACRE	0.02	0.02
	35101598	AGGREGATE BASE COURSE, TYPE B 3"	SQ YD	2830	2830
	42300200	PORTLAND CEMENT CONCRETE DRIVEWAY PAVEMENT, 6 INCH	SQ YD	131	131
~	42400200	PORTLAND CEMENT CONCRETE SIDEWALK 5 INCH	SQ FT	21176	21176
~	42400300	PORTLAND CEMENT CONCRETE SIDEWALK 6 INCH	SQ FT	4282	4282
~	42400800	DETECTABLE WARNINGS	SQ FT	174	174
	44000200	DRIVEWAY PAVEMENT REMOVAL	SQ YD	799	799
	44000600	SIDEWALK REMOVAL	SQ FT	33	33
	56500600	DOMESTIC WATER SERVICE BOXES TO BE ADJUSTED	EACH	22	22
	60266600	VALVE BOXES TO BE ADJUSTED	EACH	2	2
	67100100	MOBILIZATION	L SUM	1	1
	70102620	TRAFFIC CONTROL AND PROTECTION, STANDARD 701501	L SUM	1	1
	70102640	TRAFFIC CONTROL AND PROTECTION, STANDARD 701801	L SUM	1	1
~	X2020410	EARTH EXCAVATION (SPECIAL)	CU YD	643	643
~	XX008200	STABILIZED DRIVEWAY PAVEMENT	SQ YD	188	188
~	Z0004562	COMBINATION CURB AND GUTTER REMOVAL AND REPLACEMENT	FOOT	223	223

GENERAL NOTES

- BEFORE STARTING ANY EXCAVATION THE CONTRACTOR SHALL CALL "J.U.L.I.E." AT (800) 892-0123 OR 811 AND (312) 744-7000 FOR FIELD LOCATIONS OF BURIED ELECTRIC, TELEPHONE AND GAS UTILITIES. (48 HOUR NOTIFICATION REQUIRED)
- UTILITIES INDICATED ON THE PLANS ARE PROVIDED FOR THE CONTRACTOR'S USE AND ARE BASED UPON INFORMATION AVAILABLE AT THE TIME OF THE ADVERTISEMENT FOR BIDS. THE OWNER AND ENGINEER DO NOT GUARANTEE THE ACCURACY OF UTILITY INFORMATION.
- IT SHALL BE THE CONTRACTOR'S RESPONSIBILITY TO VERIFY ALL DIMENSIONS AND CONDITIONS EXISTING IN THE FIELD PRIOR TO CONSTRUCTION AND ORDERING OF MATERIALS.
- THE THICKNESS OF HMA MIXTURE STATED IN THE SPECIFICATIONS IS THE NOMINAL THICKNESS. DEVIATIONS FROM THE NOMINAL THICKNESS WILL BE PERMITTED WHEN SUCH DEVIATIONS OCCUR DUE TO IRREGULARITIES IN THE EXISTING SURFACE OR BASE ON WHICH THE HMA SURFACE IS PLACED.
- THE REMOVAL AND/OR REPLACEMENT OF ANY DRIVEWAYS, PAVEMENT, CURB, SIDEWALK, ETC. SHALL BE ACCOMPLISHED BY MEANS OF A SAW CUT JOINT, AT THE DIRECTION OF THE ENGINEER. THIS WORK WILL NOT BE PAID FOR SEPARATELY, BUT SHALL BE INCLUDED IN THE UNIT PRICE FOR THE VARIOUS ITEMS.
- ANY LOOSE MATERIAL DEPOSITED IN THE FLOW LINE OF DITCHES, GUTTERS OR OTHER DRAINAGE STRUCTURES SHALL BE REMOVED BY THE END OF EACH DAY BY THE CONTRACTOR AT THEIR EXPENSE.

* - INDICATES SPECIALTY ITEMS
 ~ - INDICATES SPECIAL PROVISIONS

FILE NAME = 10429-QUAN-01 - IDOT P01

USER NAME =	DESIGNED -- JPH	REVISED --
CHECKED -- PKB	REVISED --	
PLOT SCALE =	DRAWN -- PS	REVISED --
PLOT DATE = 02-01-13	CHECKED -- AG	REVISED --

STATE OF ILLINOIS
 DEPARTMENT OF TRANSPORTATION

VILLAGE OF BRIDGEVIEW
 PROPOSED SIDEWALK IMPROVEMENTS
 SUMMARY OF QUANTITIES

F.A. RTE	SECTION	COUNTY	TOTAL SHEETS	SHEET NO.
N/A	12-00066-00-SW	COOK	11	2
FED. ROAD DIST. NO. 1 ILLINOIS			FED. AID PROJECT SRTS-4009(174)	

SCALE: SHEET NO. 2 OF 11 SHEETS STA. TO STA.

DATE	
BY	
SURVEYED	
PLOTTED	
CHECKED	
NOTED	
NOTE BOOK NO.	
FILE NAME	

DATE	
BY	
SURVEYED	
PLOTTED	
CHECKED	
NOTED	
NOTE BOOK NO.	
FILE NAME	

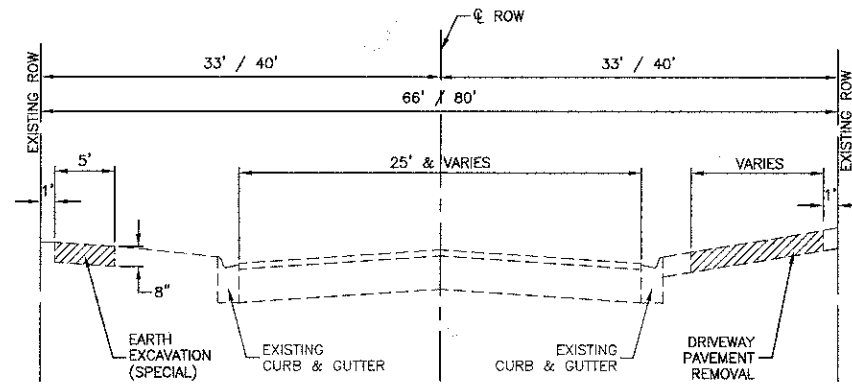

EXISTING TYPICAL SECTION

STICKNEY AVENUE	STA. 1+14.56 TO STA. 12+47.47
75TH STREET	STA. 20+27.87 TO STA. 23+14.19
77TH STREET	STA. 30+14.75 TO STA. 40+68.52
BELOIT AVENUE	STA. 50+15.08 TO STA. 63+26.86
THOMAS AVENUE	STA. 80+13.78 TO STA. 93+27.82

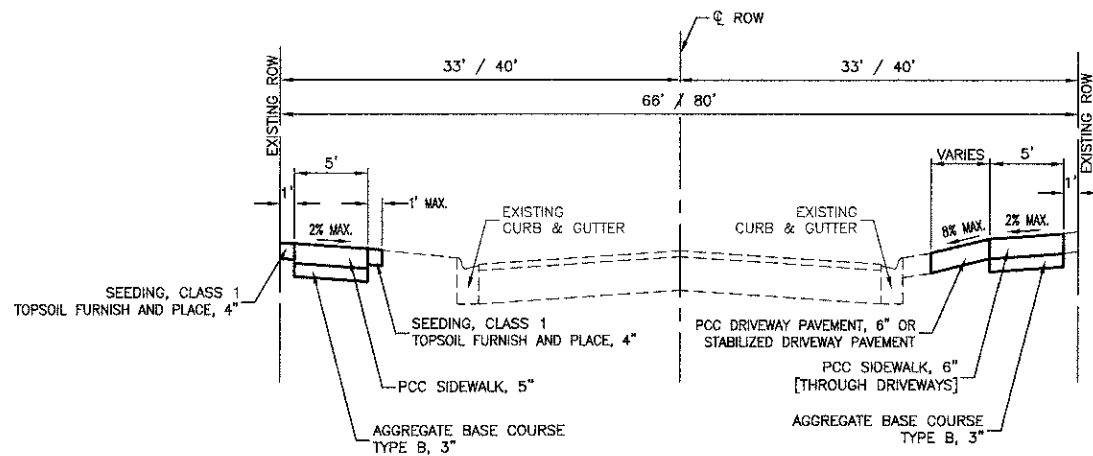

PROPOSED TYPICAL SECTION

STICKNEY AVENUE	STA. 1+14.56 TO STA. 12+47.47
75TH STREET	STA. 20+27.87 TO STA. 23+14.19
77TH STREET	STA. 30+14.75 TO STA. 40+68.52
BELOIT AVENUE	STA. 50+15.08 TO STA. 63+26.86
THOMAS AVENUE	STA. 80+13.78 TO STA. 93+27.82

HOT-MIX ASPHALT MIXTURE REQUIREMENTS

MIXTURE TYPE	AIR VOIDS
STABILIZED DRIVEWAY PAVEMENT	
HOT-MIX ASPHALT SURFACE COURSE, MIX "D", N50, (IL 9.5mm) 2 1/2"	4% @ 50 GYR
HOT-MIX ASPHALT - CURB PATCH	
HOT-MIX ASPHALT SURFACE COURSE, MIX "D", N50, (IL 9.5mm) 1 1/2"	4% @ 50 GYR
HOT-MIX ASPHALT PATCH (HMA BINDER IL-19.0mm); 7" (IN 3 LIFTS)	4% @ 70 GYR

NOTES:
 THE UNIT WEIGHT USED TO CALCULATE ALL HMA SURFACE MIXTURE QUANTITIES IS 112 LBS/SY/IN.
 THE 'AC TYPE' FOR POLYMERIZED HMA MIXES SHALL BE 'SBS/SBR PG 76-22' AND FOR NON-POLYMERIZED HMA THE 'AC-TYPE' SHALL BE 'PG 64-22' UNLESS MODIFIED BY DISTRICT ONE SPECIAL PROVISIONS. FOR "PERCENT OF RAP" SEE DISTRICT ONE SPECIAL PROVISIONS.

FILE NAME = 10426-TYPX-01 - P01

USER NAME =	DESIGNED -- JPH	REVISED --
	CHECKED -- PKB	REVISED --
PLOT SCALE =	DRAWN -- KWM / RG	REVISED --
PLOT DATE = 02-01-13	CHECKED -- AG	REVISED --

STATE OF ILLINOIS
 DEPARTMENT OF TRANSPORTATION

VILLAGE OF BRIDGEVIEW PROPOSED SIDEWALK IMPROVEMENTS TYPICAL CROSS SECTIONS		F.A. RTE.	SECTION	COUNTY	TOTAL SHEETS	SHEET NO.
		N/A	12-00066-00-SW	COOK	11	3
SCALE:		SHEET NO. 3 OF 11 SHEETS		STA.	TO STA.	
		FED. ROAD DIST. NO. 1	ILLINOIS	FED. AID PROJECT	SRTS-4009(174)	

CONTRACT NO. 63800

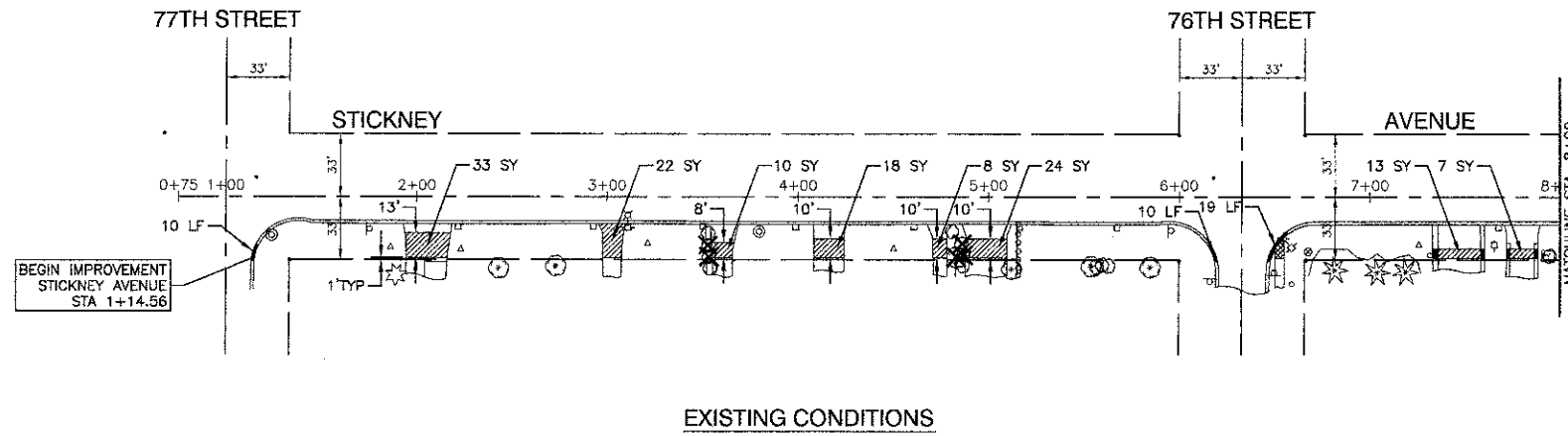

EXISTING CONDITIONS

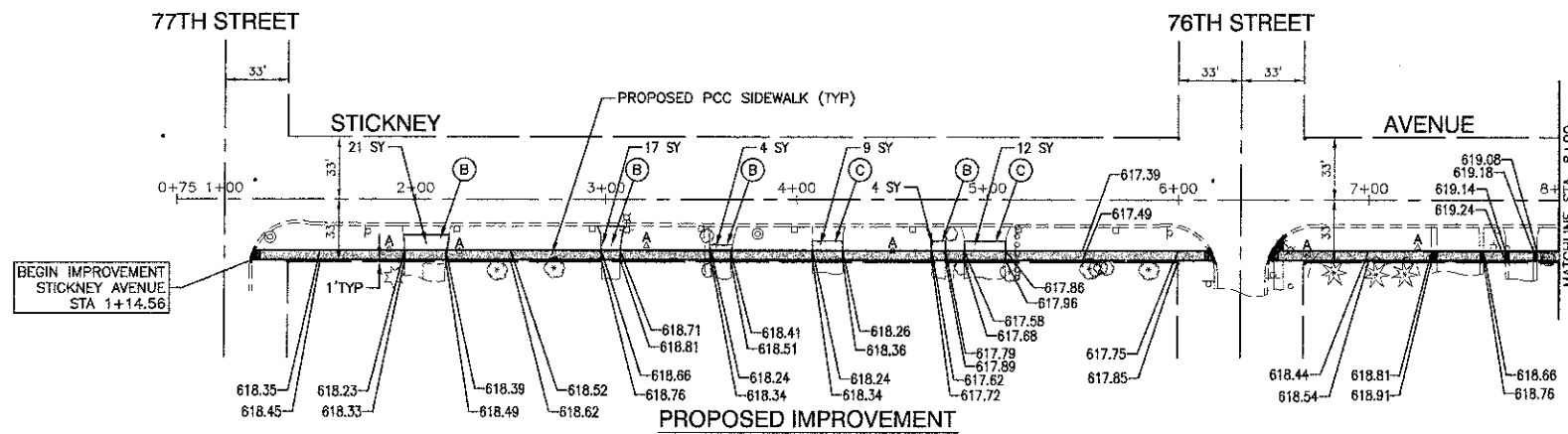

PROPOSED IMPROVEMENT

LEGEND

- CURB REMOVAL & REPLACEMENT
- SIDEWALK REMOVAL
- DRIVEWAY PAVEMENT REMOVAL
- PORTLAND CEMENT CONCRETE SIDEWALK, 5" (6" THROUGH DRIVEWAYS) AGGREGATE BASE COURSE, TYPE B, 3"
- DETECTABLE WARNINGS
- ADJUST STRUCTURE
- STABILIZED DRIVEWAY PAVEMENT
- PCC DRIVEWAY PAVEMENT, 6"
- TREE / SHRUB REMOVAL

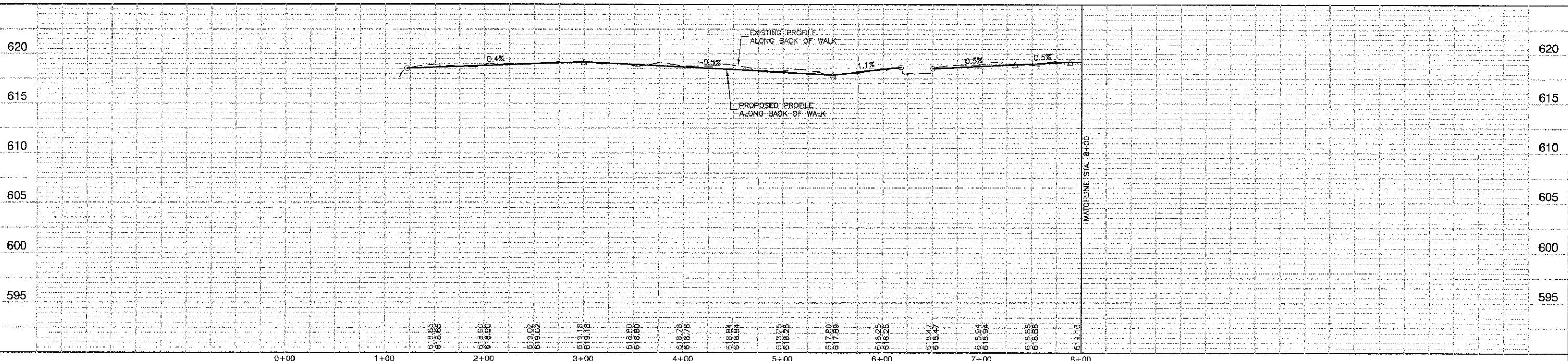

PLAN

BY	DATE
SURVEYED	
ALIGNED	
CHECKED	
NOTE BOOK	
NO.	

PROFILE

BY	DATE
SURVEYED	
GRADES CHECKED	
NOTE BOOK	
NO.	

STATE OF ILLINOIS
DEPARTMENT OF TRANSPORTATION

VILLAGE OF BRIDGEVIEW
PROPOSED SIDEWALK IMPROVEMENTS
SIDEWALK PLAN & PROFILE

F.A. RTE.	SECTION	COUNTY	TOTAL SHEETS	SHEET NO.
N/A	12-00068-00-SW	COOK	11	4
CONTRACT NO. 63800				

SCALE: SHEET NO. 4 OF 11 SHEETS STA. TO STA.

FED. ROAD DIST. NO. 1 ILLINOIS FED. AID PROJECT SRTS-4009(174)

FILE NAME = 10426-PLFR01 - IDOT PLFR01

USER NAME =	DESIGNED -- JPH	REVISED --
PLOT SCALE =	CHECKED -- PKB	REVISED --
PLOT DATE = 02-01-13	DRAWN -- KWM / PS	REVISED --
	CHECKED -- AG	REVISED --

DATE	
BY	
SURVEYED	
PLOTTED	
ALIGNED	
CHECKED	
NOTED	
FILE NAME	
PLAN	
NOTE BOOK	
NO.	

DATE	
BY	
SURVEYED	
PLOTTED	
GRADES CHECKED	
NOTED	
PROFILE	
NOTE BOOK	
NO.	

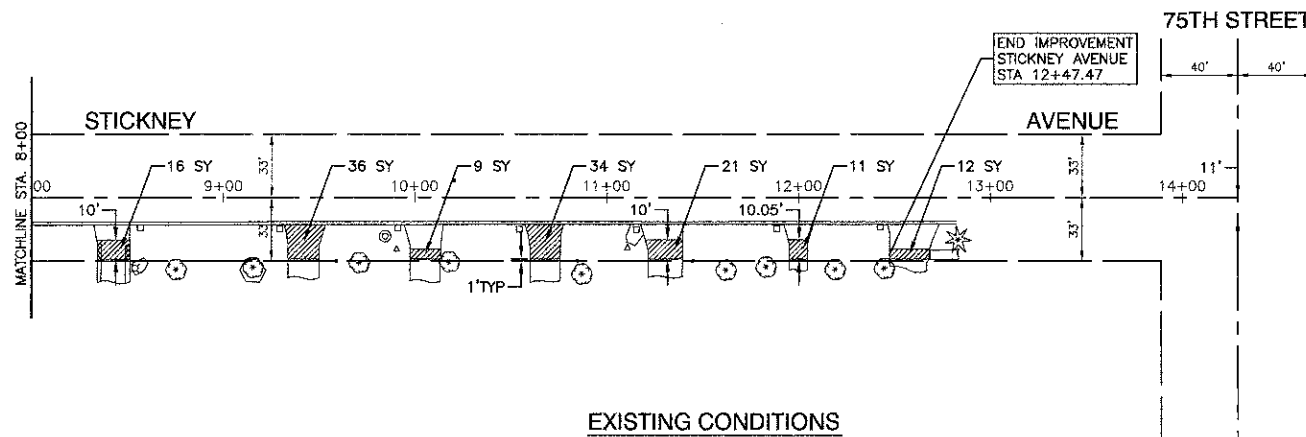

EXISTING CONDITIONS

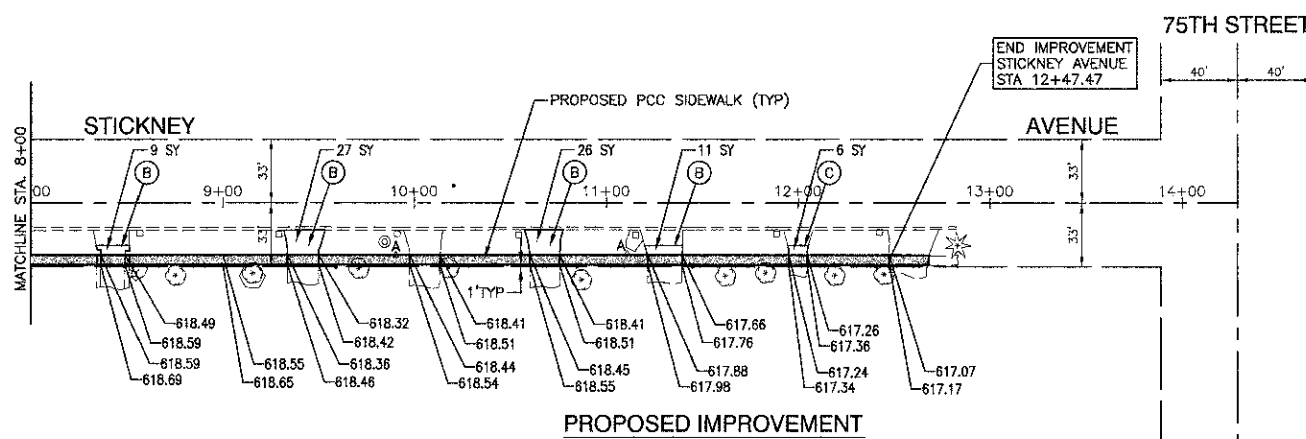

PROPOSED IMPROVEMENT

LEGEND

- CURB REMOVAL & REPLACEMENT
- SIDEWALK REMOVAL
- DRIVEWAY PAVEMENT REMOVAL
- PORTLAND CEMENT CONCRETE SIDEWALK, 5" (6" THROUGH DRIVEWAYS) AGGREGATE BASE COURSE, TYPE B, 3"
- DETECTABLE WARNINGS
- ADJUST STRUCTURE
- STABILIZED DRIVEWAY PAVEMENT
- PCC DRIVEWAY PAVEMENT, 6"
- TREE / SHRUB REMOVAL

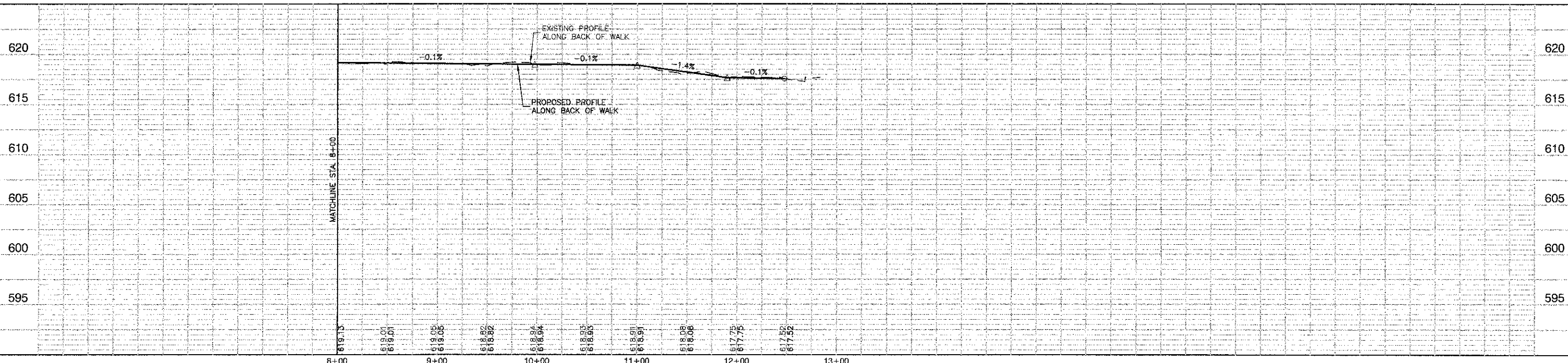

FILE NAME = 10428-PLPR-01 - IDOT PLPR02

USER NAME =	DESIGNED -- JPH	REVISED --
	CHECKED -- PKB	REVISED --
PLOT SCALE =	DRAWN -- KWM / PS	REVISED --
PLOT DATE = 02-01-13	CHECKED -- AG	REVISED --

STATE OF ILLINOIS
DEPARTMENT OF TRANSPORTATION

VILLAGE OF BRIDGEVIEW
PROPOSED SIDEWALK IMPROVEMENTS
SIDEWALK PLAN & PROFILE

SCALE: SHEET NO. 5 OF 11 SHEETS STA. TO STA.

F.A. RTE.	SECTION	COUNTY	TOTAL SHEETS	SHEET NO.
N/A	12-00066-00-SW	COOK	11	5
CONTRACT NO. 63800				
FED. ROAD DIST. NO. 1 ILLINOIS FED. AID PROJECT SRTS-4009(174)				



PLAN	SURVEYED	DATE
	PLOTTED	
	CHECKED	
	BY	
	NOTE BOOK NO.	
	DATE	

PROFILE	SURVEYED	DATE
	PLOTTED	
	CHECKED	
	BY	
	NOTE BOOK NO.	
	DATE	

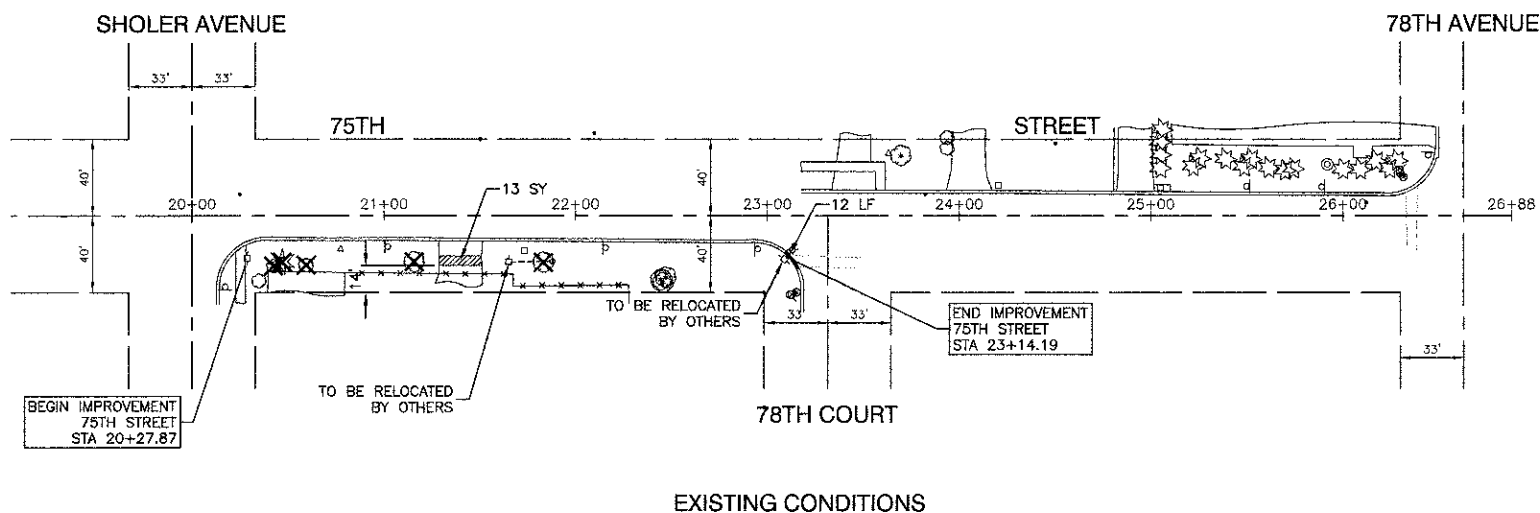

EXISTING CONDITIONS

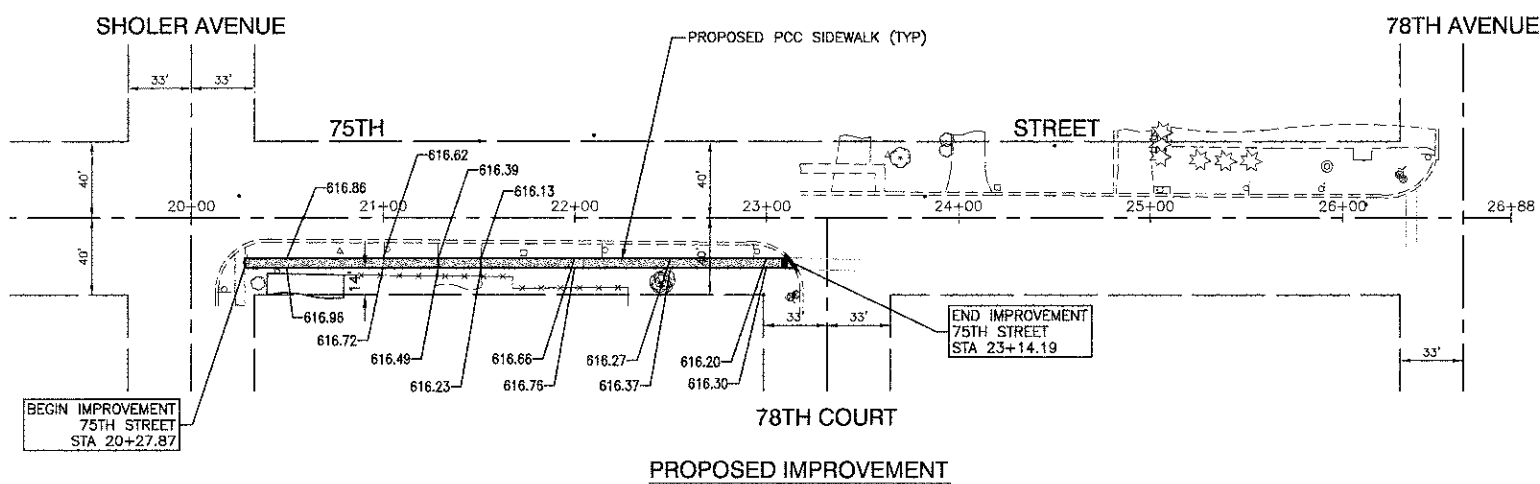

PROPOSED IMPROVEMENT

LEGEND

- CURB REMOVAL & REPLACEMENT
- SIDEWALK REMOVAL
- DRIVEWAY PAVEMENT REMOVAL
- PORTLAND CEMENT CONCRETE SIDEWALK, 5" (6" THROUGH DRIVEWAYS) AGGREGATE BASE COURSE, TYPE B, 3"
- DETECTABLE WARNINGS
- A ADJUST STRUCTURE
- B STABILIZED DRIVEWAY PAVEMENT
- C PCC DRIVEWAY PAVEMENT, 6"
- TREE / SHRUB REMOVAL

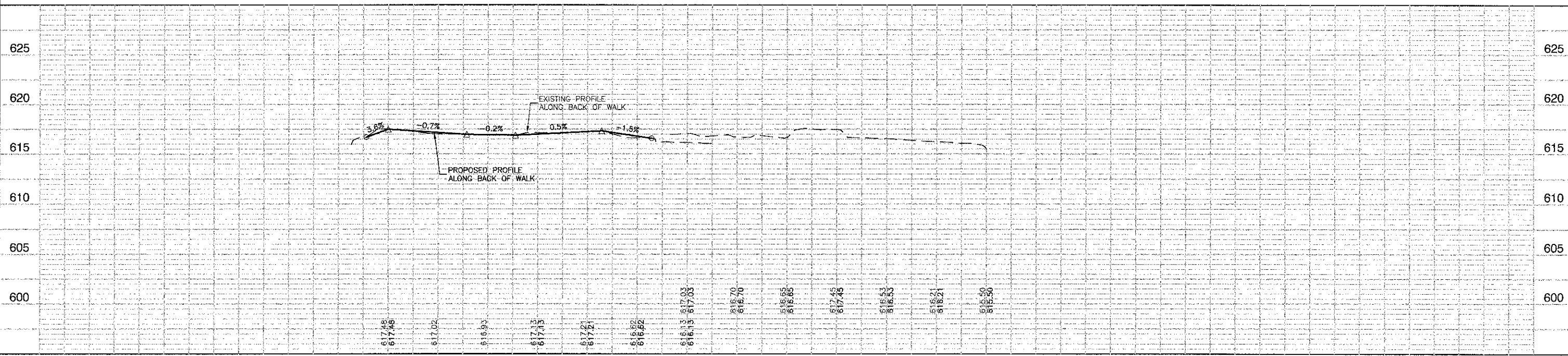

FILE NAME = 10425-FLPR-01 - IDOT FLP003	USER NAME =	DESIGNED - JPH	REVISED -	STATE OF ILLINOIS DEPARTMENT OF TRANSPORTATION	VILLAGE OF BRIDGEVIEW PROPOSED SIDEWALK IMPROVEMENTS SIDEWALK PLAN & PROFILE				F.A. RTE.	SECTION	COUNTY	TOTAL SHEETS	SHEET NO.
	PLOT SCALE =	CHECKED - PKB	REVISED -		N/A	12-00666-00-SW	COOK	11	6				
	PLOT DATE = 02-01-13	DRAWN - KWM / PS	REVISED -		SCALE: SHEET NO. 6 OF 11 SHEETS STA. TO STA.				CONTRACT NO. 63800				
		CHECKED - AG	REVISED -		FED. ROAD DIST. NO. 1 ILLINOIS FED. AID PROJECT SRTS-4009(174)								



DATE	
BY	
REVISIONS	
NO.	
DATE	
BY	
REVISIONS	
NO.	
DATE	
BY	
REVISIONS	
NO.	
DATE	
BY	
REVISIONS	
NO.	

DATE	
BY	
REVISIONS	
NO.	
DATE	
BY	
REVISIONS	
NO.	
DATE	
BY	
REVISIONS	
NO.	

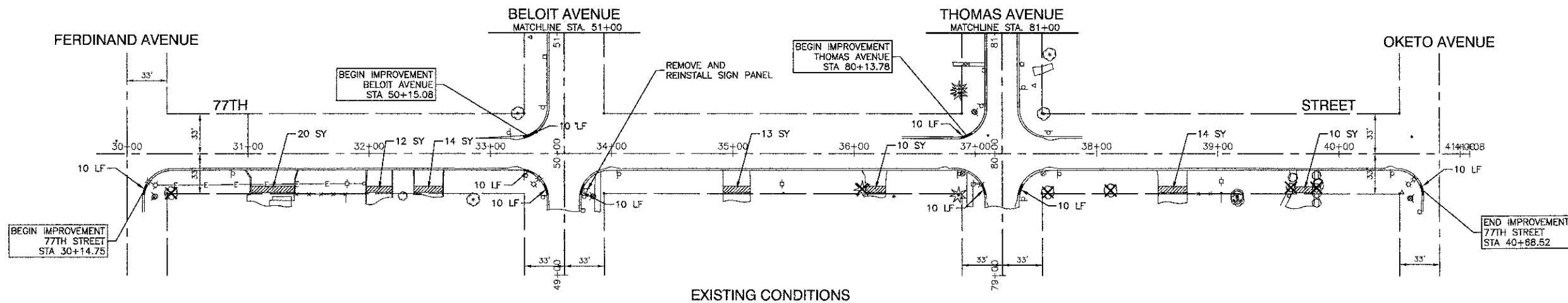

EXISTING CONDITIONS

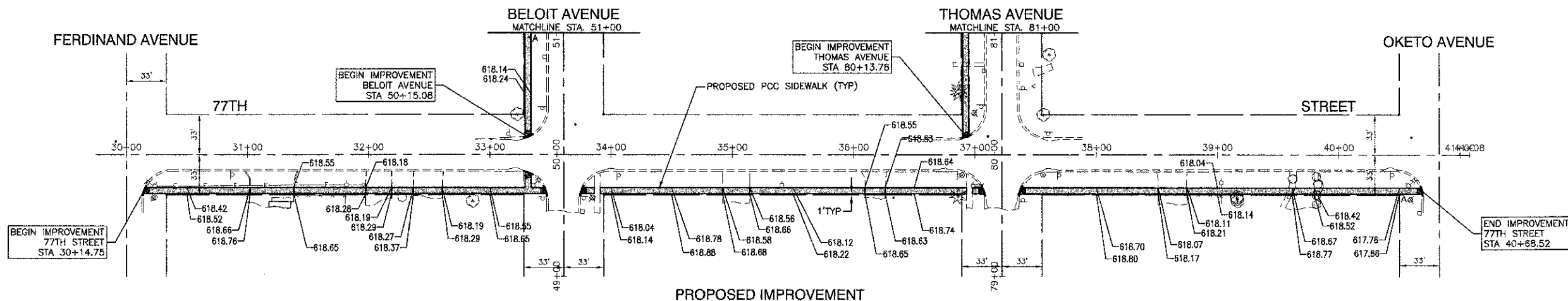

PROPOSED IMPROVEMENT

LEGEND

- CURB REMOVAL & REPLACEMENT
- SIDEWALK REMOVAL
- DRIVEWAY PAVEMENT REMOVAL
- PORTLAND CEMENT CONCRETE SIDEWALK, 5" (6" THROUGH DRIVEWAYS) AGGREGATE BASE COURSE, TYPE B, 3"
- DETECTABLE WARNINGS
- A ADJUST STRUCTURE
- B STABILIZED DRIVEWAY PAVEMENT
- C PCC DRIVEWAY PAVEMENT, 6"
- TREE / SHRUB REMOVAL

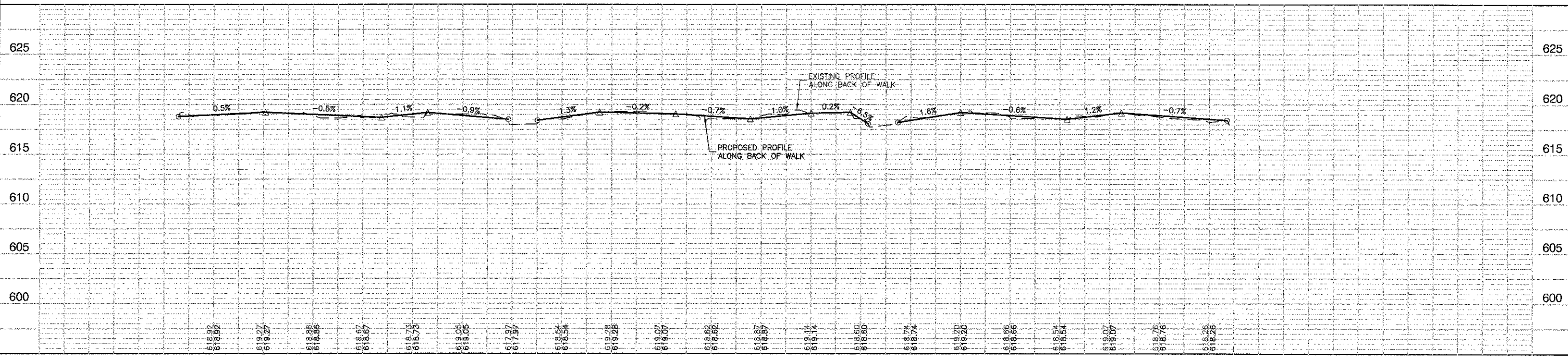

FILE NAME = 10428-PLPR-01 - ICOT PLR04	USER NAME =	DESIGNED - JPH	REVISED -	STATE OF ILLINOIS DEPARTMENT OF TRANSPORTATION	VILLAGE OF BRIDGEVIEW PROPOSED SIDEWALK IMPROVEMENTS SIDEWALK PLAN & PROFILE			F.A. RTE.	SECTION	COUNTY	TOTAL SHEETS	SHEET NO.
	PLOT SCALE =	CHECKED - PKB	REVISED -		N/A	12-00066-00-SW	COOK	11	7			
	PLOT DATE = 02-01-13	DRAWN - KWM / PS	REVISED -		CONTRACT NO. 63800			FED. ROAD DIST. NO. 1	ILLINOIS	FED. AID PROJECT	SRTS-4002(174)	
		CHECKED - AG	REVISED -		SCALE:	SHEET NO. 7	OF 11 SHEETS	STA.	TO STA.			

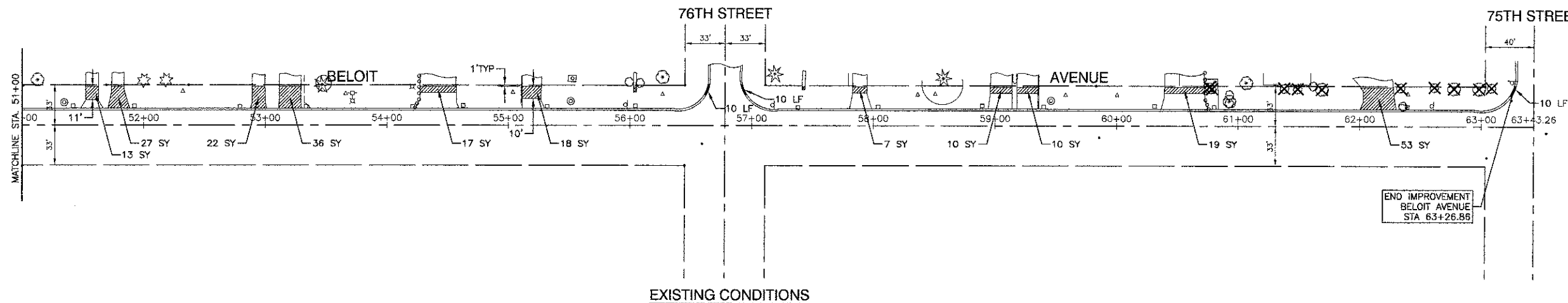
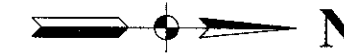

EXISTING CONDITIONS

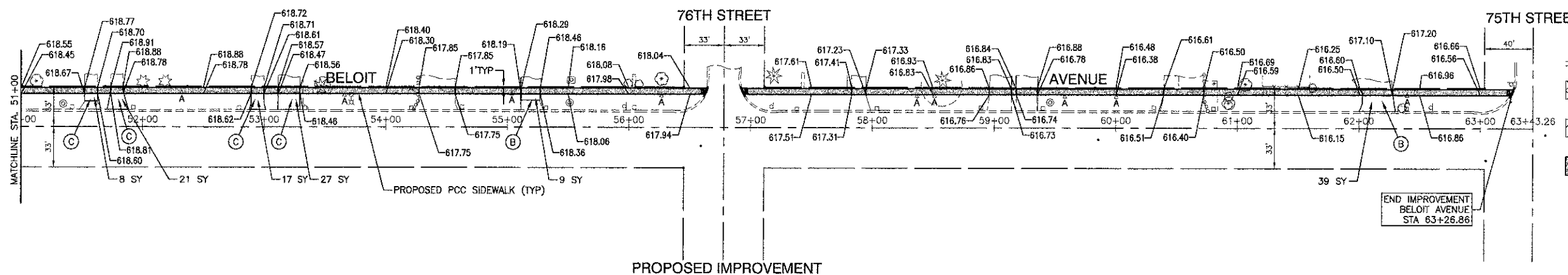

PROPOSED IMPROVEMENT

- LEGEND**
- CURB REMOVAL & REPLACEMENT
 - SIDEWALK REMOVAL
 - DRIVEWAY PAVEMENT REMOVAL
 - PORTLAND CEMENT CONCRETE SIDEWALK, 5" (6" THROUGH DRIVEWAYS) AGGREGATE BASE COURSE, TYPE B, 3"
 - DETECTABLE WARNINGS
 - A ADJUST STRUCTURE
 - B STABILIZED DRIVEWAY PAVEMENT
 - C PCC DRIVEWAY PAVEMENT, 6"
 - TREE / SHRUB REMOVAL

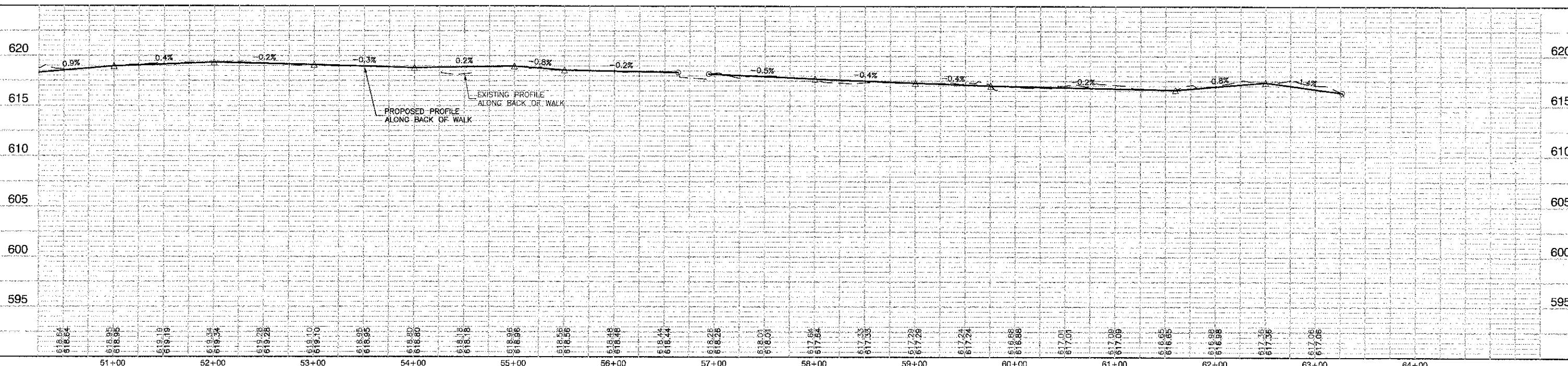

PLAN

DATE	
BY	
REVISIONS	
NO. 1	
NO. 2	
NO. 3	
NO. 4	
NO. 5	
NO. 6	
NO. 7	
NO. 8	
NO. 9	
NO. 10	

PROFILE

DATE	
BY	
REVISIONS	
NO. 1	
NO. 2	
NO. 3	
NO. 4	
NO. 5	
NO. 6	
NO. 7	
NO. 8	
NO. 9	
NO. 10	

FILE NAME = 10426-PLPR-01 - IDOT PLPR05	USER NAME =	DESIGNED -- JPH	REVISED --	STATE OF ILLINOIS DEPARTMENT OF TRANSPORTATION	VILLAGE OF BRIDGEVIEW PROPOSED SIDEWALK IMPROVEMENTS SIDEWALK PLAN & PROFILE				F.A. RTE. =	SECTION =	COUNTY =	TOTAL SHEETS =	SHEET NO. =
	PLOT SCALE =	CHECKED -- PKB	REVISED --		N/A	12-00066-00-SW	COOK	11	8				
	PLOT DATE = 02-01-13	DRAWN -- KWM / PS	REVISED --		SCALE: SHEET NO. 8 OF 11 SHEETS STA. TO STA.				CONTRACT NO. 63800				
		CHECKED -- AG	REVISED --		FED. ROAD DIST. NO. 1 ILLINOIS				FED. AID PROJECT SRTS-4009(174)				

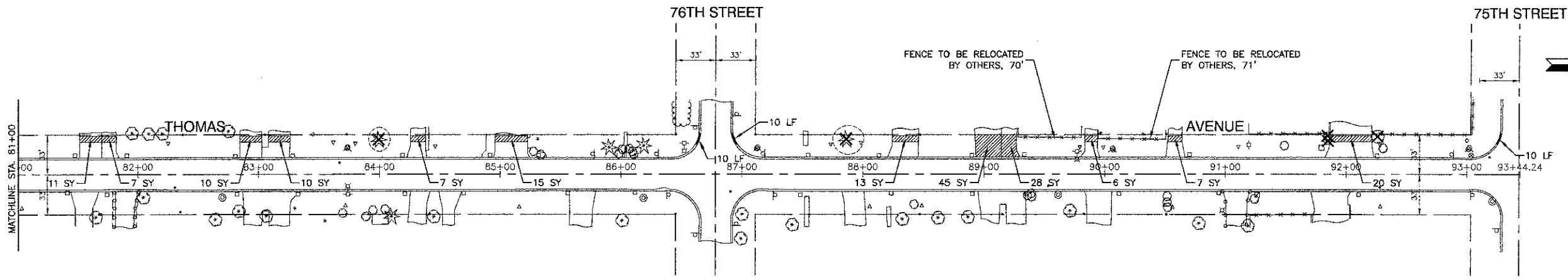

EXISTING CONDITIONS

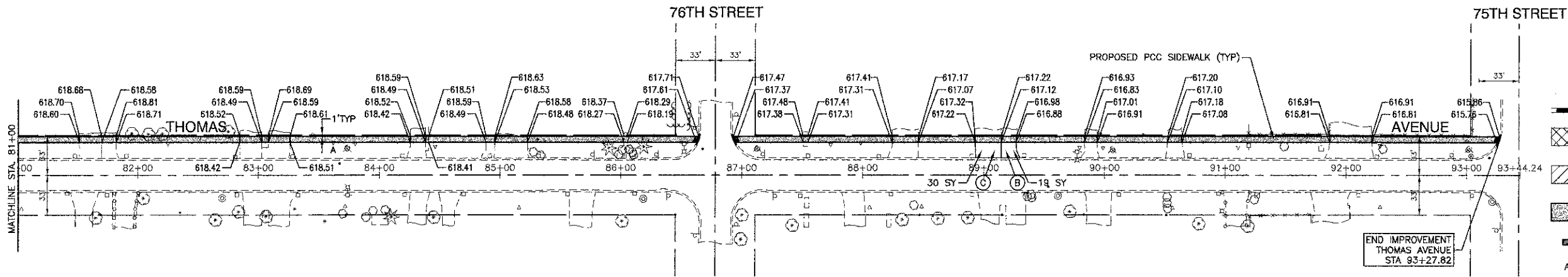

PROPOSED IMPROVEMENT

LEGEND

- CURB REMOVAL & REPLACEMENT
- SIDEWALK REMOVAL
- DRIVEWAY PAVEMENT REMOVAL
- PORTLAND CEMENT CONCRETE SIDEWALK, 5" (6" THROUGH DRIVEWAYS) AGGREGATE BASE COURSE, TYPE B, 3"
- DETECTABLE WARNINGS
- A ADJUST STRUCTURE
- B STABILIZED DRIVEWAY PAVEMENT
- C PCC DRIVEWAY PAVEMENT, 6"
- TREE / SHRUB REMOVAL

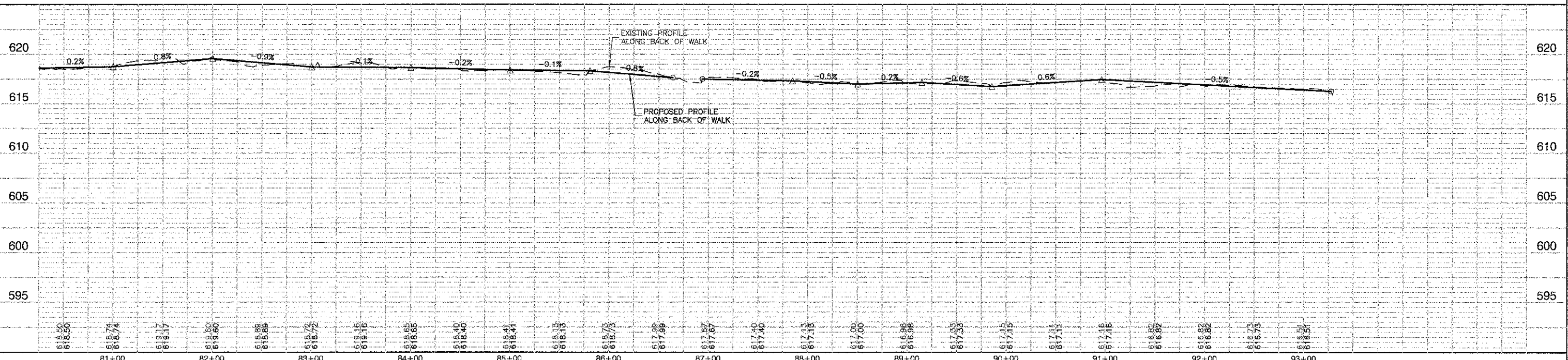

FILE NAME = 10426-PLPR-01 - IDOT PLPR06	USER NAME =	DESIGNED -- JPH	REVISED --	STATE OF ILLINOIS DEPARTMENT OF TRANSPORTATION	VILLAGE OF BRIDGEVIEW PROPOSED SIDEWALK IMPROVEMENTS SIDEWALK PLAN & PROFILE	F.A. RTE	SECTION	COUNTY	TOTAL SHEETS	SHEET NO.	
	PLOT SCALE =	CHECKED -- PKB	REVISED --			N/A	12-00066-00-SW	COOK	11	9	
	PLOT DATE = 02-01-13	DRAWN -- KWM / PS	REVISED --			SCALE: SHEET NO. 9 OF 11 SHEETS STA. TO STA.		CONTRACT NO. 63800			
		CHECKED -- AG	REVISED --			FED. ROAD DIST. NO. 1 ILLINOIS FED. AID PROJECT SRTS-4009(174)					

DATE	BY	SURVEYED	ALIGNMENT CHECKED	RT. OF WAY CHECKED	POD FILE NAME

DATE	BY	SURVEYED	GRADES CHECKED	B.M. NOTED

VARIABLE - TO MEET EXISTING DIMENSIONS AND FIELD CONDITIONS (SEE NOTE ②)

PROP. CONC. CURB OR CURB AND GUTTER REPLACEMENT IN ACCORDANCE WITH STATE STANDARD 606001. (SEE NOTE ②)

SAW CUT FULL DEPTH - INCLUDED IN THE COST OF SIDEWALK, DRIVEWAY OR MEDIAN SURFACE REMOVAL PAY ITEM.

SEE STATE STANDARD 606001
EXISTING OR PROPOSED HMA SURFACE (IF APPLICABLE)

18" (450) MAX.

1/4" (5) **

EXISTING SIDEWALK, DRIVEWAY, MEDIAN SURFACE, SOD OR GROUND.

PROPOSED SIDEWALK, DRIVEWAY PAVEMENT, MEDIAN SURFACE OR SODDING SALT TOLERANT WITH TOP SOIL, 4" (100) SOD RESTORATION (SEE NOTE ①).

EXISTING CONCRETE PAVEMENT, CONCRETE BASE COURSE OR FLEXIBLE PAVEMENT

3" (75) MIN.

SUITABLE BACKFILL MATERIAL (INCLUDED IN THE COST OF CURB OR CURB AND GUTTER REMOVAL AND REPLACEMENT)

PROPOSED 3/4" (20) PREFORMED EXPANSION JOINT AT CONCRETE SIDEWALKS, DRIVEWAYS, AND MEDIANS. (INCLUDED IN THE COST OF CURB OR CURB AND GUTTER REMOVAL AND REPLACEMENT.)

* 3" (75) MINIMUM FROM TOP AND BOTTOM OF THE CONCRETE PAVEMENT OR BASE COURSE.

** IF THE FINAL SURFACE OF THE PAVEMENT IS CONCRETE, THE GUTTER IS TO BE FLUSH WITH THE PAVEMENT.

UNSUITABLE SUB-BASE MATERIAL TO BE REMOVED, IF DIRECTED BY THE ENGINEER, SHALL BE REPLACED WITH EITHER SUB-BASE GRANULAR MATERIAL, TYPE B OR ADDITIONAL THICKNESS OF CONCRETE.

REMOVAL AND REPLACEMENT 4" (100) OR LESS IS INCLUDED IN THE COST OF CURB OR CURB AND GUTTER REMOVAL AND REPLACEMENT.

REMOVAL AND REPLACEMENT IN EXCESS OF 4" (100) WILL BE PAID FOR IN ACCORDANCE WITH ARTICLE 109.04 OF THE STANDARD SPECIFICATIONS.

NOTE: ① SIDEWALK, DRIVEWAY PAVEMENT OR MEDIAN SURFACE SHALL BE SIMILAR TO THE MATERIAL BEING REMOVED AND WILL BE PAID FOR SEPARATELY.

SODDING, SALT TOLERANT AND TOP SOIL, FURNISH AND PLACE 4" WILL BE PAID FOR SEPARATELY,

② FERTILIZER FOR THE PLACEMENT OF THE SOD IS NOT REQUIRED

③ CURB OR CURB AND GUTTER REPLACEMENT SHALL MATCH THE SHAPE OF THE EXISTING CURB OR CURB AND GUTTER UNLESS OTHERWISE SPECIFIED.

④ FOR CURB OR CURB AND GUTTER REMOVAL AND REPLACEMENT ADJACENT TO FLEXIBLE PAVEMENT DELETE EPOXY COATED TIE BARS.

⑤ LONGITUDINAL BARS, IF ENCOUNTERED IN THE EXISTING CURB OR CURB AND GUTTER, ARE NOT TO BE REPLACED. CUTTING AND REMOVING LONGITUDINAL BARS SHALL BE INCLUDED IN THE COST OF CURB OR CURB AND GUTTER REMOVAL AND REPLACEMENT.

⑥ THE COST OF HMA SURFACE REMOVAL IN THE EXISTING GUTTER FLAG SHALL BE INCLUDED IN THE COST OF THE CURB AND GUTTER REMOVAL AND REPLACEMENT.

⑦ THE REMOVAL AND REPLACEMENT OF THE EXISTING CURB OR CURB AND GUTTER SHALL BE DONE IN ACCORDANCE WITH THE APPLICABLE PORTIONS OF SECTION 440 AND 606 OF THE STANDARD SPECIFICATIONS.

⑧ THE LOCATIONS OF REMOVAL AND REPLACEMENT OF EXISTING CURB OR CURB AND GUTTER SHALL BE DETERMINED BY THE RESIDENT ENGINEER AT THE TIME OF CONSTRUCTION.

PROPOSED #6 (20) EPOXY COATED TIE BARS 24" (600) LONG AT 24" (600) CENTERS WILL NOT BE PAID FOR SEPARATELY. DELETE EPOXY COATED TIE BARS IF EXISTING TIE BARS ARE USUABLE AS DETERMINED BY THE ENGINEER. (SEE NOTE ③).

BASIS OF PAYMENT:

THIS WORK WILL BE PAID FOR AT THE CONTRACT UNIT PRICE PER FOOT (METER) FOR "CURB REMOVAL AND REPLACEMENT" OR "COMBINATION CONCRETE CURB AND GUTTER REMOVAL AND REPLACEMENT".

CURB OR CURB AND GUTTER REMOVAL AND REPLACEMENT

ALL DIMENSIONS ARE IN INCHES (MILLIMETERS) UNLESS OTHERWISE SHOWN.

FILE NAME = 10428-D7LS-01-BD24 - BD-24	USER NAME = drlvakosgn	DESIGNED - A. HOUSEH	REVISED - R. SHAH 10-03-96	STATE OF ILLINOIS DEPARTMENT OF TRANSPORTATION	CURB OR CURB AND GUTTER REMOVAL AND REPLACEMENT	F/A R/E	SECTION	COUNTY	TOTAL SHEETS	SHEET NO.	
	CHECKED -	REVISED - A. ABBAS 03-21-97				N/A	12-00086-00-SW	COOK	11	10	
	PLOT SCALE = 50.000' / IN.	DRAWN -	REVISED - M. GOMEZ 01-22-01			BD600-06 (BD-24)		CONTRACT NO. 63800			
	PLOT DATE = 12/15/2009	CHECKED - 03-11-94	REVISED - R. BORO 12-15-09			SCALE:		SHEET NO. 10 OF 11 SHEETS		STA. TO STA.	
						FED. ROAD DIST. NO. 1		ILLINOIS		FED. AID PROJECT SRTS-4009(174)	

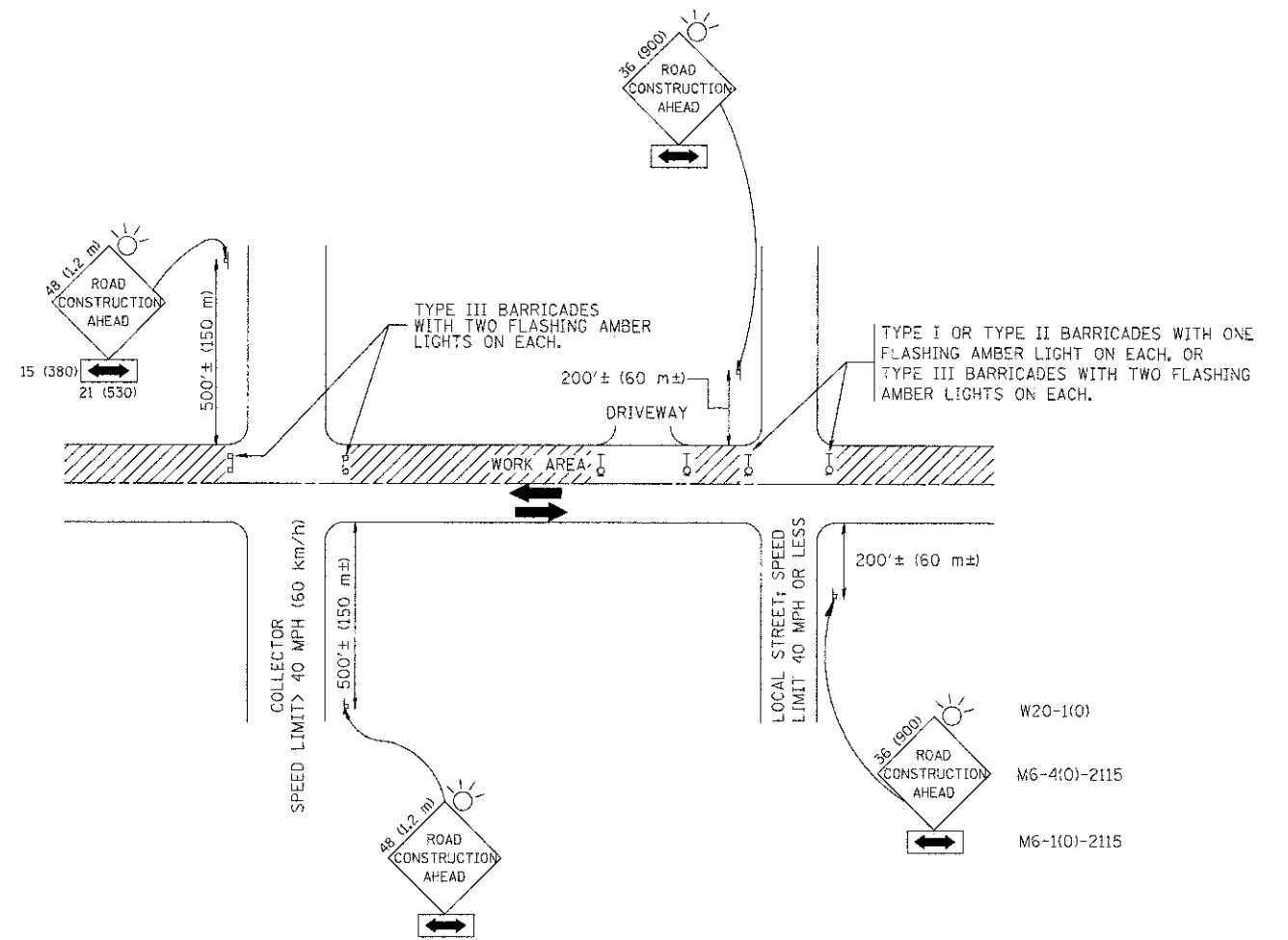

TRAFFIC CONTROL AND PROTECTION FOR SIDE ROADS, INTERSECTIONS, AND DRIVEWAYS

NOTES:

- A. FOR NO LANE RESTRICTION ON THE SIDE ROAD OR DRIVEWAYS
 1. SIDE ROAD WITH A SPEED LIMIT OF 40 MPH (60 km/h) OR LESS AS SHOWN ON THE DRAWING AND AS DIRECTED BY THE ENGINEER:
 - a) ONE **ROAD CONSTRUCTION AHEAD** SIGN 36 x 36 (900x900) WITH A FLASHER AND FLAG MOUNTED ON IT APPROXIMATELY 200' (60 m) IN ADVANCE OF THE MAIN ROUTE.
 - b) THE CLOSED PORTION OF THE MAIN ROUTE SHALL BE PROTECTED BY BLOCKING WITH TYPE I, TYPE II OR TYPE III BARRICADES, 1/3 OF THE CROSS SECTION OF THE CLOSED PORTION.
 2. SIDE ROAD WITH A SPEED LIMIT GREATER THAN 40 MPH (60 km/h) AS SHOWN ON THE DRAWING AND AS DIRECTED BY THE ENGINEER:
 - a) ONE **ROAD CONSTRUCTION AHEAD** SIGN 48 x 48 (1.2 m x 1.2 m) WITH A FLASHER MOUNTED ON IT APPROXIMATELY 500' (150 m) IN ADVANCE OF THE MAIN ROUTE.
 - b) THE CLOSED PORTION OF THE MAIN ROUTE SHALL BE PROTECTED BY BLOCKING WITH TYPE III BARRICADES, 1/2 OF THE CROSS SECTION OF THE CLOSED PORTION.
 3. WHEN THE SIDE ROAD LIES BETWEEN THE BEGINNING OF THE MAINLINE SIGNING AND THE WORK ZONE, A SINGLE HEADED ARROW (M6-1) SHALL BE USED IN LIEU OF THE DOUBLE HEADED ARROW (M6-4).
- B. FOR A LANE CLOSURE ON A SIDE ROAD OR DRIVEWAY:

USE APPLICABLE PORTIONS OF THE TYPICAL APPLICATION OF TRAFFIC CONTROL DEVICES (STD. 701501, STD. 701606 OR THE APPROPRIATE STANDARD). THE SPACING OF SIGNS AND BARRICADES SHALL BE ADJUSTED FOR FIELD CONDITIONS AS DIRECTED BY THE ENGINEER. THE DIRECTIONAL ARROW SHALL BE COVERED OR REMOVED WHEN NO LONGER CONSISTENT WITH THE SIDE ROAD LANE CLOSURE.
- C. ADVANCE WARNING SIGNS ARE TO BE OMITTED ON DRIVEWAY UNLESS OTHERWISE NOTED.
- D. THE TRAFFIC CONTROL AND PROTECTION FOR SIDE ROADS, INTERSECTIONS, AND DRIVEWAYS SHALL BE INCIDENTAL TO THE COST OF SPECIFIED TRAFFIC CONTROL STANDARDS OR ITEMS.

All dimensions are in millimeters (inches) unless otherwise shown.

FILE NAME = 10428-DTLR-08-TC10 - TC-10	USER NAME = goghanobt	DESIGNED -- LHA	REVISED -- J. OBERLE 10-18-95
		CHECKED --	REVISED -- A. HOUSEH 03-06-96
	PLOT SCALE = 58.000' / IN.	DRAWN --	REVISED -- A. HOUSEH 10-15-96
	PLOT DATE = 1/4/2008	CHECKED -- 06-89	REVISED -- F. RAMMACHER 01-06-00

STATE OF ILLINOIS
DEPARTMENT OF TRANSPORTATION

TRAFFIC CONTROL AND PROTECTION FOR SIDE ROADS, INTERSECTIONS, AND DRIVEWAYS		F.A. RTE.	SECTION	COUNTY	TOTAL SHEETS	SHEET NO.
SCALE:		N/A	12-00086-00-SW	COOK	11	11
SHEET NO. 11 OF 11 SHEETS		TC-10		CONTRACT NO. 63800		
STA. TO STA.		FED. ROAD DIST. NO. 1 ILLINOIS FED. AID PROJECT SRTS-4009(174)				