

EXISTING CONDITIONS

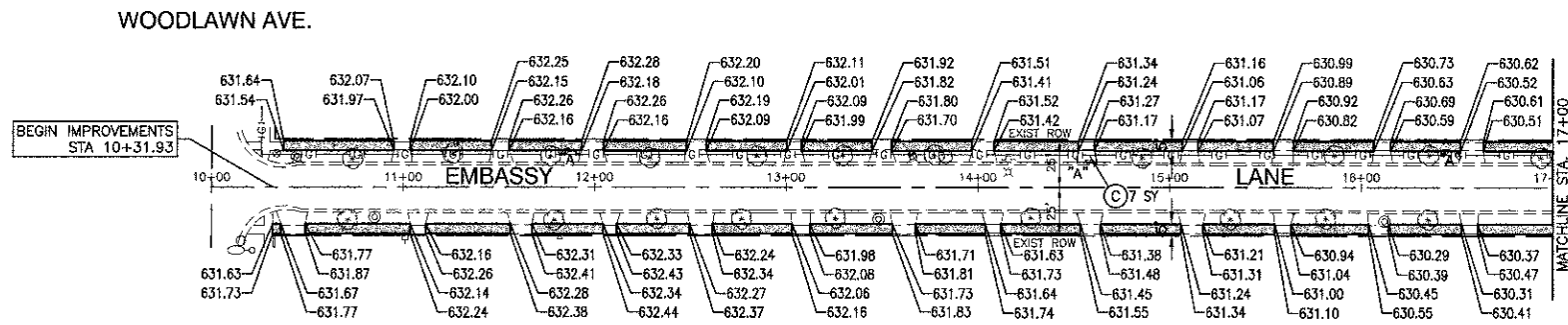

PROPOSED IMPROVEMENT

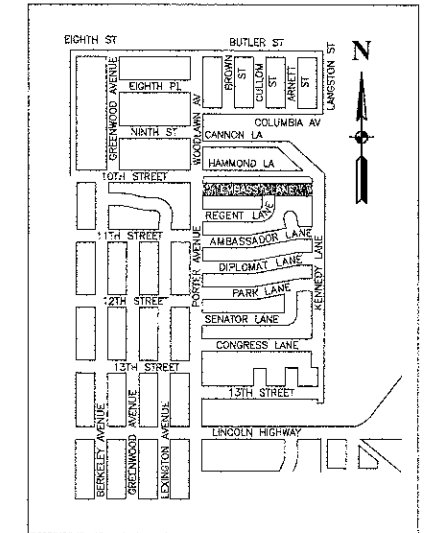

LOCATION MAP
NOT TO SCALE

LEGEND

- CURB REMOVAL & REPLACEMENT
- SIDEWALK REMOVAL
- DRIVEWAY PAVEMENT REMOVAL
- PORTLAND CEMENT CONCRETE SIDEWALK, 5"
AGGREGATE BASE COURSE, TYPE B, 3"
- DETECTABLE WARNINGS
- HOT-MIX ASPHALT DRIVEWAY PAVEMENT, 4"
- STABILIZED DRIVEWAY PAVEMENT
- DOMESTIC WATER SERVICE BOXES TO BE ADJUSTED
- MANHOLES TO BE ADJUSTED

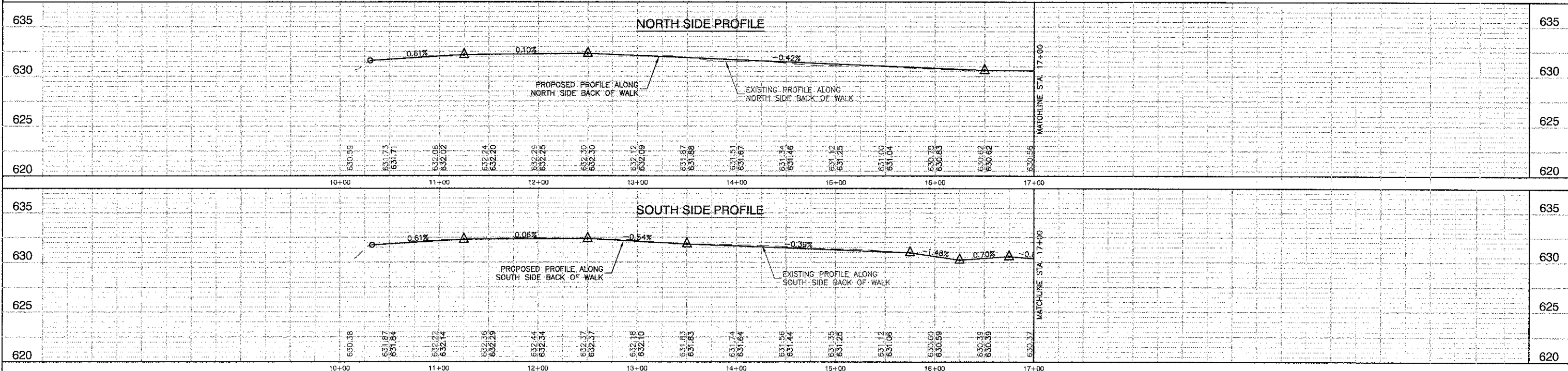

FILE NAME = I2594-PLPR-02 IDOT P01	USER NAME =	DESIGNED = JPH/TAG	REVISED =	STATE OF ILLINOIS DEPARTMENT OF TRANSPORTATION	SIDEWALK CONSTRUCTION VILLAGE OF FORD HEIGHTS EMBASSY LANE SIDEWALK PLAN AND PROFILE	F.A.U. RTE. =	SECTION =	COUNTY =	TOTAL SHEETS =	SHEET NO. =	
PLOT SCALE = 1"=50'	CHECKED = PKB	DRAWN = LTL/RG	REVISED =			N/A	07-00010-01-SW	COOK	8	4	
PLOT DATE = 02-01-13	CHECKED = AG	REVISED =				SCALE: H 1"=60' V 1"=5' SHEET NO. 4 OF 8 SHEETS STA. 10+31.93 TO STA. 17+00					
						FED. ROAD DIST. NO. 1 ILLINOIS FED. AID PROJECT CONTRACT NO. 63802					