

STATE OF ILLINOIS
DEPARTMENT OF TRANSPORTATION
DIVISION OF HIGHWAYS

| | | | | |
|-----------------------|----------------|------------------|--------------|-----------|
| F. A. L. NO. | SECTION | COUNTY | TOTAL SHEETS | SHEET NO. |
| N/A | 07-00010-01-SW | COOK | 8 | 1 |
| STA. | TO STA. | | | |
| FED. ROAD DIST. NO. 1 | LANE(S) | FED. AID PROJECT | | |

CONTRACT #63802

INDEX OF SHEETS

- 1 COVER SHEET, INDEX OF SHEETS & STATE STANDARDS
- 2 SUMMARY OF QUANTITIES & GENERAL NOTES
- 3 TYPICAL CROSS SECTIONS
- 4-8. SIDEWALK PLAN AND PROFILE

**PLANS FOR PROPOSED
FEDERAL AID HIGHWAY**

**PARK AVENUE, EMBASSY LANE & AMBASSADOR LANE
SIDEWALK CONSTRUCTION**

STATE STANDARDS

- 424001-07 PERPENDICULAR CURB RAMPS FOR SIDEWALKS
- 606001-05 CONCRETE CURB TYPE B AND COMBINATION CONCRETE CURB AND GUTTER
- 701006-04 OFF-RD OPERATIONS, 2L, 2W, 15' TO 24" FROM PAVEMENT EDGE
- 701801-05 SIDEWALK, CORNER OR CROSSWALK CLOSURE
- 701901-02 TRAFFIC CONTROL DEVICES

**SECTION NO.: 07-00010-01-SW
VILLAGE OF FORD HEIGHTS
COOK COUNTY
JOB NO.: C-91-186-11**

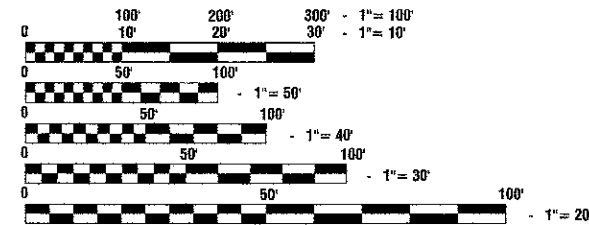
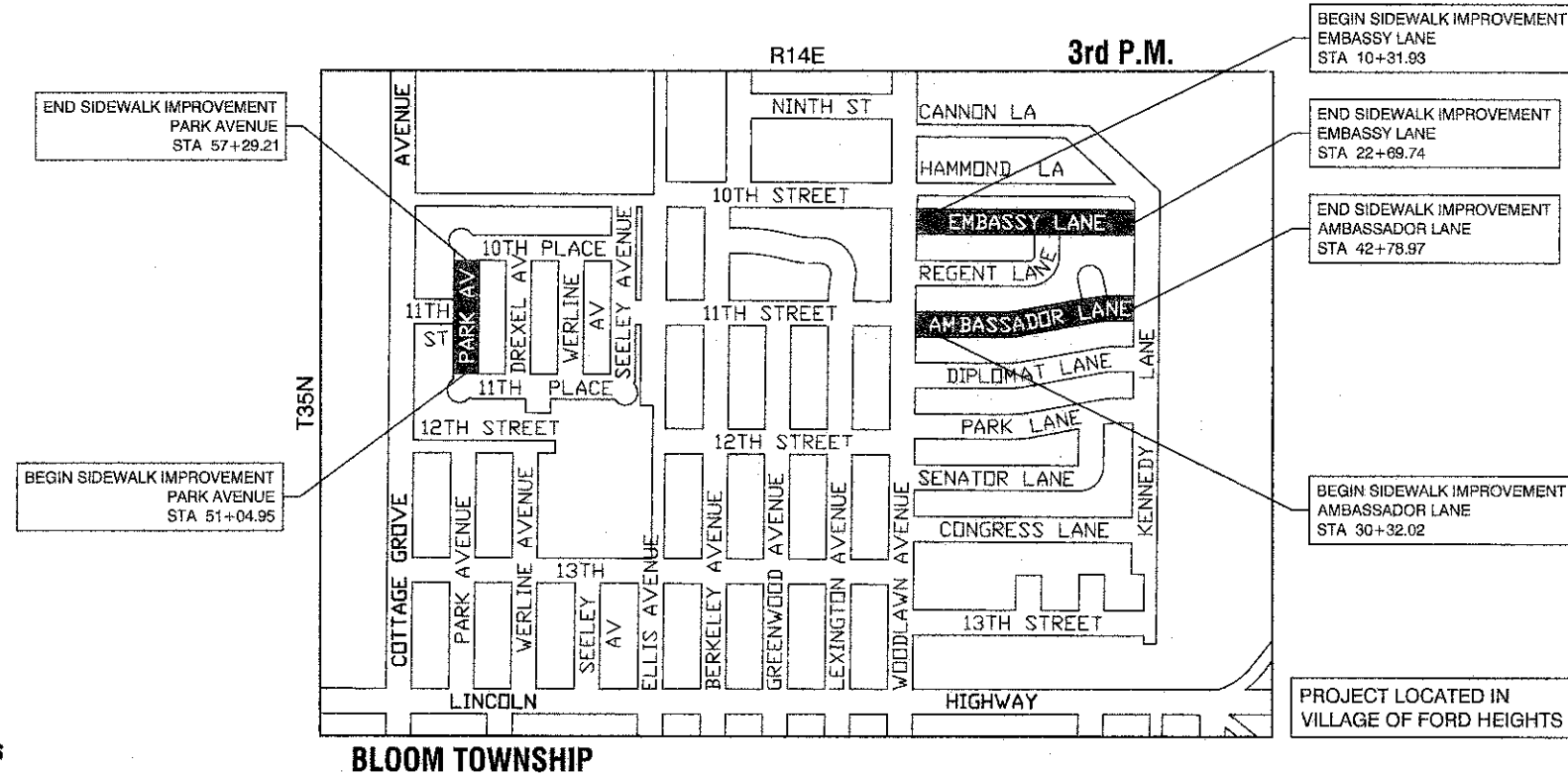
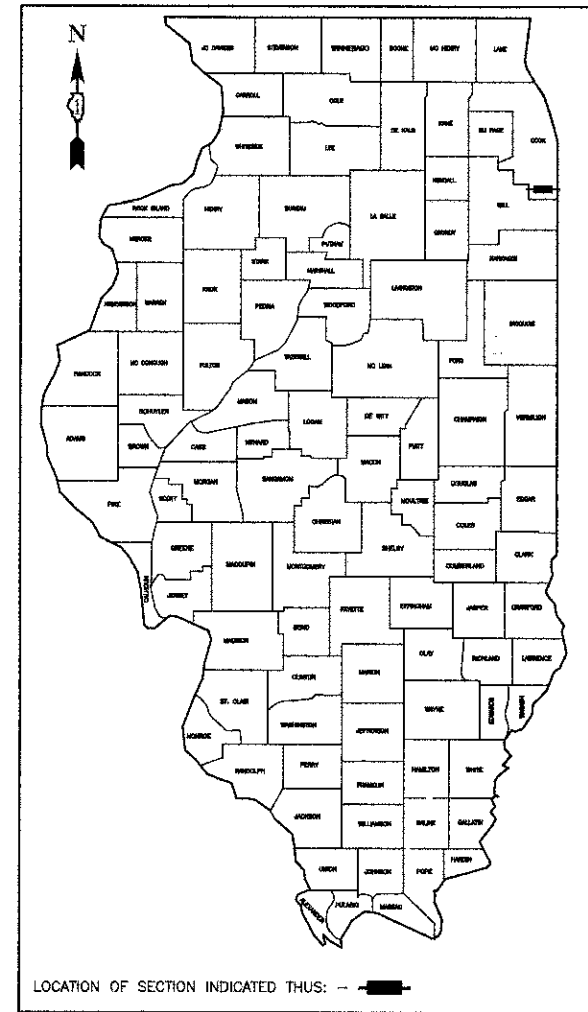

FULL SIZE PLANS HAVE BEEN PREPARED USING STANDARD ENGINEERING SCALES, REDUCED SIZED PLANS WILL NOT CONFORM TO STANDARD SCALES, IN MAKING MEASUREMENTS ON REDUCED PLANS, THE ABOVE SCALES MAY BE USED.

J. U. L. I. E.
JOINT UTILITY LOCATION INFORMATION FOR EXCAVATION
1-800-892-0123 or 811

CONTRACT NO. 63802

LOCATION MAP

N.T.S

- INDICATES PROPOSED IMPROVEMENT

GROSS LENGTH= 3,108.02 FEET = 0.59 MILES
NET LENGTH= 3,108.02 FEET = 0.59 MILES

STATE OF ILLINOIS DEPARTMENT OF TRANSPORTATION
DIVISION OF HIGHWAYS

Approved:
President, Village of Ford Heights

Passed: **FEBRUARY 25, 2013**

District 1 Engineer of Local Roads & Streets

Released for Bid Based on Limited Review: **February 27, 2013**

Deputy Director of Highways, Region 1 Engineer

PRINTED BY THE AUTHORITY OF
THE STATE OF ILLINOIS

PREPARED BY OR UNDER THE
DIRECT SUPERVISION OF:

1/30/2013



PROGRAM AND OFFICE ENGINEER: CHARLES F. RIDDLE, P.E. (847)-705-4406, SCHAMBOURG, IL
CONSULTANTS: ROBINSON ENGINEERING, LTD. 708-331-6700

| | | |
|-----------|-----------|------|
| PLAN | SURVEYED | DATE |
| NOTE BOOK | PLOTTED | BY |
| NO. | FILED | |
| | REVISIONS | |
| | BY | |
| | DATE | |

| | | |
|-----------|-----------|------|
| PROFILE | SURVEYED | DATE |
| NOTE BOOK | PLOTTED | BY |
| | REVISIONS | |
| | BY | |
| | DATE | |

| SUMMARY OF QUANTITIES | | | | | CONSTRUCTION TYPE CODE |
|-----------------------|----------|---|-------|-------|------------------------|
| S.I. | CODE NO. | PAY ITEM | UNIT | QUAN | 0021 |
| | 21101615 | TOPSOIL FURNISH AND PLACE, 4" | SQ YD | 800 | 800 |
| ~ | 25000100 | SEEDING, CLASS 1 | ACRE | 0.25 | 0.25 |
| | 35101598 | AGGREGATE BASE COURSE, TYPE B 3" | SQ YD | 2562 | 2562 |
| | 42300200 | PORTLAND CEMENT CONCRETE DRIVEWAY PAVEMENT, 6 INCH | SQ YD | 7 | 7 |
| ~ | 42400200 | PORTLAND CEMENT CONCRETE SIDEWALK 5 INCH | SQ FT | 25197 | 25197 |
| ~ | 42400300 | PORTLAND CEMENT CONCRETE SIDEWALK 6 INCH | SQ FT | 90 | 90 |
| ~ | 42400800 | DETECTABLE WARNINGS | SQ FT | 80 | 80 |
| | 44000200 | DRIVEWAY PAVEMENT REMOVAL | SQ YD | 24 | 24 |
| ~ | 44000600 | SIDEWALK REMOVAL | SQ FT | 21722 | 21722 |
| ~ | 56500600 | DOMESTIC WATER SERVICE BOXES TO BE ADJUSTED | EACH | 26 | 26 |
| | 60255500 | MANHOLES TO BE ADJUSTED | EACH | 5 | 5 |
| | 67100100 | MOBILIZATION | L SUM | 1 | 1 |
| | 70102640 | TRAFFIC CONTROL AND PROTECTION, STANDARD 701801 | L SUM | 1 | 1 |
| ~ | X2020410 | EARTH EXCAVATION (SPECIAL) | CU YD | 87 | 87 |
| ~ | XX008200 | STABILIZED DRIVEWAY PAVEMENT | SQ YD | 8 | 8 |
| ~ | Z0004562 | COMBINATION CURB AND GUTTER REMOVAL AND REPLACEMENT | FOOT | 40 | 40 |

GENERAL NOTES:

- UTILITIES INDICATED ON THE PLANS ARE PROVIDED FOR THE CONTRACTORS USE AND ARE BASED UPON INFORMATION AVAILABLE AT THE TIME OF THE ADVERTISEMENT FOR BIDS. THE OWNER AND ENGINEER DO NOT GUARANTEE THE ACCURACY OF UTILITIES INFORMATION.
- BEFORE ANY EXCAVATION, THE CONTRACTOR SHALL CALL "JULIE" AT 1-800-892-0123 FOR FIELD LOCATIONS OF BURIED UTILITIES. (48 HOUR NOTIFICATION IS REQUIRED)
- THE CONTRACTOR SHALL COORDINATE CONSTRUCTION ACTIVITIES WITH UTILITY COMPANIES AND THE VILLAGE OF FORD HEIGHTS.
- BARRICADES: THE CONTRACTOR SHALL PROVIDE AND INSTALL TWO (2) WEIGHTED SANDBAGS ON EACH TYPE I OR TYPE II BARRICADE. USE ONE (1) WEIGHTED SAND BAG ACROSS EACH BOTTOM RAIL.
- ALL PAVEMENT, CURB, SIDEWALK AND DRIVEWAY REMOVALS SHALL BE MADE BY MEANS OF STRAIGHT SAW CUT JOINT. THE COST FOR SAW CUTTING SHALL BE INCLUDED IN THE COST OF THE INDIVIDUAL ITEMS BEING REMOVED
- THE CONTRACTOR MAY PROSECUTE WORK BETWEEN THE HOURS OF 7:00 A.M. AND DUSK EACH WORKDAY. NO WORK WILL BE PERMITTED ON SUNDAYS, OR ON HOLIDAYS, WITHOUT PRIOR WRITTEN PERMISSION FROM THE VILLAGE OF FORD HEIGHTS.

* - INDICATES SPECIALTY ITEMS
 ~ - INDICATES SPECIAL PROVISIONS

FILE NAME = 12584-QUAN-01 - IDOT P01

| | | |
|----------------------|---------------------|---------------------|
| USER NAME = | DESIGNED -- JHS/TAG | REVISED -- 02-14-13 |
| | CHECKED -- PKB | REVISED -- |
| PLOT SCALE = N/A | DRAWN -- RG | REVISED -- |
| PLOT DATE = 02-01-13 | CHECKED -- AG | REVISED -- |

STATE OF ILLINOIS
 DEPARTMENT OF TRANSPORTATION

| | | | |
|---|-------------------------|------|---------|
| SIDEWALK CONSTRUCTION VILLAGE OF FORD HEIGHTS SUMMARY OF QUANTITIES & GENERAL NOTES | | | |
| SCALE: N/A | SHEET NO. 2 OF 6 SHEETS | STA. | TO STA. |

| | | | | |
|-----------------------|----------------|--------|--------------|------------------|
| F.A.U. RTE. | SECTION | COUNTY | TOTAL SHEETS | SHEET NO. |
| N/A | 07-00010-01-SW | COOK | 8 | 2 |
| FED. ROAD DIST. NO. 1 | | | ILLINOIS | FED. AID PROJECT |

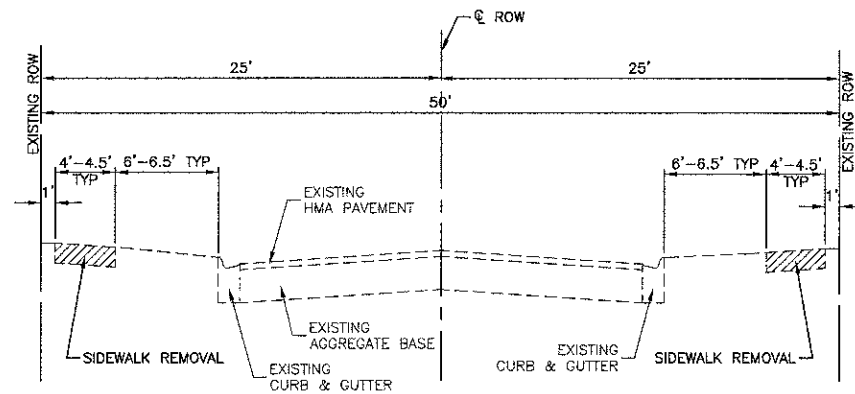

EXISTING TYPICAL SECTION

EMBASSY LANE, STA. 10+31.93 TO STA. 22+69.74
 AMBASSADOR LANE, STA. 30+32.02 TO STA. 42+78.97
 PARK AVENUE, STA. 51+04.95 TO STA. 57+29.21

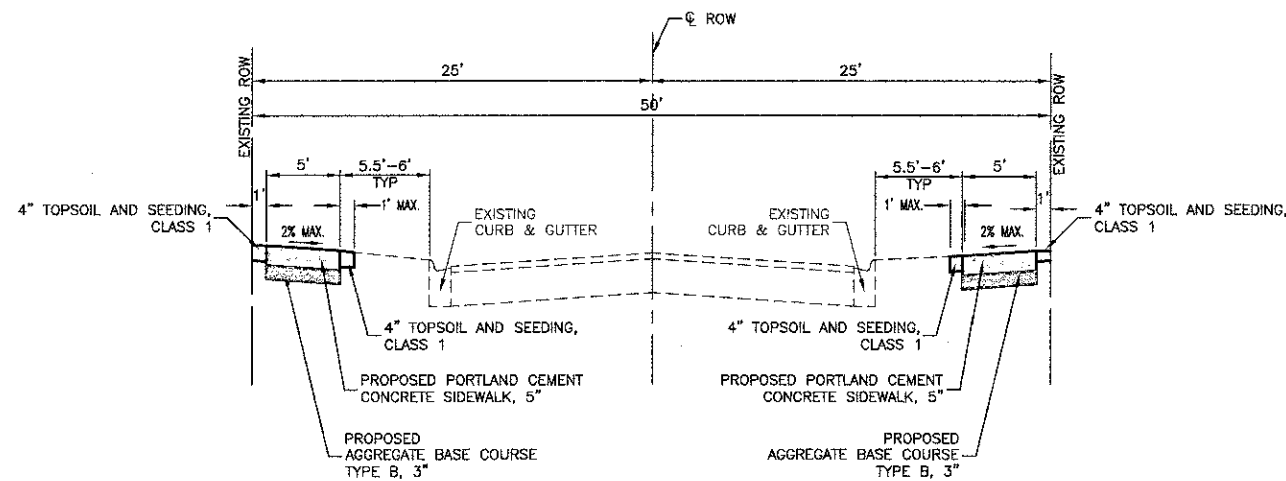

PROPOSED TYPICAL SECTION

EMBASSY LANE, STA. 10+31.93 TO STA. 22+69.74
 AMBASSADOR LANE, STA. 30+32.02 TO STA. 42+78.97
 PARK AVENUE, STA. 51+04.95 TO STA. 57+29.21

HOT-MIX ASPHALT MIXTURE REQUIREMENTS

| MIXTURE TYPE | AIR VOIDS |
|---|-------------|
| STABILIZED DRIVEWAY PAVEMENT | |
| HOT-MIX ASPHALT SURFACE COURSE, MIX "D", N50, (IL 9.5mm) 2 1/2" | 4% @ 50 GYR |
| HOT-MIX ASPHALT - CURB PATCH | |
| HOT-MIX ASPHALT SURFACE COURSE, MIX "D", N50, (IL 9.5mm) 1 1/2" | 4% @ 50 GYR |
| HOT-MIX ASPHALT PATCH (HMA BINDER IL-19.0mm) 7" (3 LIFTS) | 4% @ 70 GYR |

NOTES:
 THE UNIT WEIGHT USED TO CALCULATE ALL HMA SURFACE MIXTURE QUANTITIES IS 112 LBS/SY/IN.
 THE 'AC TYPE' FOR POLYMERIZED HMA MIXES SHALL BE 'SBS/SBR PG 76-22' AND FOR NON-POLYMERIZED HMA THE 'AC-TYPE' SHALL BE 'PG 64-22' UNLESS MODIFIED BY DISTRICT ONE SPECIAL PROVISIONS. FOR "PERCENT OF RAP" SEE DISTRICT ONE SPECIAL PROVISIONS.

FILE NAME = 12584-TYPK-01 - P01

| | | |
|----------------------|---------------------|------------|
| USER NAME = | DESIGNED -- JHS/TAG | REVISED -- |
| | CHECKED -- PKB | REVISED -- |
| PLOT SCALE = NTS | DRAWN -- KWM/RG | REVISED -- |
| PLOT DATE = 02-01-13 | CHECKED -- AG | REVISED -- |

STATE OF ILLINOIS
 DEPARTMENT OF TRANSPORTATION

SIDEWALK CONSTRUCTION
 VILLAGE OF FORD HEIGHTS
 TYPICAL CROSS SECTIONS

| | | | | |
|---|----------------|--------|--------------------|-----------|
| F.A.U. RTE. | SECTION | COUNTY | TOTAL SHEETS | SHEET NO. |
| N/A | 07-00010-01-SW | COOK | 8 | 3 |
| FED. ROAD DIST. NO. 1 ILLINOIS FED. AID PROJECT | | | CONTRACT NO. 63802 | |

SCALE: NTS SHEET NO. 3 OF 8 SHEETS STA. TO STA.

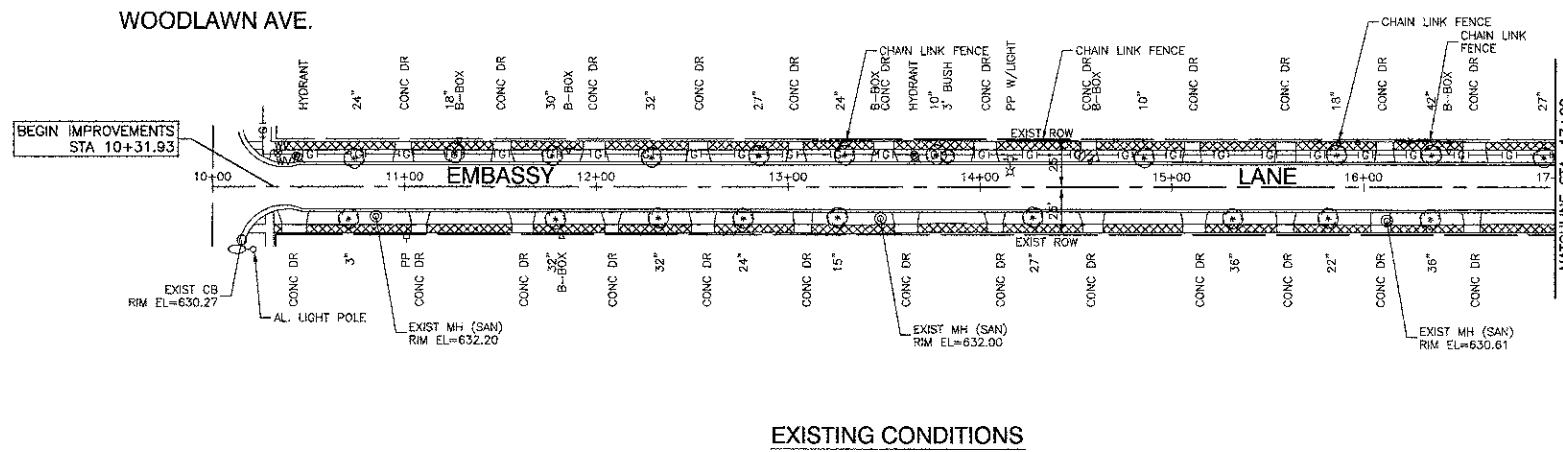

EXISTING CONDITIONS

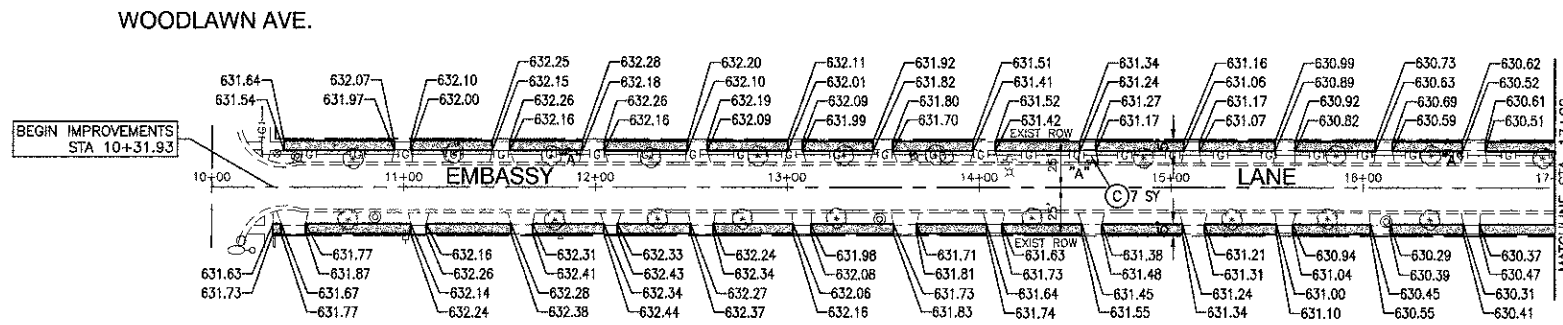

PROPOSED IMPROVEMENT

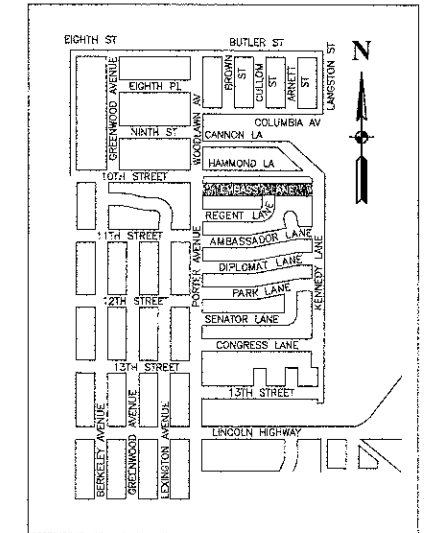

LOCATION MAP
NOT TO SCALE

LEGEND

- CURB REMOVAL & REPLACEMENT
- SIDEWALK REMOVAL
- DRIVEWAY PAVEMENT REMOVAL
- PORTLAND CEMENT CONCRETE SIDEWALK, 5" AGGREGATE BASE COURSE, TYPE B, 3"
- DETECTABLE WARNINGS
- HOT-MIX ASPHALT DRIVEWAY PAVEMENT, 4"
- STABILIZED DRIVEWAY PAVEMENT
- DOMESTIC WATER SERVICE BOXES TO BE ADJUSTED
- MANHOLES TO BE ADJUSTED

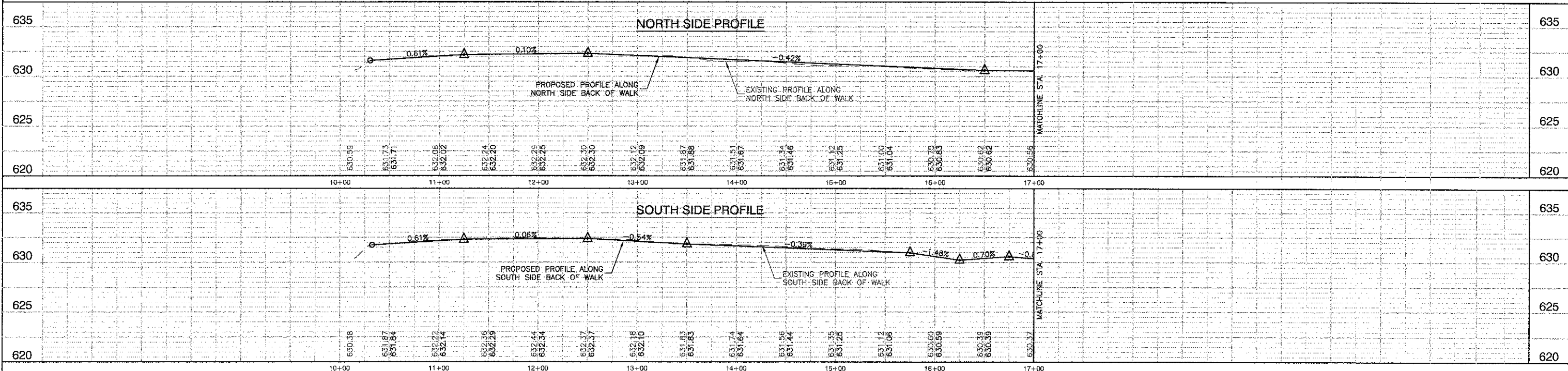

| | | | | | | | | | | | |
|------------------------------------|----------------|--------------------|-----------|---|--|--|----------------|----------|----------------|-------------|--|
| FILE NAME = I2594-PLPR-02 IDOT P01 | USER NAME = | DESIGNED = JPH/TAG | REVISED = | STATE OF ILLINOIS DEPARTMENT OF TRANSPORTATION | SIDEWALK CONSTRUCTION VILLAGE OF FORD HEIGHTS EMBASSY LANE SIDEWALK PLAN AND PROFILE | F.A.U. RTE. = | SECTION = | COUNTY = | TOTAL SHEETS = | SHEET NO. = | |
| | CHECKED = PKB | REVISED = | | | | N/A | 07-00010-01-SW | COOK | 8 | 4 | |
| PLOT SCALE = 1"=50' | DRAWN = LTL/RG | REVISED = | | | | SCALE: H 1"=60' V 1"=5' | | | | | |
| PLOT DATE = 02-01-13 | CHECKED = AG | REVISED = | | | | SHEET NO. 4 OF 8 SHEETS STA. 10+31.93 TO STA. 17+00 | | | | | |
| | | | | | | FED. ROAD DIST. NO. 1 ILLINOIS FED. AID PROJECT CONTRACT NO. 63802 | | | | | |

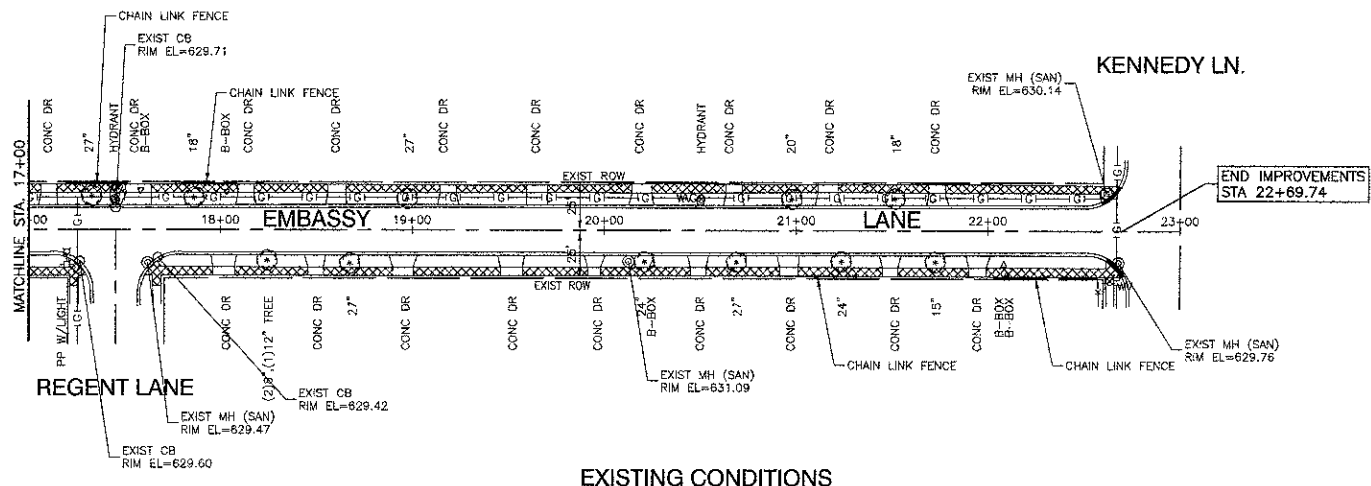

EXISTING CONDITIONS

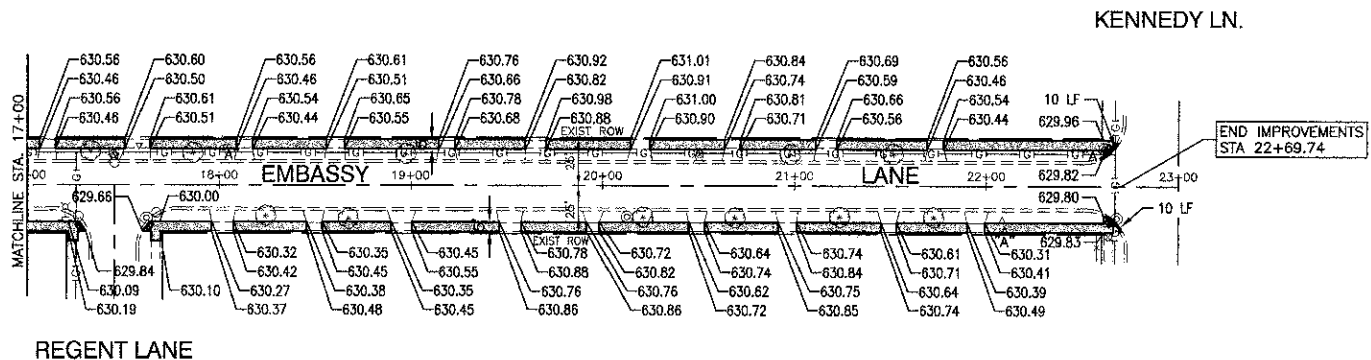

PROPOSED IMPROVEMENT

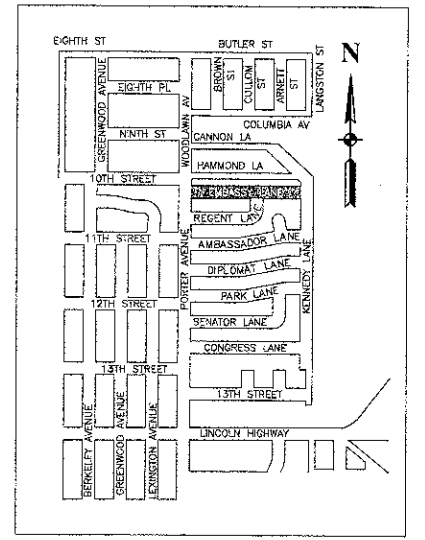

LOCATION MAP NOT TO SCALE

LEGEND

- CURB REMOVAL & REPLACEMENT
- SIDEWALK REMOVAL
- DRIVEWAY PAVEMENT REMOVAL
- PORTLAND CEMENT CONCRETE SIDEWALK, 5" AGGREGATE BASE COURSE, TYPE B, 3"
- DETECTABLE WARNINGS
- HOT-MIX ASPHALT DRIVEWAY PAVEMENT, 4"
- STABILIZED DRIVEWAY PAVEMENT
- DOMESTIC WATER SERVICE BOXES TO BE ADJUSTED
- MANHOLES TO BE ADJUSTED

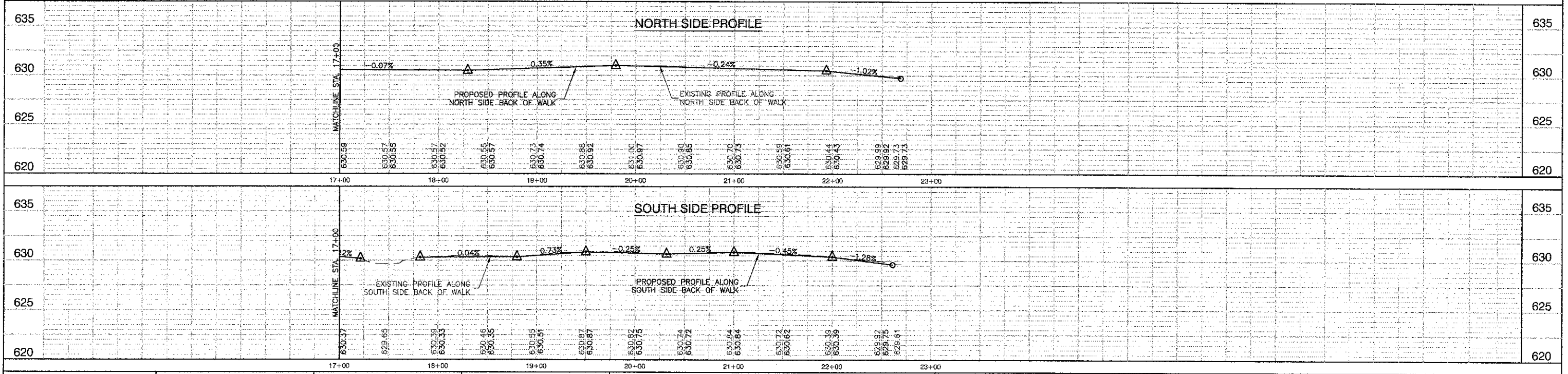

FILE NAME = 1284-PLPR-02 1001 P02
 USER NAME =
 PLOT SCALE = 1"=50'
 PLOT DATE = 02-01-13

| | |
|---------------------|-----------|
| DESIGNED -- JPH/TAG | REVISD -- |
| CHECKED -- PKB | REVISD -- |
| DRAWN -- LTL/RG | REVISD -- |
| CHECKED -- AG | REVISD -- |

STATE OF ILLINOIS
 DEPARTMENT OF TRANSPORTATION

SIDWALK CONSTRUCTION
 VILLAGE OF FORD HEIGHTS
 EMBASSY LANE SIDEWALK PLAN AND PROFILE
 SCALE: H 1"=50' V 1"=5'
 SHEET NO. 6 OF 8 SHEETS
 STA. 17+00 TO STA. 22+69.74

| | | | | |
|-----------------------|----------------|----------|--------------|------------------|
| F.A.U. RTE. | SECTION | COUNTY | TOTAL SHEETS | SHEET NO. |
| N/A | 07-00010-01-SW | COOK | 8 | 5 |
| FED. ROAD DIST. NO. 1 | | ILLINOIS | | FED. AID PROJECT |
| CONTRACT NO. 63802 | | | | |

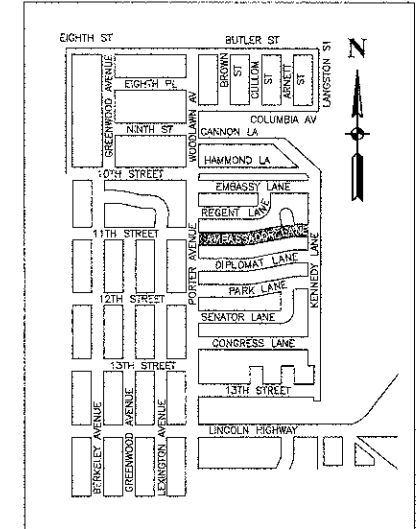
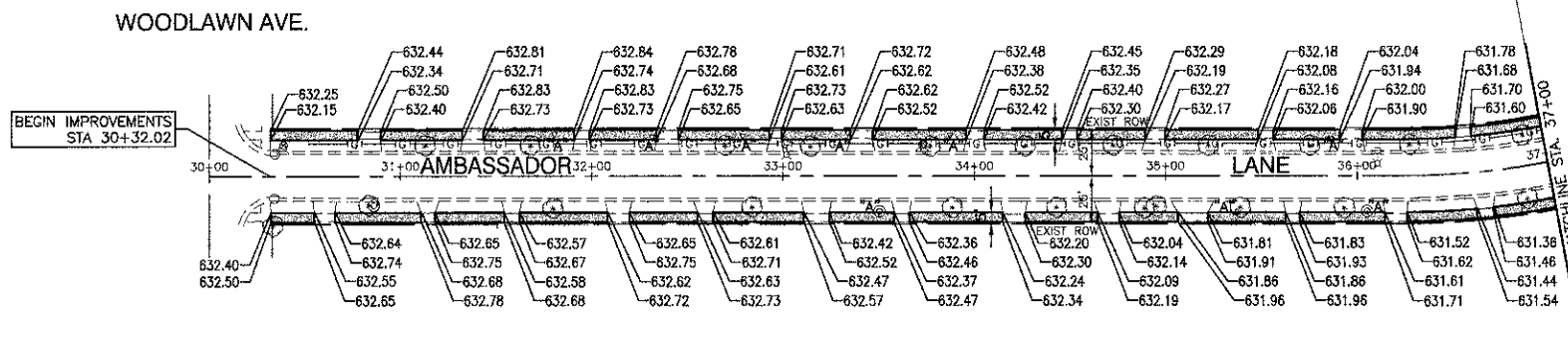
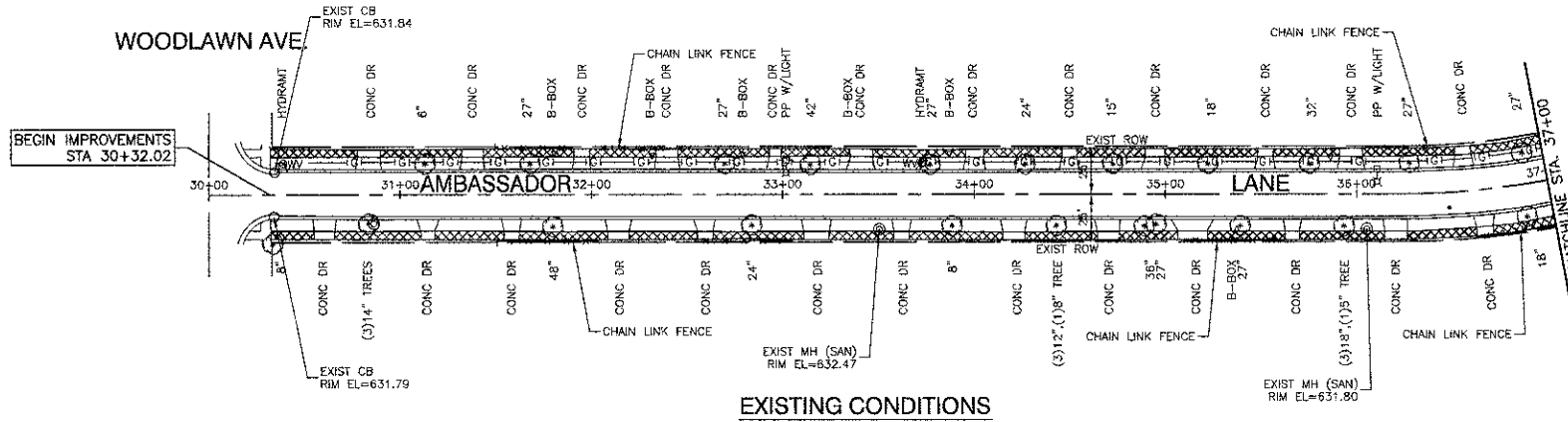

LOCATION MAP
NOT TO SCALE

LEGEND

- CURB REMOVAL & REPLACEMENT
- SIDEWALK REMOVAL
- DRIVEWAY PAVEMENT REMOVAL
- PORTLAND CEMENT CONCRETE SIDEWALK, 5"
AGGREGATE BASE COURSE, TYPE B, 3"
- DETECTABLE WARNINGS
- HOT-MIX ASPHALT DRIVEWAY PAVEMENT, 4"
- STABILIZED DRIVEWAY PAVEMENT
- DOMESTIC WATER SERVICE BOXES TO BE ADJUSTED
- MANHOLES TO BE ADJUSTED

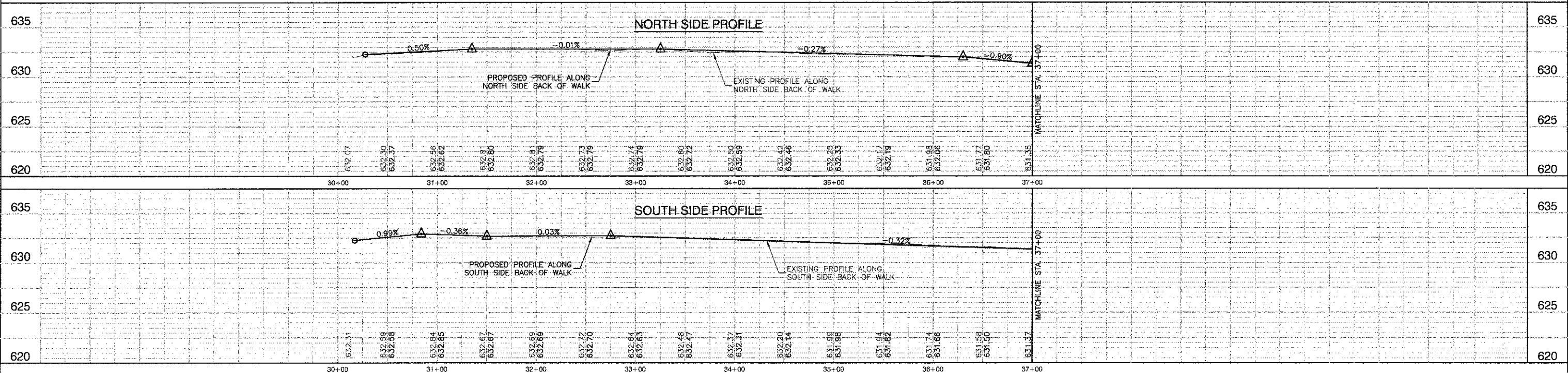

FILE NAME = 12584-PLPR-02 IDOT P03
 USER NAME =
 PLOT SCALE = 1"=50'
 PLOT DATE = 02-01-13

| | |
|---------------------|------------|
| DESIGNED -- JPH/TAG | REVISED -- |
| CHECKED -- PKB | REVISED -- |
| DRAWN -- LTL/RG | REVISED -- |
| CHECKED -- AG | REVISED -- |

STATE OF ILLINOIS
 DEPARTMENT OF TRANSPORTATION

SIDEWALK CONSTRUCTION
 VILLAGE OF FORD HEIGHTS
 AMBASSADOR LANE SIDEWALK PLAN AND PROFILE
 SCALE: H 1"=50' V 1"=5'
 SHEET NO. 6 OF 8 SHEETS
 STA. 30+32.02 TO STA. 37+00

| | | | | |
|-----------------------|----------------|---------------------------|--------------|-----------|
| F.A.U. RTE. | SECTION | COUNTY | TOTAL SHEETS | SHEET NO. |
| N/A | 07-00010-01-SW | COOK | 8 | 6 |
| FED. ROAD DIST. NO. 1 | | ILLINOIS FED. AID PROJECT | | |
| CONTRACT NO. 63802 | | | | |

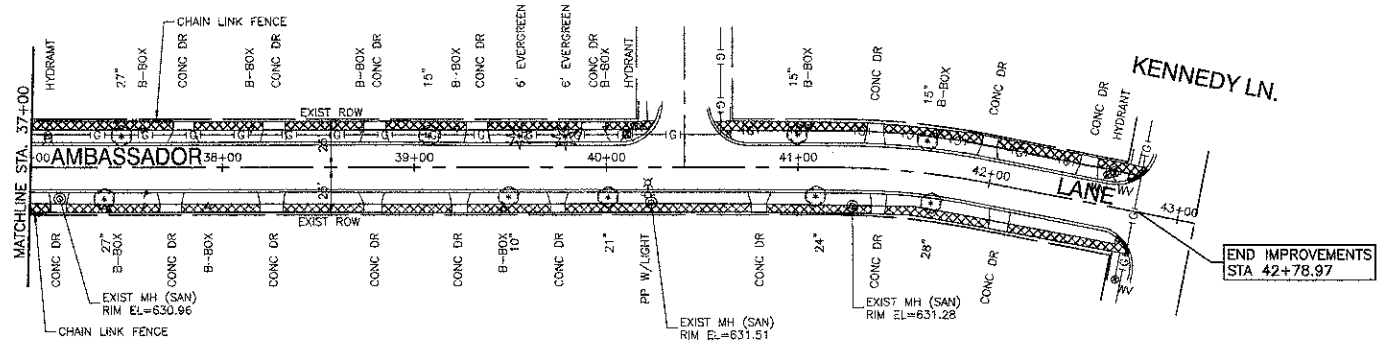

EXISTING CONDITIONS

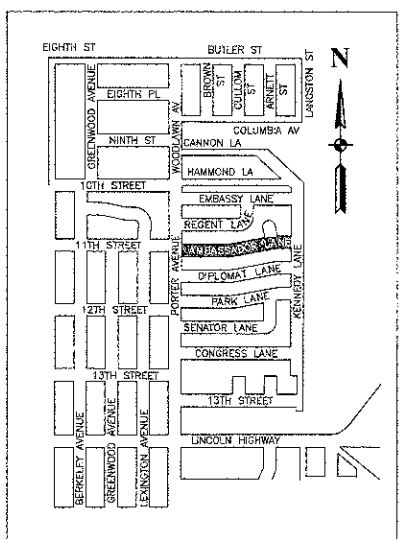

LOCATION MAP
NOT TO SCALE

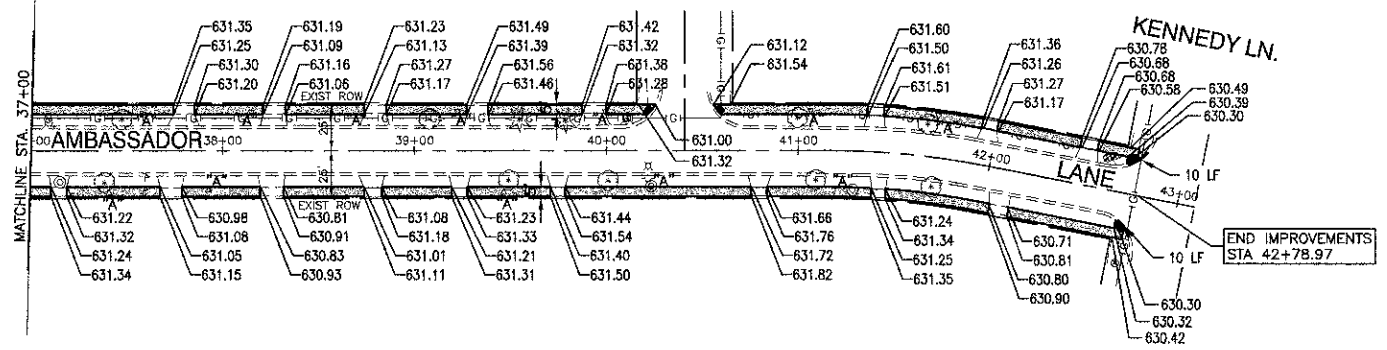

PROPOSED IMPROVEMENT

- LEGEND**
- CURB REMOVAL & REPLACEMENT
 - SIDEWALK REMOVAL
 - DRIVEWAY PAVEMENT REMOVAL
 - PORTLAND CEMENT CONCRETE SIDEWALK, 5" AGGREGATE BASE COURSE, TYPE B, 3"
 - DETECTABLE WARNINGS
 - HOT-MIX ASPHALT DRIVEWAY PAVEMENT, 4"
 - STABILIZED DRIVEWAY PAVEMENT
 - DOMESTIC WATER SERVICE BOXES TO BE ADJUSTED
 - MANHOLES TO BE ADJUSTED

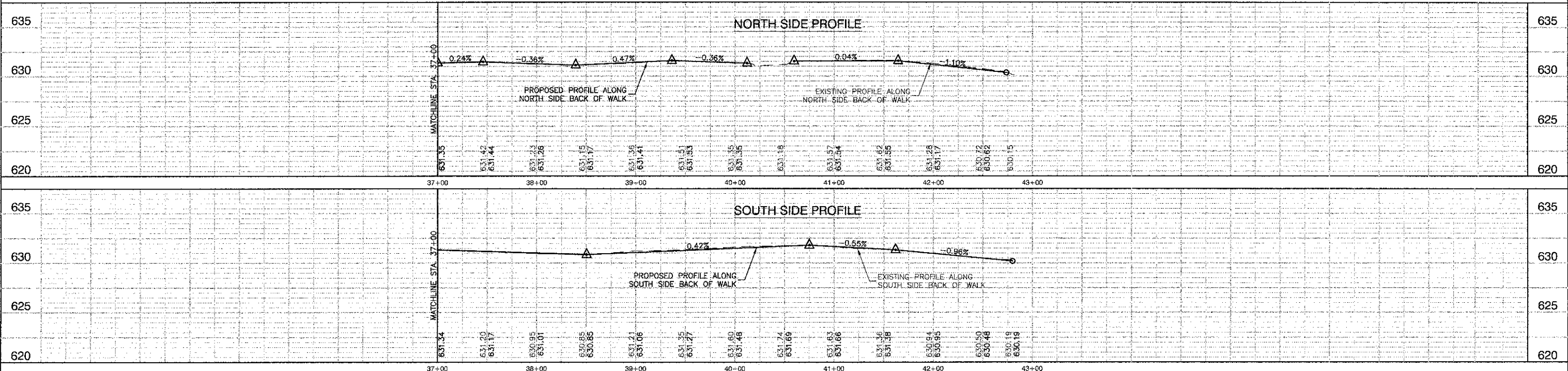

STATE OF ILLINOIS
DEPARTMENT OF TRANSPORTATION

SIDEWALK CONSTRUCTION
VILLAGE OF FORD HEIGHTS
AMBASSADOR LANE SIDEWALK PLAN AND PROFILE

| | | | | |
|--------------------|----------------|--------|--------------|-----------|
| F.A.U. RTE. | SECTION | COUNTY | TOTAL SHEETS | SHEET NO. |
| N/A | 07-00010-01-SW | COOK | 8 | 7 |
| CONTRACT NO. 63802 | | | | |

| | | |
|------------------------------------|---------------------|------------|
| FILE NAME = 12884-PLPH-02 IDOT P04 | DESIGNED -- JPH/TAG | REVISED -- |
| USER NAME = | CHECKED -- PKB | REVISED -- |
| PLOT SCALE = 1"=50' | DRAWN -- LTL/RG | REVISED -- |
| PLOT DATE = 02-01-13 | CHECKED -- AG | REVISED -- |

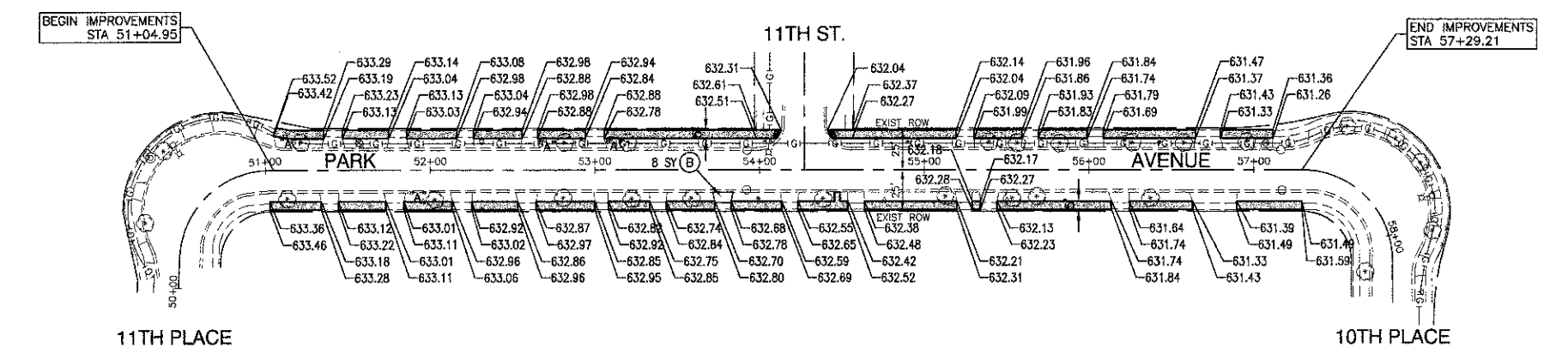
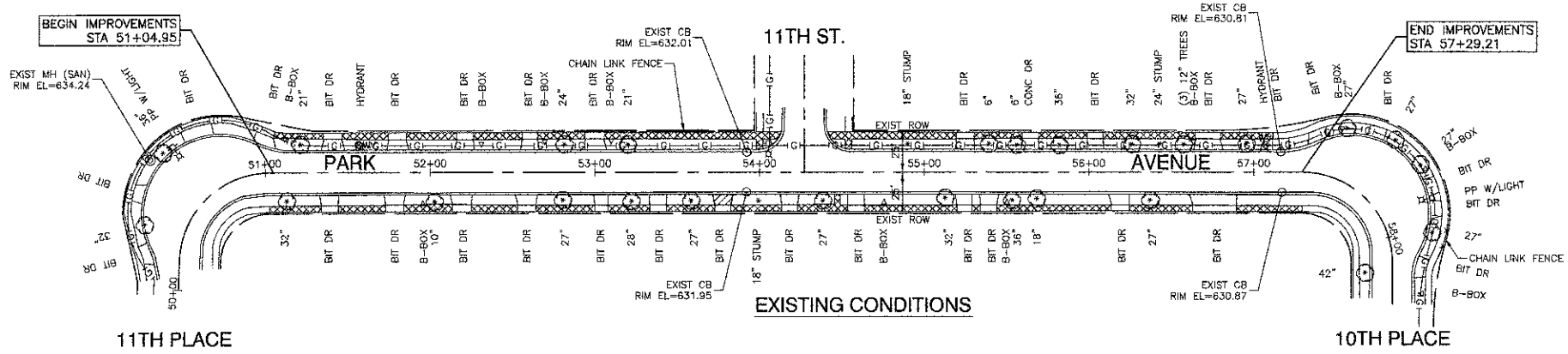
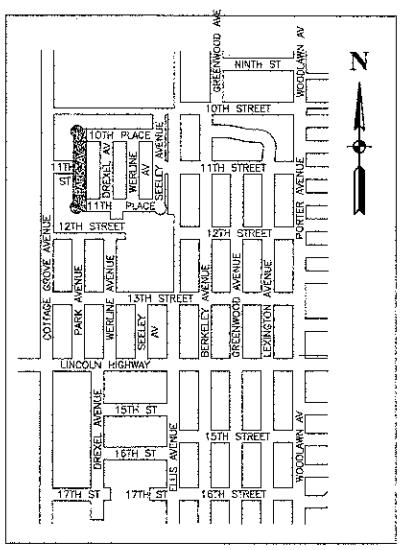
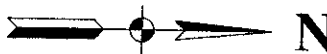

- LEGEND**
- CURB REMOVAL & REPLACEMENT
 - SIDEWALK REMOVAL
 - DRIVEWAY PAVEMENT REMOVAL
 - PORTLAND CEMENT CONCRETE SIDEWALK, 5" AGGREGATE BASE COURSE, TYPE B, 3"
 - DETECTABLE WARNINGS
 - HOT-MIX ASPHALT DRIVEWAY PAVEMENT, 4"
 - STABILIZED DRIVEWAY PAVEMENT
 - DOMESTIC WATER SERVICE BOXES TO BE ADJUSTED
 - MANHOLES TO BE ADJUSTED

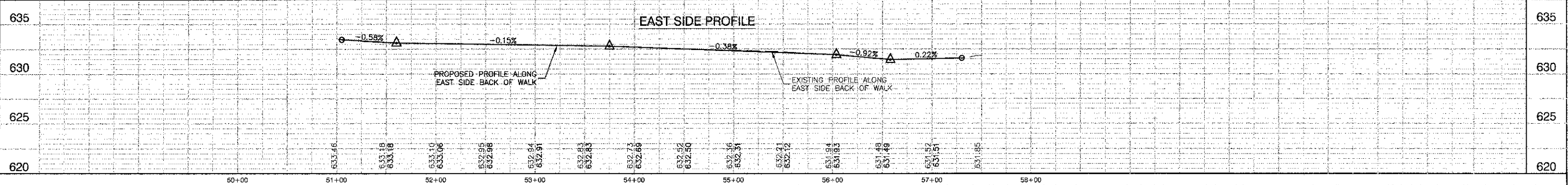
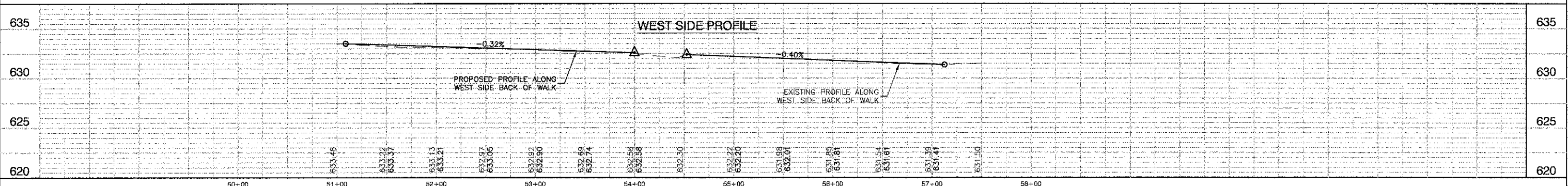

FILE NAME = 12594-PLPR-02 IDOT P05
 USER NAME =
 PLOT SCALE = 1"=50'
 PLOT DATE = 02-01-13

| | |
|--------------------|-----------|
| DESIGNED — JPH/TAG | REVISED — |
| CHECKED — PKB | REVISED — |
| DRAWN — LTL/RG | REVISED — |
| CHECKED — AG | REVISED — |

**STATE OF ILLINOIS
DEPARTMENT OF TRANSPORTATION**

**SIDEWALK CONSTRUCTION
VILLAGE OF FORD HEIGHTS
PARK AVENUE SIDEWALK PLAN AND PROFILE**

SCALE: H 1"=50' V 1"=5'
 SHEET NO. 8 OF 8 SHEETS
 STA. 51+04.95 TO STA. 57+29.21

| | | | | |
|-----------------------|----------------|--------|---------------------------|-----------|
| F.A.U. RTE. | SECTION | COUNTY | TOTAL SHEETS | SHEET NO. |
| N/A | 07-00010-01-SW | COOK | 8 | 8 |
| FED. ROAD DIST. NO. 1 | | | ILLINOIS FED. AID PROJECT | |
| CONTRACT NO. 63802 | | | | |