

STATE OF ILLINOIS
DEPARTMENT OF TRANSPORTATION

PLANS FOR
PROPOSED FEDERAL AID HIGHWAY

FAP 343 IL ROUTE 68 (DUNDEE ROAD)
DES PLAINES RIVER BRIDGE TO I-294 TOLLWAY BRIDGE
SECTION 10-00072-00-BT
PROJECT TE-00D1 (854)
PEDESTRIAN PATH CONSTRUCTION
VILLAGE OF WHEELING
COOK COUNTY
C-91-400-11 R11E 3RD P.M.

F.A.P. RTE.	SECTION	COUNTY	TOTAL SHEETS	SHEET NO.
343	10-00072-00-BT	COOK	39	1
ILLINOIS CONTRACT NO. 63805				

INDEX OF SHEETS

- 1 TITLE SHEET
- 2 GENERAL NOTES
- 3 SUMMARY OF QUANTITIES
- 4 -5 TYPICAL SECTIONS
- 6 EARTHWORK SCHEDULE
- 7 ALIGNMENT AND TIES
- 8 -13 PLAN AND PROFILE SHEETS
- 14-19 EROSION CONTROL PLANS
- 20-21 RETAINING WALL PLANS
- 22 DISTRICT ONE TYPICAL PAVEMENT MARKINGS
- 23 DISTRICT ONE TC&P FOR SIDE ROADS, INTERSECTIONS AND DRIVEWAYS
- 24 DISTRICT ONE ARTERIAL ROAD INFORMATION SIGN
- 25-28 COMPENSATORY STORAGE CALCULATIONS
- 29-39 CROSS SECTIONS



DESIGN DESIGNATION

DUNDEE ROAD
FUNCTIONAL CLASSIFICATION: OTHER PRINCIPAL ARTERIAL
POSTED SPEED = 50 MPH EAST OF PORTWINE ROAD
40 MPH WEST OF PORTWINE ROAD
EXISTING ADT = 31,300 (2009)

PROJECT LOCATED IN THE VILLAGE OF WHEELING

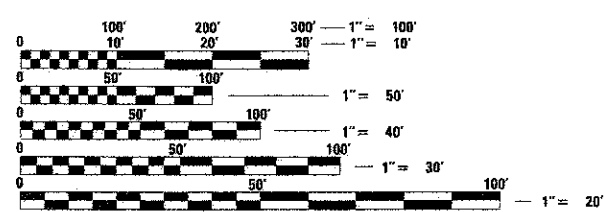

FULL SIZE PLANS HAVE BEEN PREPARED USING STANDARD ENGINEERING SCALES. REDUCED SIZED PLANS WILL NOT CONFORM TO STANDARD SCALES. IN MAKING MEASUREMENTS ON REDUCED PLANS, THE ABOVE SCALES MAY BE USED.

J.U.L.I.E.
JOINT UTILITY LOCATION INFORMATION FOR EXCAVATION
1-800-892-0123
OR 811

CONTRACT NO. 63805

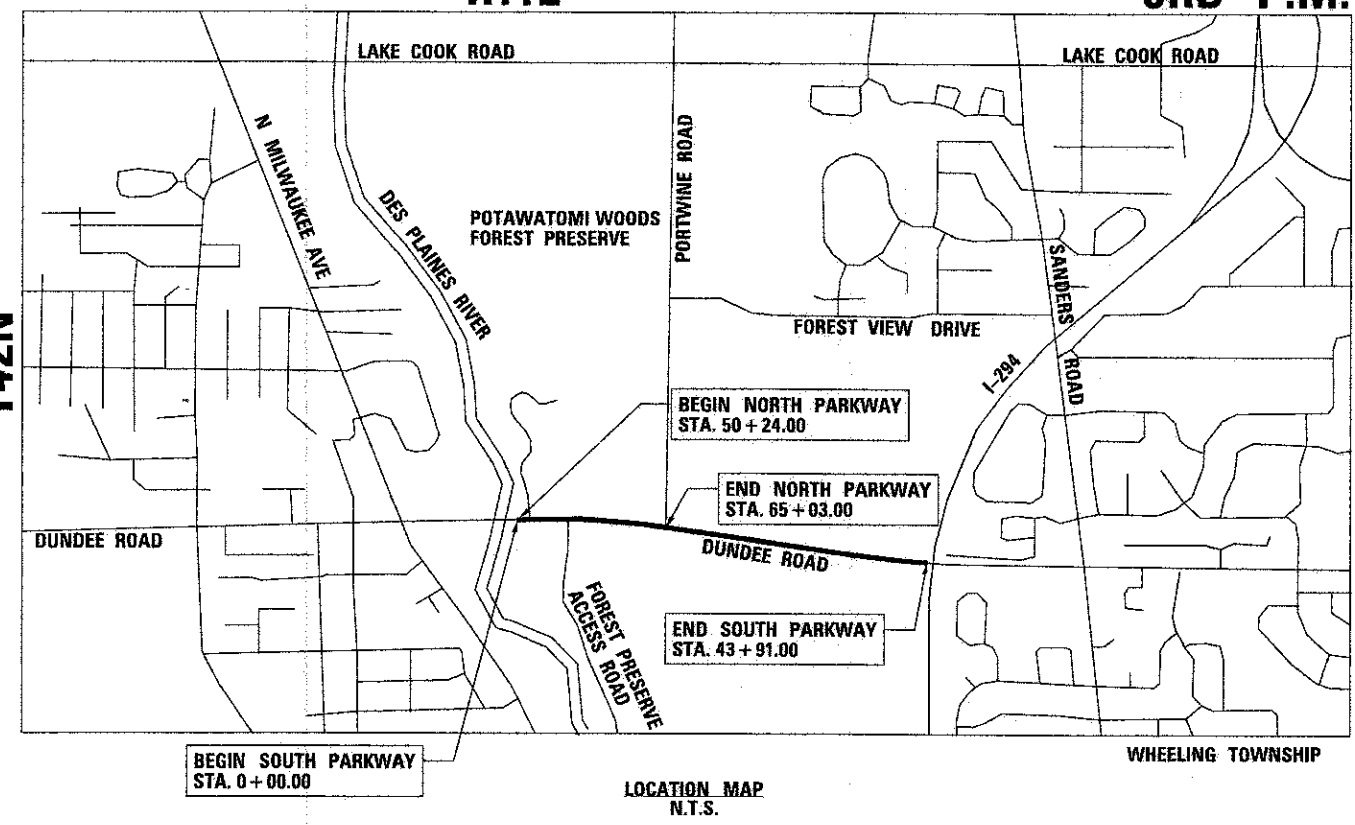

GROSS LENGTH = 4,391 FT. = 0.83 MILE
NET LENGTH = 4,391 FT. = 0.83 MILE

STATE OF ILLINOIS DEPARTMENT OF TRANSPORTATION

APPROVED 1/31 2012
John M. Koch
VILLAGE OF WHEELING

PASSED FEBRUARY 25 2012
C. Holt
DISTRICT 1 ENGINEER OF LOCAL ROADS AND STREETS

RELEASING FOR BID
BASED ON LIMITED
REVIEW February 27 2012
John Fortson
DEPUTY DIRECTOR OF HIGHWAYS, REGION 1 ENGINEER

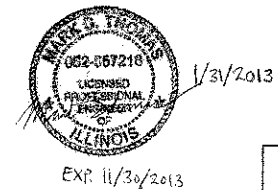

PRINTED BY THE AUTHORITY
OF THE STATE OF ILLINOIS

PROGRAM AND OFFICE ENGINEER: CHARLES F. RIDDLE, P.E. (847) 705-4405, SCHAUMBURG, IL

9575 W. Higgins Road, Suite 600
Rosemont, Illinois 60018
(847) 823-0500

