

GENERAL NOTES

1. ALL REFERENCES TO "STANDARD SPECIFICATIONS" IN THESE GENERAL NOTES SHALL BE INTERPRETED TO MEAN "STANDARD SPECIFICATIONS FOR ROAD AND BRIDGE CONSTRUCTION" ADOPTED BY THE ILLINOIS DEPARTMENT OF TRANSPORTATION, JANUARY 1, 2012.

2. ALL REFERENCES TO "ENGINEER" SHALL BE INTERPRETED TO MEAN THE RESIDENT ENGINEER.

3. PRIOR TO COMMENCEMENT OF CONSTRUCTION, THE CONTRACTOR SHALL VERIFY ALL DIMENSIONS AND CONDITIONS AFFECTING THEIR WORK WITH THE ACTUAL CONDITIONS AT THE JOB SITE. IN ADDITION, THE CONTRACTOR SHALL VERIFY THE ENGINEER'S LINE AND GRADE STAKES. IF THERE ARE ANY DISCREPANCIES FROM WHAT IS SHOWN ON THE CONSTRUCTION PLANS, HE/SHE MUST IMMEDIATELY REPORT SAME TO THE ENGINEER BEFORE DOING ANY WORK, OTHERWISE THE CONTRACTOR ASSUMES FULL RESPONSIBILITY. IN THE EVENT OF DISAGREEMENT WITH THE CONSTRUCTION PLANS, STANDARD SPECIFICATIONS AND/OR SPECIAL DETAILS, THE CONTRACTOR SHALL SECURE WRITTEN INSTRUCTIONS FROM THE ENGINEER PRIOR TO PROCEEDING WITH ANY PART OF THE WORK AFFECTED BY OMISSIONS OR DISCREPANCIES. FAILING TO SECURE SUCH INSTRUCTIONS, THE CONTRACTOR WILL BE CONSIDERED TO HAVE PROCEEDED AT HIS OWN RISK AND EXPENSE IN THE EVENT OF ANY DOUBT OR QUESTION ARISING WITH RESPECT TO THE TRUE MEANING OF THE CONSTRUCTION PLANS OR SPECIFICATIONS, THE DECISION OF THE ENGINEER SHALL BE FINAL AND CONCLUSIVE.

4. IT IS THE CONTRACTOR'S RESPONSIBILITY TO ASCERTAIN EXISTING FIELD CONDITIONS PRIOR TO BIDDING ON THE PROJECT.

5. BEFORE STARTING EXCAVATION, THE CONTRACTOR SHALL CALL "JULIE" (JOINT UTILITY LOCATION INFORMATION FOR EXCAVATION) AT 811 or 1-800-892-0123 AND THE CITY OF NAPERVILLE AT 630-420-6131 (ELECTRIC) OR 630-420-6137 (WATER) FOR FIELD LOCATIONS OF BURIED UTILITIES (48 HOURS NOTIFICATION IS REQUIRED).

6. THE CONTRACTOR WILL NOT BE ALLOWED TO SET UP A YARD OR FIELD OFFICE ON STATE OR CITY PROPERTY OR ROW WITHOUT WRITTEN PERMISSION FROM THE ENGINEER.

7. SAW CUTTING OF PAVEMENTS, SIDEWALK, ETC. SHALL BE TO FULL DEPTH AND SHALL RESULT IN A CLEAN STRAIGHT EDGE ON THE PORTION REMAINING. ALL SAW CUTTING SHALL BE CONSIDERED INCLUDED IN THE COST OF THE ITEM REMOVED.

8. THE CONTRACTOR SHALL PROTECT AND CAREFULLY PRESERVE ALL SECTION OR SUBSECTION MONUMENTS, PROPERTY CORNERS, AND REFERENCE MARKERS UNTIL THE OWNER, HIS AGENT, OR AN AUTHORIZED SURVEYOR HAS WITNESSED OR OTHERWISE REFERENCED THEIR LOCATIONS.

9. DETECTABLE WARNINGS SHALL BE ARMOR TILE OR APPROVED EQUAL.

10. THE CONTRACTOR'S ATTENTION IS CALLED TO THE FACT THAT THE PRESERVATION OF EXISTING TREES IS OF UTMOST IMPORTANCE TO THE CITY OF NAPERVILLE. ALL TREE PROTECTION, TREE REMOVAL, PRUNING AND ROOT PRUNING SHALL BE COMPLETED BEFORE CONSTRUCTION OPERATIONS COMMENCE IN ANY AREA. AT NO TIME SHALL THE CONTRACTOR PRUNE OR REMOVE ANY TREES UNLESS SPECIFICALLY DIRECTED BY THE ENGINEER.

11. THE CONTRACTOR SHALL TAKE EXTRA CARE IN GRADING AND EXCAVATING NEAR TREES WHICH ARE NOT MARKED FOR REMOVAL SO AS NOT TO CAUSE INJURY TO THE ROOT SYSTEM OR TRUNKS. ROOTS OF A TREE THAT ARE TO REMAIN IN PLACE EXTENDING INTO THE EXCAVATION AREAS AT AN ELEVATION THAT WOULD INTERFERE WITH ANY PORTION OF THE PLANNED CONSTRUCTION SHALL BE SEVERED AT A POINT IMMEDIATELY OUTSIDE OF THE EXCAVATION AREA IN A MANNER THAT WILL CAUSE THE LEAST AMOUNT OF SYSTEMIC DAMAGE TO THE REMAINING TREE STRUCTURE. ANY DAMAGE DONE TO EXISTING ITEMS BY THE CONTRACTOR SHALL BE REPAIRED BY THE CONTRACTOR AT THE CONTRACTOR'S OWN EXPENSE.

12. PRUNE TREE LIMBS THAT MIGHT BE DAMAGED BY EQUIPMENT OPERATIONS AT LEAST ONE WEEK PRIOR TO THE START OF CONSTRUCTION BY A CERTIFIED ARBORIST. ANY TREE LIMBS THAT ARE BROKEN BY CONSTRUCTION EQUIPMENT AFTER THE INITIAL PRUNING MUST BE PRUNED CORRECTLY WITHIN 72 HOURS.

13. SUPPLEMENTAL WATERING IS SPECIFIED FOR TREES AND SHRUBS THAT WILL BE DISTURBED BY CONSTRUCTION BUT WILL REMAIN. NOTE THAT WATERING SHOULD BEGIN IMMEDIATELY AFTER ROOT PRUNING, TOP PRUNING OR OTHER CONSTRUCTION DISTURBANCE.

TRAFFIC CONTROL

1. SEE TRAFFIC CONTROL HIGHWAY STANDARDS CONCERNING TRAFFIC CONTROL AND PROTECTION.

2. THE CONTRACTOR SHALL SCHEDULE CONSTRUCTION ACTIVITIES SO THAT ONE LANE OF TRAFFIC SHALL REMAIN OPEN IN EACH DIRECTION AT ALL TIMES.

STORM SEWERS, WATER MAINS, AND UTILITIES

1. THE CONTRACTOR SHALL BE RESPONSIBLE FOR CONTACTING THE OWNERS OF ALL UTILITIES PRIOR TO CONSTRUCTION TO DETERMINE THE LOCATION OF ALL UTILITY EQUIPMENT. THE CONTRACTOR SHALL COOPERATE WITH ALL UTILITY OWNERS IN ACCORDANCE WITH THE STANDARD SPECIFICATIONS IF UTILITY RELOCATION, ADJUSTMENT, OR PROTECTION IS NECESSARY.

2. THE LOCATION OF EXISTING DRAINAGE STRUCTURES, STORM SEWERS, WATER MAINS, SANITARY SEWERS, AND ANY OTHER PUBLIC UTILITIES AS SHOWN ON THE PLANS IS APPROXIMATE AND THEIR EXACT LOCATION IS TO BE DETERMINED IN THE FIELD BY THE CONTRACTOR. THIS WORK SHALL BE CONSIDERED AS INCLUDED IN THE UNIT BID PRICES OF THE CONTRACT, AND NO ADDITIONAL COMPENSATION WILL BE ALLOWED.

3. THE CONTRACTOR SHALL BE RESPONSIBLE FOR THE PROTECTION OF ALL UNDERGROUND AND SURFACE UTILITIES EVEN IF NOT SHOWN ON THE PLANS. ALL UTILITY PROPERTY DAMAGE DURING CONSTRUCTION SHALL BE REPAIRED OR REPLACED TO THE SATISFACTION OF THE OWNER AT THE CONTRACTOR'S EXPENSE.

4. ALL UTILITY OWNERS SHALL BE NOTIFIED AT LEAST 3 DAYS PRIOR TO THE START OF CONSTRUCTION.

5. THE CONTRACTOR SHALL USE ALL NECESSARY PRECAUTIONS AND PROTECTION MEASURES REQUIRED TO MAINTAIN EXISTING UTILITIES, SEWERS, AND APPURTENANCES THAT MUST BE KEPT IN OPERATION.

6. THE CONTRACTOR SHALL ENSURE ALL WATER SYSTEM VALVES, VALVE VAULTS, AND SANITARY SEWER MANHOLES REMAIN READILY ACCESSIBLE FOR EMERGENCY OPERATIONS. THE LOCATIONS OF ALL WATER AND SANITARY FACILITIES SHALL BE MARKED AND READILY VISIBLE AT ALL TIMES.

7. ALL LOOSE MATERIAL DEPOSITED IN THE FLOWLINE OF DRAINAGE STRUCTURES, WHICH OBSTRUCTS THE NATURAL FLOW OF WATER SHALL BE REMOVED AT THE CLOSE OF EACH WORKING DAY. PRIOR TO ACCEPTANCE OF THE IMPROVEMENT, ALL DRAINAGE STRUCTURES SHALL BE FREE OF DIRT AND DEBRIS. THIS WORK WILL NOT BE PAID FOR SEPARATELY, BUT SHALL BE CONSIDERED AS INCLUDED IN THE UNIT BID PRICES OF THE CONTRACT IN ACCORDANCE WITH ARTICLE 107.15.

8. THE EXISTING FRAMES AND LIDS SHALL REMAIN AS PROPERTY OF THE CITY OF NAPERVILLE. ALL OLD FRAMES AND LIDS NOT BEING REUSED SHALL BE REMOVED FROM PARKWAYS BY THE CONTRACTOR, DELIVERED TO AND STOCKPILED AT THE CITY DEPARTMENT OF PUBLIC WORKS FACILITY WITHIN SEVEN (7) DAYS OF THEIR REMOVAL. THE PUBLIC WORKS DEPARTMENT YARD IS LOCATED AT 180 FORT HILL DRIVE.

MISCELLANEOUS NOTES

1. MATERIALS RESULTING FROM THE REMOVAL OF CONCRETE SURFACES, UTILITY STRUCTURE ADJUSTMENT, RESTORATION WORK, ETC. SHALL BE REMOVED AT THE END OF EACH DAY TO AN APPROVED SITE. IF THE CONTRACTOR DOES NOT REMOVE THESE MATERIALS AT THE REQUEST OF THE ENGINEER, THE ENGINEER WILL HIRE A CONTRACTOR TO HAVE THE MATERIAL REMOVED AND THE CONTRACTOR SHALL BE BILLED (CHARGED) ACCORDINGLY.

2. THE INDISCRIMINATE USE OF FIRE HYDRANTS, EXISTING STREAMS, CREEKS, WETLANDS, OR PONDS IS STRICTLY PROHIBITED. THE CONTRACTOR SHALL PROVIDE A WATER TRUCK AND DRIVER AS REQUIRED TO OBTAIN AND TRANSPORT THIS WATER. THE CONTRACTOR SHALL BE RESPONSIBLE FOR OBTAINING WATER FROM AN APPROVED SOURCE. IF THIS WATER IS FROM A SOURCE OTHER THAN HIS/HER YARD, WRITTEN APPROVAL FROM THE AGENCY HAVING JURISDICTION FOR THE SOURCE OF THE WATER MUST BE RECEIVED BY THE CONTRACTOR PRIOR TO USE OF THE WATER.

3. THE CONTRACTOR SHALL BE RESPONSIBLE FOR SWEEPING AND CLEANING STREETS OF ANY DEBRIS AND MATERIAL THAT HAS ACCUMULATED AS A RESULT OF THE CONSTRUCTION ACTIVITY. A MECHANICAL SWEEPER, MECHANICALLY DRIVEN AIR AND HANDWORK WITH SHOVEL AND BROOM SHALL BE UTILIZED TO PROVIDE A CLEAN STREET FOR THE MOTORING PUBLIC. WITHIN 24 HOURS OF PLACING PRIME COAT AND THE LAYING OF HMA, THE CONTRACTOR SHALL SWEEP THE PAVEMENT AND REMOVE STANDING WATER, EARTH, WEEDS, LEAVES, DIRT, CONSTRUCTION DEBRIS AND ALL LOOSE MATERIAL.

4. IT WILL BE THE CONTRACTOR'S RESPONSIBILITY TO NOTIFY RESIDENTS AND THE ENGINEER WHEN ACCESS TO THEIR DRIVEWAYS WILL BE TEMPORARILY CLOSED DUE TO SIDEWALK REPLACEMENT, AND/OR CURB AND GUTTER REPLACEMENT. AT LOCATIONS WHERE THE SIDEWALK OR CURB AND GUTTER IS SCHEDULED TO BE REMOVED, THE CONTRACTOR SHALL CONTACT THE BUSINESS/HOMEOWNER 24 HOURS PRIOR TO REMOVING THE CURB OR SIDEWALK. EVERY EFFORT SHALL BE MADE TO ACCOMMODATE ACCESS TO THESE PROPERTIES. THE CONTRACTOR SHALL NOT BE ALLOWED TO CLOSE A DRIVEWAY FOR MORE THAN 48 HOURS UNDER ANY CIRCUMSTANCE. THE CONTRACTOR SHALL BE RESPONSIBLE FOR MAINTAINING THE BARRICADES TO PREVENT TRAFFIC FROM USING THE DRIVEWAYS DURING THIS PERIOD.

5. WHEN REMOVING PAVEMENT, CURB AND GUTTER, SHOULDER, AND/OR ANY OTHER STRUCTURES, THE USE OF ANY TYPE OF CONCRETE BREAKERS WHICH MIGHT DAMAGE UNDERGROUND PUBLIC OR PRIVATE UTILITIES AND BUILDING FOUNDATIONS WILL NOT BE PERMITTED. UNDER NO CIRCUMSTANCES WILL THE USE OF A FROST BALL BE PERMITTED.

6. WHEN THE P.C.C. SIDEWALK EXTENDS THROUGH THE DRIVEWAY, THE THICKNESS OF THE SIDEWALK IN THE DRIVEWAY AREA SHALL BE THE SAME AS THE DRIVEWAY THICKNESS. SIDEWALK WILL BE PAID FOR AS P.C.C. SIDEWALK, 5" SIDEWALK CROSS SLOPE THRU DRIVEWAY AREA TO BE A MAXIMUM OF 1:50.

HIGHWAY STANDARDS	
STD. NO.	DESCRIPTION
00001-06	STANDARD SYMBOLS, ABBREVIATIONS AND PATTERNS
424001-07	PERPENDICULAR CURB RAMPS FOR SIDEWALKS
424006-01	DIAGONAL CURB RAMPS
424011-01	CORNER PARALLEL CURB RAMPS
442201-03	CLASS C AND D PATCHES
604001-03	FRAME AND LIDS TYPE 1
606001-05	CONCRETE CURB TYPE B AND COMBINATION CONCRETE CURB AND GUTTER
701301-04	LANE CLOSURE, 2L, 2W, SHORT TIME OPERATIONS
701501-06	LANE CLOSURE, 2L, 2W, UNDIVIDED
701801-05	SIDEWALK, CORNER OR CROSSWALK CLOSURE
701901-02	TRAFFIC CONTROL DEVICES

BENCHMARK INFORMATION:



**City of Naperville
Survey Monument**

City of Naperville
Transportation, Engineering,
and Development
(TED) Business Group
400 S. Eagle Street
Naperville, IL 60540
Phone: 630-308-7001

Station No.: 1007

Date Established: 01/17/2001

Order of Accuracy: Horizontal 1st Vertical 4th

Date Last Checked: 11/15/2005

Station Elevation: 733.69 (Ft)

Naperville Field Checked: 10/09/2008

Note: Any and all parties utilizing the vertical elevation listed above should always check at least one other monument.

Horizontal Datum: NAD83 (2007) Illinois State Plane Transverse Mercator, East Zone

Vertical Datum: NAVD 1988 Adjustment

North: 1,858,566.01 (Ft) East: 1,039,994.31 (Ft)

Latitude: 41° 46' 09.24367" (N) Longitude: 088° 07' 44.35152" (W)

Description:

Bernsten 3D Top Security Monument. Consisting of a 9/16" Dia. Stainless Steel Datum Point On Threaded 9/16" x 4" Long Rod Totalling (12") In Length With Greased Top Security Sleeve Enclosed In Sand and 6" PVC Pipe With BMAC 6 Aluminum Access Cover.

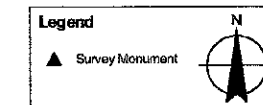
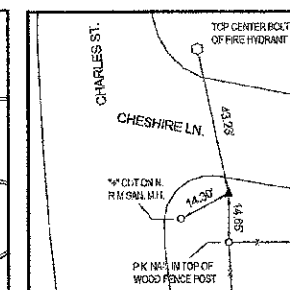
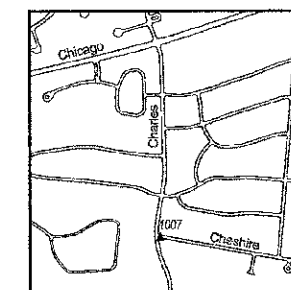

For further data information please consult the National Geodetic Survey: www.ngs.noaa.gov

STATE OF ILLINOIS
DEPARTMENT OF TRANSPORTATION

2013 New Sidewalk Program
General Notes

CAL. SHEET NO.	SECTION	COUNTY	TOWN	SHEET NO.
13-60390-00-01		DUPAGE	44	3
CONTRACT NO. 63810				

DESIGNED - JFS	REVIEWED - 1/25/2013
DRAWN - JFS	REVIEWED - 2/25/2013
CHECKED - BK	REVIEWED -
DATE - 12/04/2012	REVIEWED -