

NOTE:
SEE ALIGNMENT TIES AND BENCHMARKS
SHEET FOR BENCHMARK INFORMATION.

BILL OF MATERIAL

ITEM	UNIT	TOTAL
POROUS GRANULAR EMBANKMENT	CU YD	15
STONE RIPRAP, CLASS A4	SQ YD	50
FILTER FABRIC	SQ YD	50
REMOVAL OF EXISTING STRUCTURES	EACH	1
REMOVAL AND DISPOSAL OF UNSUITABLE MATERIAL FOR STRUCTURES	CU YD	15
REINFORCEMENT BARS EPOXY COATED	POUND	83,868
NAME PLATES	EACH	1
CONCRETE BOX CULVERTS	CU YD	152

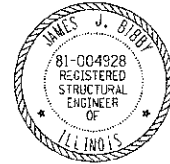

"I certify that to the best of my knowledge, information and belief, this bridge is structurally adequate for the design loading shown on the plans. The design is an economical one for the style of structure and complies with requirements of the current AASHTO Standard Specifications for Highway Bridges."

JAMES J. BIBBY
ILLINOIS REGISTERED STRUCTURAL ENGINEER
NO. 081-004928 EXPIRES 11-30-14

WATERWAY INFORMATION

Drainage Area = 8.65 Sq. Mi.

Flood	Yr.	Freq.	C.F.S.	0	Opening	Sq. Ft.	Nat.	Head	- Ft.	Headwater	El.
Design	50	655	74	74	714.39	0.53	0.53	714.92	714.92	714.92	714.92
Base	100	755	74	74	714.62	0.44	0.44	715.05	715.05	715.05	715.05
Overlapping	50	655	74	74	714.39	0.53	0.53	714.92	714.92	714.92	714.92
Max. Calc.	500	1065	74	74	715.11	0.29	0.29	715.40	715.40	715.40	715.40

EXISTING STRUCTURE

S.N. 022-0067 - First constructed in the 1920's, this bridge consists of a one span (26'-0") reinforced concrete slab on stub abutments over Winfield Creek. Entire existing structure shall be removed and replaced requiring a full road closure.

Road will be closed. Traffic will be detoured around site.

Salvage: None

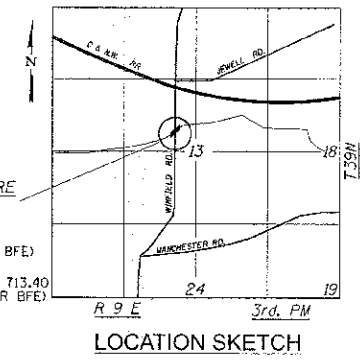
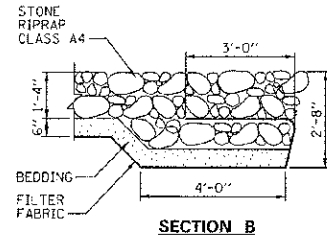
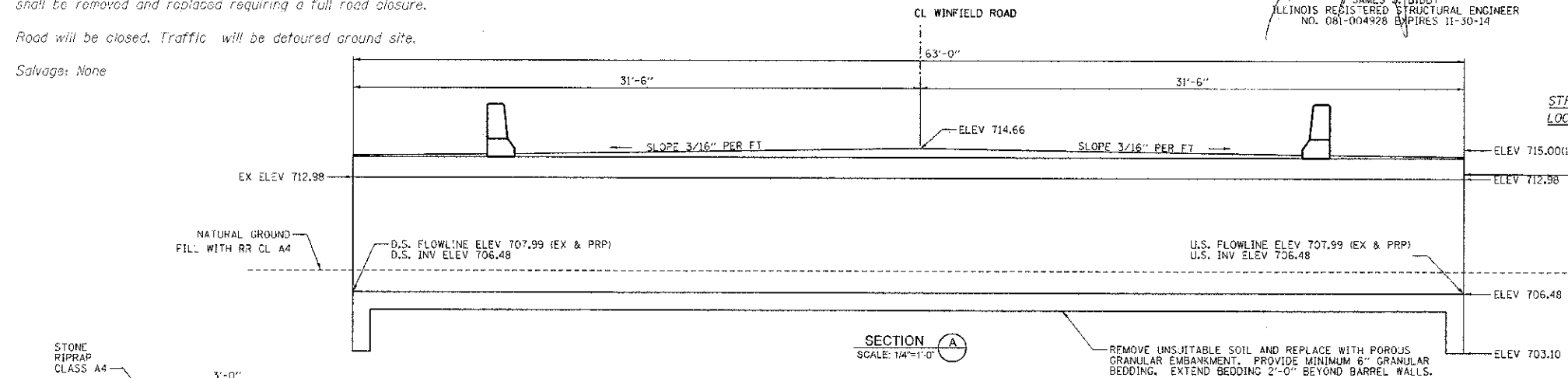

LOADING HL-93
Allow 50#/sq. ft. for future wearing surface.
DESIGN SPECIFICATIONS
2007 AASHTO LRFD Bridge Design Specifications
with 2008 & 2009 Interims
DESIGN STRESSES
FIELD UNITS
 $f_c = 5,000$ psi
 $f_s = 60,000$ psi (reinforcement)

WINFIELD CREEK
BUILT 2013 BY
VILLAGE OF WINFIELD
F.A.S. RT. 3549
SEC. 10-00045-00-BR
LOADING HL-93
STR. NO. 022-6007
NAME PLATE
See Std. 515001

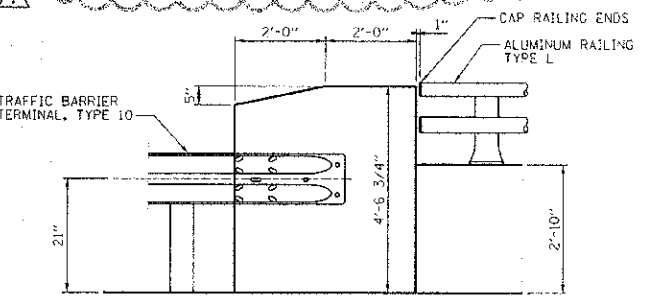
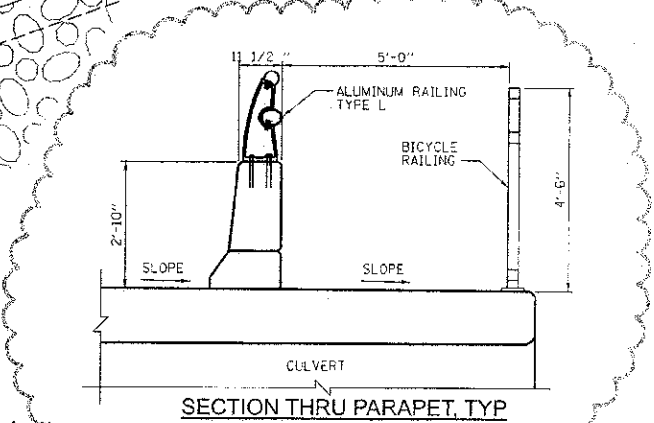
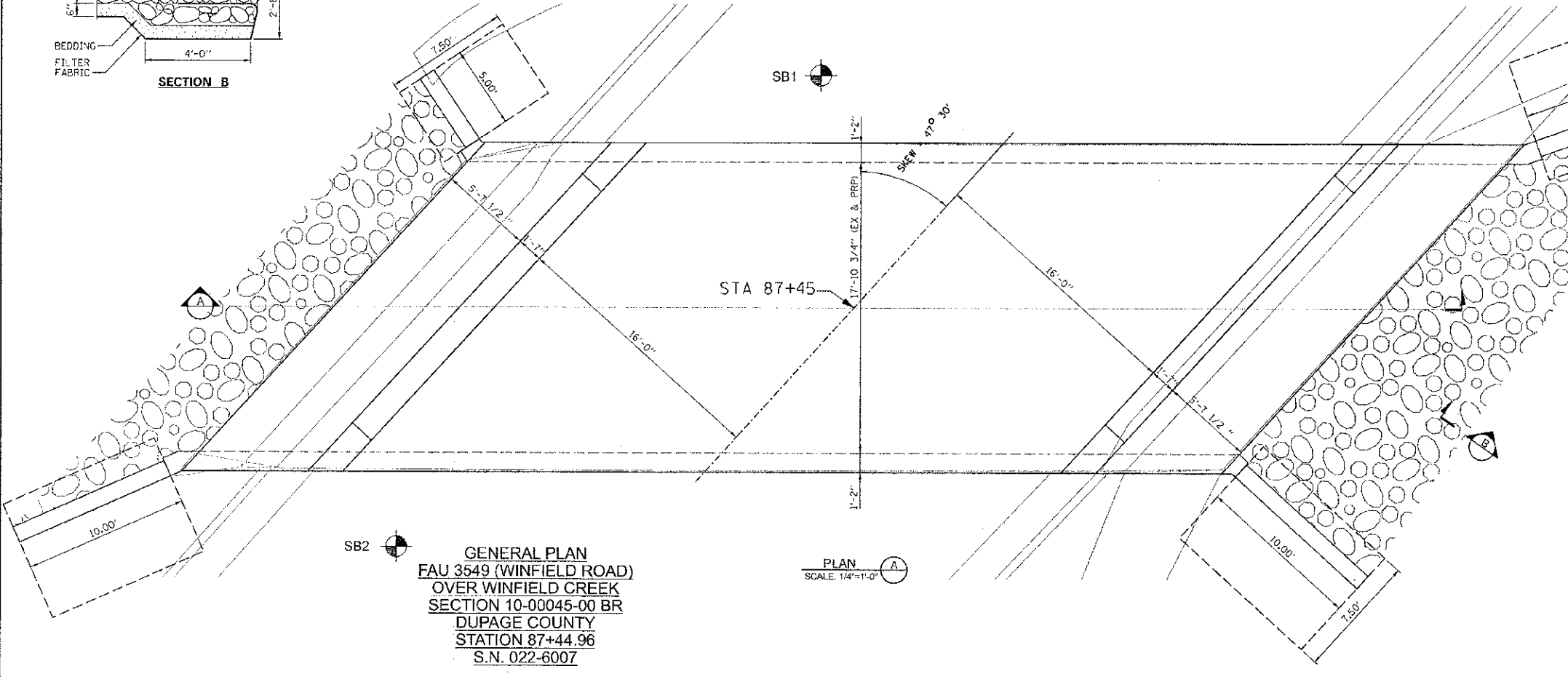
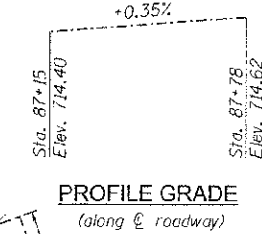

GENERAL PLAN
FAU 3549 (WINFIELD ROAD)
OVER WINFIELD CREEK
SECTION 10-00045-00 BR
DUPAGE COUNTY
STATION 87+44.96
S.N. 022-6007

FILE NAME =	USER NAME = #USER#	DESIGNED - D.R.	REVISED - 4/12/13	STATE OF ILLINOIS DEPARTMENT OF TRANSPORTATION	GENERAL PLAN AND ELEVATION STRUCTURE NO. 022-6007	F.A.U. I. R.E. = 2543	SECTION 10-00045-00-BR	COUNTY DUPAGE	TOTAL SHEETS 16	SHEET NO. 10
PLT SCALE = #SCALE#	DRAWN - G.R.	CHECKED - J.E.	REVISIONS			SCALE: STA. 86+71.54 TO STA. 88+18.46	FED. ROAD DIST. NO. 1	ILLINOIS FED. AID PROJECT	CONTRACT NO. 63812	
PLT DATE = #DATE#	DATE									