

DATE	
BY	
REVISIONS	
PLANNED	
ALIGNED	
CHECKED	
DATE	
FILE NAME	
NO.	

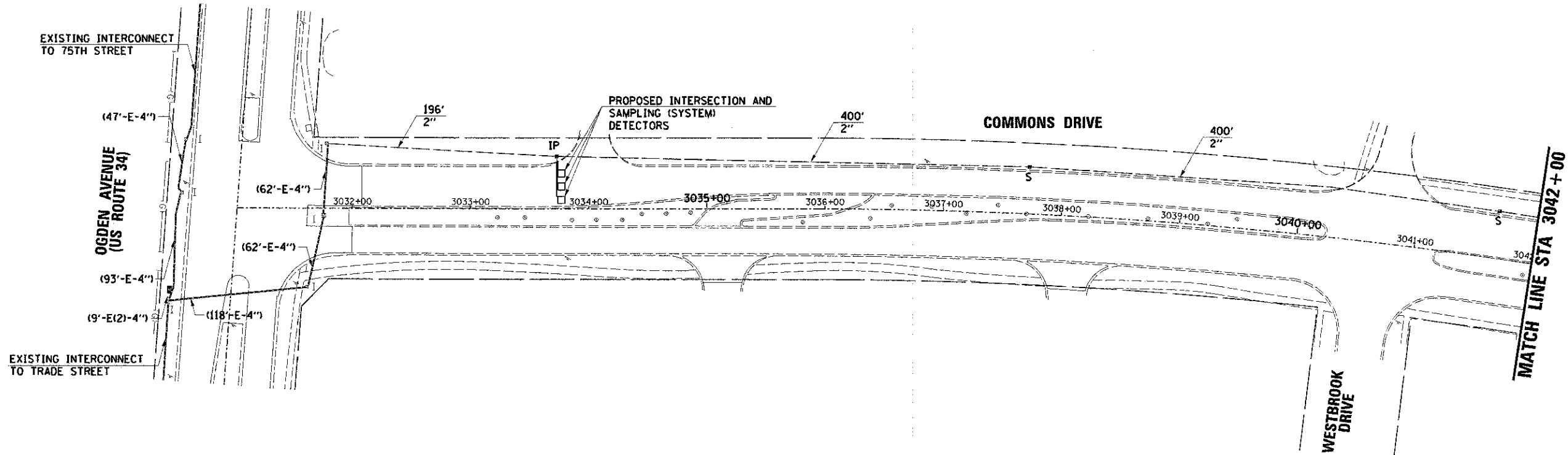

DATE	
BY	
REVISIONS	
PROFILE	
GRADES	
CHECKED	
DATE	
FILE NAME	
NO.	

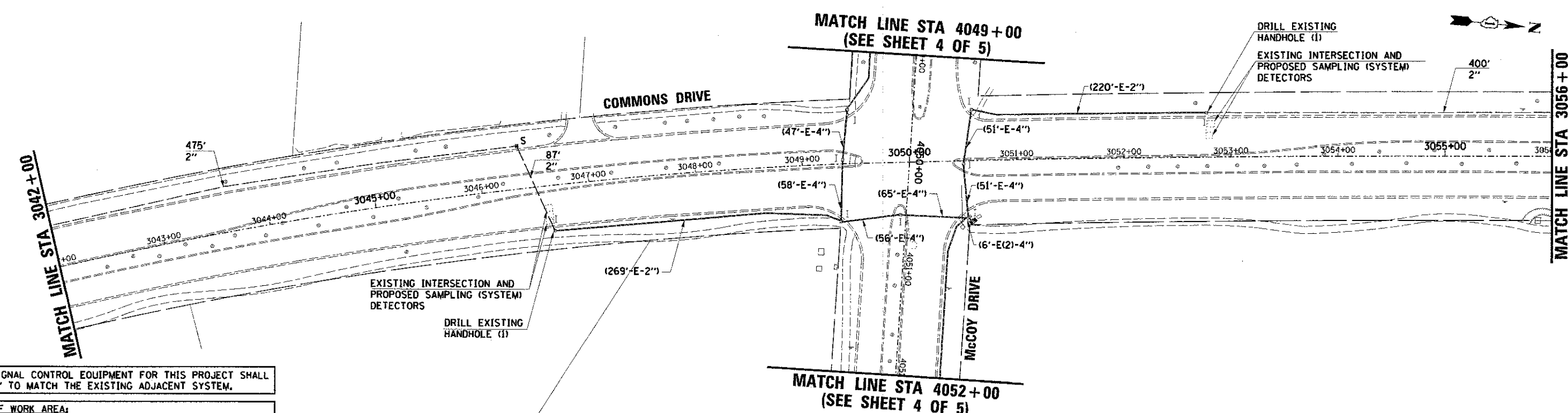

THE TRAFFIC SIGNAL CONTROL EQUIPMENT FOR THIS PROJECT SHALL BE "ECONOLITE" TO MATCH THE EXISTING ADJACENT SYSTEM.

RESTORATION OF WORK AREA:
 RESTORATION OF THE TRAFFIC SIGNAL WORK AREA SHALL BE INCIDENTAL TO THE RELATED PAY ITEM SUCH AS FOUNDATION, CONDUIT, HANDHOLE, TRENCH AND BACKFILL, ETC., AND NO EXTRA COMPENSATION SHALL BE ALLOWED. ALL ROADWAY SURFACES SUCH AS SHOULDERS, MEDIANS, SIDEWALKS, PAVEMENT, ETC. SHALL BE REPLACED IN KIND. ALL DAMAGE TO MOWED LAWNS SHALL BE REPLACED WITH AN APPROVED SOD, AND ALL DAMAGE TO UNMOWED FIELDS SHALL BE SEEDING IN ACCORDANCE WITH STANDARD SPECIFICATIONS 252 AND 250 RESPECTIVELY.

LEGEND

---	EXISTING RIGHT-OF-WAY
-----	EXISTING PERMANENT EASEMENT

HRGreen.com Illinois Professional Design Firm #104-001322	USER NAME = Mjoller PLOT SCALE = PLOT DATE = 2/22/2013 FILE NAME = 690_10_sigm01.dgn	DESIGNED - MJF CHECKED - APS DATE - 02/21/2013	REVISED - REVISED - REVISED - REVISED -	STATE OF ILLINOIS DEPARTMENT OF TRANSPORTATION	INTERCONNECT PLAN (SHEET 1 OF 5)	F.A.U. RTE. 1531/2532 SECTION 11-00297-00-TL COUNTY DUPAGE TOTAL SHEETS 38 SHEET NO. 28 CONTRACT NO. 63816	SCALE: SHEET NO. OF SHEETS STA. TO STA. FED. ROAD DIST. NO. ILLINOIS FED. AID PROJECT
---	---	--	--	---	---	---	--