

Notes:  
 See Sheet 22 of 35 for North Abutment details, Bill of Material, Plan-Pile Location and s(E) bar spacing.  
 Bars indicated thus 20 x 3-#5 etc. indicates 20 lines of bars with 3 lengths per line.  
 For details of Bar Splicers, See Sheet 32 of 35.  
 For details of piles and Concrete Encasement, See Sheet 30 of 35.  
 The back face of the MSE wall shall be flush against the side of the abutment. Adjust abutment length as required.

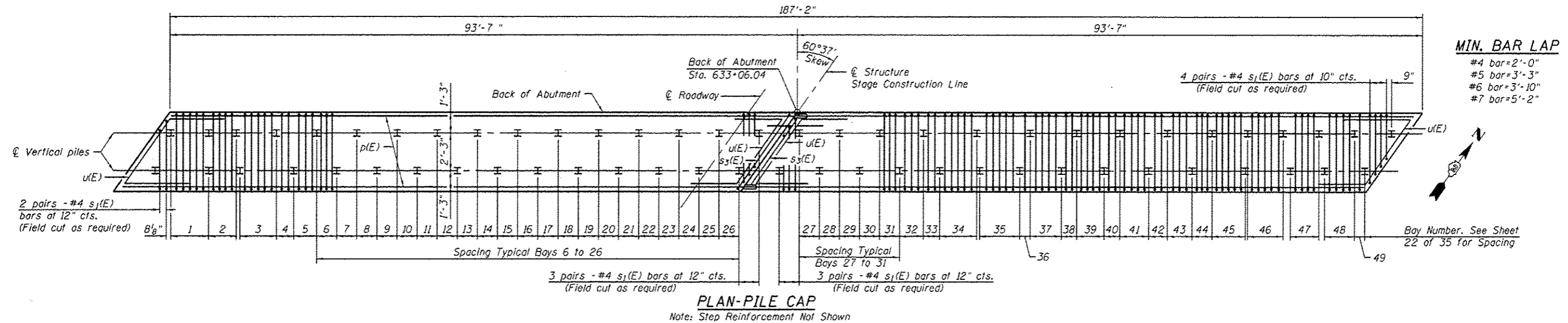
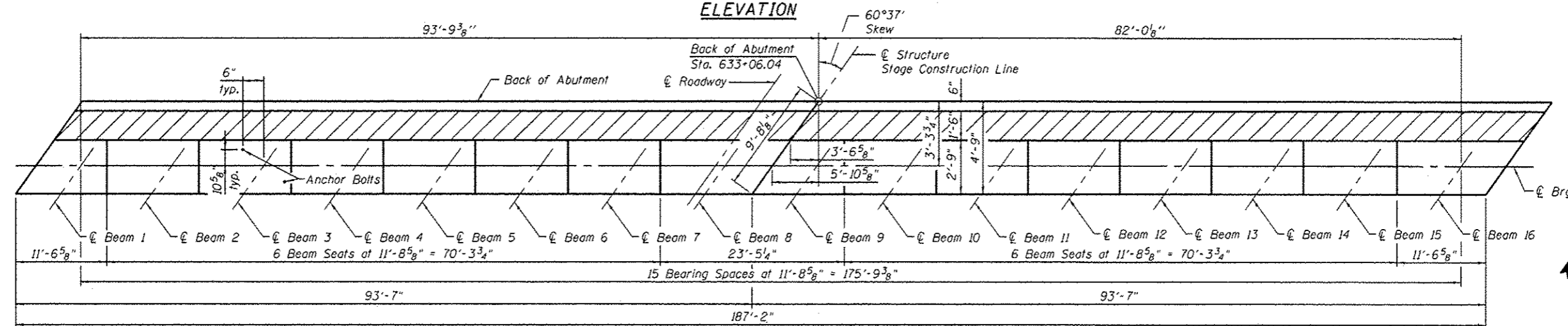
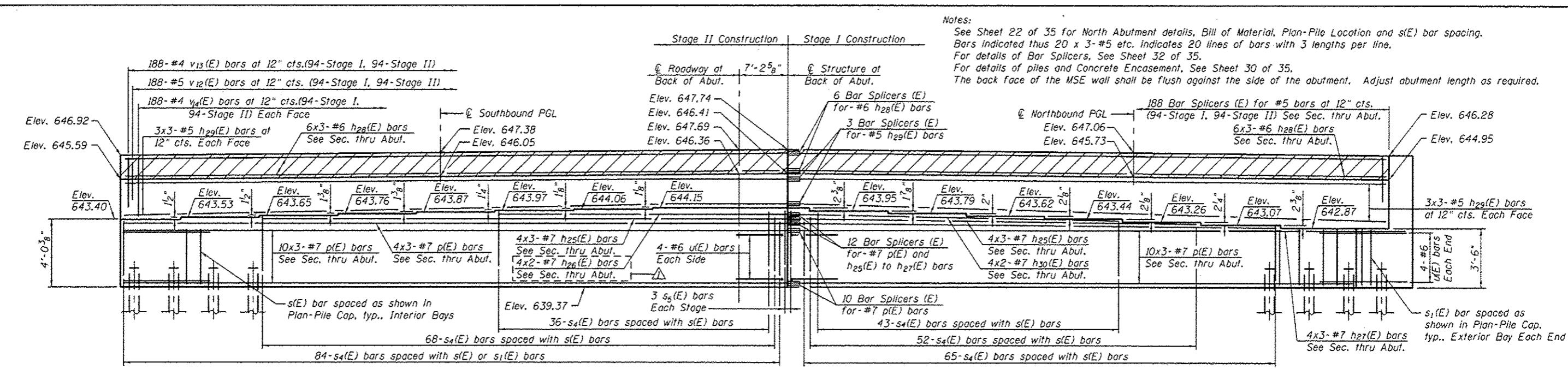

FILE NAME: S:\102\6288--(599)6345\B25\MicroStation\Structural\Plan\0980015-64C17-021-104BIT.dgn

1170 SOUTH HOUBOLT ROAD JOLIET, ILLINOIS 60451 (815) 744-4200 IDPRR NO. 184-001273	USER NAME: *brunf PLOT SCALE: PLOT DATE: 4/9/2013	DESIGNED - RRD CHECKED - AJS DRAWN - BJF CHECKED - RRD	REVISED $\Delta$ RRD 4/5/2013 REVISED REVISED REVISED	STATE OF ILLINOIS DEPARTMENT OF TRANSPORTATION	NORTH ABUTMENT DETAILS (1 OF 2) STRUCTURE NO. 098-0015 SHEET NO. 21 OF 35 SHEETS	F.A.P. RTE. 646 SECTION 101 BR-3 COUNTY WHITESIDE CONTRACT NO. 64C17	TOTAL SHEETS 113 SHEET NO. 77 ILLINOIS FED. AID PROJECT
---	---	---	--	---	--	---	---