

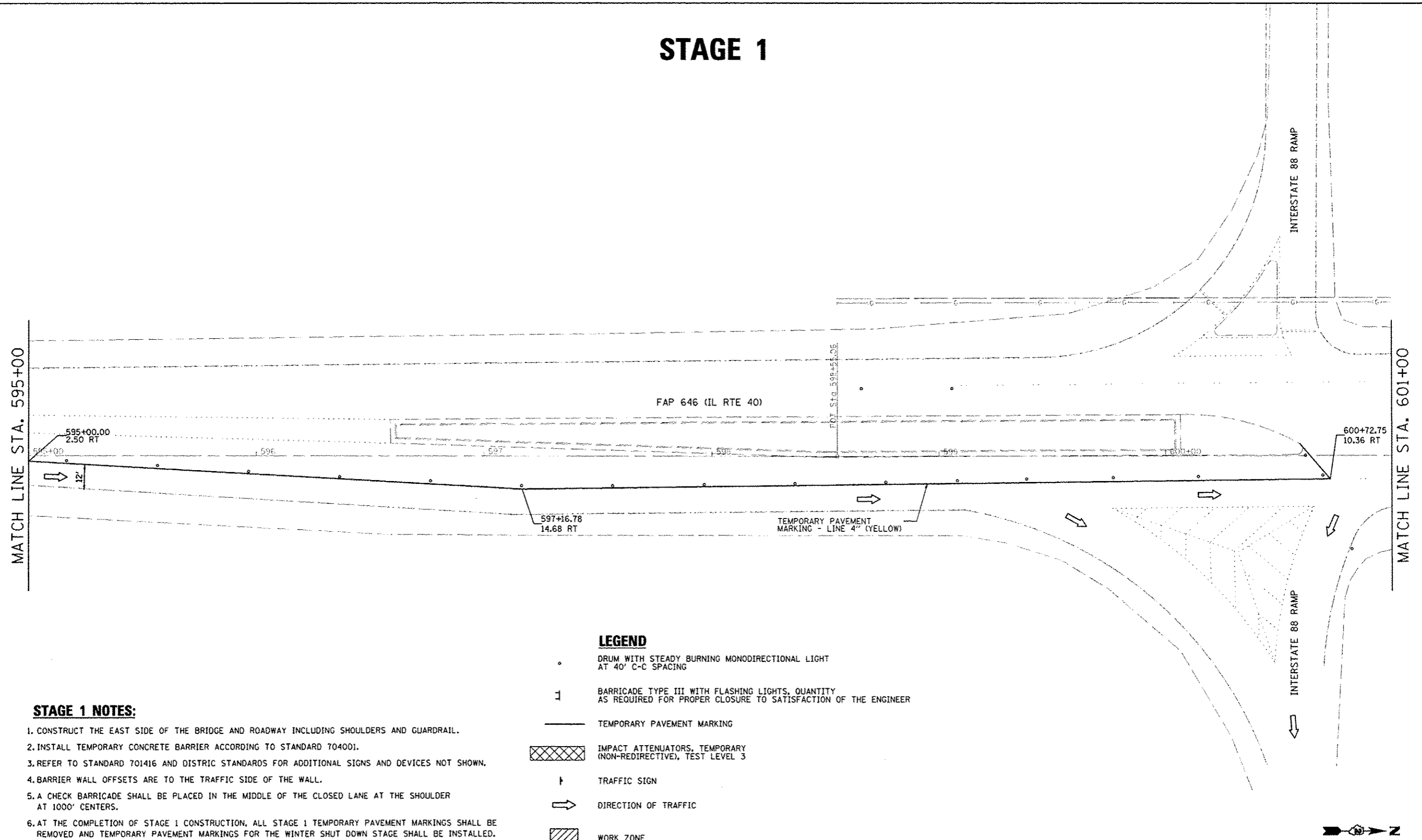







STAGE 1



STAGE 1 NOTES:

1. CONSTRUCT THE EAST SIDE OF THE BRIDGE AND ROADWAY INCLUDING SHOULDERS AND GUARDRAIL.
2. INSTALL TEMPORARY CONCRETE BARRIER ACCORDING TO STANDARD 704001.
3. REFER TO STANDARD 701416 AND DISTRICT STANDARDS FOR ADDITIONAL SIGNS AND DEVICES NOT SHOWN.
4. BARRIER WALL OFFSETS ARE TO THE TRAFFIC SIDE OF THE WALL.
5. A CHECK BARRICADE SHALL BE PLACED IN THE MIDDLE OF THE CLOSED LANE AT THE SHOULDER AT 1000' CENTERS.
6. AT THE COMPLETION OF STAGE 1 CONSTRUCTION, ALL STAGE 1 TEMPORARY PAVEMENT MARKINGS SHALL BE REMOVED AND TEMPORARY PAVEMENT MARKINGS FOR THE WINTER SHUT DOWN STAGE SHALL BE INSTALLED.

LEGEND

-  DRUM WITH STEADY BURNING MONODIRECTIONAL LIGHT AT 40' C-C SPACING
-  BARRICADE TYPE III WITH FLASHING LIGHTS, QUANTITY AS REQUIRED FOR PROPER CLOSURE TO SATISFACTION OF THE ENGINEER
-  TEMPORARY PAVEMENT MARKING
-  IMPACT ATTENUATORS, TEMPORARY (NON-REDIRECTIVE), TEST LEVEL 3
-  TRAFFIC SIGN
-  DIRECTION OF TRAFFIC
-  WORK ZONE



Rev. 2-20-13

FILE NAME = H:\JUL16389-639916346-025\mcd\04\1\026417-INT-Stage1R2.dgn

SA STRAND ASSOCIATES
 1170 SOUTH HOUBOLT ROAD
 JOLIET, ILLINOIS 60431
 (815) 744-4200

USER NAME = vonesan	DESIGNED - VLF	REVISED -
PLOT SCALE = 48.0000 / IN.	DRAWN - DJW	REVISED -
PLOT DATE = 2/18/2013	CHECKED - MAG	REVISED -
	DATE - 10-12-12	REVISED -

**STATE OF ILLINOIS
 DEPARTMENT OF TRANSPORTATION**

MAINTENANCE OF TRAFFIC STAGE 1			
SCALE: 1" = 20'	SHEET 2 OF 21 SHEETS	STA. 595+00 TO STA. 601+00	FED. ROAD DIST. NO. 2 ILLINOIS FED. AID PROJECT

F.A.P. RTE. 646	SECTION 101 BR-3	COUNTY WHITESIDE	TOTAL SHEETS 113	SHEET NO. 31
CONTRACT NO. 64C17				