

STATE OF ILLINOIS
DEPARTMENT OF TRANSPORTATION

PROJECT NO.	SECTION	SHEET	TOTAL SHEETS
	Whiteside	7	3 SHEETS
Contract Number: 64C67			

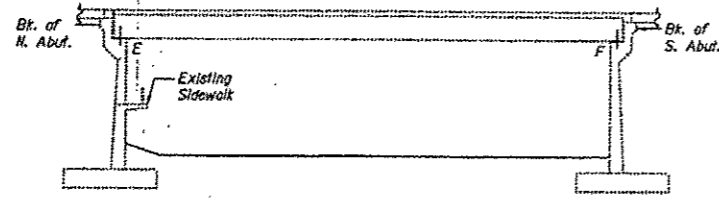

ELEVATION

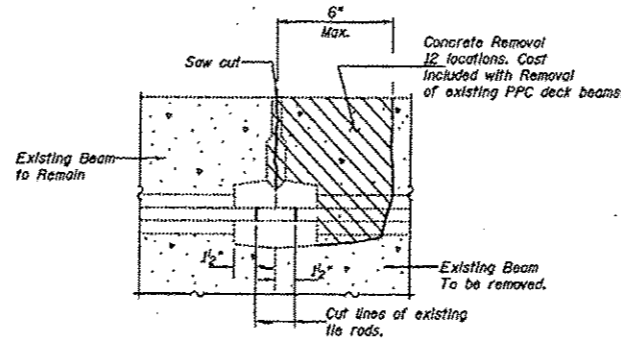

BEAM REMOVAL DETAIL
AT TRANSVERSE TIES

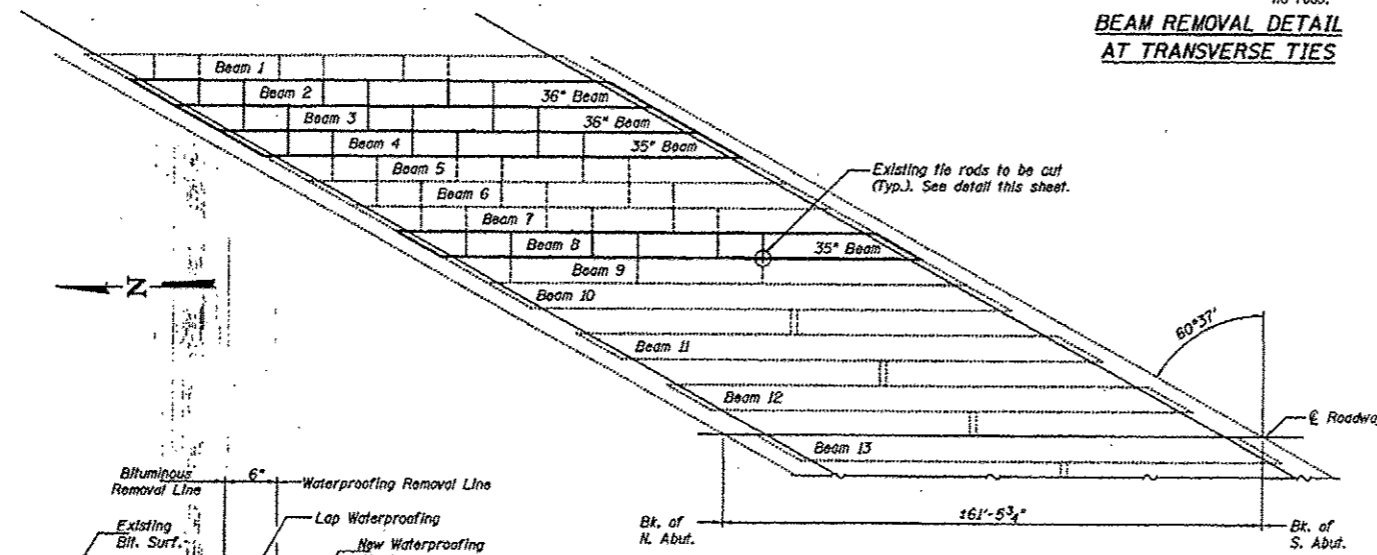

PLAN

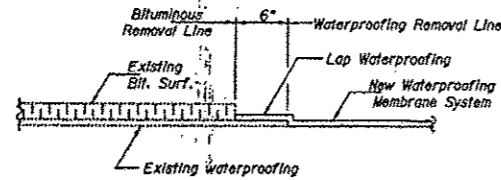

WATERPROOFING TREATMENT

GENERAL NOTES

Plan dimensions and details relative to existing structure have been taken from existing plans and are subject to nominal construction variations. It shall be the Contractor's responsibility to verify such dimensions and details in the field and make necessary approved adjustments prior to construction or ordering of materials. Such variations shall not be cause for additional compensation for a change in the scope of the work, however, the Contractor will be paid for the quantity actually furnished at the unit price bid for the work.

The cut strands at each beam end shall be given two coats of zinc dust spray or paint meeting the requirements of ASTM A780. The zinc dust spray or paint shall be applied before corrosion appears and allowed to dry according to manufacturer's specifications prior to another coat of zinc. This work shall be performed by the producer and included with the cost of the beam.

Any damage done to the bridge during beam removal shall be repaired by the Contractor. Cost to be included in the cost of Removal of Existing PPC Deck Beams.

The top surfaces of the beams shall be finished in accordance with Article 504.06 of the Standard Specifications except that the surface shall not be roughened by brooming. The finished surface shall be free of depressions or high spots with sharp corners, and the top edge of keys shall be rounded or chamfered a minimum of 1/4".

If required to be anchored, temporary concrete barrier shall only be anchored into the overlay and not the PPC Deck Beams.

All construction joints shall be bonded.

See Roadway Plans for Stage Construction Details.

The minimum thickness of the Bituminous concrete overlay shall be 1 1/2" and varies as required to adjust for the existing profile grade and beam camber.

All structural steel shall be shop painted with the inorganic zinc rich primer per AASHTO M300, Type 1. Cost included with Furnishing and Erecting Structural Steel.

TOTAL BILL OF MATERIAL

ITEM	UNIT	QUANTITY
Removal of Existing PPC Deck Beams	Sq. Ft.	659
PPC Deck Beams (21" Depth)	Sq. Ft.	650
PC Mortar Fairing Course	Foot	330
Waterproofing Membrane System	Sq. Yd.	917
Asbestos Bearing Pad Removal	Each	4
Bituminous Concrete Surface Course, Superpave Mix "D" #50	Ton	10.3
Furnishing and Erecting Structural Steel	Pound	210
Bituminous Concrete Surface Removal	Sq. Yd.	18.5
Silicone Joint Sealer, 1/2"	Foot	25

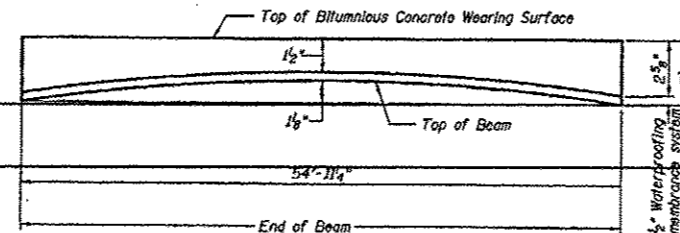

ANTICIPATED INITIAL CAMBER DIAGRAM

DESIGN STRESSES

PRECAST UNITS

$f'_c = 5,000$ psi
 $f'_s = 4,000$ psi
 $f'_s = 270,000$ psi (1/2" # low lax strands)
 $f'_s = 201,960$ psi (1/2" # low lax strands)

PLAN AND ELEVATION
IL 40 / HENNEPIN CANAL FEEDER
WHITESIDE COUNTY
SN 098-0015

DESIGNED: *[Signature]*
 CHECKED: *[Signature]*
 DRAWN: *[Signature]*
 CHECKED: *[Signature]*

August 4, 2006
 EXAMINED: *[Signature]*
 PASSED: *[Signature]*



Expires November 30, 2005

SLT-92-001-06

FILE NAME: <i>[Path]</i>	USER NAME: granton	DESIGNED: -	REVISED: -
11-sh1-details.dgn		DRAWN: -	REVISED: -
PLOT SCALE: 1/8"=1'-0"		CHECKED: -	REVISED: -
PLOT DATE: Wed Feb 28 15:23:35 2013		DATE: -	REVISED: -

STATE OF ILLINOIS
DEPARTMENT OF TRANSPORTATION

EXISTING GENERAL PLAN AND ELEVATION
STRUCTURE NO. 098-0015

SHEET 35 OF 35 SHEETS

F.A.P. R.T.C.	SECTION	COUNTY	TOTAL SHEETS
646	101-BB-3	WHITESIDE	113
CONTRACT NO. 64C17			917
ILLINOIS FED. AID PROJECT			

FOR INFORMATION ONLY

Added Sheet 2-20-13