

STATE OF ILLINOIS
DEPARTMENT OF TRANSPORTATION
DIVISION OF HIGHWAYS

F.A.P. RTE.	SECTION	COUNTY	TOTAL SHEETS	SHEET NO.
623	(G,G-1,G-R)RS-5	LASALLE	19	1
		ILLINOIS	CONTRACT NO. 66947	

D-93-045-09

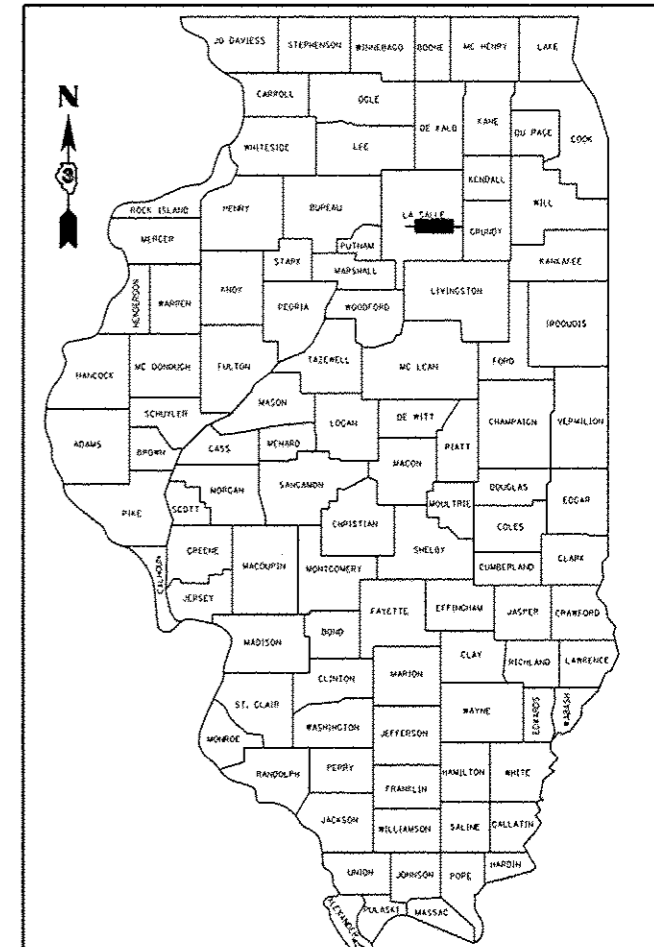

LOCATION OF SECTION INDICATED THUS: - [black rectangle] -

FUNCTIONAL CLASSIFICATION-
MINOR ARTERIAL (RURAL)

2011 ADT = 4400 VPD
PV = 95.7% SU = 2.3% % MU = 2%

STATE OF ILLINOIS
DEPARTMENT OF TRANSPORTATION
DIVISION OF HIGHWAYS

SUBMITTED 11-14 2012
Paul A. Carter
DEPUTY DIRECTOR OF HIGHWAYS, REGION ENGINEER

March 22 2013
John D. Baranzoli, P.E.
ENGINEER OF DESIGN AND ENVIRONMENT

March 22 2013
Onor Osman, P.E.
DIRECTOR OF HIGHWAYS, CHIEF ENGINEER

PRINTED BY THE AUTHORITY
OF THE STATE OF ILLINOIS

PROPOSED
HIGHWAY PLANS

FAP ROUTE 623 (US 6)
SECTION (G,G-1,G-R)RS-5
PROJECT: ACF-0623(032)
TYPE of IMPROVEMENT-3P RESURFACING
LASALLE COUNTY

C-93-082-09

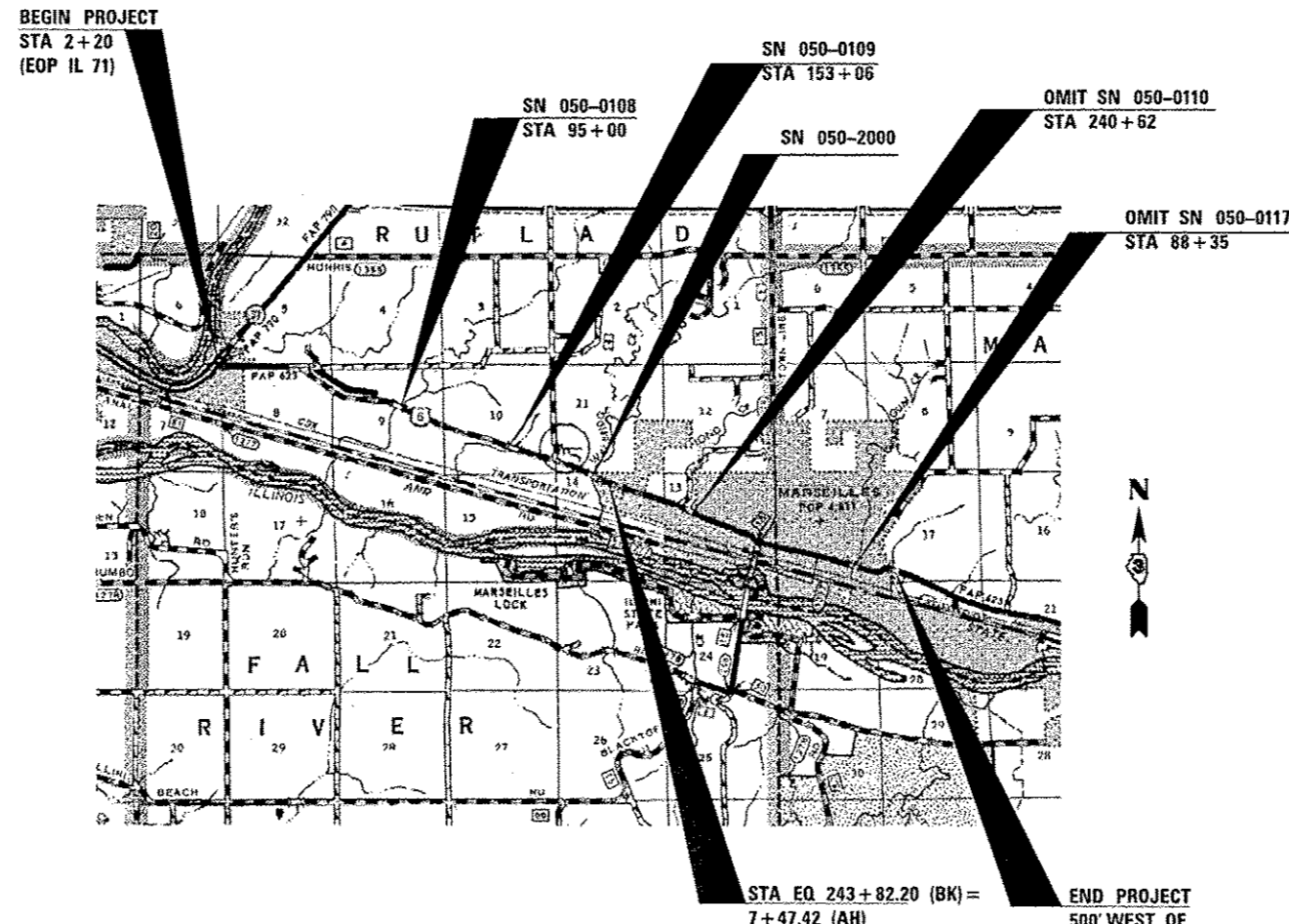

GROSS LENGTH = 34,051 FT. = 6.45 MILE
NET LENGTH = 33,907 FT. = 6.42 MILE

INDEX OF SHEETS

- 1 COVER SHEET
- 2 GENERAL NOTES & LOCATION MAP
- 3-6 SUMMARY OF QUANTITIES
- 7-8 TYPICAL SECTIONS
- 9-13 SCHEDULES
- 14 STRAIGHT LINE DIAGRAM
- 15-19 DETAILS

STANDARDS

- 000001-06 STANDARD SYMBOLS, ABBREVIATIONS AND PATTERNS
- 001006 DECIMAL OF AN INCH AND OF A FOOT
- 406201-01 MAILBOX TURNOUT
- 424001-07 CURB RAMPS FOR SIDEWALK
- 606001-04 CONCRETE CURB TYPE B AND COMBINATION CONCRETE CURB AND GUTTER
- 630301-06 SHOULDER WIDENING FOR TYPE I (SPECIAL) GUARDRAIL TERMINALS
- 635006-03 REFLECTOR AND TERMINAL MARKER PLACEMENT
- 701001-02 OFF-ROAD OPERATIONS 2L, 2W, MORE THAN 15' (4.5 m) AWAY
- 701006-04 OFF-ROAD OPERATIONS 2L, 2W, 15' (4.5 m) TO 24' (600 mm) FROM PAVEMENT EDGE
- 701011-03 OFF-ROAD MOVING OPERATIONS 2L, 2W, DAY ONLY
- 701201-04 LANE CLOSURE, 2L, 2W, DAY ONLY, FOR SPEEDS **e** 45 MPH
- 701301-04 LANE CLOSURE, 2L, 2W, SHORT TIME OPERATIONS
- 701306-93 LANE CLOSURE, 2L, 2W, SLOW MOVING OPERATIONS DAY ONLY, FOR SPEEDS **e** 45 MPH
- 701311-03 LANE CLOSURE, 2L, 2W, MOVING OPERATIONS - DAY ONLY
- 701501-04 URBAN LANE CLOSURE, 2L, 2W, UNDIVIDED
- 701502-05 URBAN LANE CLOSURE, 2L, 2W, WITH BIDIRECTIONAL LEFT TURN LANE
- 701801-05 LANE CLOSURE, MULTILANE 1W OR 2W CROSSWALK OR SIDEWALK CLOSURE
- 701901-02 TRAFFIC CONTROL DEVICES
- 780001-03 TYPICAL PAVEMENT MARKINGS
- 781001-03 TYPICAL APPLICATIONS RAISED REFLECTIVE PAVEMENT MARKERS
- 701321-13 LANE CLOSURE, 2L, 2W, BRIDGE REPAIR W/ BARRIER

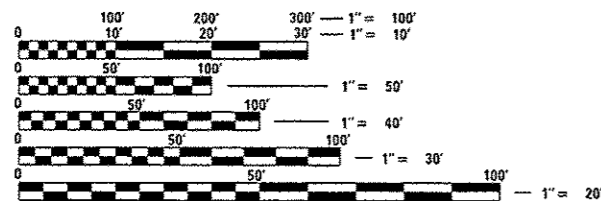

FULL SIZE PLANS HAVE BEEN PREPARED USING STANDARD ENGINEERING SCALES. REDUCED SIZED PLANS WILL NOT CONFORM TO STANDARD SCALES. IN MAKING MEASUREMENTS ON REDUCED PLANS, THE ABOVE SCALES MAY BE USED.

J.U.L.I.E.
JOINT UTILITY LOCATION INFORMATION FOR EXCAVATION
1-800-892-0123
OR 811

PROJECT ENGINEER-JOE KANNEL
UNIT CHIEF-PAT BRABOY
TOWNSHIP-FALL RIVERMANLIUS
CONTRACT NO. 66947

GENERAL NOTES

THE THICKNESS OF HMA SHOWN ON THE PLANS IS THE NOMINAL THICKNESS. DEVIATIONS FROM THE NOMINAL THICKNESS WILL BE PERMITTED WHEN SUCH DEVIATIONS OCCUR DUE TO IRREGULARITIES IN THE EXISTING SURFACE OR BASE ON WHICH THE HMA IS PLACED.

THE HMA SURFACE OF ALL MAILBOX TURNOUTS, PRIVATE ENTRANCES, COMMERCIAL ENTRANCES, AND SIDE ROADS SHALL BE MADE NEATLY, IN A WORKMANLIKE MANNER, AND SHALL ACCURATELY CONFORM TO THE SHAPES AND DIMENSIONS SHOWN ON THE PLAN DETAILS. IF REQUIRED BY THE ENGINEER, THE CONTRACTOR SHALL BE REQUIRED TO SAW CUT THE HMA SURFACE TO CONFORM TO THE SHAPES AND DIMENSIONS SHOWN ON THE PLAN DETAILS. THIS WORK SHALL BE INCLUDED IN THE COST OF THE HMA SURFACE.

THE ENGINEER WILL BE THE SOLE JUDGE CONCERNING CURING TIME FOR THE VARIOUS HMA LIFTS.

SEEDING SHALL NOT BE PERMITTED AT ANY TIME WHEN THE GROUND IS FROZEN, WET, OR IN AN UNTILLABLE CONDITION. LOCATIONS TO BE SEEDED WILL BE DETERMINED BY THE ENGINEER.

THE FINISHED EARTHWORK SHALL HAVE A VEGETATION SUSTAINING SOIL COVERING THE TOP FOUR INCHES (100 MILLIMETERS) IN AREAS TO BE SEEDED OR SODDED. THE VEGETATION SUSTAINING SOIL REQUIRED WILL NOT BE PAID FOR SEPARATELY BUT SHALL BE INCLUDED IN THE COST OF FURNISHED EXCAVATION.

ON EXISTING PAVEMENT WHICH MAY BE SUPERELEVATED, THE NEW HMA PAVEMENT SHALL BE BUILT WITH THE SAME SUPERELEVATION UNLESS NEW SUPERELEVATION RATES ARE GIVEN ON THE PLANS.

ALL ELEVATIONS REFERRING TO U.S.G.S. MEAN SEA LEVEL DATUM.

ANY REFERENCE TO A STANDARD IN THESE PLANS SHALL BE INTERPRETED TO MEAN THE EDITION AS INDICATED BY THE SUBNUMBER SHOWN IN THE LIST OF STANDARDS OR THE COPY INCLUDED IN THESE PLANS.

THE FOLLOWING RATES OF APPLICATION HAVE BEEN USED IN CALCULATING PLAN QUANTITIES:

GRANULAR MATERIALS	2.05	TONS / CU YD
AGGREGATE (PRIME COAT)	0.002	TONS / SQ YD
HMA RESURFACING	112	LBS / SQ YD / IN
SHORT TERM PAVEMENT MARKING	10	FT / 100 FT OF APPLICATION
MIX FOR CRACKS, JTS & FLOWYS	0.0003	TONS / SQ YD
LEVEL BINDER (HAND METHOD)	0.0005	TONS / SQ YD
SUPPLEMENTAL WATERING	3	GAL / SQ YD / APPLICATION
CALCIUM CHLORIDE	2	LB / SQ YD / APPLICATION
AGGREGATE DITCH CHECKS	5	TONS AGGREGATE

BITUMINOUS MATERIALS (PRIME COAT) RATES		
SURFACE TYPE	ESTIMATED TRUCK APPLICATION RATE	RESIDUAL RATE
AGGREGATE BASES	0.375 GAL / SQ YD	N/A
MILLED HMA OR PCC PAVEMENT	0.08 GAL / SQ YD	0.04 GAL / SQ YD
EXISTING PAVEMENT	0.05 GAL / SQ YD	0.025 GAL / SQ YD
FOG COAT (BETWEEN ADDITIONAL HMA LIFTS)	0.05 GAL / SQ YD	0.025 GAL / SQ YD

ESTIMATED TRUCK APPLICATION RATE USED FOR CALCULATING PLAN QUANTITIES

THE CONTRACTOR SHALL CONTACT JULIE AT LEAST 48 HOURS PRIOR TO EXCAVATION TO DETERMINE WHICH UTILITIES ARE IN THE AREA.

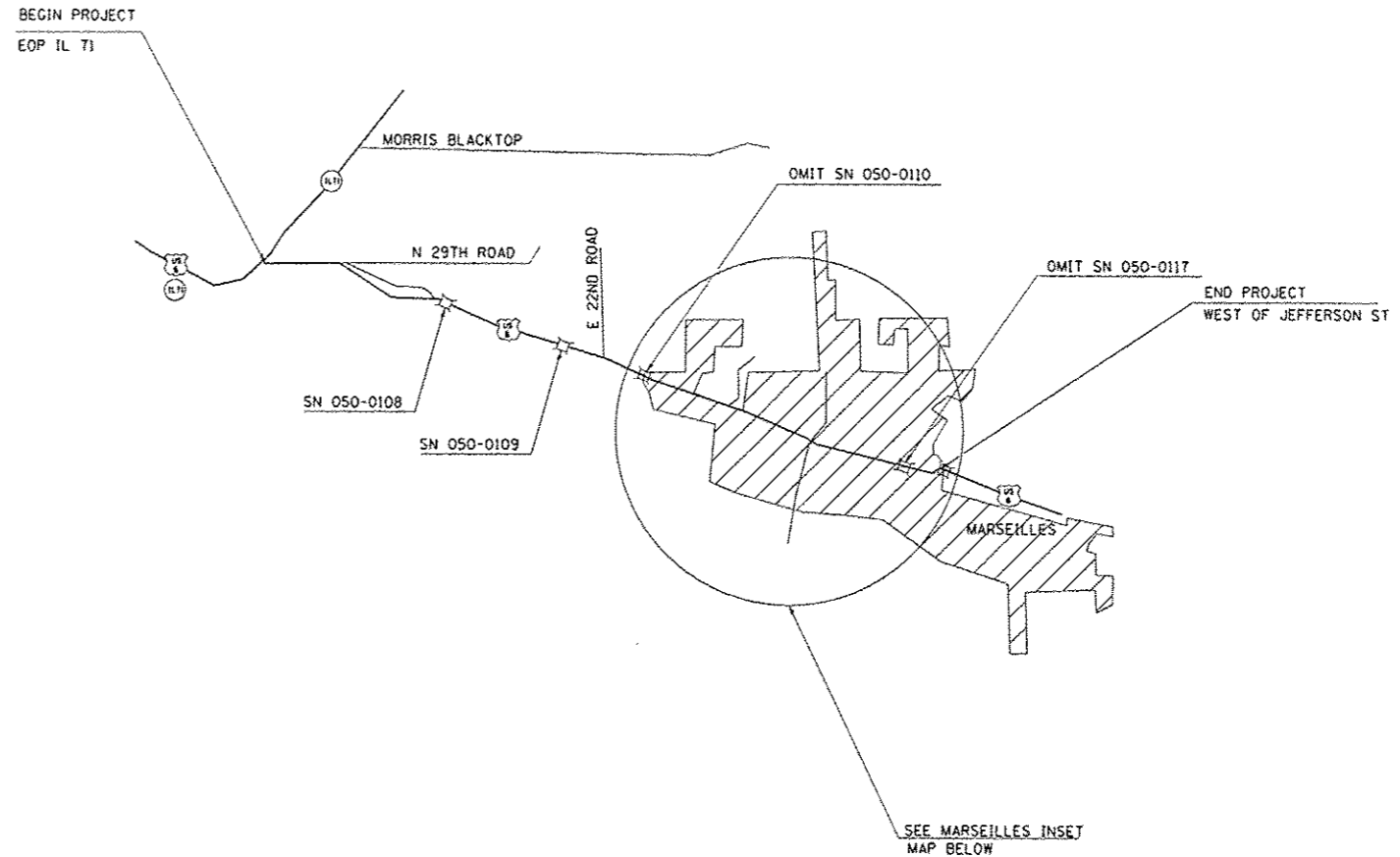

LOCATION MAP (NOT TO SCALE)

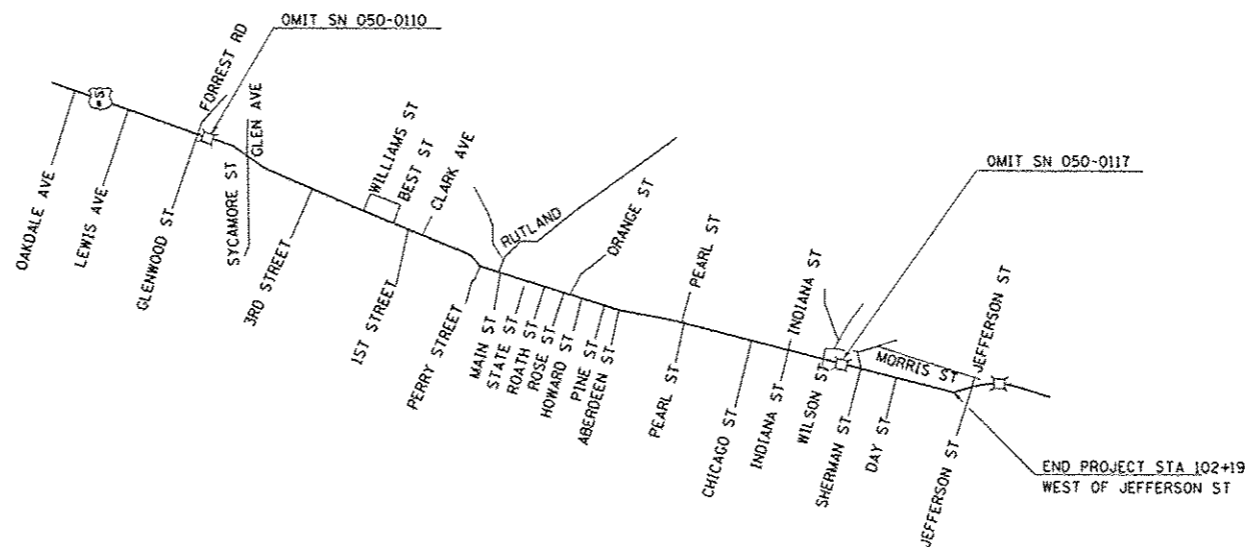

MARSEILLES INSET MAP (NOT TO SCALE)

STATE OF ILLINOIS
DEPARTMENT OF TRANSPORTATION
DISTRICT THREE

PREPARED BY: Don Prankers
DISTRICT STUDIES & PLANS ENGINEER

DATE: 11/14/12

EXAMINED BY: Herbert K. Long
DISTRICT CONSTRUCTION ENGINEER

Wayne C. Phillips
DISTRICT MATERIALS ENGINEER

James A. Huber
DISTRICT OPERATIONS ENGINEER

FILE NAME: c:\pwork\pwork\plotschtr\0122685\03	USER NAME: plotschtr	DESIGNED - designed by	REVISED - revised by1	STATE OF ILLINOIS DEPARTMENT OF TRANSPORTATION	GENERAL NOTES AND LOCATION MAP	F.A.P. RTE. 623	SECTION (G.G-1.G-R)RS-5	COUNTY LASALLE	TOTAL SHEETS 19	SHEET NO. 2	
947-sht-details.dwg	DRAWN - drawn by	REVISED - revised by2	SCALE: _____			SHEET NO. _____ OF _____ SHEETS	STA. _____ TO STA. _____	CONTRACT NO. 66947		ILLINOIS FED. AID PROJECT	
PLOT SCALE = 100.000 sf / in.	CHECKED - checked by	REVISED - revised by3									
PLOT DATE = 11/14/2012	DATE - checked_date	REVISED - revised by4									

RURAL
80% FED./20% STATE

CONSTRUCTION CODE
0005

CODE NO.	ITEM	UNIT	TOTAL QUANTITY	ROADWAY	
20101700	SUPPLEMENTAL WATERING	UNIT	10	10	
20400800	FURNISHED EXCAVATION	CU YD	174	64	110
25200110	SODDING, SALT TOLERANT	SO YD	376	376	
40600100	BITUMINOUS MATERIALS (PRIME COAT)	GALLON	15863	10977	4886
40600300	AGGREGATE (PRIME COAT)	TON	244	168	76
40600400	MIXTURE FOR CRACKS, JOINTS, AND FLANGEWAYS	TON	16	10	6
40600527	LEVELING BINDER (HAND METHOD), IL-9.5FG, N50	TON	27	17	10
40600627	LEVELING BINDER (MACHINE METHOD), IL-9.5FG, N50	TON	5623	3608	2015
40600895	CONSTRUCTING TEST STRIP	EACH	2	2	
40600990	TEMPORARY RAMP	SO YD	352	296	56
40603310	HOT-MIX ASPHALT SURFACE COURSE, MIX "C", N50	TON	9717	6620	3097
40800050	INCIDENTAL HOT-MIX ASPHALT SURFACING	TON	1088	887	201
42400100	PORTLAND CEMENT CONCRETE SIDEWALK 4 INCH	SO FT	3844	3844	
42400800	DETECTABLE WARNINGS	SO FT	568	568	

RURAL
80% FED./20% STATE

CODE NO.	ITEM	UNIT	TOTAL QUANTITY	CONSTRUCTION CODE	
				ROADWAY	ROADWAY
				0005	
44000155	HOT-MIX ASPHALT SURFACE REMOVAL, 1 1/2"	SQ YD	57822	33236	24586
44000158	HOT-MIX ASPHALT SURFACE REMOVAL, 2 1/4"	SQ YD	54174	43174	11000
44000500	COMBINATION CURB AND GUTTER REMOVAL	FOOT	510	510	
44000600	SIDEWALK REMOVAL	SQ FT	3744	3744	
48101200	AGGREGATE SHOULDERS, TYPE B	TON	2559	1799	760
56109210	WATER VALVES TO BE ADJUSTED	EACH	11	11	
58100200	WATERPROOFING MEMBRANE SYSTEM	SQ YD	203		203
60255500	MANHOLES TO BE ADJUSTED	EACH	23	23	
60605000	COMBINATION CONCRETE CURB AND GUTTER, TYPE B-6.24	FOOT	510	510	
* 63100167	TRAFFIC BARRIER TERMINAL, TYPE I (SPECIAL) TANGENT	EACH	8		8
63200310	GUARDRAIL REMOVAL	FOOT	400		400
67000400	ENGINEER'S FIELD OFFICE, TYPE A	CAL MO	3	1.5	1.5
67100100	MOBILIZATION	L SUM	1	0.5	0.5
70100405	TRAFFIC CONTROL AND PROTECTION, STANDARD 701321	EACH	1	1	
70100460	TRAFFIC CONTROL AND PROTECTION, STANDARD 701306	L SUM	1	0.5	0.5

Rev.

ILLINOIS FED. AID PROJECT
CONTRACT NO. 66947

RURAL
80% FED. / 20% STATE

CODE NO.	ITEM	UNIT	TOTAL QUANTITY	CONSTRUCTION CODE	
				ROADWAY	ROADWAY
				0005	
70102620	TRAFFIC CONTROL AND PROTECTION, STANDARD 701501	L SUM	1		1
70102640	TRAFFIC CONTROL AND PROTECTION, STANDARD 701801	L SUM	1	1	0
70106500	TEMPORARY BRIDGE TRAFFIC SIGNALS	EACH	1	1	
70300100	SHORT TERM PAVEMENT MARKING	FOOT	13755	9594	4161
70300220	TEMPORARY PAVEMENT MARKING - LINE 4"	FOOT	63180	22915	40265
70300240	TEMPORARY PAVEMENT MARKING - LINE 6"	FOOT	8513	5996	2517
70400100	TEMPORARY CONCRETE BARRIER	FOOT	291	291	
70301000	WORK ZONE PAVEMENT MARKING REMOVAL	SO FT	1134	799	335
70400200	RELOCATE TEMPORARY CONCRETE BARRIER	FOOT	291	291	
* 78000200	THERMOPLASTIC PAVEMENT MARKING - LINE 4"	FOOT	4755	4755	
* 78000400	THERMOPLASTIC PAVEMENT MARKING - LINE 6"	FOOT	5280	5280	
* 78000500	THERMOPLASTIC PAVEMENT MARKING - LINE 8"	FOOT	251	251	
* 78000600	THERMOPLASTIC PAVEMENT MARKING - LINE 12"	FOOT	506	506	
* 78000650	THERMOPLASTIC PAVEMENT MARKING - LINE 24"	FOOT	108	108	
* 78001110	PAINT PAVEMENT MARKING - LINE 4"	FOOT	87535	47270	40265
* 78001130	PAINT PAVEMENT MARKING - LINE 6"	FOOT	10762	5729	5033
* 78100100	RAISED REFLECTIVE PAVEMENT MARKER	EACH	425	295	130

*Specialty Items

FILE NAME * #FILE#	USER NAME * #USER#	DESIGNED - _____	REVISED - _____	STATE OF ILLINOIS DEPARTMENT OF TRANSPORTATION	SUMMARY OF QUANTITIES	F.A.P. RTE. 623	SECTION (G.O.-I.G.-RRS-5)	COUNTY LASALLE	TOTAL SHEETS 19	SHEET NO. 5	
#MODELNAME#	PLOT SCALE * #SCALE#	CHECKED - _____	REVISED - _____			SCALE: _____	SHEET _____ OF _____ SHEETS	ILLINOIS FED. AID PROJECT		CONTRACT NO. 65947	
	PLOT DATE * #DATE#	DATE - _____	REVISED - _____			STA. _____ TO STA. _____					
Rev.											

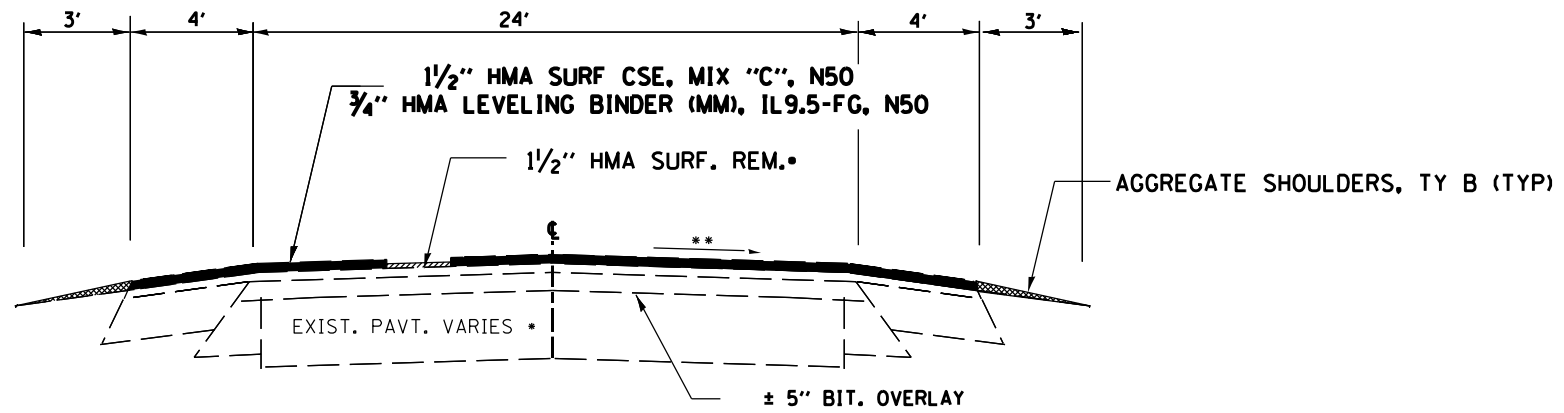

*NOTE: HALF THE DISTANCE OF EAST BOUND LANE SHALL BE MILLED 2 1/4" AND A TOTAL OF 3/4" LEVEL BINDER SHALL BE PLACED IN THIS SECTION AS WELL.
LOCATIONS TO BE DETERMINED BY THE RESIDENT ENGINEER.

PROPOSED TYPICAL SECTION

STA. 2+20 TO STA. 107+85
STA. 112+25 TO STA. 158+00
STA. 161+35 TO STA. 218+94
** MATCH EXIST. PAV'T. SLOPE

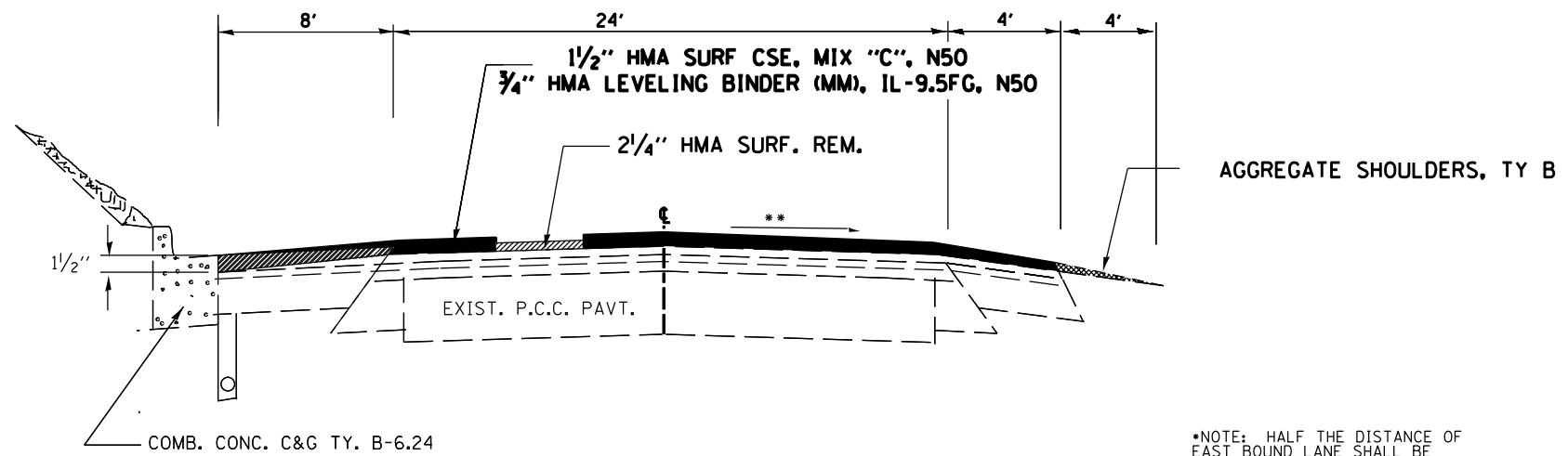

*NOTE: HALF THE DISTANCE OF EAST BOUND LANE SHALL BE MILLED 2 1/4" AND A TOTAL OF 3/4" LEVEL BINDER SHALL BE PLACED IN THIS SECTION AS WELL.
LOCATIONS TO BE DETERMINED BY THE RESIDENT ENGINEER.

PROPOSED TYPICAL SECTION

STA. 107+85 TO STA 112+25
STA. 158+00 TO STA 161+35
** MATCH EXIST. PAV'T. SLOPE

FILE NAME =	USER NAME = \$USER\$	DESIGNED - designed by	REVISED - revised by1	STATE OF ILLINOIS DEPARTMENT OF TRANSPORTATION	TYPICAL SECTIONS	F.A.P. RTE.	SECTION	COUNTY	TOTAL SHEETS	SHEET NO.	
\$FILEL\$		DRAWN - drawn by	REVISED - revised by2			623	(G.G-1.G-RIRS-5	LASALLE	19	7	
	PLOT SCALE = \$SCALE\$	CHECKED - checked by	REVISED - revised by3			CONTRACT NO. 66947					
	PLOT DATE = \$DATE\$	DATE - checked date	REVISED - revised by4			ILLINOIS FED. AID PROJECT					

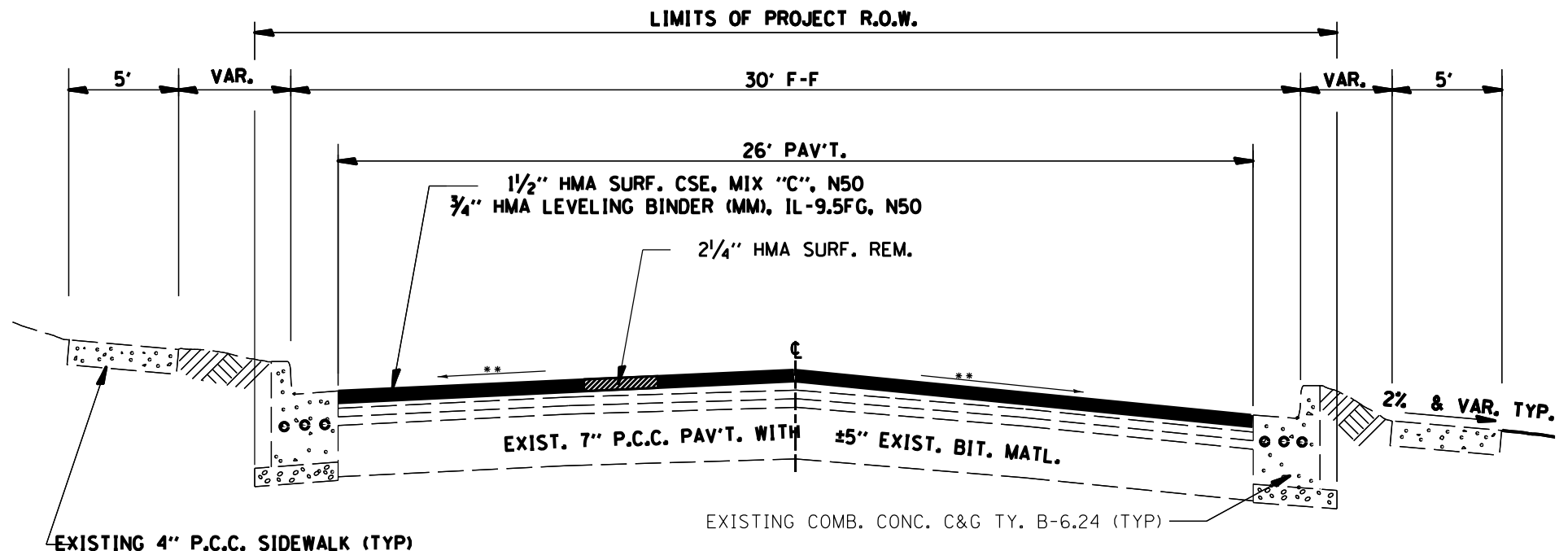

PROPOSED TYPICAL SECTION

STA. 218+94 TO STA. 113+90**
 ** MATCH EXIST. PAV'T. SLOPE

**STA. EQ. 243 + 82.2 BK
 = 7 + 47.42 AH

NOTE: FROM STA. 218+98 TO STA. 237+88
 EXIST PAVEMENT IS BIT BSE. (± 9")
 WITH ± 5" OVERLAY...

... STA. 225+91.85 (BK) = 225+60.39 (AH)

	HMA LEVEL BINDER	HMA SURFACE
PG GRADE	PG 64-22	PG 64-22
DESIGN AIR VOIDS	4.0% @ N50	4.0% @ N50
MIXTURE COMPOSITION	IL 9.5FG	IL 9.5
FRICTION AGGREGATE		MIXTURE C
DENSITY CONTROL LIMITS	OCP CORES	OCP CORES

MAINLINE																
LOCATION	WIDTH	LENGTH	AREA	HMA SURF REM 1-1/2"	HMA SURF REM 2-1/4"	HMA SURF REM COMP	HMA SURF REM (DECK)	WATER-PROOFING MEMBRANE SYSTEM	LEVEL BINDER (HM) IL-9.5FG N50	LEVEL BINDER (MM) IL-9.5FG N50	HMA SC MIX "C" N50	MIX CR JTS FLANGEWYS	BIT MATLS PR CT	AGG PR CT	TEMP RAMP	AGG SHLD TY B
STATION	FT	FT	SO YD	SO YD	SO YD	SO YD	SO YD	SO YD	TON	TON	TON	TON	GAL	TON	SO YD	TON
URBAN																
2+20 TO 91+12.10BK=90+76.19AH*	32	8892.1	31616.4	24616.0	7400.0				12.3	1638.7	2655.8	7.4	4110.1	63.2	8.0	675.1
90+76.19 TO 94+29.50	32	353.31	1256.2	1256.2					0.6	52.8	105.5	0.4	163.3			26.8
SN 050-0108 **	32	141.0	501.3				501.3				42.1		65.2	2.5		
95+70.50 TO 116+41.67	32	2071.17	7364.2	7364.2					3.7	309.3	618.6	2.2	957.3	14.7		157.3
217+02 TO 225+91.85BK=225+60.39AH	26	889.85	2570.7		2570.7				0.0	108.0	215.9	0.0	334.2	5.1		67.6
225+60.39 TO 240+24.26	26	1463.87	4229.0		4229.0				0.0	177.6	355.2	0.0	549.8	8.5	8.0	111.1
BR OMISSION SN 050-0110		76.0	0.0		0.0											
241+00.26 TO 243+82.20BK=7+47.42AH	26	281.94	814.5		814.5				0.0	34.2	68.4	0.0	105.9	1.6	8.0	21.4
7+47.42 TO 17+96.22BK=17+96.00AH	26	1048.8	3029.9		3029.9				0.0	127.3	254.5	0.0	393.9	6.1		79.6
17+96.00 TO 88+01.05	26	7005.05	20236.8		20236.8				0.0	849.9	1699.9	0.0	2630.8	40.5	8.0	531.9
BR OMISSION SN 050-0117		68.0	0.0		0.0											
88+69.05 TO 105+63	26	1693.95	4893.6		4893.6				0.0	205.5	411.1	0.0	636.2	9.8	8.0	128.6
URBAN TOTAL		23985	76513	33236	43174	0	501	0	17	3608	6620	10	9947	152	40	1799
RURAL																
116+41.67 TO 151+06.65BK=151+05.65AH*	32	3464.98	12319.9	8319.0	4000.0				4.2	685.4	1034.9	2.5	1601.6	24.6	8.0	263.1
151+05.65 TO 154+26.5	32	320.85	1140.8	1140.8					0.6	47.9	95.8	0.3	148.3	2.3	8.0	24.4
SN 050-0109	32	57.0	202.7				202.7	202.7			17.0		26.3	0.4		
154+83.5 TO 178+16.67BK=178+11.80AH*	32	2333.2	8295.7	6295.0	2000.0				1.0	432.4	696.8	0.6	1078.4	16.6		177.1
178+11.80 TO 217+02*	32	3890.2	13831.8	8831.0	5000.0				4.4	790.9	1161.9	2.6	1798.1	27.7		295.4
RURAL TOTAL		10066	35791	24586	11000	203	0	203	10	2015	3097	6	4653	72	16	760
GRAND TOTALS		34051	112303	57822	54174	203	501	203	27	5624	9716	16	14599	224	56	2559

STATION EQUATIONS:
 91+12.10 (BK) = 90+76.17 (AH)
 151+06.65 (BK) = 151+05.65 (AH)
 178+16.67 (BK) = 178+11.80 (AH)
 225+91.85 (BK) = 225+60.39 (AH)
 243+82.20 (BK) = 7+47.42 (AH)
 17+96.22 (BK) = 17+96.00 (AH)

ECL OTTAWA STA. 116+41.67
 WCL MARSEILLES STA. 220+37.40

NOTE:

* THERE WILL BE 2 1/4" MILLING IN APPROXIMATELY HALF THE DISTANCE FOR THESE SECTIONS BECAUSE OF DETERIORATED PAVEMENT. THIS MILLING WILL ONLY BE DONE IN THE EBL. ADDITION LEVELING BINDER (MM) (1 1/2" TOTAL THICKNESS) HAS BEEN ADDED IN THESE SECTIONS SO THE WBL PAVEMENT GRADE WILL BE MATCHED.

** WATERPROOFING NOT NEEDED AT THIS STRUCTURE, AS THIS STRUCTURE IS SCHEDULED TO BE REMOVED IN 2 YEARS

GUARDRAIL (ALL RURAL)				
STRUCTURE NUMBER	TBT TY 1 SPL (TANGENT)	GUARDRAIL REMOVAL	TERMINAL MARKER - DA	FURNISHED EXCAVATION
	EA	FOOT	EA	CU YD
050-0108	4	200	4	50
050-0109	4	200	4	50
TOTAL	8	400	8	100

ADJUSTMENTS		
LOCATION STATION	WATER VALVES TO BE ADJUSTED (EACH)	MANHOLES TO BE ADJUSTED (EACH)
EAST OF SYCAMORE ST.		1
3RD ST.		1
EAST OF 3RD ST.		1
FIRST ST.		1
PERRY ST.		1
RUTLAND ST.	3	
MAIN ST.	4	3
ROATH ST.		1
ROSE ST.		1
ORANGE ST.		1
HOWARD ST.		1
PINE ST.		1
CHURCH ST.		1
PEARL ST.	2	3
CHICAGO ST.		1
INDIANA ST.		1
WILSON ST.		1
SHERMAN ST.	2	1
DAY ST.		1
JEFFERSON ST.		1
TOTALS	11	23

* FURNISHED EX TO BE PLACED AT END SECTIONS ACCORDING TO STD. 630301

TRAFFIC CONTROL		
LOCATION STATION	EACH	FOOT
US 6 (LASALLE COUNTY) SN 050-0109		
TRAFFIC CONTROL AND PROTECTION STANDARD T01321	1	
TEMPORARY BRIDGE TRAFFIC SIGNALS	1	
TEMPORARY CONCRETE BARRIER		291.0
RELOCATED TEMPORARY CONCRETE BARRIER		291.0
IMPACT ATTENUATORS, TEMPORARY (NON-REDIRECTIVE), TEST LEVEL 3	2	
IMPACT ATTENUATORS, RELOCATE (NON-REDIRECTIVE), TEST LEVEL 3	2	
TOTALS	6	582

* THIS TRAFFIC CONTROL NOT NEEDED FOR SN 050-0108 SINCE IT WILL BE REPLACED IN TWO YEARS

FILE NAME *	USER NAME * #USER#	DESIGNED - designed by	REVISED - revised by1	STATE OF ILLINOIS DEPARTMENT OF TRANSPORTATION	SCHEDULE OF QUANTITIES	F.A.P. RTE.	SECTION	COUNTY	TOTAL SHEETS	SHEET NO.	
#FILE#		DRAWN - drawn by	REVISED - revised by2			623	IG-G-1,G-RRS-5	LASALLE	19	9	
		CHECKED - checked by	REVISED - revised by3			CONTRACT NO. 66947					
		DATE - checked date	REVISED - revised by4			ILLINOIS FED. AID PROJECT					

long section number
multiple county names

SIDE ROAD & ENTRANCES (URBAN)										
NAME	MATERIAL	STATION	TYPE	RT/LT**	HMA SURF REM VAR DEPTH	INCIDENTAL HMA SURF	BIT MATLS PR CT	AGG PR CT	TEMP. RAMP FOR SIDEROAD	FURN. EX•
					SO YD	TON	GAL	TON	SO YD	CU YD
LASALLE COUNTY										
2+20 BEGIN PROJECT EOP IL 71										
URBAN										
ABANDONED SIDEROAD	HMA	6+40	SR	RT	153	17.1	19.9	0.3	8.0	2.0
WAREHOUSE DRIVE	HMA	9+98	SR	RT	525	58.8	68.3	1.1	8.0	2.0
CE	HMA	13+37	CE	LT	48	5.4	6.2	0.1		
TITANIUM DR	HMA	18+85	SR	RT	1762	197.3	229.1	3.5	8.0	2.0
CE	HMA	22+03	CE	LT	78	8.7	10.1	0.2		
OAKDALE AVE		222+91	SR	RT	145	16.2	18.9	0.3	8.0	2.0
LEWIS AVE		229+32	SR	RT	175	19.6	22.8	0.4	8.0	2.0
	PCC	234+94	PE	RT	0	NO WORK	0.0	0.0		
	PCC	236+11	PE	RT	0	NO WORK	0.0	0.0		
	PCC	236+84	PE	RT	0	NO WORK	0.0	0.0		
	PCC	238+34	PE	RT	0	NO WORK	0.0	0.0		
GLENWOOD AVE		239+56	SR	RT	153	17.1	19.9	0.3	8.0	2.0
N 2825TH ROAD (FORREST RD)		239+59	SR	LT	167	18.7	21.7	0.3	8.0	2.0
SN 050-0110					0	NO WORK	0.0	0.0		
	PCC	242+98	CE	RT	0	NO WORK	0.0	0.0		
	PCC	8+07	CE	RT	0	NO WORK	0.0	0.0		
GLEN AVE	PCC	10+00	SR	RT	0	NO WORK	0.0	0.0		
SYCAMORE ST	PCC	10+00	SR	RT	0	NO WORK	0.0	0.0		
THIRD ST.	HMA	19+25	SR	RT	202	22.6	26.3	0.4	8.0	2.0
WILLIAMS ST.	PCC GUTTER	27+12	SR	LT	0	NO WORK	0.0	0.0	8.0	2.0
BEST ST.	PCC GUTTER	30+43	SR	LT	0	NO WORK	0.0	0.0	8.0	2.0
FIRST ST	HMA	32+48	SR	RT	215	24.1	28.0	0.4	8.0	2.0
CLARK ST.	PCC GUTTER	35+15	SR	LT	0	NO WORK	0.0	0.0		
PERRY ST	HMA	42+14	SR	RT	293	32.8	38.1	0.6	8.0	2.0
RUTLAND ST	HMA	44+67	SR	LT	370	41.4	48.1	0.7	8.0	2.0
MAIN ST	HMA	45+20	SR	RT	277	31.0	36.0	0.6	8.0	2.0
POSTAL ALLEY (EAST)	PCC	46+60	SR	RT	0	NO WORK	0.0	0.0		
STATE ST	HMA	48+02	SR	RT	136	15.2	17.7	0.3	8.0	2.0
ROATH ST	HMA	50+58	SR	RT	204	22.8	26.5	0.4	8.0	2.0
ROSE ST	HMA	53+10	SR	RT	136	15.2	17.7	0.3	8.0	2.0
ORANGE AVE	HMA	54+29	SR	LT	193	21.6	25.1	0.4	8.0	2.0
HOWARD ST	HMA	55+70	SR	RT	217	24.3	28.2	0.4	8.0	2.0
PINE ST	HMA	58+53	SR	RT	234	26.2	30.4	0.5	8.0	2.0
CHURCH ST	HMA	61+14	SR	RT	212	23.7	27.6	0.4	8.0	2.0
PEARL ST (NORTH)	HMA	68+73	SR	LT	170	19.0	22.1	0.3	8.0	2.0
PEARL ST (SOUTH)	HMA	69+14	SR	RT	222	24.9	28.9	0.4	8.0	2.0
CHICAGO (NORTH) (P.E.)	PCC GUTTER	77+87	PE	LT	0	NO WORK	0.0	0.0		
CHICAGO ST (SOUTH)	HMA	77+87	SR	RT	189	21.2	24.6	0.4	8.0	2.0
INDIANA (NORTH)	PCC GUTTER	82+50	SR	LT	0	NO WORK	0.0	0.0	8.0	2.0
INDIANA ST (SOUTH)	HMA	82+50	SR	RT	191	21.4	24.8	0.4	8.0	2.0
LASALLE ST (NORTH)	HMA	87+16	SR	RT	152	17.0	19.8	0.3	8.0	2.0
LASALLE ST (SOUTH) PVT ENT	HMA	87+16	SR	LT	240	26.9	31.2	0.5	8.0	2.0
SN 050-0117					0	NO WORK	0.0	0.0		
SHERMAN ST (NORTH)	HMA	94+76	SR	LT	275	30.8	35.8	0.6	8.0	2.0
SHERMAN ST (SOUTH)	HMA	94+99	SR	RT	162	18.1	21.1	0.3	8.0	2.0
DAY ST	HMA	96+47	SR	RT	157	17.6	20.4	0.3	8.0	2.0
JEFFERSON ST. (SOUTH)	HMA	105+31	SR	RT	271	30.4	35.2	0.5	8.0	2.0
URBAN TOTAL		105+63 END PROJECT			7924	887	1030	16	256	64

•PLACE FURNISHED EX AROUND SIDEROAD RADII. THIS AREA TO BE SEEDED, FERTILIZED AND MULCHED- NOT PAID FOR SEPERATELY BUT INCLUDED IN THE COST OF FURNISHED EX
 **RT/LT, FACING EAST
 ALL MAILBOX TURNOUTS TO BE MILLED AND PAVED. ONLY THOSE MBTO ON OPPOSITE SIDE OF ROADS ARE BROKEN OUT ABOVE

STATION EQUATIONS:
 91+12.10 (BK) = 90+76.17 (AH)
 151+06.65 (BK) = 151+05.65 (AH)
 178+16.67 (BK) = 178+11.80 (AH)
 225+91.85 (BK) = 225+60.39 (AH)
 243+82.20 (BK) = 7+47.42 (AH)
 17+96.22 (BK) = 17+96.00 (AH)

FILE NAME =	USER NAME = \$USER\$	DESIGNED - designed by	REVISED - revised by1	STATE OF ILLINOIS DEPARTMENT OF TRANSPORTATION	SUMMARY OF QUANTITIES	F.A.P. RTE.	SECTION	COUNTY	TOTAL SHEETS	SHEET NO.	
\$FILEL\$		DRAWN - drawn by	REVISED - revised by2			623	IG.G-1.G-RIRS-5	LASALLE	19	10	
PLOT SCALE = \$SCALE\$		CHECKED - checked by	REVISED - revised by3			CONTRACT NO. 66947					
PLOT DATE = \$DATE\$		DATE - checked date	REVISED - revised by4			ILLINOIS FED. AID PROJECT					

SIDE ROAD & ENTRANCES (RURAL)										
NAME	MATERIAL	STATION	TYPE	RT/LT**	HMA SURF REM VAR DEPTH	INCIDENTAL HMA SURF	BIT MATLS PR CT	AGG PR CT	TEMP. RAMP FOR SIDEROAD	FURN. EX*
					SO YD	TON	GAL	TON	SO YD	CU YD
LASALLE COUNTY RURAL										
CE	HMA	23+46	CE	RT	73	8.2	9.5	0.1		
CE	HMA	24+80	CE	LT	73	8.2	9.5	0.1		
PE	HMA	26+08	PE	LT	39	4.4	5.1	0.1		
BLACKWELL VALLEY	HMA	27+82	SR	LT	150	16.8	19.5	0.3	8.0	2.0
PE	HMA	27+82	PE	RT	50	5.6	6.5	0.1		
PE	HMA	36+20	PE/MB	LT	67	7.5	8.7	0.1		
N 29TH RD	HMA	37+07	SR	LT	195	21.8	25.4	0.4	8.0	2.0
	GRAVEL	40+10	FE	RT	0	NO WORK	0.0	0.0		
	GRAVEL	57+23	FE	RT	0	NO WORK	0.0	0.0		
	GRAVEL	77+76	FE	RT	0	NO WORK	0.0	0.0		
UNMARKED SIDEROAD SN 050-0108	HMA	81+46 94+27.76	SR	LT	178	19.9	23.1	0.4	8.0	2.0
UNMARKED SIDEROAD	HMA	91+61	SR	RT	87	9.7	11.3	0.2	8.0	2.0
	HMA	97+63	FE	RT	39	4.4	5.1	0.1		
	HMA	98+92	PE/MB	LT	42	4.7	5.5	0.1		
	GRAVEL	125+85	FE	RT	0	NO WORK	0.0	0.0		
MAILBOX TURNOUT	HMA	139+79	MB	LT	40	4.48	5.2	0.1		
PE	HMA	141+42	PE	RT	52	5.8	6.8	0.1		
PE/MAILBOX TURNOUT SN 050-0109	MB IS HMA	150+89 153+36.63	PE/MB	LT	40	4.48	5.2	0.1		
	GRAVEL	156+94	FE	RT	0	NO WORK	0.0	0.0		
	HMA	166+41	PE/MB	RT	78	8.7	10.1	0.2		
E 22ND RD	HMA	174+10	SR	LT	255	28.6	33.2	0.5	8.0	2.0
	HMA	175+32	MB	LT	40	4.5	5.2	0.1		
	GRAVEL	190+05	FE	RT	0	NO WORK	0.0	0.0		
	HMA	190+05	PE	LT	62	6.9	8.1	0.1		
	GRAVEL		FE	RT	0	NO WORK	0.0	0.0		
	HMA	206+85	PE/MB	LT	177	19.8	23.0	0.4		
	HMA	208+19	PE	RT	58	6.5	7.5	0.1		
RURAL TOTAL					1795	201	233	4	40	10
URBAN TOTAL					7924	887	1030	16	256	64
TOTAL (URBAN & RURAL)					9719	1088	1263	20	296	74

*PLACE FURNISHED EX AROUND SIDEROAD RADII. THIS AREA TO BE SEEDED, FERTILIZED AND MULCHED- NOT PAID FOR SEPERATELY BUT INCLUDED IN THE COST OF FURNISHED EX
 **RT/LT, FACING EAST
 ALL MAILBOX TURNOUTS TO BE MILLED AND PAVED. ONLY THOSE MBTO ON OPPOSITE SIDE OF ROADS ARE BROKEN OUT ABOVE

STATION EQUATIONS:
 91+12.10 (BK) = 90+76.17 (AH)
 151+06.65 (BK) = 151+05.65 (AH)
 178+16.67 (BK) = 178+11.80 (AH)
 225+91.85 (BK) = 225+60.39 (AH)
 243+82.20 (BK) = 7+47.42 (AH)
 17+96.22 (BK) = 17+96.00 (AH)
 88+35.05 (BK) = 96+43.82 (AH)

FILE NAME =	USER NAME = \$USER*	DESIGNED - designed by	REVISED - revised by1	STATE OF ILLINOIS DEPARTMENT OF TRANSPORTATION	SCHEDULES OF QUANTITIES			F.A.P	SECTION	COUNTY	TOTAL SHEETS	SHEET NO.
		DRAWN - drawn by	REVISED - revised by2		SCALE: _____	STA. _____	TO STA. _____	623	(G.G-1,G-RRS-5	LASALLE	19	11
	PLOT SCALE = \$SCALE*	CHECKED - checked by	REVISED - revised by3					CONTRACT NO. 66947				
	PLOT DATE = \$DATE*	DATE - checked date	REVISED - revised by4		ILLINOIS FED. AID PROJECT							

SIDEWALK (ALL URBAN)								
	SIDEWALK ADA STANDARD	CURB REMOVAL	CCC&G B 6.24	SIDEWALK REMOVAL	DETECTABLE WARNINGS	PCC SIDEWALK, 4"	SOD, SALT TOLERANT	SUPPLEMENTAL WATERING
LOCATION		FOOT	FOOT	SO FT	SO FT	SO FT	SO YD	UNIT
GLENWOOD AVE								
SE QUAD	424001 < 5' LANDSCAPE	8	8	75	8	75	8	0.22
CASEYS GENERAL STORE								
WEST ENTRANCE	424001 PAVED/LANDSCAPE	8	8	50	16	50	8	0.22
EAST ENTRANCE	424001 PAVED/LANDSCAPE	12	12	50	16	50	8	0.22
SYCAMORE ST.								
SE QUAD	424001	6	6	75	16	75		
SW QUAD	424001	6	6	125	16	125		
3RD STREET								
SE QUAD	424001 < 5' LANDSCAPE	8	8	50	8	50	8	0.22
SW QUAD	424001 < 5' LANDSCAPE	8	8	50	8	50	8	0.22
BEST ST								
NE QUAD	424001 < 5' LANDSCAPE	10	10	50	8	50	8	0.22
NW QUAD	424001 < 5' LANDSCAPE	10	10	50	8	50	8	0.22
WILLIAMS ST								
NE QUAD	424001 < 5' LANDSCAPE	15	15	60	8	60	8	0.22
NW QUAD	424001 < 5' LANDSCAPE	15	15	60	8	60	8	0.22
1ST STREET								
SE QUAD	424001 < 5' LANDSCAPE	6	6	50	8	50	8	0.22
SW QUAD	424001 < 5' LANDSCAPE	6	6	50	8	50	8	0.22
ALLEY/PRIVATE DRIVE WEST OF BANK								
NE QUAD	OMIT	0	0	0	0	0		
NW QUAD	OMIT	0	0	0	0	0		
PERRY								
NE QUAD	OMIT	0	0	0	0	0		
SE QUAD	OMIT	0	0	0	0	0		
SW QUAD	OMIT	0	0	0	0	0		
NW QUAD	OMIT	0	0	0	0	0		
RUTLAND								
NE QUAD	424021	19	19	80	16	80		
NW QUAD	424021	14	14	112	16	112		
MAIN STREET								
SE QUAD	424001 < 5' PAVED	24	24	125	16	125		
SW QUAD	424016 & 424001 < 5' LANDSCAPE	19	19	137	16	137	8	0.22
NORTH	424016	6	6	20	8	20		
GROCERY ENTRANCE WEST	OMIT	0	0	0	0	0		
GROCERY ENTRANCE EAST	OMIT	0	0	0	0	0		
POSTAL ALLEY								
SE QUAD	424001 < 5' LANDSCAPE	6	6	75	8	75	8	0.22
SW QUAD	424001 < 5' LANDSCAPE	6	6	50	8	50	8	0.22
STATE STREET								
SE QUAD	424001 < 5' LANDSCAPE	6	6	40	8	40	8	0.22
SW QUAD	424001 < 5' LANDSCAPE	6	6	45	8	45	8	0.22
ROATH STREET								
SE QUAD	424001 < 5' LANDSCAPE	6	6	45	8	45	8	0.22
SW QUAD	424001 < 5' LANDSCAPE	6	6	45	8	45	8	0.22
ROSE STREET								
SE QUAD	424001 < 5' LANDSCAPE	8	8	45	8	45	8	0.22
SW QUAD	424001 > 5' LANDSCAPE	6	6	45	8	45	8	0.22
ORANGE								
NE QUAD	424006	30	30	100	8	100		
NW QUAD	424001 < 5' LANDSCAPE	8	8	60	8	60	8	0.22
HOWARD STREET								
SE QUAD	424001 > 5' LANDSCAPE	6	6	50	8	50	8	0.22
SW QUAD	424001 < 5' LANDSCAPE	6	6	50	8	50	8	0.22
PINE STREET								
SE QUAD	424001 > 5' LANDSCAPE	8	8	60	8	60	8	0.22
SW QUAD	424001 > 5' LANDSCAPE	6	6	45	8	45	8	0.22
CHURCH STREET								
SE QUAD	424001 > 5' LANDSCAPE	10	10	40	8	40	8	0.22
SW QUAD	424001 > 5' LANDSCAPE	6	6	65	8	65	8	0.22
PEARL STREET								
SE QUAD	424001 < 5' LANDSCAPE	6	6	50	8	50	8	0.22
SW QUAD (2 LOCATIONS)	424001 < 5' LANDSCAPE	12	12	110	16	110	8	0.22
(OPAL ST.) NE QUAD	424001 < 5' LANDSCAPE	6	6	60	8	60	8	0.22
(OPAL ST.) NW QUAD	424001 < 5' LANDSCAPE	6	6	45	8	45	8	0.22
CHICAGO STREET								
SE QUAD	424001 > 5' LANDSCAPE	6	6	95	8	95	8	0.22
SW QUAD	424001 > 5' LANDSCAPE	6	6	50	8	50	8	0.22
NE QUAD	OMIT	0	0	0	0	0		
NW QUAD	OMIT	0	0	0	0	0		
INDIANA STREET								
SE QUAD (2 LOCATIONS)	424001 > 5' LANDSCAPE	12	12	160	16	160	8	0.22
SW QUAD	424001 > 5' LANDSCAPE	6	6	75	8	75	8	0.22
NE QUAD (2 LOCATIONS)	424001 < 5' LANDSCAPE	6	6	110	16	110	16	0.43
NW QUAD	424001 < 5' LANDSCAPE	6	6	50	8	50	8	0.22
WILSON STREET								
SE QUAD (ADD CROSS RAMPS)	424001 > 5' LANDSCAPE	12	12	48	16	98	8	0.22
SW QUAD (2 LOCATIONS)	424001 < 5' LANDSCAPE	12	12	145	16	145	8	0.22
NE QUAD (ADD CROSS RAMPS)	424001 < 5' LANDSCAPE	12	12	45	16	95	8	0.22
NW QUAD	424001 < 5' LANDSCAPE	6	6	55	8	55	8	0.22
SHERMAN STREET								
SE QUAD (2 LOCATIONS)	424001 < 5' LANDSCAPE	19	19	80	16	80	8	0.22
SW QUAD (2 LOCATIONS)	424001 < 5' LANDSCAPE	19	19	125	16	125	8	0.22
NE QUAD (2 LOCATIONS)	424001 > 5' PAVED	10	10	72	16	72		
NW QUAD	424011	6	6	120	8	120	8	0.22
DAY STREET								
SE QUAD	424001 < 5' LANDSCAPE	6	6	40	8	40	8	0.22
SW QUAD	424001 < 5' LANDSCAPE	6	6	80	8	80	8	0.22
TOTAL		510	510	3,744	568	3,844	376	10

ALL EXCAVATED MATERIAL MUST REMAIN ON THE JOBSITE. NO MATERIAL IS ALLOWED TO BE REMOVED OUTSIDE THE RIGHT-OF-WAY.

FILE NAME =	USER NAME = *USER*	DESIGNED - designed by	REVISED - revised by1	STATE OF ILLINOIS DEPARTMENT OF TRANSPORTATION	SCHEDULE OF QUANTITIES	F.A.P. RTE.	SECTION	COUNTY	TOTAL SHEETS	SHEET NO.	
*FILE#		DRAWN - drawn by	REVISED - revised by2			623	IG-G-1,G-RHS-5	LASALLE	19	12	
PLOT SCALE = *SCALE*		CHECKED - checked by	REVISED - revised by3			CONTRACT NO. 66947					
PLOT DATE = *DATE*		DATE - checked date	REVISED - revised by4			ILLINOIS FED. AID PROJECT					

PAVEMENT MARKING SCHEDULE

STA. TO STA.	LENGTH	THERMO	THERMO	THERMO	THERMO	THERMO	THERMO	THERMO	PAINT PVT MK			TEMP PVT MKS		SHORT	WORK ZONE	RAISED	RAISED			
		PVT MKS	PVT MKS	PVT MKS	PVT MKS	PVT MKS	PVT MKS	PVT MKS	PVT MKS	4" WHT	4" YELL	6" YELL	4" WHT	6" YELL	TERM	PAV'T MARK	REFLECT.	REFLECTIVE		
		4" YELLOW	6" YELLOW	12" YELLOW	6" WHITE	8" WHITE	12" WHITE	24" WHITE							PAV'T MARK	REMOVAL	PVT MK REM	PVT MK		
		LF	LF	LF	LF	LF	LF	LF	LF	LF	LF	LF	LF	LF	SQ FT	EACH	EACH			
URBAN																				
2+20 TO 116+41.67*	11457.58	1740		76.0								45830.3		5728.8	22915.2	2864.4	4583.0	382	143	143
217+02 TO 105+63*	12527.46		3131.9											3131.9	5011.0		417	152	152	
NO PASSING ZONES**		3015								0.0	1440.0	0.0								
X-WALKS																				
DAY ST.					72.0															
SHERMAN ST.					158.0															
WILSON ST.					150.0															
INDIANA ST.					120.0															
CHICAGO ST.					120.0															
PEARL ST.					136.0															
CHURCH ST.					80.0															
PINE ST.					78.0															
HOWARD ST.					72.0															
ORANGE ST.					94.0															
ROSE ST.					82.0															
ROATH ST.					94.0															
STATE ST.					88.0															
MAIN ST. (S)					122.0			24.0												
MAIN ST. (N)					52.0		102.0													
RUTLAND ST. (S)					144.0			24.0												
RUTLAND ST. (N)					70.0		138.0													
US 6 W					26.0			12.0												
US 6 E					26.0			12.0												
PERRY ST.					42.0															
FIRST ST.					66.0															
BEST ST.					44.0															
WILLIAMS ST.					28.0															
THIRD ST.					62.0															
GLEN AVE. (1)					122.0		136.0	100.0												
TITANIUM DR.								36.0												
IL 71 (1)							115.0	90.0												
URBAN TOTAL	23985	4755	3132	76	2148	251	430	108	45830	1440	5729	22915	5996	9594	799	295	295			
RURAL																				
116+41.67 TO 217+02*	10066.16											40264.6	5033.1	40264.6	2516.5	4026.5	335	130	130	
RURAL TOTAL	10066	0	0	0					40265		5033	40265	2517	4161	335	130	130			
TOTALS	34051	4755	3132	76	2148	251	430	108	86095	1440	10762	63180	8513	13755	1134	425	425			

*STATION EQUATIONS:
 91+12.10 (BK) = 90+76.17 (AH)
 151+06.65 (BK) = 151+05.65 (AH)
 178+16.67 (BK) = 178+11.80 (AH)
 225+91.85 (BK) = 225+60.39 (AH)
 243+82.20 (BK) = 7+47.42 (AH)
 17+96.22 (BK) = 17+96.00 (AH)

ECL OTTAWA STA. 116+41.67
 WCL MARSEILLES STA. 220+37.40

**NOTE: THE FOLLOWING NO PASSING ZONES SHOULD BE FIELD VERIFIED BY THE ENGINEER PRIOR TO RESURFACING
 EBL WBL
 225+91 TO 231+82 8+00 TO 15+20
 100+45 TO 105+63 231+82 TO 12+05
 103+15 TO 105+63

***NOTE: ALL PAINT PVT MK QUANTITIES HAVE BEEN DOUBLED.
 PAINT PVT MK WILL BE APPLIED IN 2 SEPARATE APPLICATIONS. SEE SPECIAL PROVISIONS.

****NOTE: PAINT PVT MK SHALL BE APPLIED TO STR. NO. 050-0108 AND 050-0109.
 THERMO PVT MK SHALL BE APPLIED TO STR. NO. 050-0110 AND 050-0117.

(1) QUANTITIES INCLUDE PAINTED ISLANDS.

INCLUDED IN QUANTITIES ABOVE ISLAND MARKINGS, WHITE 8", WHITE 12", WHITE 24" STOP BARS AND
 YELLOW 4" LINE ADJACENT TO THE MEDIAN NEED TO BE REPLACED AT THE US RT.6 & IL 71 INTERSECTION.

FILE NAME =	USER NAME = *USER*	DESIGNED - designed by	REVISED - revised by1	STATE OF ILLINOIS DEPARTMENT OF TRANSPORTATION	SCHEDULE OF QUANTITIES	F.A.P. RTE.	SECTION	COUNTY	TOTAL SHEETS	SHEET NO.	
FILEL		DRAWN - drawn by	REVISED - revised by2			623	IG,C-1,G-RRS-5	LASALLE	19	13	
	PLOT SCALE = *SCALE*	CHECKED - checked by	REVISED - revised by3			CONTRACT NO. 66947					
	PLOT DATE = *DATE*	DATE - checked date	REVISED - revised by4			ILLINOIS FED. AID PROJECT					

CENTERLINE L IL 71US 6 STA 1 + 94.97

BEGINNING OF IMPROVEMENT STA 2+20 (EOP IL 71)

STA 32+27

STA. 41+70 N 29th ROAD

ROUTE 6

MILL & REPLACE 112" REPLACE WATERPROOF MEMBRANE SYS.

S.N. NO. 050 - 0108 OMISSION STA 94+29.5 57'

S.N. NO 050 - 0109 OMISSION STA 153+08.13 141'

MILL & REPLACE 112" REPLACE WATERPROOF MEMBRANE SYS.

E. 22nd ROAD STA. 173+35

S.N 050 - 2000 STA. 193+41 CULVERT

MATCH LINE A



MATCH LINE A

ROUTE 6

OAKDALE AVE. STA. 222+91.52

LEWIS AVE. STA. 229+32.60

GLENWOOD AVE. STA. 239+56.35

N. 2825th ROAD STA. 239+59.15

GLEN AVE. STA. 10+00

S.N. NO. 050 - 0110 STA. 240+62.26 SKIP STRUCTURE

THIRD STREET STA. 19+25.50

FIRST STREET STA. 32+48.6

BEST STREET STA. 30+43.5

PERRY STREET STA. 42+14.41

RUTLAND STREET STA. 44+67.80

MAIN ST. (STA. 45+20.02)

STATE ST. (STA. 48+02.15)

ROATH ST. (STA. 50+58.89)

ROSE ST. (STA. 53+10.02)

HOWARD ST. (STA. 55+70.37)

PINE ST. (STA. 58+53.35)

ABERDEEN STREET STA. 61+14.01

PEARL STREET STA. 69+14.48

PEARL STREET STA. 68+73.95

CHICAGO ST.(STA. 77+88.66)

INDIANA ST. (STA. 82+50.43)

LASALLE STREET STA. 87+12.05

SHERMAN ST. (STA.91+87.17)

SHERMAN STREET STA. 91+82.47

DAY ST. (STA. 96+48.64)

S.N. NO. 050 - 0117 STA. 88+35.05 OMIT STRUCTURE

END OF IMPROVEMENT STA. 102+19

FILE NAME = *FILEL*	USER NAME = *USER*	DESIGNED - designed by	REVISED - revised by1	STATE OF ILLINOIS DEPARTMENT OF TRANSPORTATION	STRAIGHT LINE DIAGRAM	F.A.P. RTE. 623	SECTION IG.G-1.G-RIRS-5	COUNTY LASALLE	TOTAL SHEETS 19	SHEET NO. 14	
	PLOT SCALE = *SCALE*	CHECKED - checked by	REVISED - revised by2			SCALE: scale			CONTRACT NO. 66947		
	PLOT DATE = *DATE*	DATE - checked date	REVISED - revised by3								
			REVISED - revised by4								

ILLINOIS FED. AID PROJECT

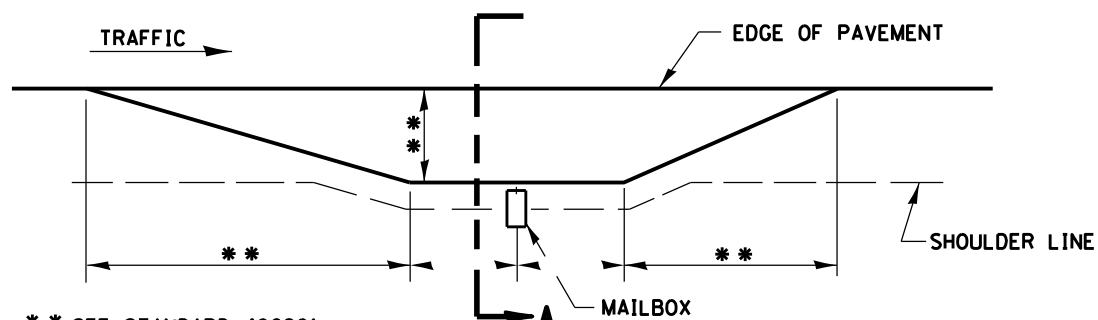

** SEE STANDARD 406201

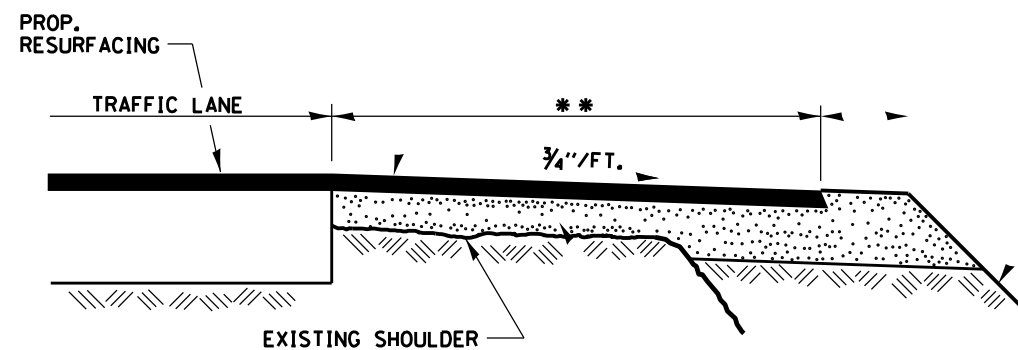

SECTION A-A
RURAL MAILBOX TURNOUT DETAILS

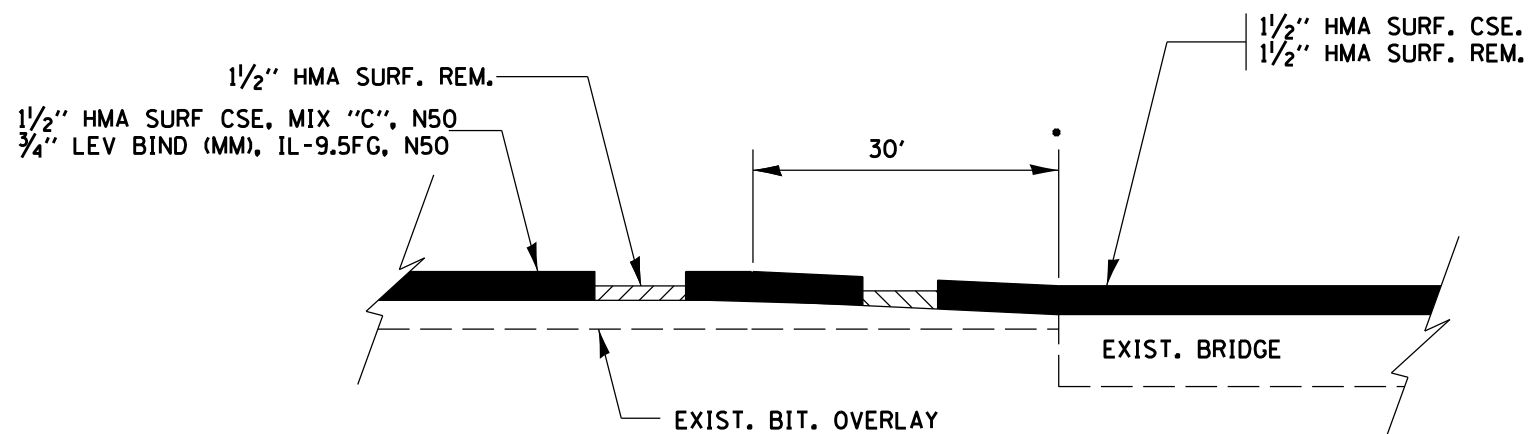

TAPER AT STRUCTURES

- SN 050-0108
- SN 050-0109

FILE NAME = *FILEL*	USER NAME = *USER*	DESIGNED - designed by	REVISED - revised by1	STATE OF ILLINOIS DEPARTMENT OF TRANSPORTATION	DETAILS	F.A.P. RTE. 623	SECTION IG,G-1,G-RRS-5	COUNTY LASALLE	TOTAL SHEETS 19	SHEET NO. 15
	PLOT SCALE = *SCALE*	DRAWN - drawn by	REVISED - revised by2			CONTRACT NO. 66947				
	PLOT DATE = *DATE*	CHECKED - checked by	REVISED - revised by3			ILLINOIS FED. AID PROJECT				
		DATE - checked date	REVISED - revised by4							

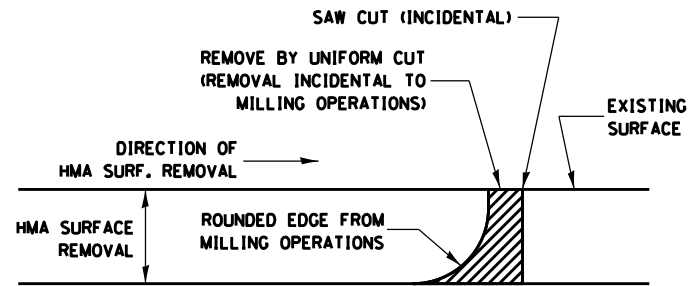

NOTE:
 WHEN MILLING OPERATIONS PRODUCE A ROUNDED EDGE, THEN A SAW CUT SHALL BE USED TO MANUFACTURE A PERPENDICULAR EDGE AS SHOWN IN THE DETAIL. THE ENGINEER SHALL BE THE SOLE JUDGE CONCERNING THE USE OF THIS DETAIL.

HMA DETAIL AT BUTT JOINTS

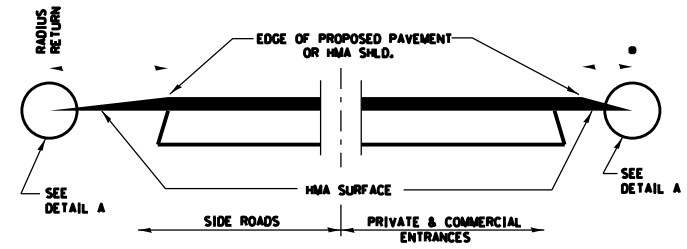

SECTION A-A
DETAILS AT ENTRANCES & SIDE ROADS

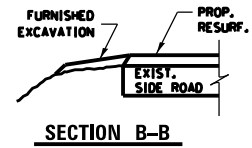

THE COST OF REMOVAL AT EXISTING HMA OR P.C.C. LOCATIONS SHALL BE PAID FOR PER SQ. YD. BY THE APPROPRIATE PAY ITEM. REMOVAL AT THE EXISTING AGG. LOCATIONS SHALL BE INCIDENTAL TO THE HMA. A-3 LOCATIONS SHALL BE FEATHER TAPERED.

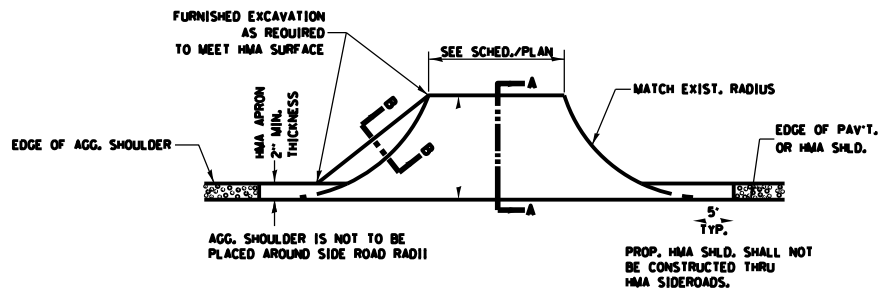
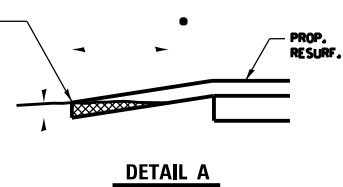

PLAN AT SIDE ROADS

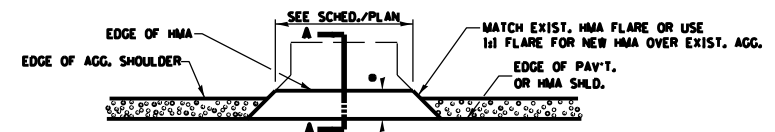

PLAN AT PRIVATE & COMMERCIAL ENTRANCES
 (DO NOT RESURFACE FIELD ENTRANCES)

• PROPOSED HMA RESURFACING AT PUBLIC EDUCATIONAL FACILITY ENTRANCES SHALL BE EXTENDED TO THE RIGHT-OF-WAY LIMITS.

•• NOTE A
 RESURFACE TO RADIUS RETURN

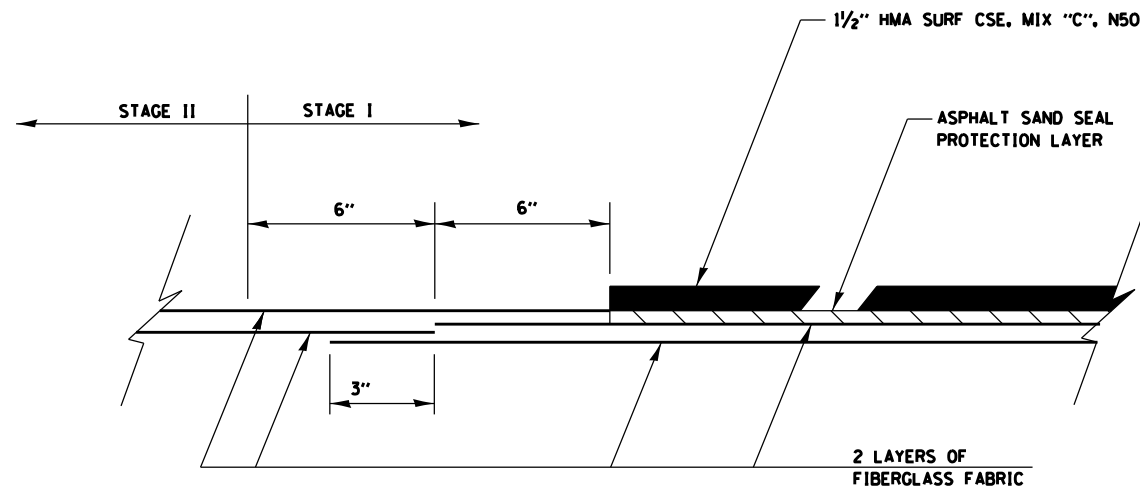

DECK WATERPROOFING TREATMENT (WATERPROOFING MEMBRANE SYSTEM)

STR. NO. 050-0108
 STR. NO. 050-0109

FILE NAME = \$FILEL\$	USER NAME = \$USER\$	DESIGNED - designed by	REVISED - revised by1	STATE OF ILLINOIS DEPARTMENT OF TRANSPORTATION	DETAILS	F.A.P. RTE. 623	SECTION IG,C-1,G-RIRS-5	COUNTY LASALLE	TOTAL SHEETS 19	SHEET NO. 16	
	PLOT SCALE = \$SCALE\$	DRAWN - drawn by	REVISED - revised by2			SCALE: _____	station to	CONTRACT NO. 66947		ILLINOIS FED. AID PROJECT	
	PLOT DATE = \$DATE\$	CHECKED - checked by	REVISED - revised by3								
		DATE - checked date	REVISED - revised by4								

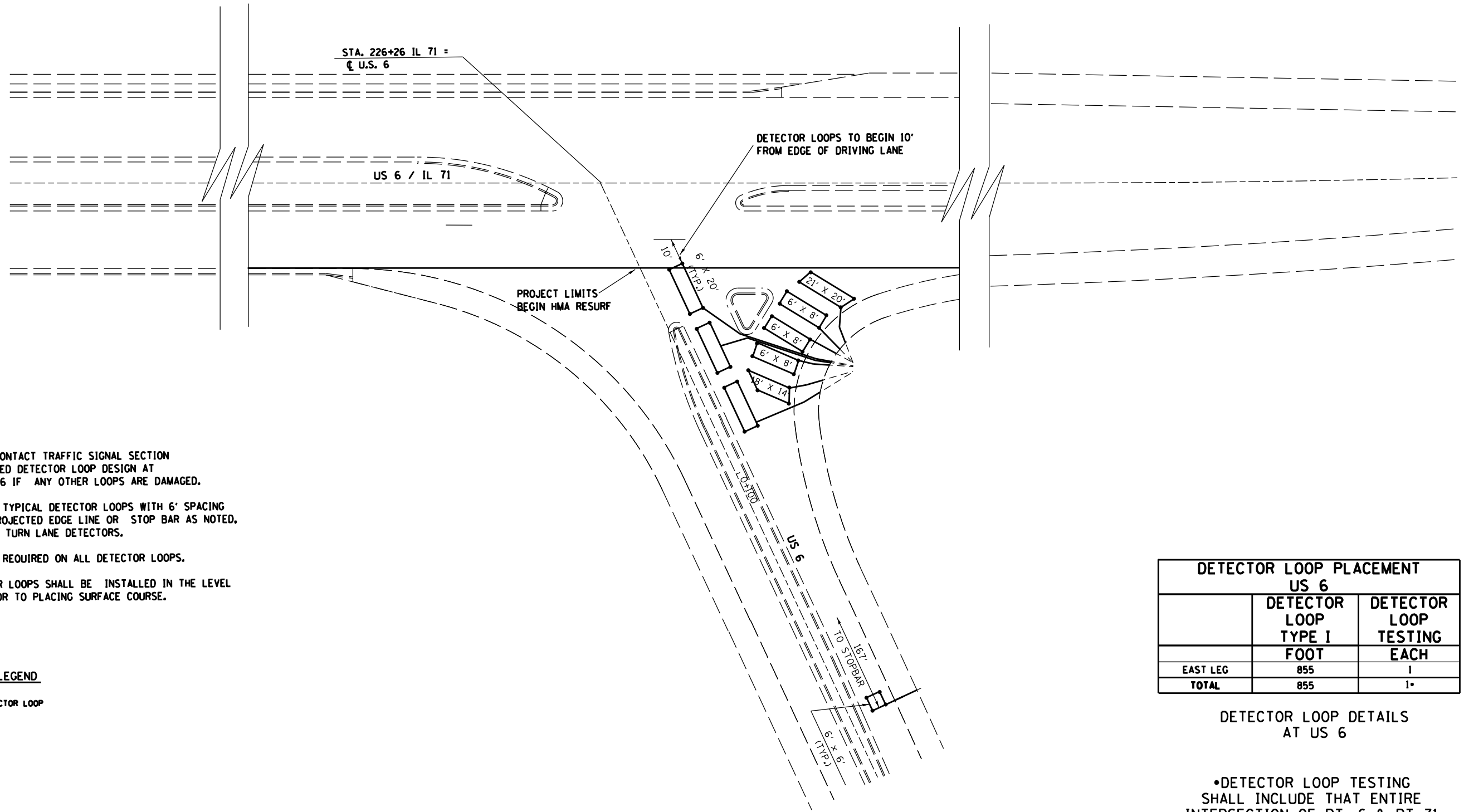
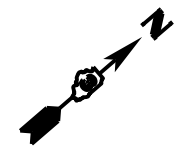

TRAFFIC SIGNAL LEGEND

PROPOSED DETECTOR LOOP

DETECTOR LOOP PLACEMENT US 6		
	DETECTOR LOOP TYPE I FOOT	DETECTOR LOOP TESTING EACH
EAST LEG	855	1
TOTAL	855	1*

**DETECTOR LOOP DETAILS
AT US 6**

•DETECTOR LOOP TESTING SHALL INCLUDE THAT ENTIRE INTERSECTION OF RT. 6 & RT 71 DETECTOR LOOPS ARE OPERATIONAL

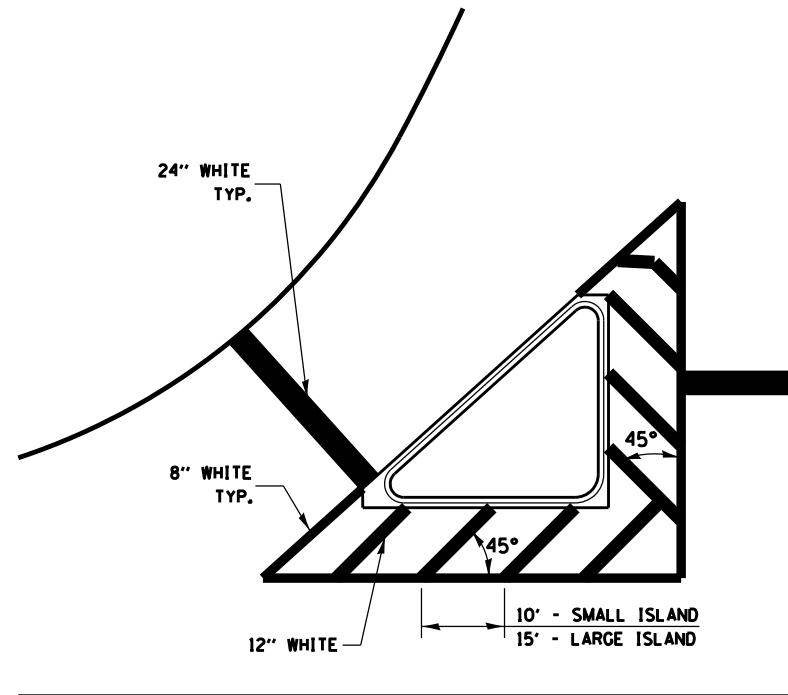

TYPICAL ISLAND

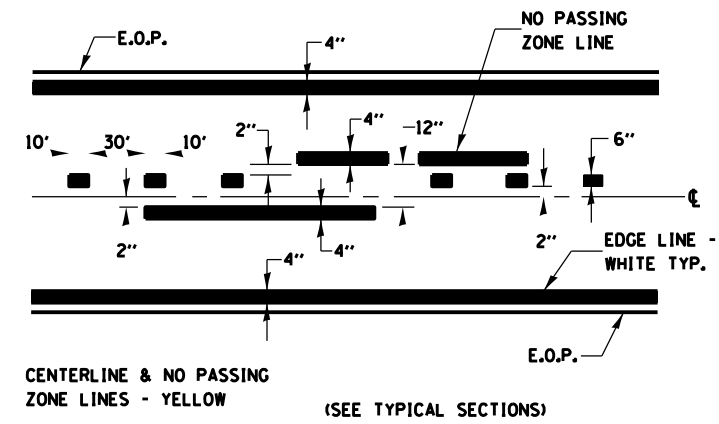

PAVEMENT MARKING

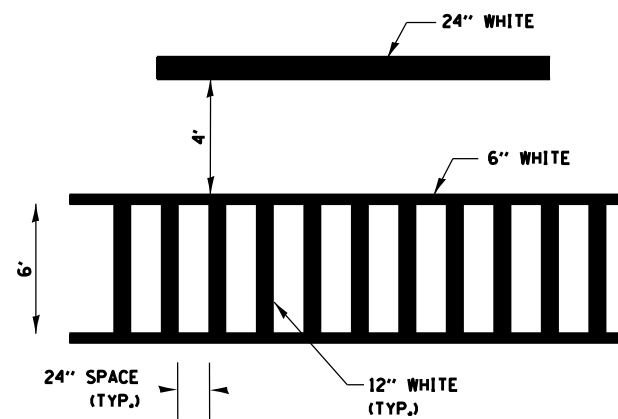

TYPICAL SPACING DETAIL FOR CROSSWALKS AND STOP BARS

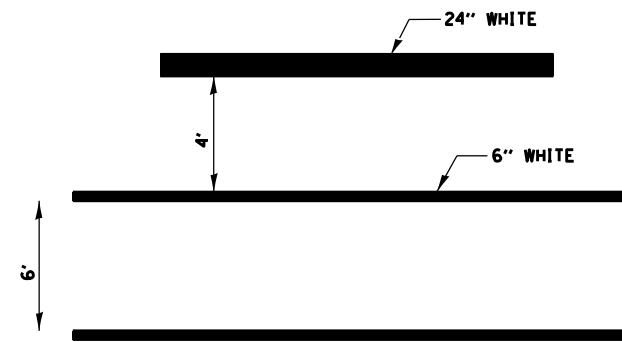

TYPICAL SPACING DETAIL FOR CROSSWALKS AND STOP BARS

FILE NAME =	USER NAME = \$USER*	DESIGNED - _____	REVISED - _____	STATE OF ILLINOIS DEPARTMENT OF TRANSPORTATION	PAVEMENT MARKING DETAILS		F.A.P. RTE.	SECTION	COUNTY	TOTAL SHEETS	SHEET NO.
FILEL	PLOT SCALE = *SCALE*	DRAWN - _____	REVISED - _____				623	IG, G-1, G-RRS-5	LASALLE	19	18
MODELNAME	PLOT DATE = \$DATE*	CHECKED - _____	REVISED - _____		SCALE: _____ SHEET _____ OF _____ SHEETS STA. _____ TO STA. _____		CONTRACT NO. 66947				
							ILLINOIS FED. AID PROJECT				

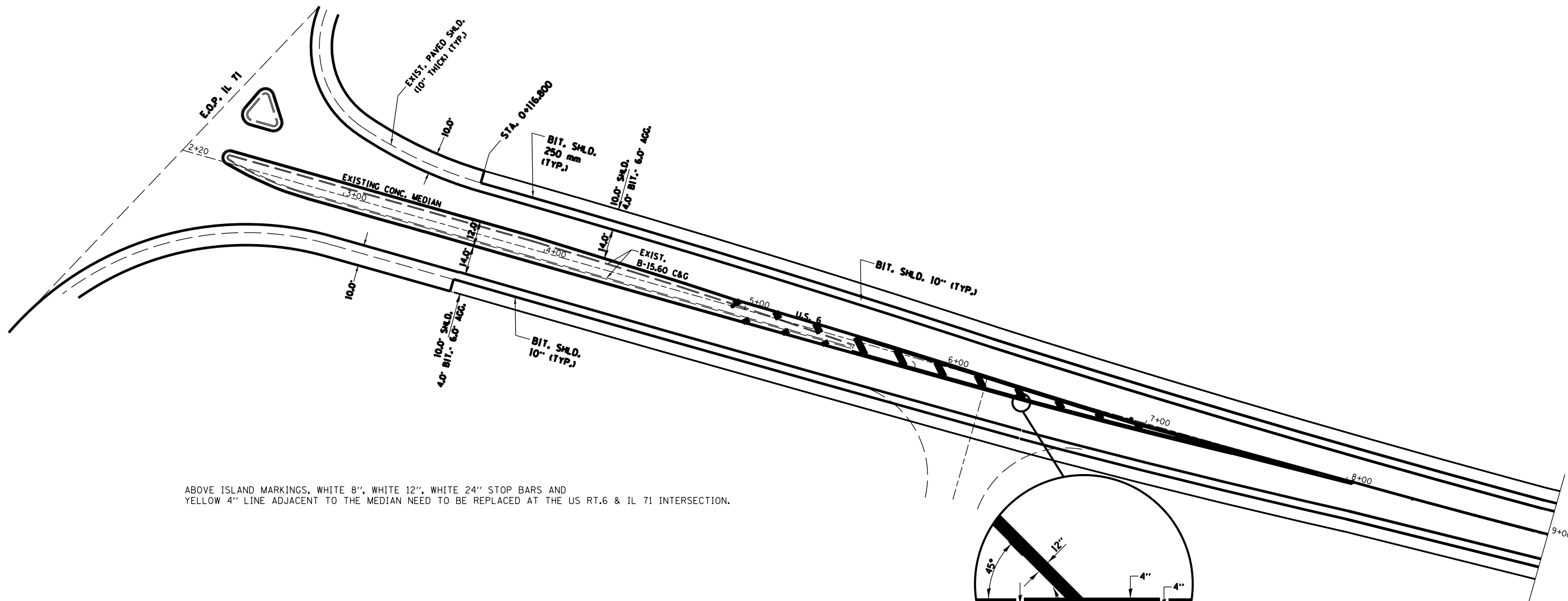

ABOVE ISLAND MARKINGS, WHITE 8", WHITE 12", WHITE 24" STOP BARS AND YELLOW 4" LINE ADJACENT TO THE MEDIAN NEED TO BE REPLACED AT THE US RT.6 & IL 71 INTERSECTION.

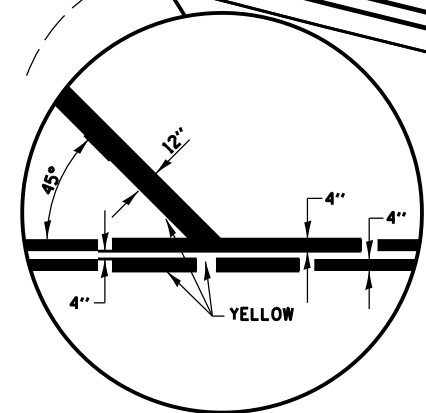

FILE NAME = \$FILEL\$	USER NAME = \$USER\$	DESIGNED - designed by	REVISED - revised by1	STATE OF ILLINOIS DEPARTMENT OF TRANSPORTATION	PAVEMENT MARKINGS	F.A.P. RTE. 623	SECTION CG-1.6-RW5-5	COUNTY LASALLE	TOTAL SHEETS 19	SHEET NO. 19	
	PLOT SCALE = \$SCALE\$	DRAWN - drawn by	REVISED - revised by2			SCALE: _____					
	PLOT DATE = \$DATE\$	CHECKED - checked by	REVISED - revised by3								
		DATE - checked date	REVISED - revised by4								
ILLINOIS FED. AID PROJECT											