

SEC. 34 - T 20 N - R 8 E - 3RD PM

SEE DISTRICT 5 DETAIL 7800BBBB FOR STRIPING AT ENTRANCE AND EXIT RAMP AND GORE AREAS AND OTHER STRIPING DETAILS.

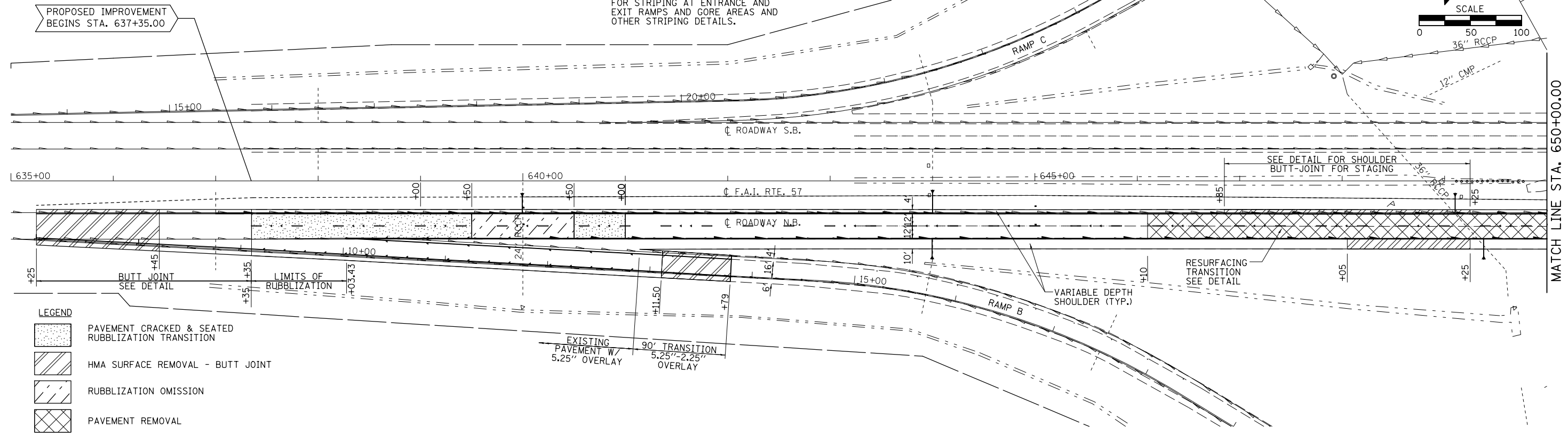
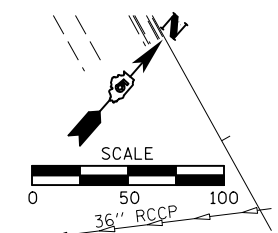

SEC. 34 - T 20 N - R 8 E - 3RD PM

SEE DISTRICT 5 DETAIL 7800BBBB FOR STRIPING AT ENTRANCE AND EXIT RAMP AND GORE AREAS AND OTHER STRIPING DETAILS.

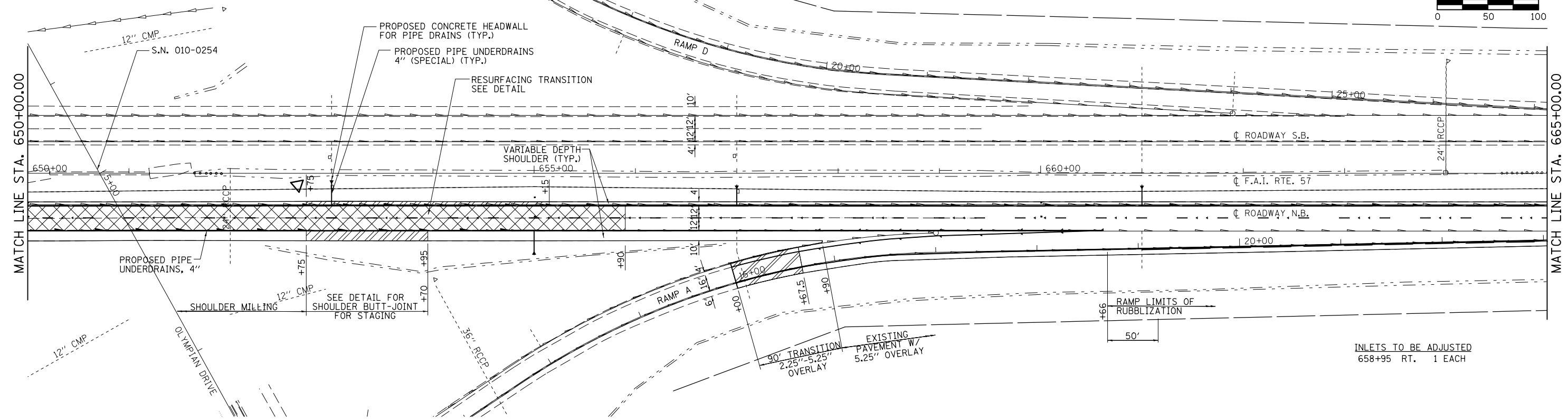
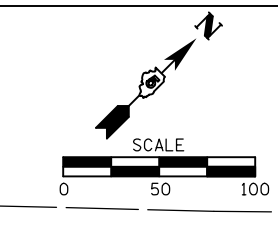

| | | | | | | | | | | | |
|---|-----------------------------|------------|-----------|---|------------------------------|---------------------------|------------------------|-----------|--------------|-----------|--|
| FILE NAME = | USER NAME = keysrb | DESIGNED - | REVISED - | STATE OF ILLINOIS DEPARTMENT OF TRANSPORTATION | PLAN SHEETS F.A.I. 57 | F.A.I. RTE. | SECTION | COUNTY | TOTAL SHEETS | SHEET NO. | |
| et:\pw\work\p\d01\keysrb\d0158448\05707 | 6-sht-plan.dgn | DRAWN - | REVISED - | | | 57 | (10-34, 10-35)RS-2(NB) | CHAMPAIGN | 53 | 23 | |
| | PLOT SCALE = 100.0000' / 1" | CHECKED - | REVISED - | | | CONTRACT NO. 70716 | | | | | |
| | PLOT DATE = 11/13/2012 | DATE - | REVISED - | | | ILLINOIS FED. AID PROJECT | | | | | |