

SEC. 24 - T 20 N - R 8 E - 3RD PM

SEE DISTRICT 5 DETAIL 7800BBBB FOR STRIPING AT ENTRANCE AND EXIT RAMP AND GORE AREAS AND OTHER STRIPING DETAILS.

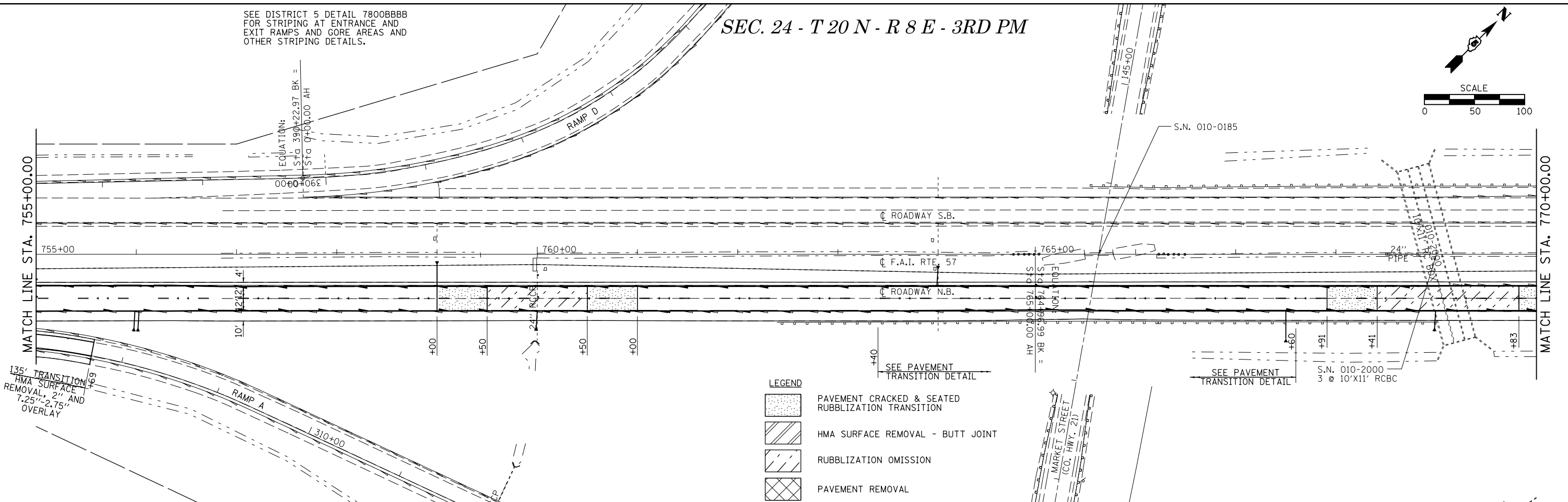

SEC. 24 - T 20 N - R 8 E - 3RD PM

SEE DISTRICT 5 DETAIL 7800BBBB FOR STRIPING AT ENTRANCE AND EXIT RAMP AND GORE AREAS AND OTHER STRIPING DETAILS.

SEC. 13 - T 20 N - R 8 E - 3RD PM

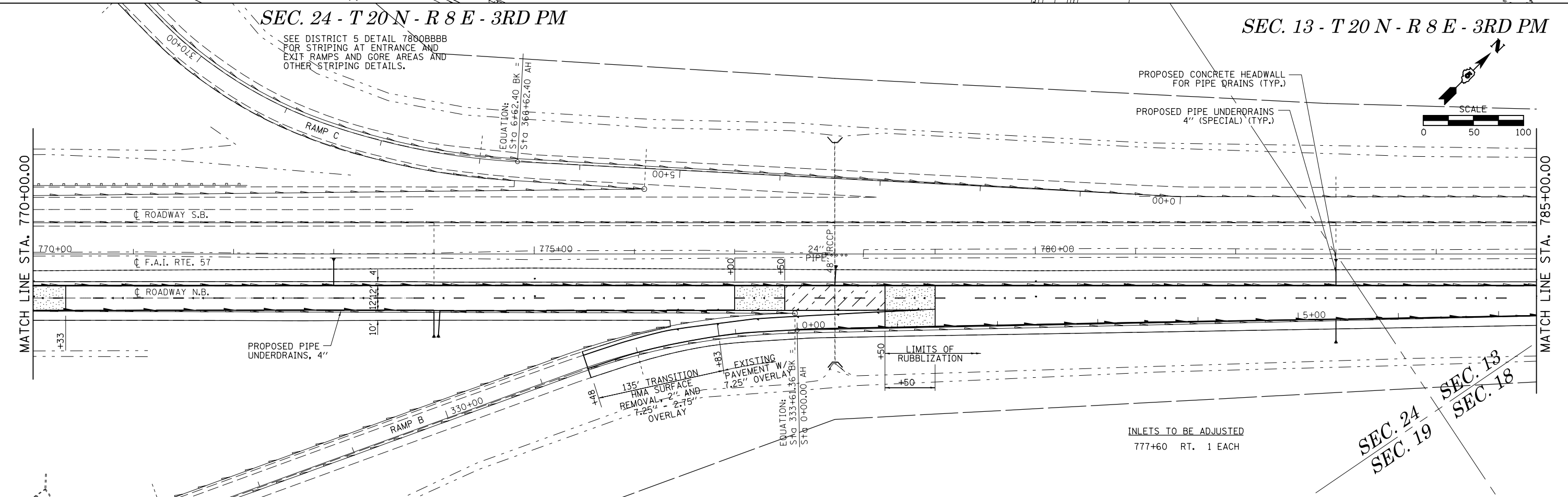

FILE NAME =	USER NAME = keysrb	DESIGNED -	REVISED -	<b>STATE OF ILLINOIS DEPARTMENT OF TRANSPORTATION</b>	<b>PLAN SHEETS F.A.I. 57</b>		F.A.I. RTE.	SECTION	COUNTY	TOTAL SHEETS	SHEET NO.	
c:\pwork\pwork\keysrb\d0158448\05707	6-sht-plan.dgn	DRAWN -	REVISED -		SCALE:	SHEET NO. 5 OF 10 SHEETS	STA. 755+00 TO STA. 785+00	57	(10-34, 10-35)RS-2(NB)	CHAMPAIGN	53	27
		CHECKED -	REVISED -									
		DATE -	REVISED -									
							CONTRACT NO. 70716					
							ILLINOIS FED. AID PROJECT					