

EXIST. CURVE PSBA4  
 PI STA. = 332+46.56  
 $\Delta = 4^\circ 44' 00''$  (RT)  
 D = 1° 00' 00"  
 R = 5,729.58'  
 T = 236.80'  
 L = 473.33'  
 E = 4.89'  
 P.C. STA. = 330+09.76  
 P.T. STA. = 334+83.09

EXIST. CURVE PSBA5  
 PI STA. = 342+64.97  
 $\Delta = 9^\circ 24' 01''$  (RT)  
 D = 2° 59' 59"  
 R = 1,910.07'  
 T = 157.04'  
 L = 313.37'  
 E = 6.44'  
 e = 2.8%  
 T.R. = 38.57'  
 S.E. RUN = 72.00'  
 P.C. STA. = 341+07.93  
 P.T. STA. = 344+21.30

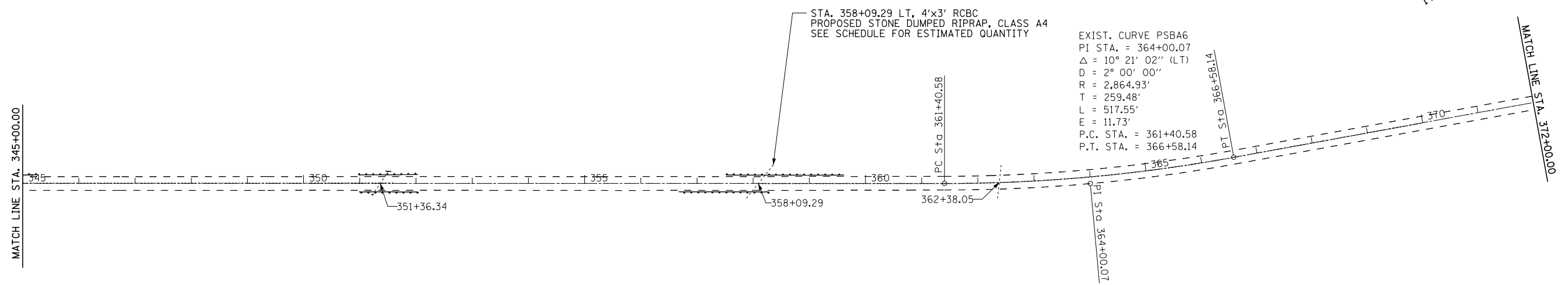
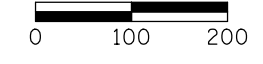

EXIST. CURVE PSBA6  
 PI STA. = 364+00.07  
 $\Delta = 10^\circ 21' 02''$  (LT)  
 D = 2° 00' 00"  
 R = 2,864.93'  
 T = 259.48'  
 L = 517.55'  
 E = 11.73'  
 P.C. STA. = 361+40.58  
 P.T. STA. = 366+58.14

FILE NAME =	USER NAME = #USER*	DESIGNED - CWG	REVISED -
#FILE#		DRAWN - MLO	REVISED -
		CHECKED -	REVISED -
SHT.DOUBLE PLAN	PLOT DATE = #DATE*	DATE - 1/11/2013	REVISED -

**STATE OF ILLINOIS  
 DEPARTMENT OF TRANSPORTATION**

**PLAN SHEETS**

SCALE: 1"=100' SHEET 1 OF 8 SHEETS STA. 325+00.00 TO STA. 372+00.00

F.A.S. RTE.	SECTION	COUNTY	TOTAL SHEETS	SHEET NO.
2600	17 RS-6, 18 RS-12	PIKE	32	19
CONTRACT NO. 72D77				
ILLINOIS FED. AID PROJECT				