

EXIST. CURVE PSBA7
 PI STA. = 388+01.91
 Δ = 15° 04' 57" (RT)
 D = 2° 59' 59"
 R = 1,910.08'
 T = 252.87'
 L = 502.81'
 E = 16.67'
 e = 4.6%
 T.R. = 38.48'
 S.E. RUN = 118.00'
 P.C. STA. = 385+49.04
 P.T. STA. = 390+51.85

BRIDGE # 075-0141
 OMISSION STA. 382+24.24
 TO STA. 384+04.12

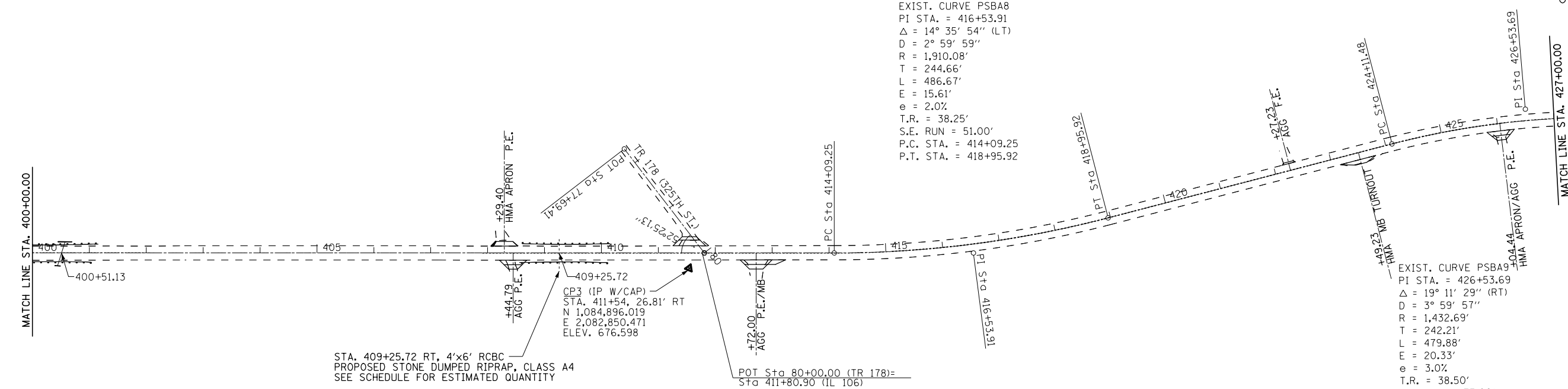
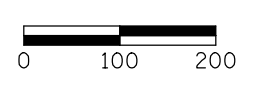

EXIST. CURVE PSBA8
 PI STA. = 416+53.91
 Δ = 14° 35' 54" (LT)
 D = 2° 59' 59"
 R = 1,910.08'
 T = 244.66'
 L = 486.67'
 E = 15.61'
 e = 2.0%
 T.R. = 38.25'
 S.E. RUN = 51.00'
 P.C. STA. = 414+09.25
 P.T. STA. = 418+95.92

STA. 409+25.72 RT, 4'x6' RCBC
 PROPOSED STONE DUMPED RIPRAP, CLASS A4
 SEE SCHEDULE FOR ESTIMATED QUANTITY

EXIST. CURVE PSBA9
 PI STA. = 426+53.69
 Δ = 19° 11' 29" (RT)
 D = 3° 59' 57"
 R = 1,432.69'
 T = 242.21'
 L = 479.88'
 E = 20.33'
 e = 3.0%
 T.R. = 38.50'
 S.E. RUN = 77.00'
 P.C. STA. = 424+11.48
 P.T. STA. = 428+91.36

FILE NAME =	USER NAME = #USER*	DESIGNED -	REVISED -
#FILE#		DRAWN -	REVISED -
	PLOT SCALE = #SCALE*	CHECKED -	REVISED -
SHT.DOUBLE PLAN	PLOT DATE = #DATE*	DATE -	REVISED -

**STATE OF ILLINOIS
 DEPARTMENT OF TRANSPORTATION**

PLAN SHEETS			
SCALE: 1"=100'	SHEET 2	OF 8 SHEETS	STA. 372+00.00 TO STA. 427+00.00

F.A.S. RTE.	SECTION	COUNTY	TOTAL SHEETS	SHEET NO.
2600	17 RS-6, 18 RS-12	PIKE	32	20
CONTRACT NO. 72D77				
ILLINOIS FED. AID PROJECT				