

EXIST. CURVE PSBA11
 PI STA. = 454+62.63
 Δ = 14° 30' 33" (LT)
 D = 1° 28' 06"
 R = 3,901.87'
 T = 496.70'
 L = 988.09'
 E = 31.49'
 e = 2.2%
 T.R. = 38.18'
 S.E. RUN = 56.00'
 P.C. STA. = 449+65.92
 P.T. STA. = 459+54.01

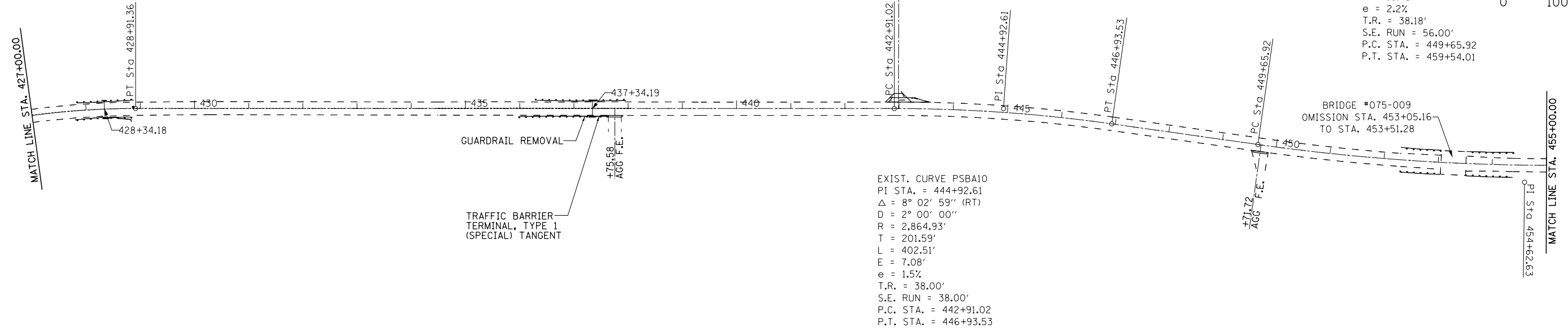

EXIST. CURVE PSBA10
 PI STA. = 444+92.61
 Δ = 8° 02' 59" (RT)
 D = 2° 00' 00"
 R = 2,864.93'
 T = 201.59'
 L = 402.51'
 E = 7.08'
 e = 1.5%
 T.R. = 38.00'
 S.E. RUN = 38.00'
 P.C. STA. = 442+91.02
 P.T. STA. = 446+93.53

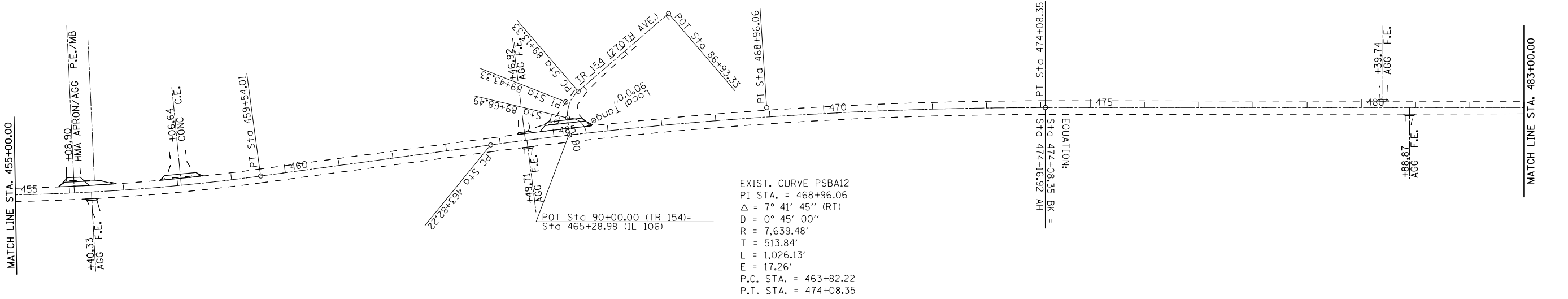
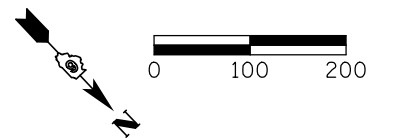

EXIST. CURVE PSBA12
 PI STA. = 468+96.06
 Δ = 7° 41' 45" (RT)
 D = 0° 45' 00"
 R = 7,639.48'
 T = 513.84'
 L = 1,026.13'
 E = 17.26'
 P.C. STA. = 463+82.22
 P.T. STA. = 474+08.35

FILE NAME = *FILEL*	USER NAME = *USER*	DESIGNED - CWG	REVISED -	STATE OF ILLINOIS DEPARTMENT OF TRANSPORTATION	PLAN SHEETS			F.A.S. RTE. 2600	SECTION 17 RS-6, 18 RS-12	COUNTY PIKE	TOTAL SHEETS 32	SHEET NO. 21
SHT.DOUBLE PLAN	PLOT SCALE = *SCALE*	CHECKED -	REVISED -		SCALE: 1"=100"	SHEET 3	OF 8 SHEETS	STA. 427+00.00	TO STA. 483+00.00	CONTRACT NO. 72D77		
	PLOT DATE = *DATE*	DATE - 1/11/2013	REVISED -		ILLINOIS FED. AID PROJECT							