

EXIST. CURVE PSBA23
 PI STA. = 737+36.70
 Δ = 44° 03' 44" (LT)
 D = 5° 29' 52"
 R = 1,042.14'
 T = 421.71'
 L = 801.44'
 E = 82.09'
 e = -----
 T.R. = -----
 S.E. RUN = -----
 P.C. STA. = 733+14.99
 P.T. STA. = 741+16.42

STA. 713+59.48 LT, 4'x3' RCBC
 PROPOSED STONE DUMPED RIPRAP, CLASS A4
 SEE SCHEDULE FOR ESTIMATED QUANTITY

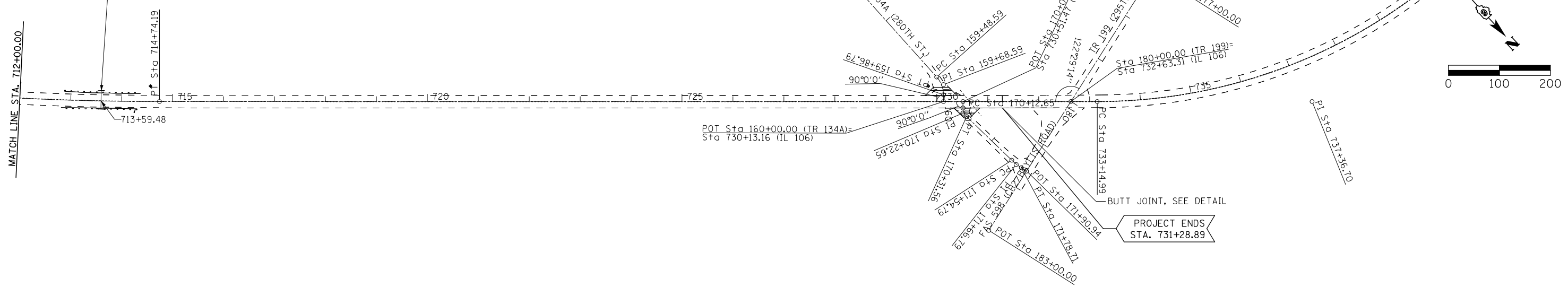

FILE NAME =	USER NAME = \$USER*	DESIGNED - CWG	REVISED -
FILEL		DRAWN - MLO	REVISED -
	PLOT SCALE = \$SCALE*	CHECKED -	REVISED -
SHT.DOUBLE PLAN	PLOT DATE = \$DATE*	DATE - 1/11/2013	REVISED -

**STATE OF ILLINOIS
 DEPARTMENT OF TRANSPORTATION**

PLAN SHEETS

SCALE: 1"=100' SHEET 8 OF 8 SHEETS STA. 712+00.00 TO STA. 740+00.00

F.A.S. RTE.	SECTION	COUNTY	TOTAL SHEETS	SHEET NO.
2600	17 RS-6, 18 RS-12	PIKE	32	26
CONTRACT NO. 72077				
ILLINOIS FED. AID PROJECT				