

(9)

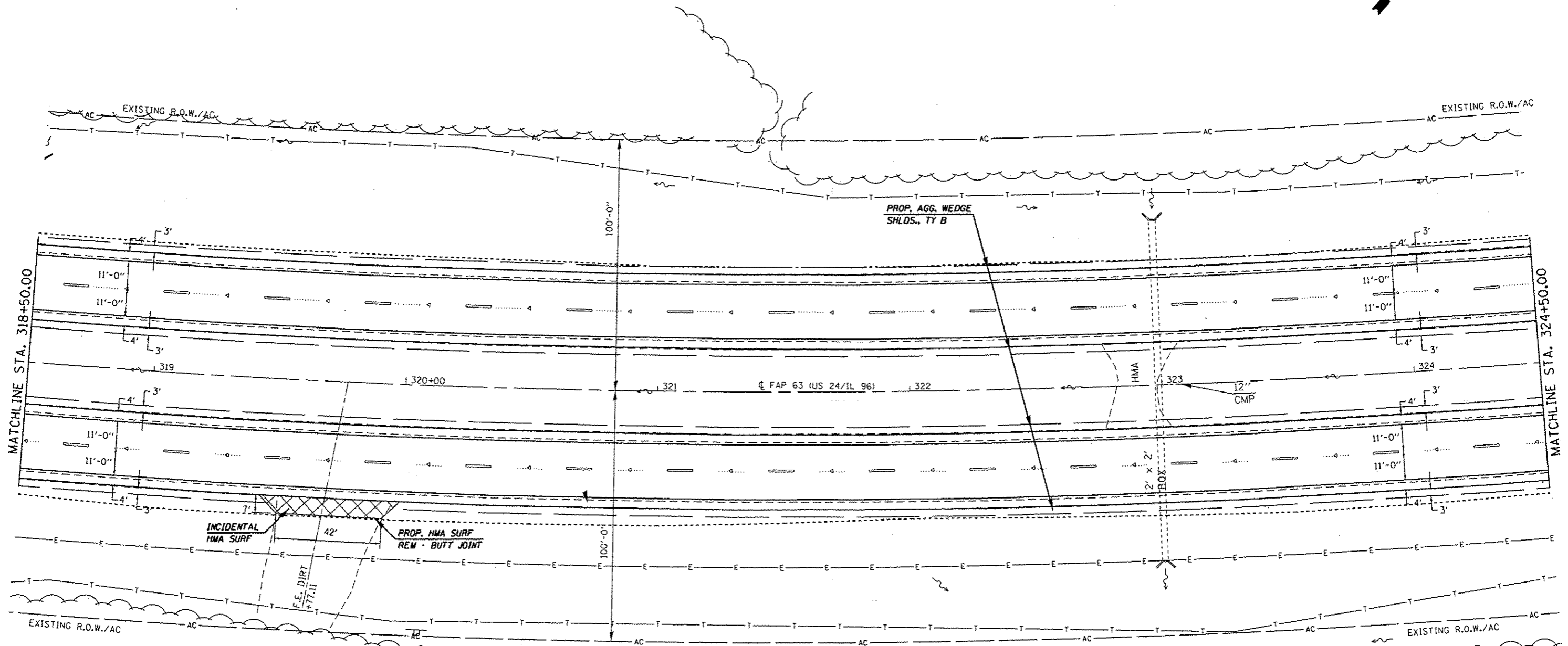
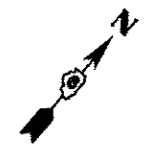

EXIST. CURVE 640  
 PI STA. = 325+60.33  
 $\Delta = 38^\circ 23' 00''$  (LT)  
 $D = 1^\circ 30' 02''$   
 $R = 3,818.03'$   
 $T = 1,328.96'$   
 $L = 2,557.76'$   
 $E = 224.68'$   
 $\theta = 3.7\%$   
 $T.R. = 42'$   
 $S.E. RUN = 103'$   
 $P.C. STA. = 312+31.37$   
 $P.T. STA. = 337+89.13$

• FAP 63 (US 24); FAP 63 (US 24/IL 96); FAP 506 (IL 96)

FILE NAME : c:\p\work\p\dot\eparkgu\0259630\PLA\lang.dgn	USER NAME : eparkgu	DESIGNED - DRAWN -	REVISED - REVISED -
Default	PLLOT SCALE = 48.0000' / in.	CHECKED - DATE -	REVISED - REVISED -
	PLLOT DATE = Dec-14-2012 03:45:24PM		

STATE OF ILLINOIS  
DEPARTMENT OF TRANSPORTATION

PLAN SHEET

SCALE: 20 SHEET 13 OF 29 SHEETS STA. 318+50.00 TO STA. 324+50.00

F.A.P. RTE.	SECTION	COUNTY	TOTAL SHEETS	SHEET NO.
	(1)N,TS-2RS-5&(7)RS-3	ADAMS	194	67
CONTRACT NO. 72E31			ILLINOIS FED. AID PROJECT	