

(8)

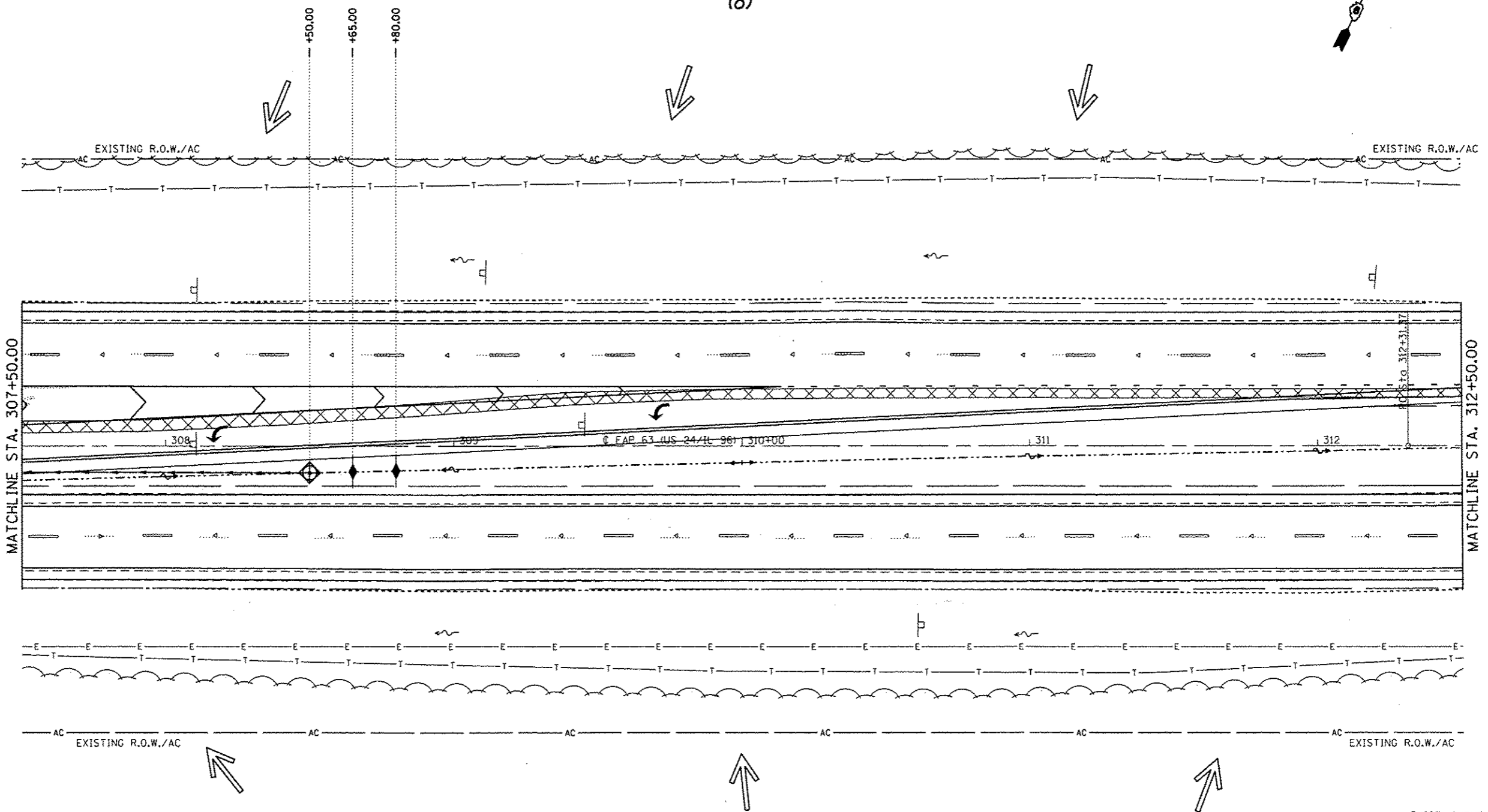

EXIST. CURVE 640  
 PI STA. = 325+60.33  
 $\Delta = 38^\circ 23' 00''$  (LT)  
 $D = 1^\circ 30' 02''$   
 $R = 3,818.03'$   
 $T = 1,328.96'$   
 $L = 2,557.76'$   
 $E = 224.68'$   
 $e = 3.7\%$   
 $T.R. = 42'$   
 $S.E. RUN = 103'$   
 $P.C. STA. = 312+31.37$   
 $P.T. STA. = 337+89.13$

\* FAP 63 (US 24); FAP 63 (US 24/IL 96); FAP 506 (IL 96)

FILE NAME =	USER NAME = sparkgy	DESIGNED -	REVISED -	<b>STATE OF ILLINOIS DEPARTMENT OF TRANSPORTATION</b>	<b>STORM WATER POLLUTION PREVENTION PLAN</b>		F.A.P. RTE.	SECTION	COUNTY	TOTAL SHEETS	SHEET NO.
c:\pwork\pwork\sparkgy\0259638\067	FE31-sht-spln.dgn	DRAWN -	REVISED -				.	(11)TS-2RS-5&(78)RS-3	ADAMS	194	92
PLANS	PLOT SCALE = 40,0000' / in.	CHECKED -	REVISED -				SCALE: 20		SHEET 9 OF 18 SHEETS		STA. 307+50.00 TO STA. 312+50.00
	PLOT DATE = Dec-14-2012 04:02:19PM	DATE -	REVISED -	ILLINOIS FED. AID PROJECT							