

DATE	
BY	
CHECKED	
PLOTTED	
TEMPLATE	
NOTE BOOK	
AREA'S CHECKED	
NO.	

DATE	
BY	
CHECKED	
PLOTTED	
TEMPLATE	
NOTE BOOK	
AREA'S CHECKED	
NO.	

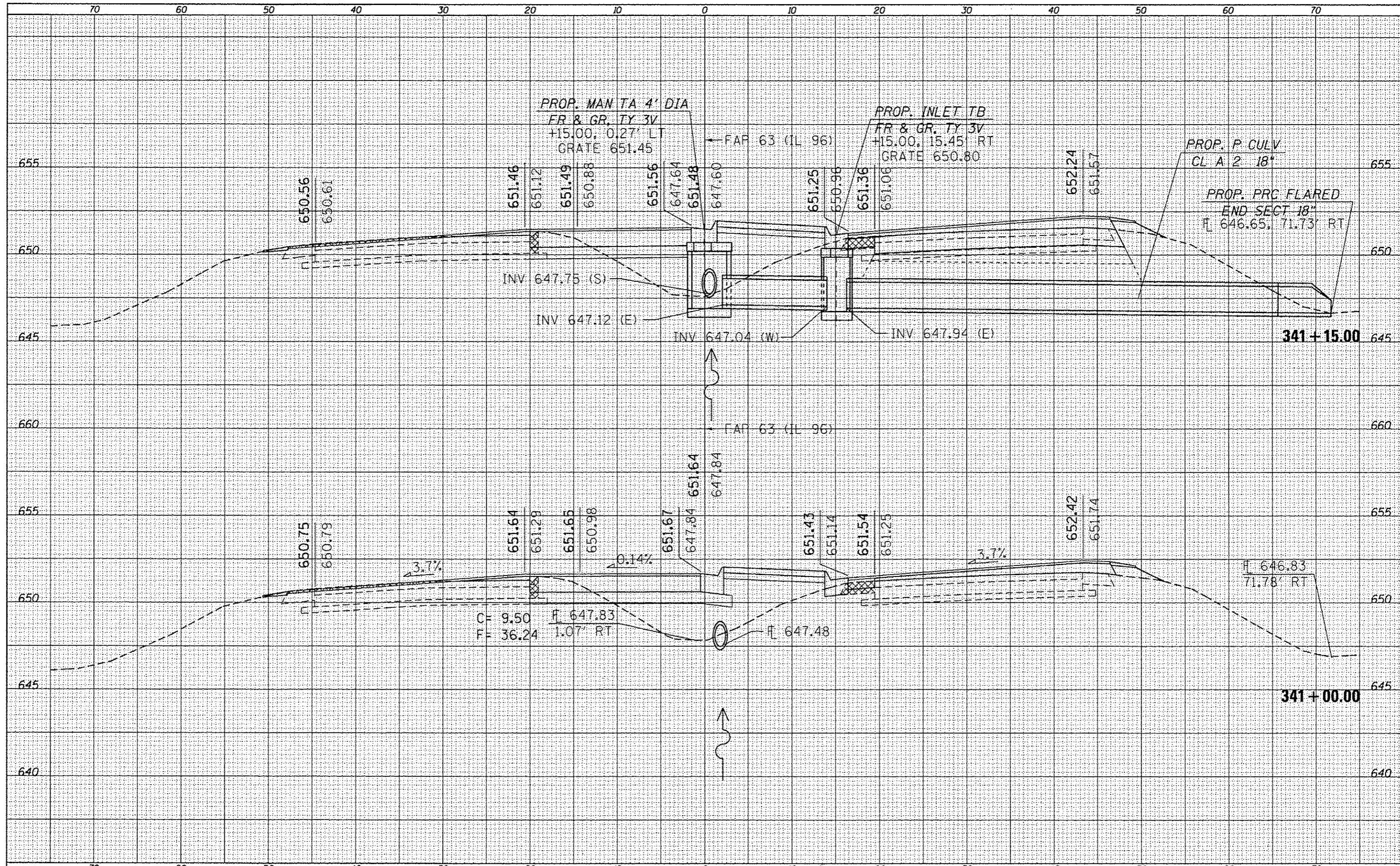

FILE NAME =	USER NAME = sparkgw	DESIGNED -	REVISED -	STATE OF ILLINOIS DEPARTMENT OF TRANSPORTATION	CROSS SECTIONS		F.A.P. RTE.	SECTION	COUNTY	TOTAL SHEETS	SHEET NO.
c:\pwork\p\dot\sparkgw\d0259630\0672E31-sh	xsht IL 961501.dgn	DRAWN -	REVISED -		•	(1)N,TS-2RS-5&(78)RS-3	ADAMS	194	177		
Default	PLOT SCALE = 10.0000' / in.	CHECKED -	REVISED -		SCALE:	SHEET 35 OF 52 SHEETS	STA. 341+00.00 TO STA. 341+15.00	CONTRACT NO. 72E31			
	PLOT DATE = Dec-14-2012 03:46:46PM	DATE -	REVISED -					ILLINOIS FED. AID PROJECT			

• FAP 63 (US 24); FAP 63 (US 24/IL 96); FAP 506 (IL 96)