

DATE	
BY	
REVISION	
NOTED	
PLANNED	
DESIGNED	
CHECKED	
DRAWN	
FILE NAME	
NO.	

DATE	
BY	
REVISION	
NOTED	
PLANNED	
DESIGNED	
CHECKED	
DRAWN	
FILE NAME	
NO.	

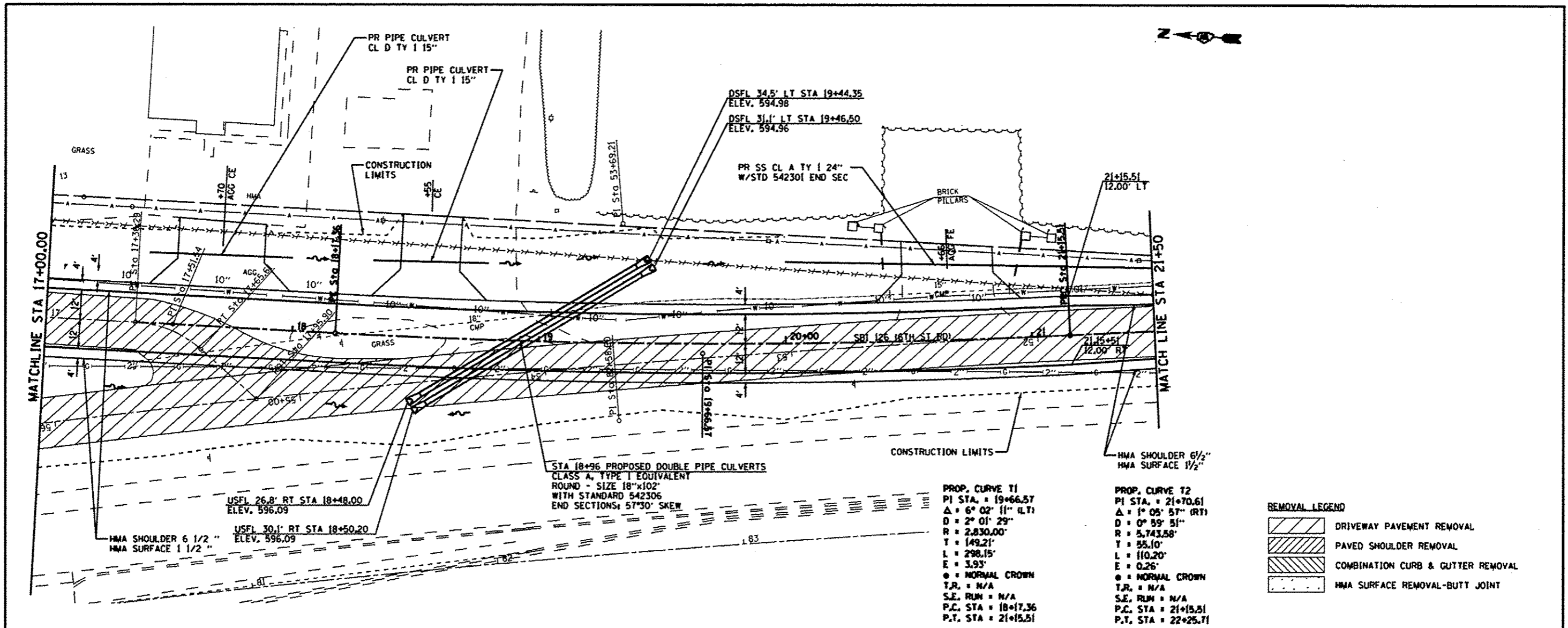

PROP. CURVE T1
 PI STA. = 19+66.57
 $\Delta = 6^{\circ} 02' 11''$ (LT)
 $D = 2^{\circ} 01' 29''$
 $R = 2,830.00'$
 $T = 149.21'$
 $L = 298.15'$
 $E = 3.93'$
 C = NORMAL CROWN
 T.R. = N/A
 S.E. RUN = N/A
 P.C. STA. = 18+17.36
 P.T. STA. = 21+15.51

PROP. CURVE T2
 PI STA. = 21+70.61
 $\Delta = 1^{\circ} 05' 57''$ (RT)
 $D = 0^{\circ} 59' 51''$
 $R = 5,743.58'$
 $T = 55.10'$
 $L = 110.20'$
 $E = 0.26'$
 C = NORMAL CROWN
 T.R. = N/A
 S.E. RUN = N/A
 P.C. STA. = 21+15.51
 P.T. STA. = 22+25.71

REMOVAL LEGEND

	DRIVEWAY PAVEMENT REMOVAL
	PAVED SHOULDER REMOVAL
	COMBINATION CURB & GUTTER REMOVAL
	HMA SURFACE REMOVAL-BUTT JOINT

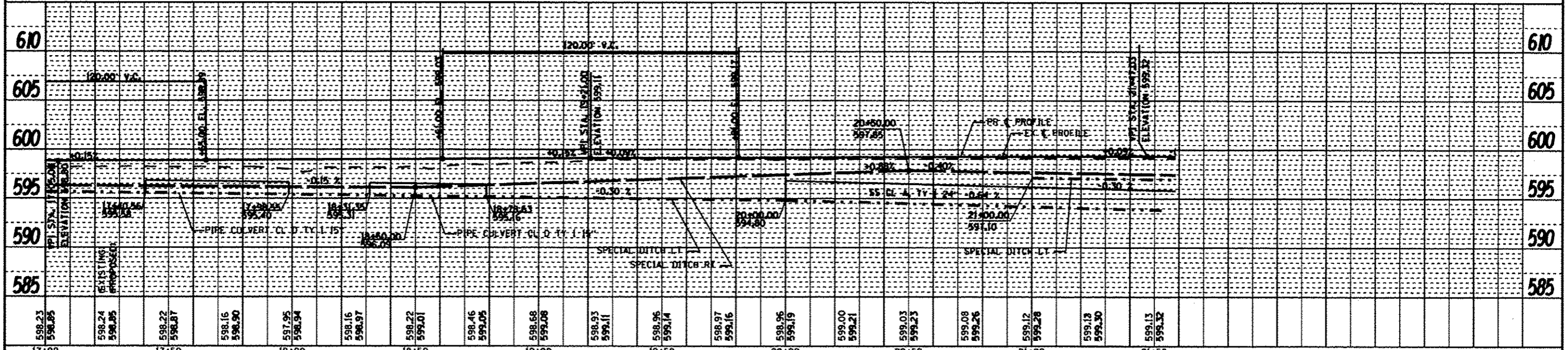

598.23	598.24	598.22	598.16	597.95	598.16	598.22	598.46	598.68	598.93	598.96	598.97	598.96	599.00	599.03	599.08	599.12	599.13	599.13
17+00	17+50	18+00	18+50	19+00	19+50	20+00	20+50	21+00	21+50									

CEC
Cummins Engineering Corporation
Civil and Structural Engineering

JOB # 2265.11
 FILE NAME = 0672F74-shr-plndgn
 PLOT SCALE = 48.0000" / IN.
 PLOT DATE = 4/15/2013

DESIGNED - NAK
 DRAWN - SJS
 CHECKED - NAK
 DATE - 10/8/2012

REVISED - 4-16-2013
 REVISED -
 REVISED -
 REVISED -

STATE OF ILLINOIS
DEPARTMENT OF TRANSPORTATION

PLAN AND PROFILE SHEET
SBI 126 (6TH STREET ROAD)
 SCALE: SHEET OF SHEETS STA. 17+00 TO STA. 22+50

S.B.I. RTE.	SECTION	COUNTY	TOTAL SHEETS	SHEET NO.
126	(110) 1-2	SANGAMON	93	31
FED. ROAD DIST. NO.			ILLINOIS FED. AID PROJECT	
			CONTRACT NO. 72F74	