

STATE OF ILLINOIS
DEPARTMENT OF TRANSPORTATION
DIVISION OF HIGHWAYS

F.A.S. RTE.	SECTION	COUNTY	TOTAL SHEETS	SHEET NO.
858	12VB-II	RANDOLPH	72	1
FED. ROAD DIST. NO.	ILLINOIS	CONTRACT NO. 76409		

72 + 2 = 74

FOR INDEX OF SHEETS, SEE SHEET NO. 2

PLANS FOR PROPOSED HIGHWAY IMPROVEMENT

FAS ROUTE 858 (ROOTS ROAD)
SECTION 12VB-1I
PROJECT ACRS-0858(300)
RANDOLPH COUNTY

BRIDGE REHABILITATION

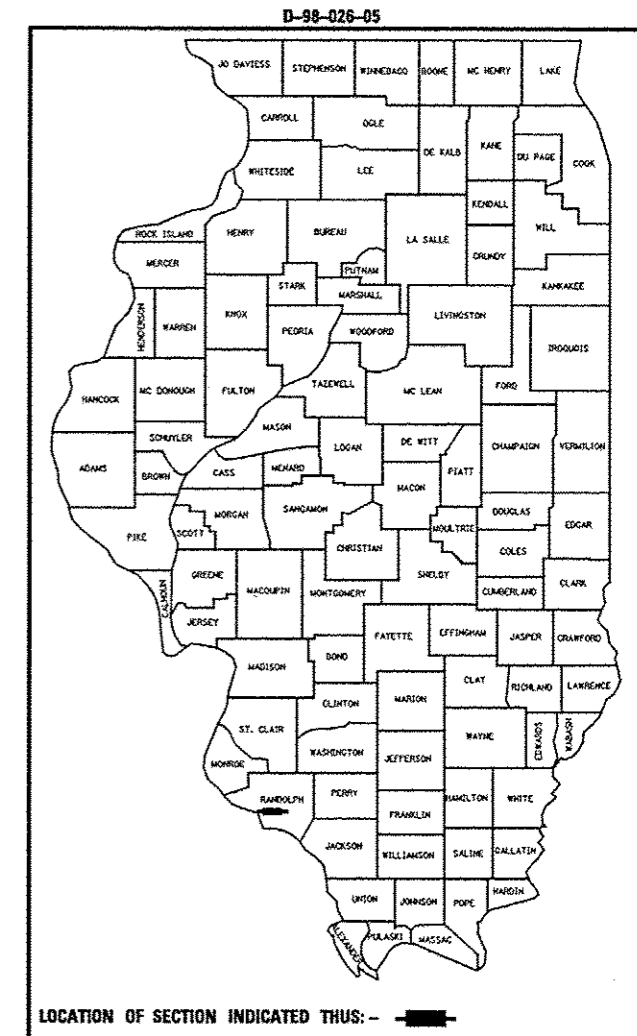

SECTION 12VB-1I INCLUDES THE REMOVAL AND REPLACEMENT OF THE EXISTING CONCRETE DECK ON THE EXISTING STEEL BEAMS AND SUBSTRUCTURE UNITS FOR THE STRUCTURE CARRYING ROOTS ROAD OVER UNION PACIFIC RAILROAD. THIS WORK ALSO INCLUDES RECONSTRUCTION OF THE BRIDGE APPROACH SLABS.
STA. 650+10.50
SN 079-0020

C-98-045-05

SECTION 12VB-1I BEGINS STA 624+34.70

SECTION 12VB-1I ENDS STA 652+10.00

SECTION 12VB-1I INCLUDES BRIDGE REPAIRS FOR THE STRUCTURE CARRYING ROOTS ROAD OVER THE KASKASKIA RIVER
STA. 631+60.00
SN 079-0019

RESURFACING OMISSION STA. 638+84.70 TO STA 648+11.00

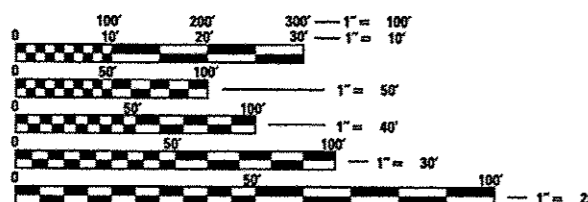

FULL SIZE PLANS HAVE BEEN PREPARED USING STANDARD ENGINEERING SCALES. REDUCED SIZED PLANS WILL NOT CONFORM TO STANDARD SCALES. IN MAKING MEASUREMENTS ON REDUCED PLANS, THE ABOVE SCALES MAY BE USED.

J.U.L.I.E.
JOINT UTILITY LOCATION INFORMATION FOR EXCAVATION
1-800-892-0123
OR 811

PROJECT ENGINEER: PATTI LEBEAU (618) 346-3179
PROJECT MANAGER: HERVE GELIN (618) 346-3323

CONTRACT NO. 76409

ADT: 475 (2012) COLLECTOR
ADT: 975 (2023)
13.3% TRUCKS

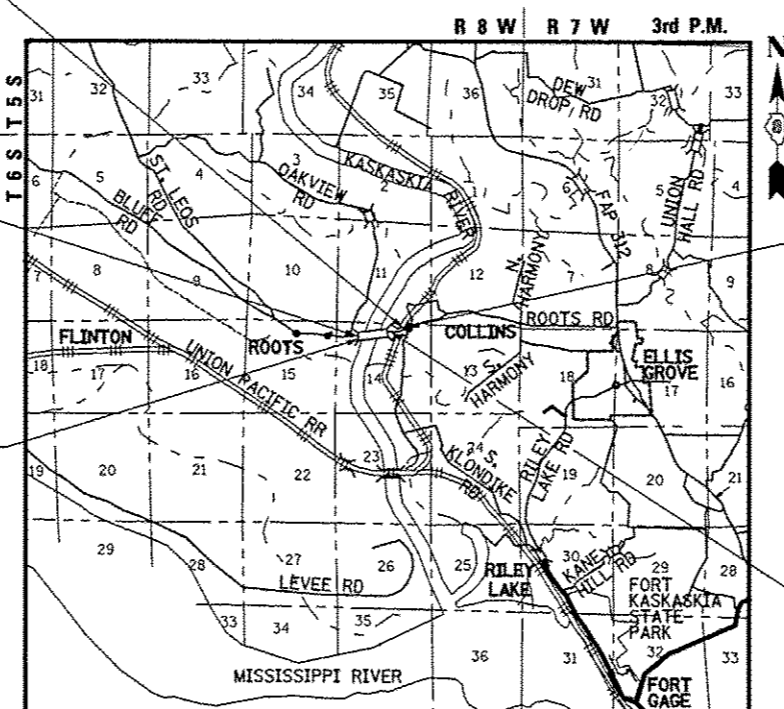

LOCATION MAP
ELLIS GROVE TOWNSHIP
GRAPHIC SCALE IN MILES

GROSS SECTION LENGTH = 2775.30 FEET = 0.525 MILES
OMISSION LENGTH = 926.30 FEET = 0.175 MILES
NET SECTION LENGTH = 1850.00 FEET = 0.350 MILES

LATITUDE
SN 079-0019 38°01' 0.13"
SN 079-0020 38°01' 2.98"
LONGITUDE
89°57' 34.11"
89°57' 2.40"



Brian R. Mueller
ILLINOIS PROFESSIONAL ENGINEER NO. 062-052018
EXP. 11-30-2013

STATE OF ILLINOIS
DEPARTMENT OF TRANSPORTATION
DIVISION OF HIGHWAYS

SUBMITTED December 13 2012
Deputy Director of Highways, Region 5 Engineer
March 22 2013
John D. Baranzelli, P.E.
Engineer of Design and Environment
March 22 2013
Omer Osman, P.E.
Director of Highways, Chief Engineer



BERNARDIN * LOCHMUELLER & ASSOCIATES, INC.
3 OAK DRIVE
MARYVILLE, ILLINOIS 62062
PHONE (618) 288-4666
FAX (618) 288-4666

PRINTED BY THE AUTHORITY
OF THE STATE OF ILLINOIS