

EROSION CONTROL & SEDIMENT CONTROL NOTES

ALL EROSION CONTROL PRODUCTS FURNISHED SHALL BE SPECIFICALLY RECOMMENDED BY THE MANUFACTURER FOR THE USE SPECIFIED IN THE EROSION CONTROL PLANS. PRIOR TO APPROVAL AND USE OF THE PRODUCT, THE CONTRACTOR SHALL SUBMIT TO THE ENGINEER A NOTARIZED CERTIFICATION BY THE PRODUCER STATING THE INTENDED USE OF THE PRODUCT AND THAT THE PHYSICAL PROPERTIES REQUIRED FOR THIS APPLICATION ARE MET OR EXCEEDED. THE CONTRACTOR SHALL PROVIDE THE MANUFACTURER RECOMMENDED INSTALLATION PROCEDURES TO FACILITATE THE ENGINEER IN CONSTRUCTION INSPECTION.

TEMPORARY SEEDING SHALL BE COMPLETED ON A WEEKLY BASIS ON EXPOSED GROUND AND WILL NOT BE PAID FOR SEPARATELY BUT CONSIDERED AS INCLUDED IN THE PERMANENT SEEDING ITEMS.

ALL AREAS DISTURBED FOR ANY REASON SHALL BE PERMANENTLY SEEDDED AS DIRECTED BY THE ENGINEER. ALL AREAS DISTURBED BY THE CONTRACTOR OUTSIDE THE PROPOSED CONSTRUCTION LIMITS SHALL BE SEEDDED AT THE CONTRACTOR'S EXPENSE.

FINAL SEEDING SHALL BE PERFORMED AS SOON AS POSSIBLE.

FAS ROUTE 858
(ROOTS ROAD)

632 633 634



MATCH LINE STA 635+00.00

FOR RIGHT OF WAY INFORMATION
SEE RIGHT OF WAY PLAN SHEETS

MATCH LINE STA 635+00.00

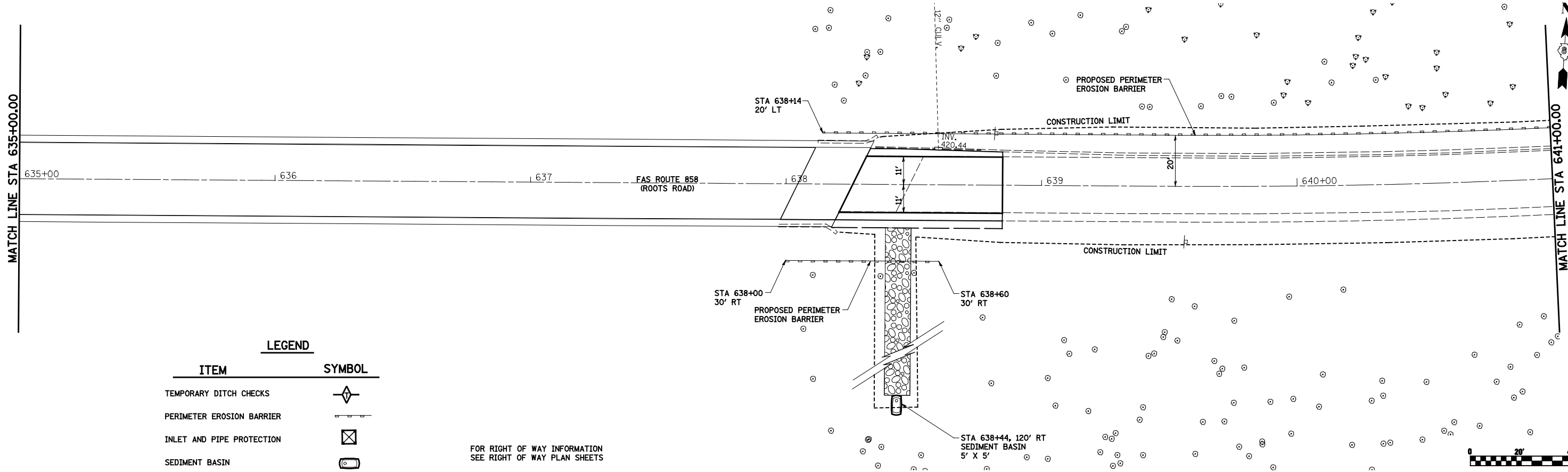

MATCH LINE STA 641+00.00

LEGEND

ITEM	SYMBOL
TEMPORARY DITCH CHECKS	
PERIMETER EROSION BARRIER	
INLET AND PIPE PROTECTION	
SEDIMENT BASIN	

FOR RIGHT OF WAY INFORMATION
SEE RIGHT OF WAY PLAN SHEETS



FILE NAME =	USER NAME = Paul	DESIGNED - JWS	REVISED -	STATE OF ILLINOIS DEPARTMENT OF TRANSPORTATION	EROSION AND SEDIMENT CONTROL PLAN	F.A.S. RTE. 858	SECTION 12VB-11	COUNTY RANDOLPH	TOTAL SHEETS 72	SHEET NO. 15	
®FILEL#		DRAWN - PDB	REVISED -			SCALE: 1"=20' SHEET NO. 1 OF 2 SHEETS STA. 629+00.00 TO STA. 641+00.00					
		CHECKED - BRM	REVISED -			ILLINOIS FED. AID PROJECT					
		DATE - 03-28-11	REVISED -			CONTRACT NO. 76409					