

**EAST CURB LINE**

Location	Station	Offset	Theoretical Grade Elevations
N. End North Appr. Pav't.	128+97.08	-18.00	434.69
A	129+07.08	-18.00	434.76
B	129+17.08	-18.00	434.83
S. End North Appr. Pav't	129+27.08	-18.00	434.90

**EAST EDGE OF PAVEMENT**

Location	Station	Offset	Theoretical Grade Elevations
N. End North Appr. Pav't.	128+97.08	-12.00	434.81
A	129+07.08	-12.00	434.88
B	129+17.08	-12.00	434.95
S. End North Appr. Pav't	129+27.08	-12.00	435.02

**℄ ROADWAY AND P.G.**

Location	Station	Offset	Theoretical Grade Elevations
N. End North Appr. Pav't.	128+97.08	0.00	435.00
A	129+07.08	0.00	435.07
B	129+17.08	0.00	435.14
S. End North Appr. Pav't	129+27.08	0.00	435.21

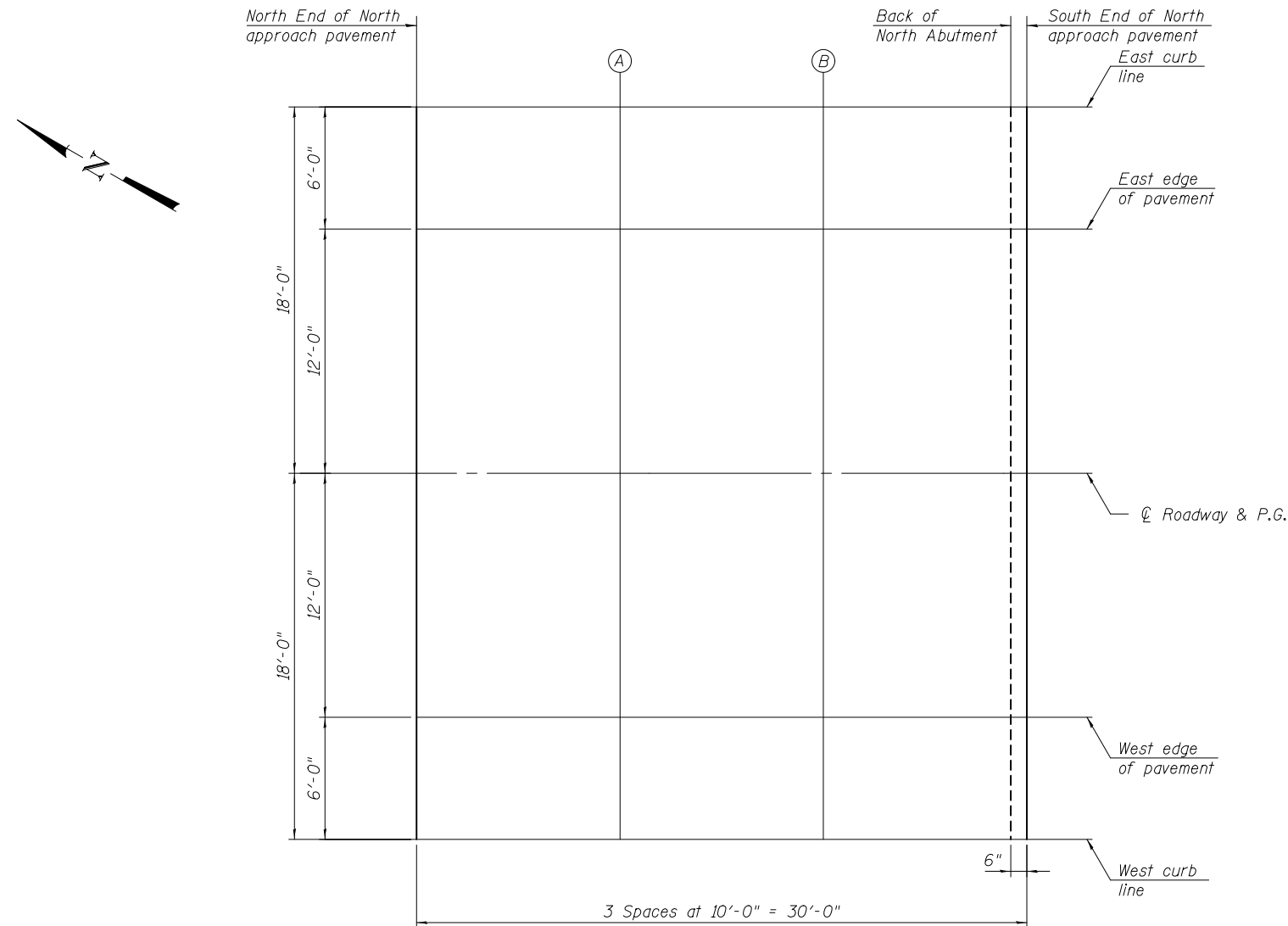

**PLAN**

**WEST EDGE OF PAVEMENT**

Location	Station	Offset	Theoretical Grade Elevations
N. End North Appr. Pav't.	128+97.08	12.00	434.81
A	129+07.08	12.00	434.88
B	129+17.08	12.00	434.95
S. End North Appr. Pav't	129+27.08	12.00	435.02

**WEST CURB LINE**

Location	Station	Offset	Theoretical Grade Elevations
N. End North Appr. Pav't.	128+97.08	18.00	434.69
A	129+07.08	18.00	434.76
B	129+17.08	18.00	434.83
S. End North Appr. Pav't	129+27.08	18.00	434.90



USER NAME =	DESIGNED - JTH	REVISED
	CHECKED - RLM	REVISED
PLOT SCALE =	DRAWN - PRC	REVISED
PLOT DATE = 2/1/2013	CHECKED - JTH	REVISED

**STATE OF ILLINOIS  
DEPARTMENT OF TRANSPORTATION**

**TOP OF NORTH APPROACH SLAB ELEVATIONS  
STRUCTURE NO. 014-0033**

SHEET NO. 12 OF 61 SHEETS

F.A.P. RTE.	SECTION	COUNTY	TOTAL SHEETS	SHEET NO.
42	1-1BR-2	CLINTON	159	81
<b>CONTRACT NO. 76479</b>				
ILLINOIS FED. AID PROJECT				