

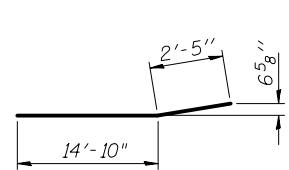

BAR h₂(E)

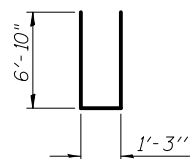

BAR h₄(E)



BAR n(E)

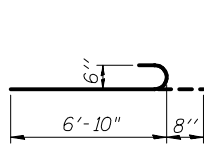

BAR n₁(E)

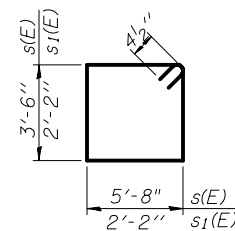

BARS s(E) & s₁(E)

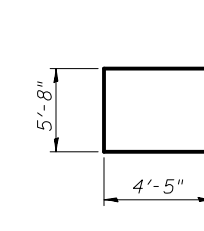

BAR u(E)

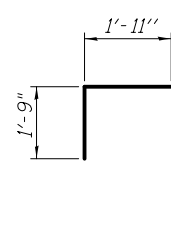

BAR v(E)

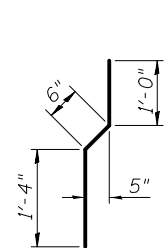

BAR v₁(E)

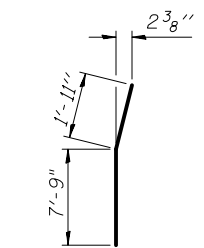

BAR v₃(E)

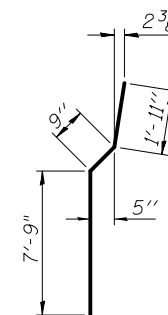

BAR v₄(E)

PILE DATA

Type: HP14x89
 Nominal Required Bearing: 705 kips
 Factored Resistance Available: 388 kips
 Est. Length: 52 feet
 No. Production Piles: 24
 No. Test Piles: 0

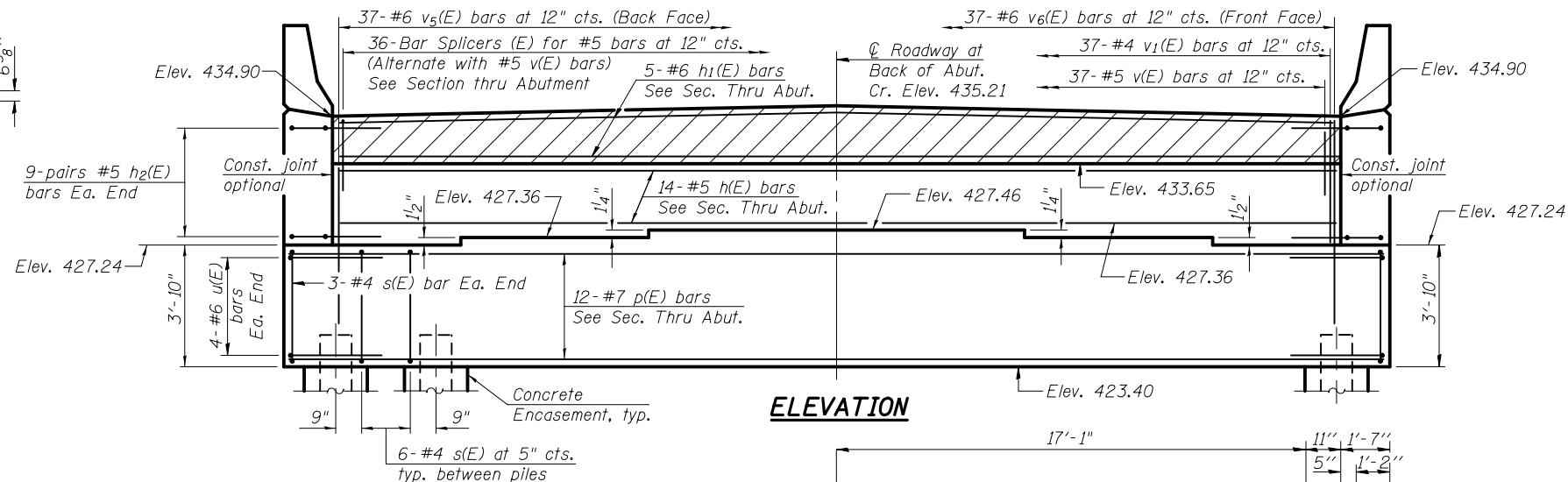

ELEVATION

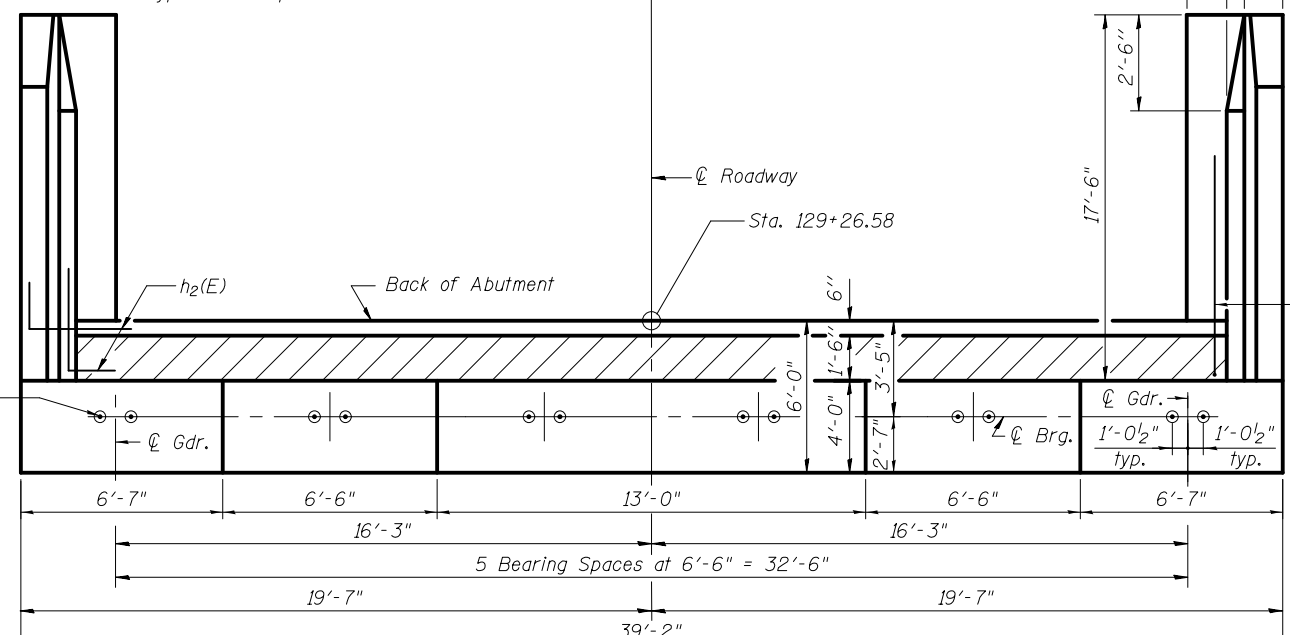

TOP VIEW

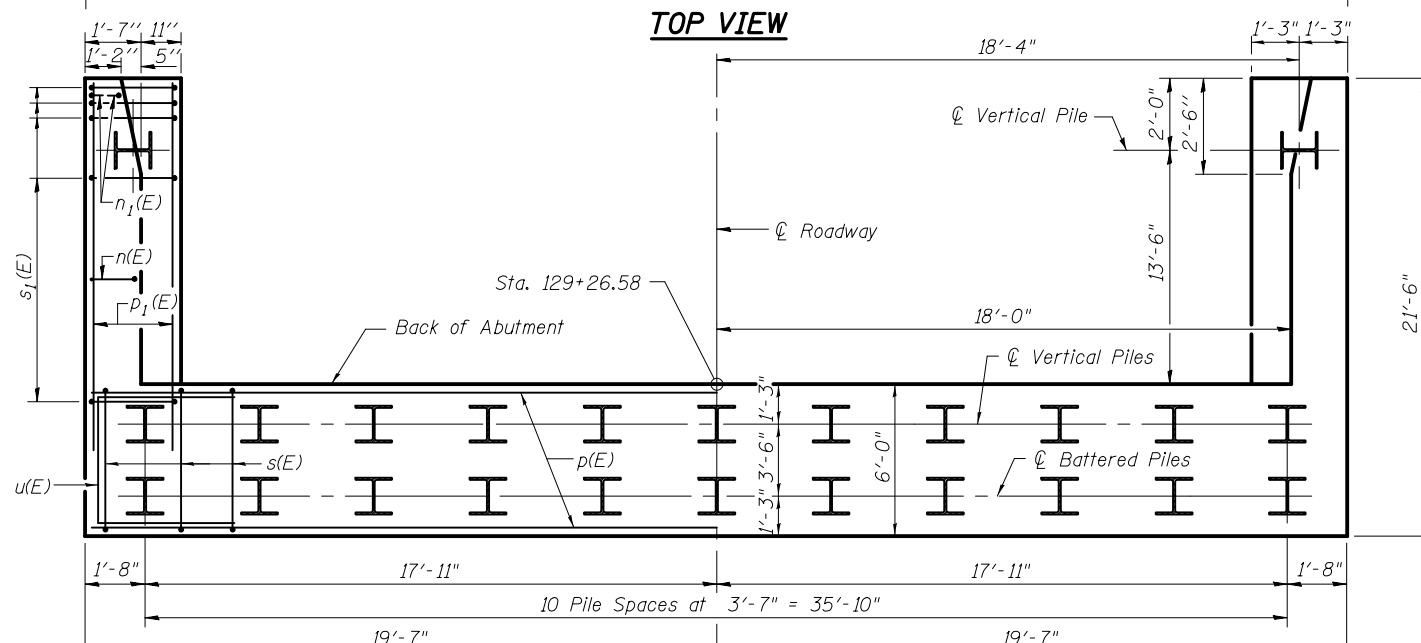

PLAN-PILE CAP

**NORTH ABUTMENT
BILL OF MATERIAL**

Bar	No.	Size	Length	Shape
h(E)	14	#5	35'-8"	—
h ₁ (E)	5	#6	35'-8"	—
h ₂ (E)	36	#5	8'-6"	L
h ₃ (E)	30	#4	17'-2"	—
h ₄ (E)	22	#4	17'-3"	—
n(E)	30	#6	14'-11"	—
n ₁ (E)	12	#6	7'-6"	—
p(E)	12	#7	38'-10"	—
p ₁ (E)	20	#7	18'-5"	—
s(E)	66	#4	19'-1"	—
s ₁ (E)	38	#4	9'-5"	—
u(E)	8	#6	14'-6"	—
v(E)	37	#5	3'-8"	—
v ₁ (E)	37	#4	2'-10"	—
v ₂ (E)	36	#6	10'-2"	—
v ₃ (E)	6	#6	9'-8"	—
v ₄ (E)	30	#6	10'-5"	—
v ₅ (E)	37	#6	8'-6"	—
v ₆ (E)	37	#6	9'-10"	—
Structure Excavation	Cu. Yd.		440	
Concrete Structures	Cu. Yd.		74.4	
Reinforcement Bars, Epoxy Coated	Pound		7,810	
Concrete Encasement	Cu. Yd.		13.1	
Furnishing Steel Piles, HP14x89	Foot		1248	
Driving Piles	Foot		1248	
Concrete Sealer	Sq. Ft.		505	

Notes:
 Hatched area to be poured after superstructure false work has been removed.
 For details of Bar Splicers, see sheet 50 of 61.
 For details of piles and Concrete Encasement, see sheet 46 of 61.



USER NAME =	DESIGNED - JTH	REVISED
	CHECKED - RLM	REVISED
PLOT SCALE =	DRAWN - PRC	REVISED
PLOT DATE = 2/1/2013	CHECKED - JTH	REVISED

STATE OF ILLINOIS
DEPARTMENT OF TRANSPORTATION

NORTH ABUTMENT
STRUCTURE NO. 014-0033

SHEET NO. 37 OF 61 SHEETS

F.A.P. RTE.	SECTION	COUNTY	TOTAL SHEETS	SHEET NO.
42	1-1BR-2	CLINTON	159	106
CONTRACT NO. 76479				
ILLINOIS FED. AID PROJECT				