

DATE	
BY	
SURVEYED	
PLOTTED	
TEMPLATE	
AREAS	
CHECKED	
NO.	

DATE	
BY	
SURVEYED	
PLOTTED	
TEMPLATE	
AREAS	
CHECKED	
NO.	

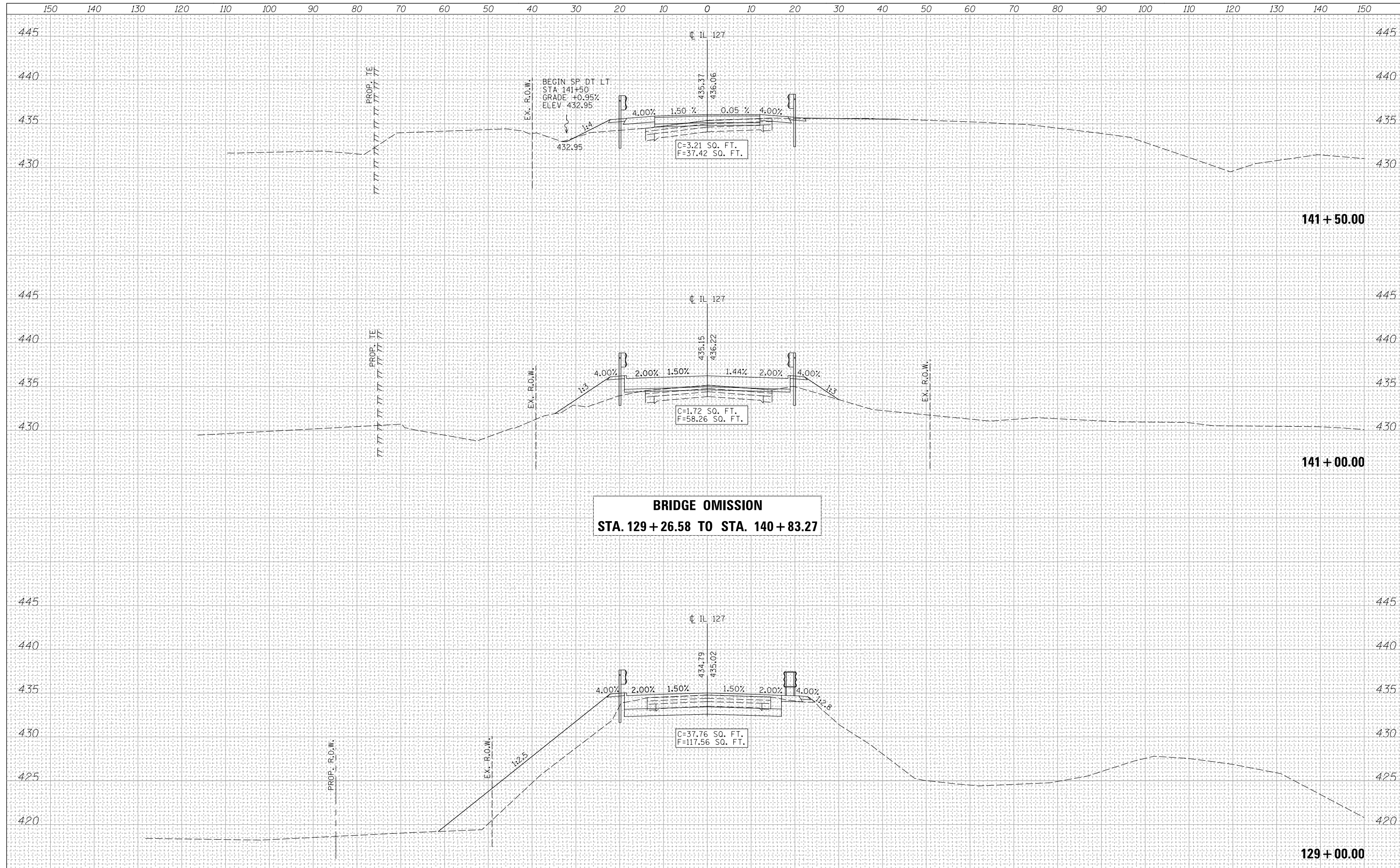

BRIDGE OMISSION
STA. 129+26.58 TO STA. 140+83.27

Lin Engineering, Ltd.
 Consulting Engineers
 Westmont, Illinois

USER NAME = Plotted by Scott	DESIGNED - RK	REVISIED -
	DRAWN - RK	REVISIED -
PLOT SCALE = 20.0000' / in.	CHECKED - SEW	REVISIED -
PLOT DATE	DATE - 2-1-2013	REVISIED -

STATE OF ILLINOIS
DEPARTMENT OF TRANSPORTATION

CROSS SECTIONS
IL 127 OVER KASKASKIA RIVER
 SCALE: 1"=10'H, 5'V SHEET NO. 3 OF 25 SHEETS STA. 129+00.00 TO STA. 141+50.00

F.A.P. RTE.	SECTION	COUNTY	TOTAL SHEETS	SHEET NO.
42	1-1BR-2	CLINTON	159	137
				CONTRACT NO. 76479
ILLINOIS FED. AID PROJECT				