

- STAGE 1
1. REMOVE EXISTING PAVEMENT AND SHOULDER. CONSTRUCT HMA PAVEMENT AND SHOULDER AND RAISED ISLAND.
 2. SHIFT LANES AS SHOWN. A 2' OUTSIDE SHOULDER AND GREATER THAN A 3' CLEARANCE BETWEEN THE INSIDE EDGE OF PAVEMENT AND THE DROP OFF AREA IS REQUIRED AS A MINIMUM. REFER TO DROP-OFF PROTECTION CHART.
 3. SHAWNEE TRAIL WILL BE LIMITED TO RIGHT IN/RIGHT OUT TRAFFIC ONLY DURING THIS STAGE.

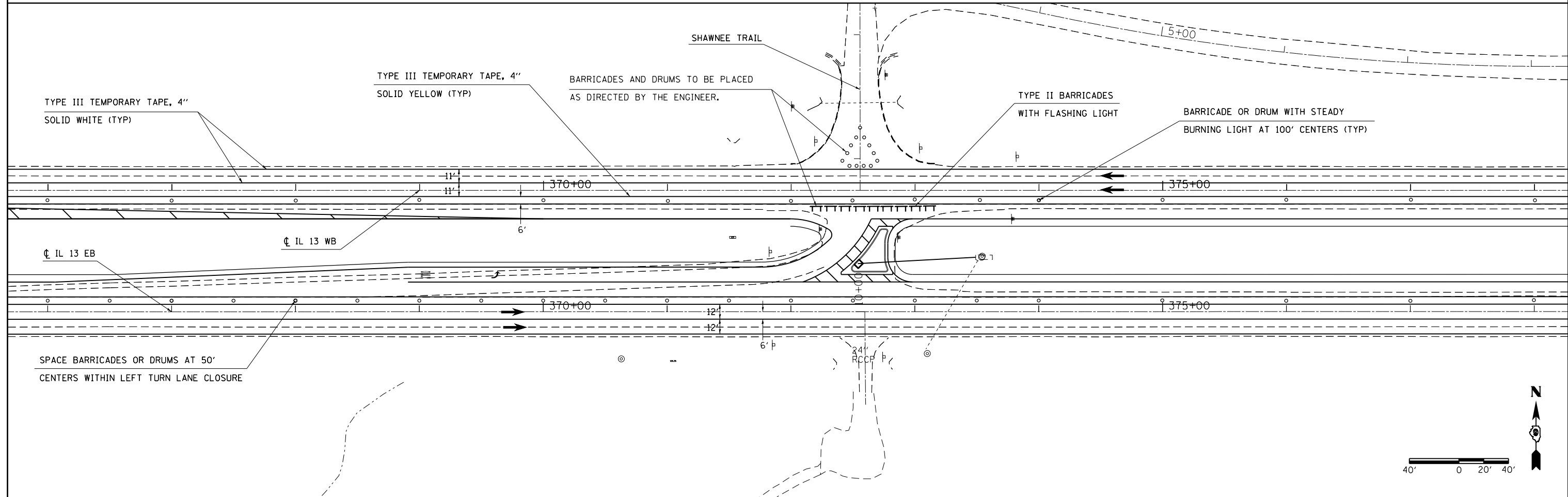
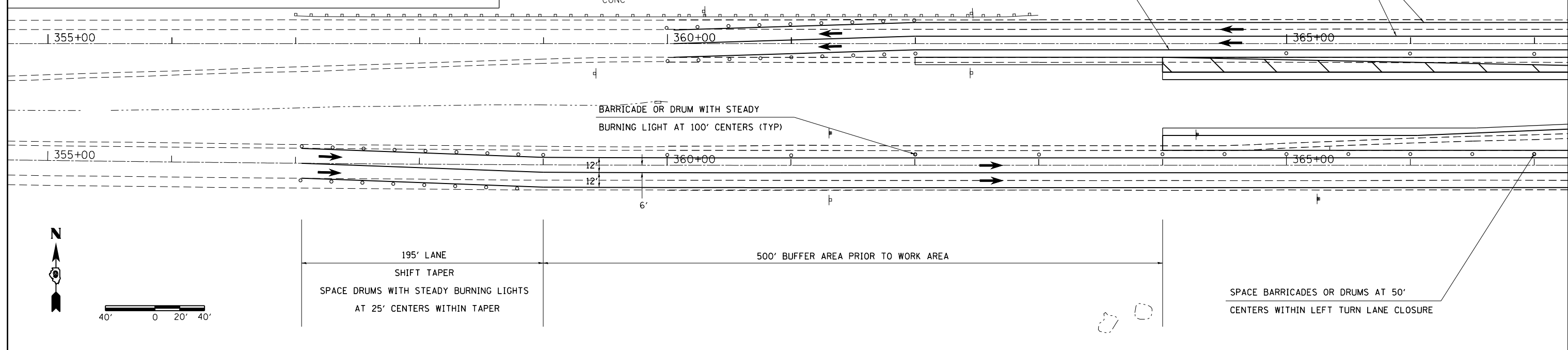

FILE NAME =	USER NAME = thomeshf	DESIGNED -	REVISED -	STATE OF ILLINOIS DEPARTMENT OF TRANSPORTATION	STAGING SHEET STAGE 1				F.A.P. RTE.	SECTION	COUNTY	TOTAL SHEETS	SHEET NO.			
Default	et:\pw\work\p\dot\thomeshf\0278330\DX\staging.dgn	DRAWN -	REVISED -		SCALE:	SHEET	OF	SHEETS	STA.	TO	STA.	331	(1-4R-3,N-5)	WILLIAMSON	91	28
	PLOT SCALE = 80.0000' / in.	CHECKED -	REVISED -													
	PLOT DATE = 2/20/2013	DATE -	REVISED -													
												CONTRACT NO. 78280		ILLINOIS FED. AID PROJECT		