

STATE OF ILLINOIS
DEPARTMENT OF TRANSPORTATION

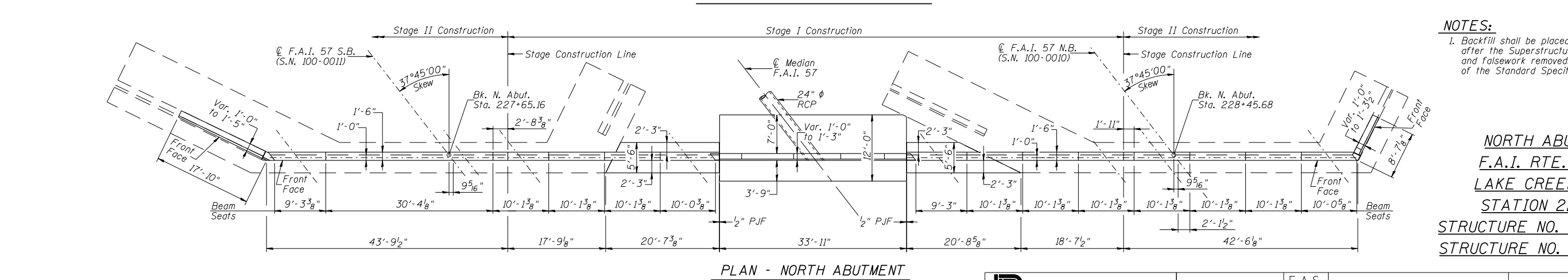
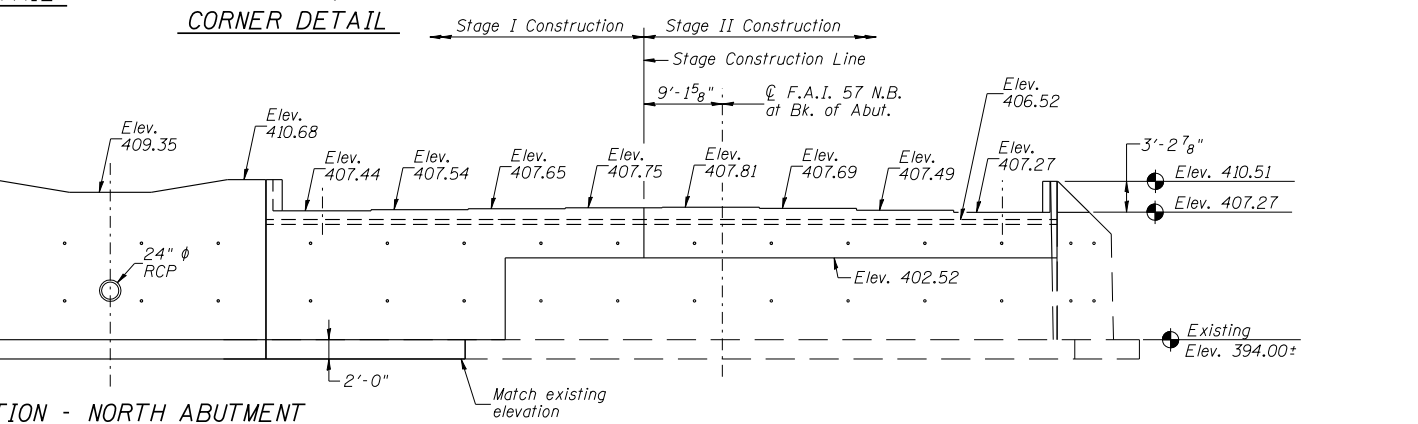
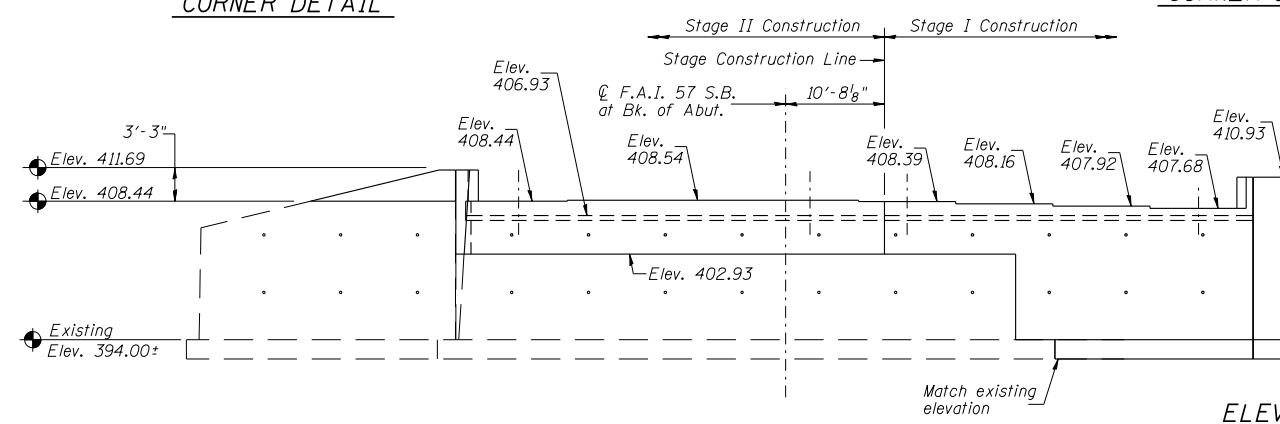
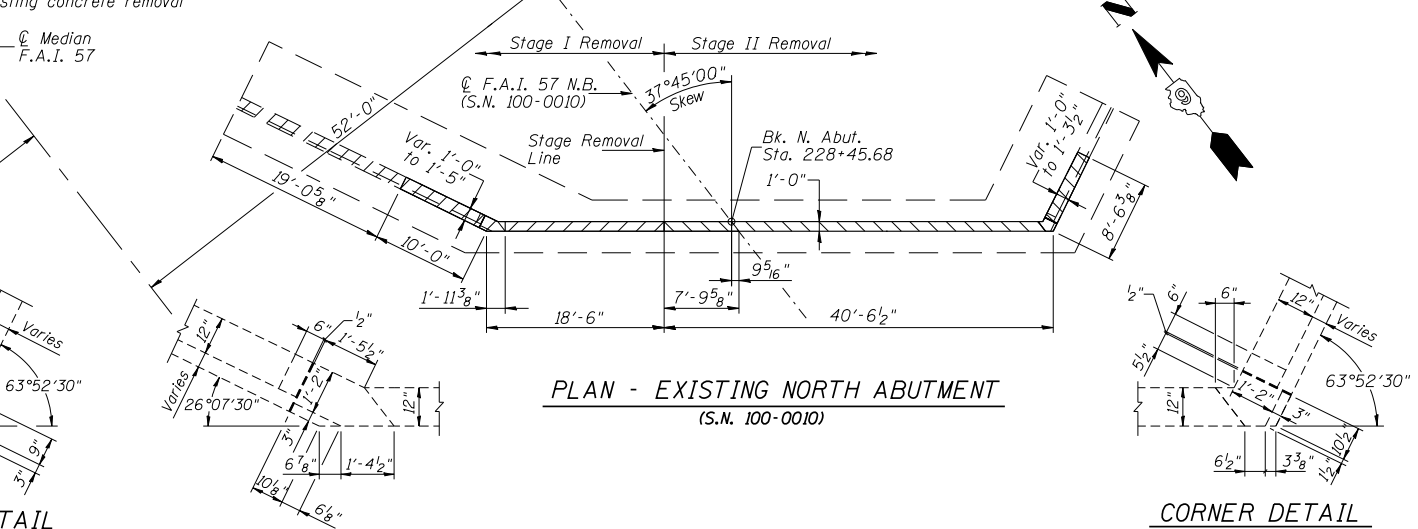
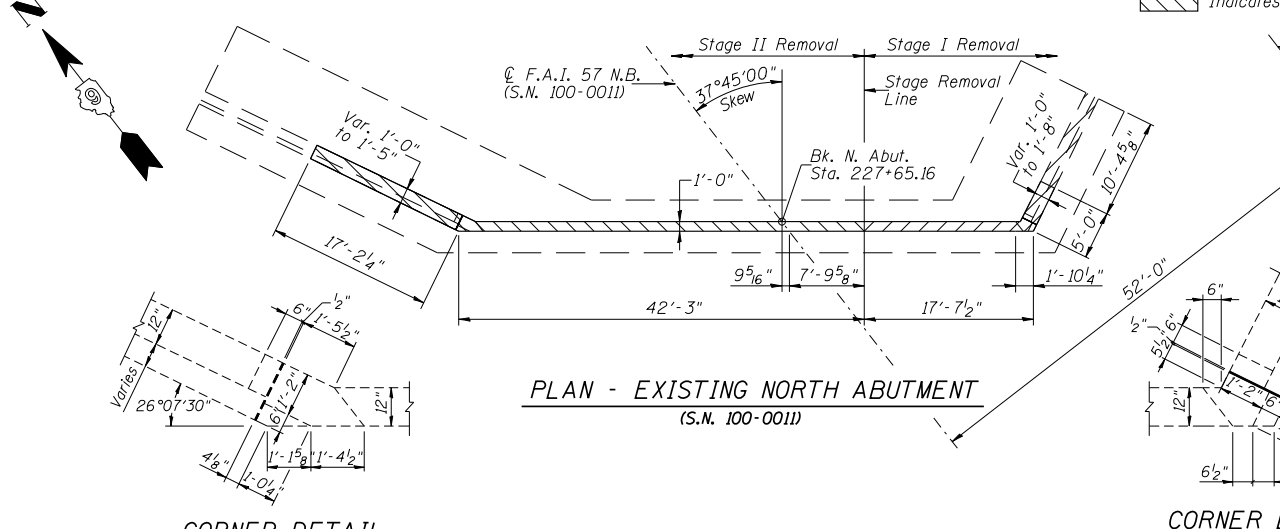
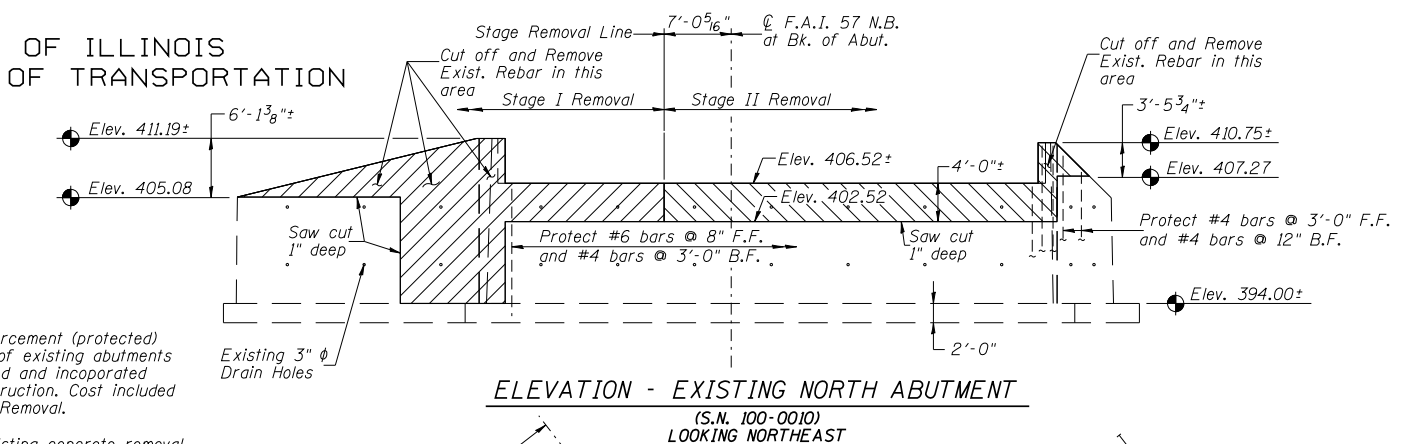
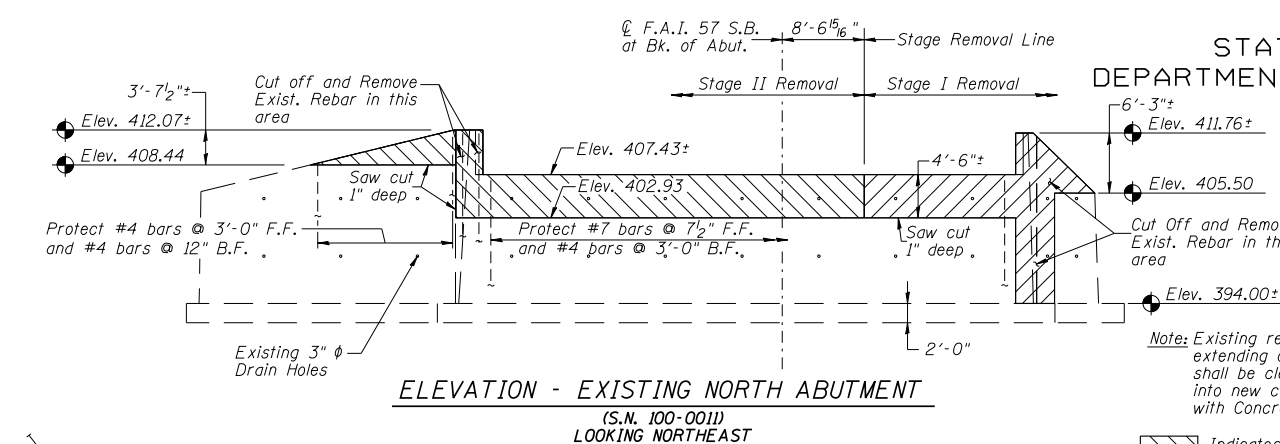

Note: Existing reinforcement (protected) extending out of existing abutments shall be cleaned and incorporated into new construction. Cost included with Concrete Removal.

Indicates existing concrete removal

NOTES:
1. Backfill shall be placed behind the abutment after the Superstructure has been poured and falsework removed. See Article 502.10 of the Standard Specifications.

NORTH ABUTMENT 1
F.A.I. RTE. 57 OVER
LAKE CREEK BRANCH
STATION 228+25.00
STRUCTURE NO. 100-0010 (N.B.)
STRUCTURE NO. 100-0011 (S.B.)

 CRAWFORD MURPHY & TILLY, INC. CONSULTING ENGINEERS SPRINGFIELD, IL ■ AURORA, IL ■ ST. LOUIS, MO ROCKFORD, IL ■ PEORIA, IL ■ CHICAGO, IL DESIGNED BY: DRAWN BY: GLD CHECKED BY: WLB DATE: 4/12/10	SHEET NO. 20	F.A.S. RTE. I-57	SECTION (X1-4-1) BR -1	COUNTY WILLIAMSON	TOTAL SHEETS 202	SHEET NO. 103
	29 SHEETS	CONTRACT NO. 78334		FED. ROAD DIST. NO. 9 ILLINOIS FED. AID PROJECT		