

STATE OF ILLINOIS
DEPARTMENT OF TRANSPORTATION

NORTH ABUTMENT
BILL OF MATERIAL

Bar	No.	Size	Length	Shape
h (E)	18	6	4'-0"	—
h1 (E)	9	6	24'-7"	—
h2 (E)	9	4	24'-5"	—
h3 (E)	5	6	39'-1"	—
h4 (E)	5	4	38'-1"	—
h5 (E)	9	6	24'-5"	—
h6 (E)	9	4	24'-5"	—
h7 (E)	5	6	39'-1"	—
h8 (E)	5	4	39'-1"	—
h9 (E)	2	4	17'-3"	—
h10 (E)	4	4	15'-0"	—
h11 (E)	25	4	33'-8"	—
h12 (E)	10	6	42'-1"	—
h13 (E)	10	4	42'-1"	—
h14 (E)	2	4	21'-10"	—
h15 (E)	6	4	7'-9"	—
h16 (E)	2	4	30'-1"	—
h17 (E)	4	16'-8"	—	—
h18 (E)	16	5	6'-0"	—
h19 (E)	7	4	42'-5"	—
n (E)	95	7	7'-6"	C
n1 (E)	40	6	4'-1"	C
s (E)	8	3	4'-1"	D
t (E)	84	5	5'-2"	—
t1 (E)	41	8	11'-8"	—
t2 (E)	41	6	11'-8"	—
t3 (E)	2	5	11'-8"	—
u (E)	128	4	4'-9"	—
v (E)	161	5	4'-6"	—
v1 (E)	161	5	2'-0"	—
v2 (E)	255	6	7'-2"	—
v3 (E)	86	7	4'-6"	—
v4 (E)	22	4	4'-6"	—
v5 (E)	36	7	13'-2"	—
v6 (E)	13	4	13'-2"	—
v7 (E)	3	7	16'-5"	—
v8 (E)	23	7	6'-1"	—
v9 (E)	91	7	5'-1"	—
v10 (E)	21	4	5'-1"	—
v11 (E)	37	7	13'-5"	—
v12 (E)	13	4	13'-5"	—
v13 (E)	3	7	16'-8"	—
v14 (E)	10	4	16'-8"	—
v15 (E)	41	4	11'-6"	—
v16 (E)	41	6	9'-0"	—
v17 (E)	2	7	7'-8"	—
v18 (E)	2	7	8'-6"	—
w (E)	12	8	5'-0"	—
w1 (E)	12	5	19'-11"	—
w2 (E)	12	5	20'-4"	—
w3 (E)	26	5	33'-7"	—
Porous Granular Embankment (Special)	Cu. Yd.	2544		
Concrete Removal	Cu. Yd.	43.2		
Structure Excavation	Cu. Yd.	1380		
Cofferdam Excavation	Cu. Yd.	1195		
Cofferdam (Ty. 2)	Each	1		
Concrete Structures	Cu. Yd.	122.2		
Reinforcement Bars Epoxy Coated	Pound	19,340		
Bar Splicers	Each	22		
Geocomposite Wall Drain Epoxy Coated	Sq. Yd.	282		
w10 (E)	12	8	5'-0"	—
w11 (E)	12	5	20'-6"	—
w12 (E)	12	5	19'-1"	—
w13 (E)	26	5	10'-7"	—
w14 (E)	26	5	26'-7"	—
Porous Granular Embankment (Special)	Cu. Yd.	2808		
Concrete Removal	Cu. Yd.	43.8		
Structure Excavation	Cu. Yd.	1380		
Cofferdam Excavation	Cu. Yd.	1255		
Cofferdam (Ty. 2)	Each	1		
Concrete Structures	Cu. Yd.	124.4		
Reinforcement Bars Epoxy Coated	Pound	19,880		
Bar Splicers	Each	22		
Geocomposite Wall Drain Epoxy Coated	Sq. Yd.	284		

SOUTH ABUTMENT
BILL OF MATERIAL

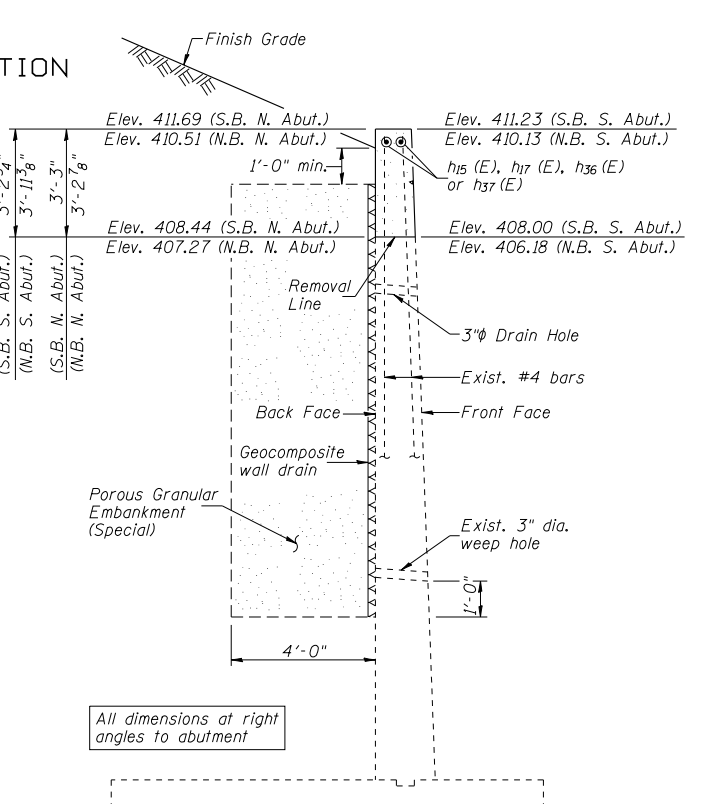
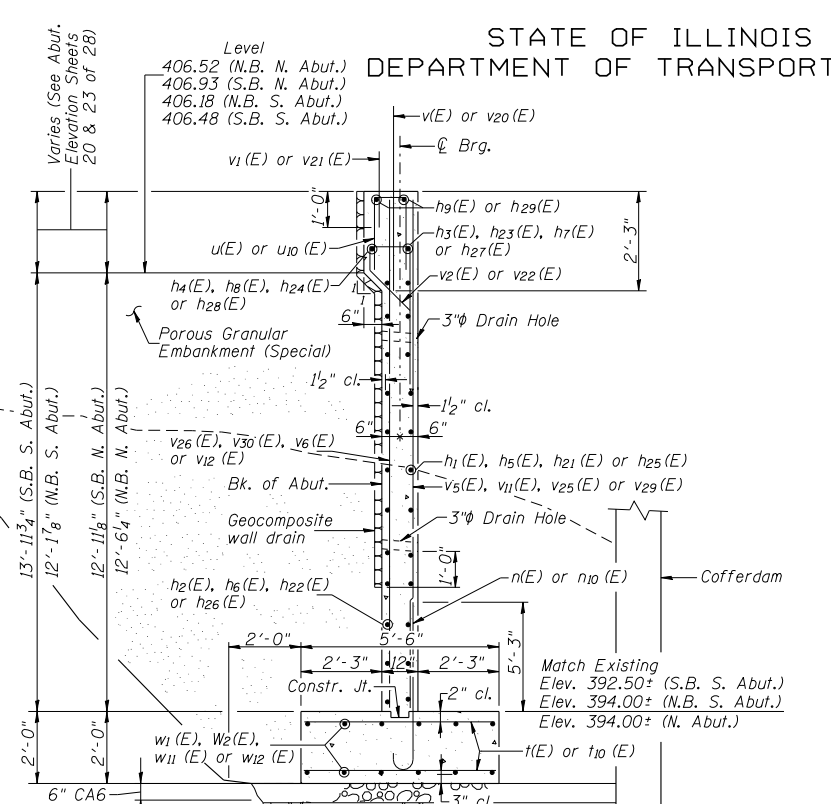
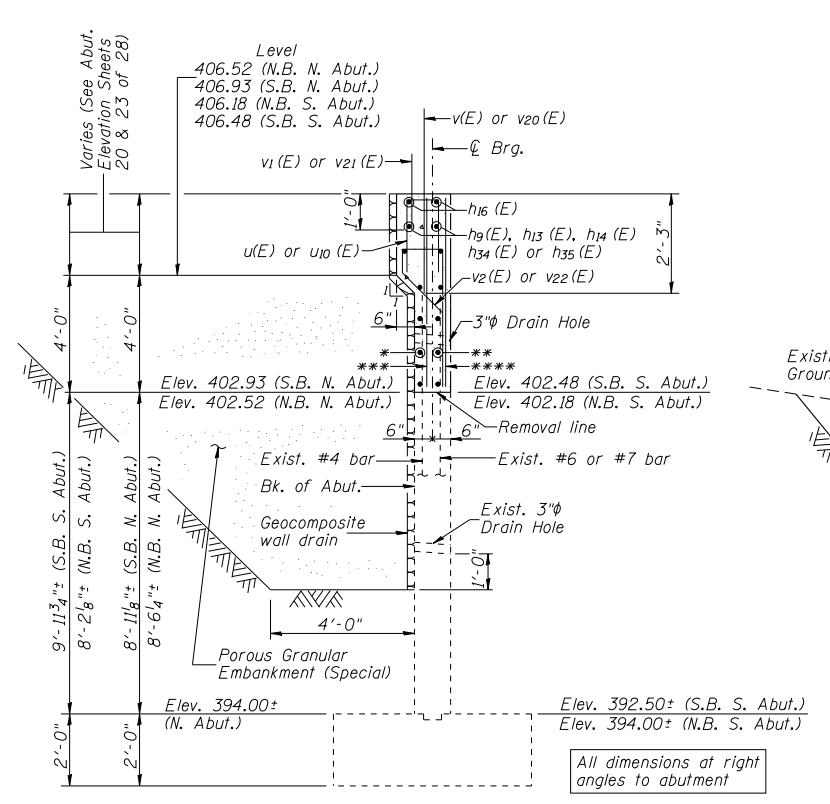

SECTION A-A

SECTION C-C

SECTION E-E

* h24 (E), h28 (E), h34 (E), h4 (E), h8 (E) or h13 (E)
 ** h3 (E), h12 (E), h7 (E), h23 (E), h27 (E) or h33 (E)
 *** v4 (E), v10 (E), v24 (E) or v32 (E)
 **** v3 (E), v9 (E), v23 (E) or v31 (E)

All dimensions at right angles to abutment

All dimensions at right angles to abutment

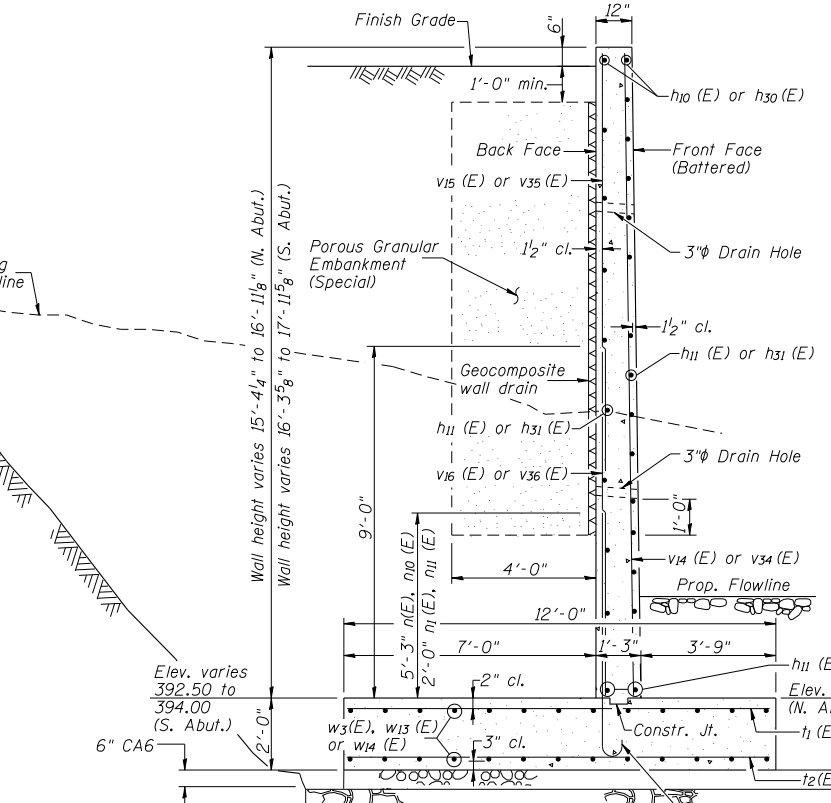
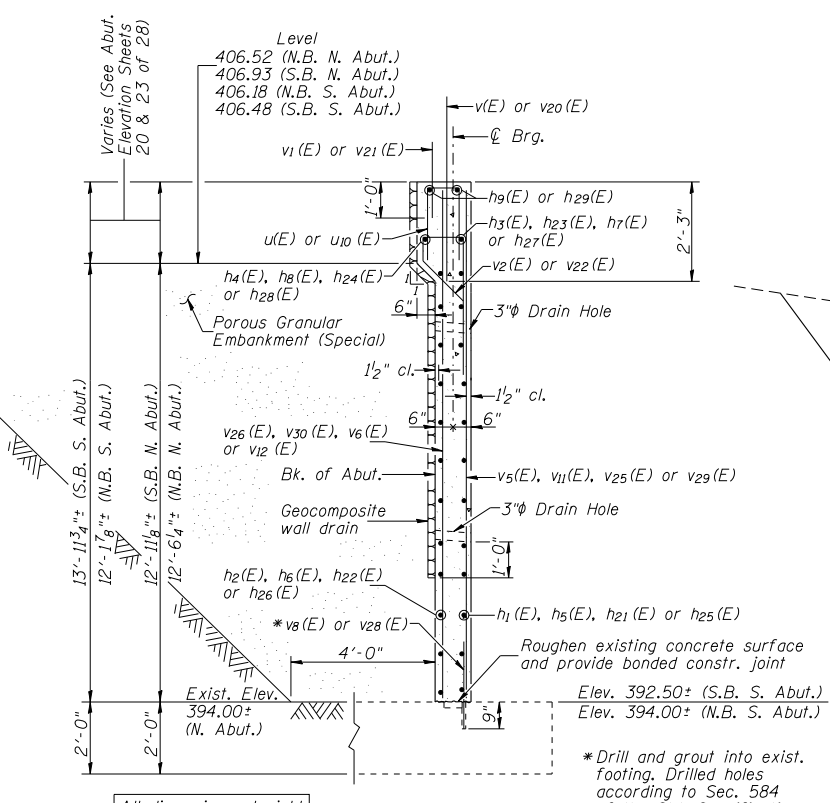

SECTION B-B

SECTION D-D

* Drill and grout into exist. footing. Drilled holes according to Sec. 584 of the Std. Specifications.

All dimensions at right angles to abutment

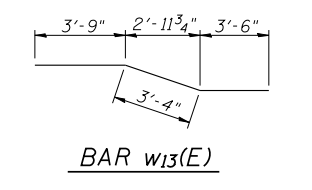
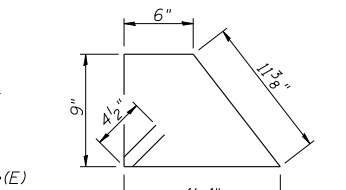
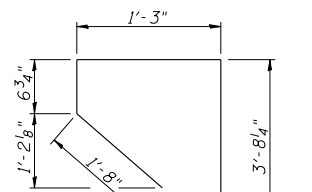
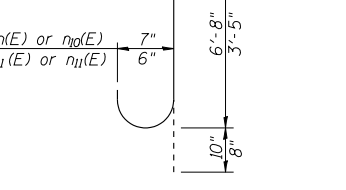
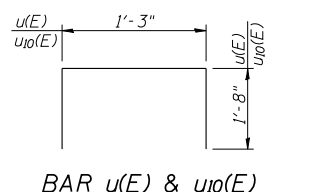
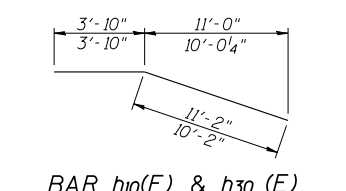

NOTES:
 1. Work this sheet with sheets 21, 22, 24 and 25 of 29.

ABUTMENT DETAILS
 F.A.I. RTE. 57 OVER
 LAKE CREEK BRANCH
 STATION 228+25.00
 STRUCTURE NO. 100-0010 (N.B.)
 STRUCTURE NO. 100-0011 (S.B.)

CMT
 CRAWFORD MURPHY & TILLY, INC.
 CONSULTING ENGINEERS
 SPRINGFIELD, IL ■ AURORA, IL ■ ST. LOUIS, MO
 ROCKFORD, IL ■ PEORIA, IL ■ CHICAGO, IL
 DESIGNED BY: C.WJ
 CHECKED BY: WLB
 DRAWN BY: GLD
 DATE: 4/12/10

SHEET NO. 26 29 SHEETS	F.A.S. RTE.	SECTION	COUNTY	TOTAL SHEETS	SHEET NO.
	I-57	(X1-4-1) BR -1	WILLIAMSON	202	109
FED. ROAD DIST. NO. 9 ILLINOIS			FED. AID PROJECT		
CONTRACT NO. 78334					