

0' 20' 40'
SCALE: 1"=40'-0"

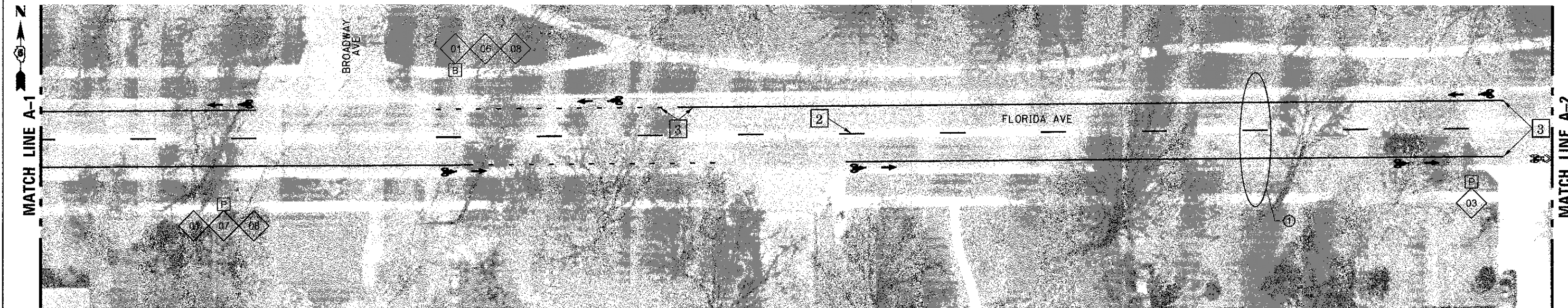

SIGN LEGEND					
01	BIKE ROUTE (D11-1)		06	BIKE ROUTE ARROW RIGHT (M6-1)	
02	BIKE LANE (R3-17)		07	BIKE ROUTE ARROW LEFT (M6-1)	
03	MAY USE FULL LANE (R4-11)		08	BIKE ROUTE ARROW AHEAD (M6-3)	
04	NO PARKING THIS SIDE OF STREET		09	AHEAD (R3-17aP)	
05	BIKE ROUTE ARROW LEFT AND RIGHT (M6-4)		10	ENDS (R3-17bP)	

2 4" SKIP-DASH YELLOW
6 4" DOUBLE YELLOW

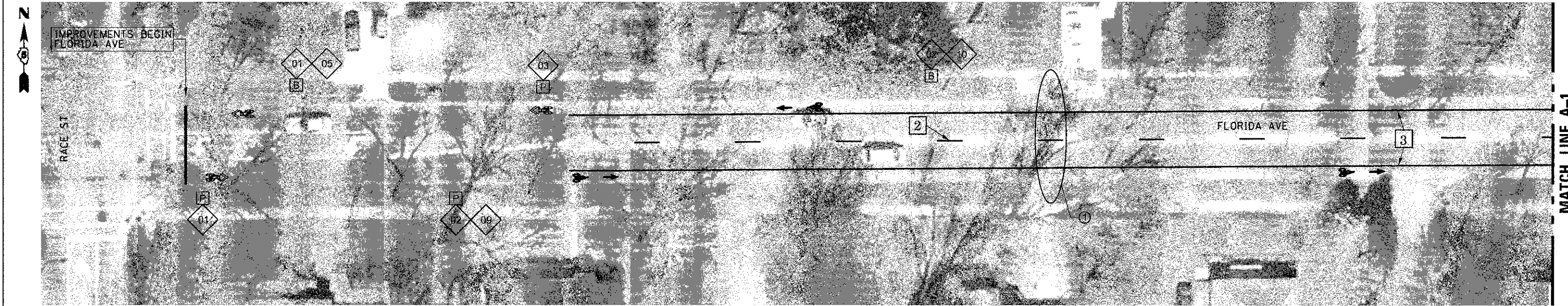
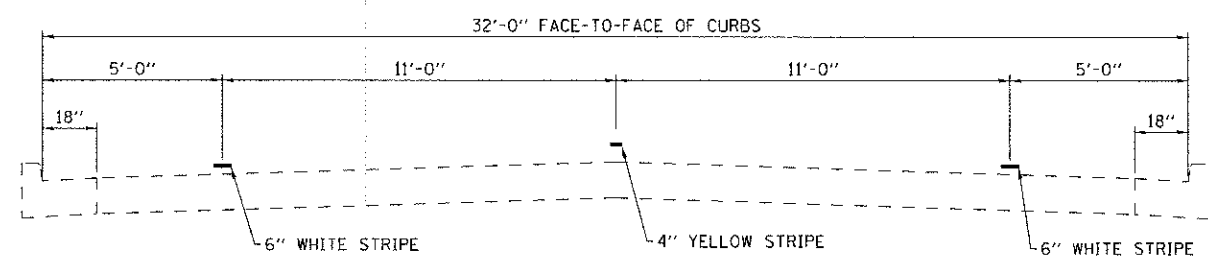
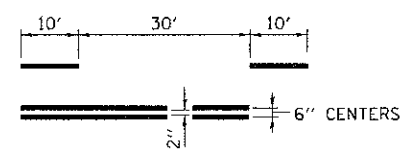

1 TYPICAL FOR PAVEMENT MARKING FLORIDA AVENUE

PAVEMENT MARKING LEGEND	
1	4" WHITE
2	4" YELLOW
3	6" WHITE
4	12" YELLOW
5	12" WHITE
6	4" DOUBLE YELLOW

PRINT DRIVER: I, R. E. D. S. & L.
 PEN: M. A. S. & L.
 FILE NAME: 12-00517-00-ST-01.dwg



USER NAME = has	DESIGNED = JMS	REVISED =
ESCA PROJECT NO. 1020.04	DRAWN = RJT/HAS	REVISED =
PLOT SCALE = 0.0033 / IN.	CHECKED = JMS	REVISED =
PLOT DATE = 1/30/2013 2:02:25 PM	DATE = 01/29/13	REVISED =

STATE OF ILLINOIS
DEPARTMENT OF TRANSPORTATION

FLORIDA AVENUE PAVEMENT MARKING

SCALE AS SHOWN SHEET NO. 1 OF 8 SHEETS STA. TO STA.

F.A. RTE.	SECTION	COUNTY	TOTAL SHEETS	SHEET NO.
VAR	12-00517-00-ST	CHAMPAIGN	22	5
CONTRACT NO. 91482				
FED. ROAD DIST. NO. ILLINOIS/FED. AID PROJECT AID				