

0' 20' 40'
SCALE: 1"=40'-0"

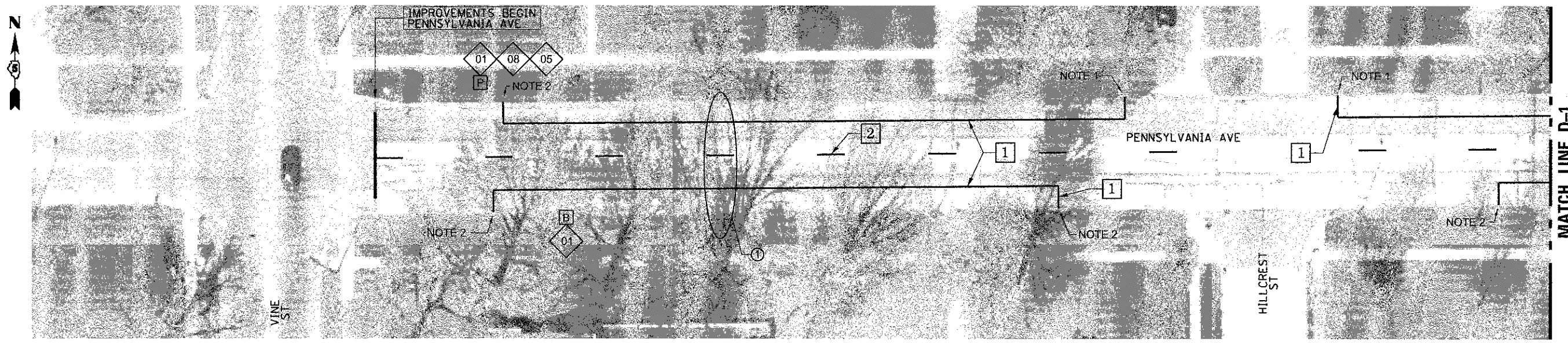

MATCH LINE D-1

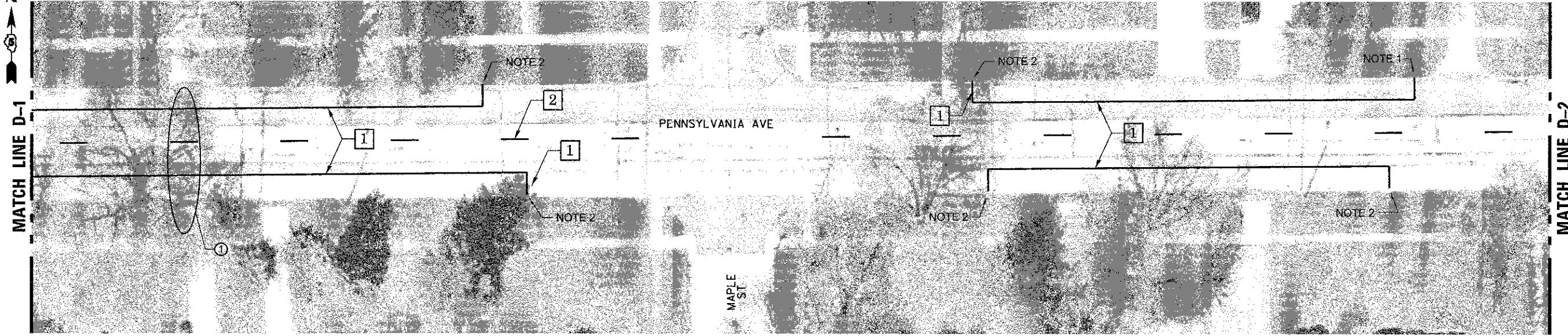

MATCH LINE D-2

NOTE 1: THE 4" WHITE PAVEMENT MARKING LINE TERMINATES AT THE LIMIT OF THE YELLOW PAINTED CURB.
NOTE 2: THE 4" WHITE PAVEMENT MARKING LINE TERMINATES AT THE "NO PARKING HERE TO CORNER" SIGNS.

SIGN LEGEND					
01	BIKE ROUTE (D11-1)		06	BIKE ROUTE ARROW RIGHT (M6-1)	
02	BIKE LANE (R3-17)		07	BIKE ROUTE ARROW LEFT (M6-1)	
03	MAY USE FULL LANE (R4-11)		08	BIKE ROUTE ARROW AHEAD (M6-3)	
04	NO PARKING THIS SIDE OF STREET		09	AHEAD (R3-17aP)	
05	BIKE ROUTE ARROW LEFT AND RIGHT (M6-4)		10	ENDS (R3-17bP)	

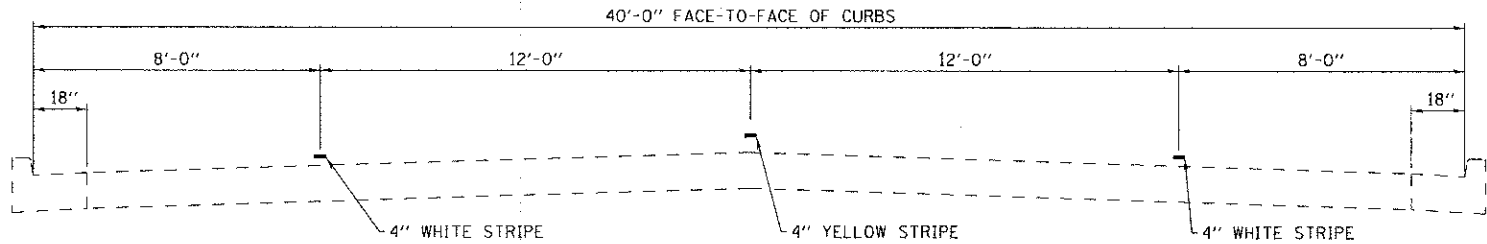

① TYPICAL FOR PAVEMENT MARKING PENNSYLVANIA AVENUE
VINE STREET TO ANDERSON STREET

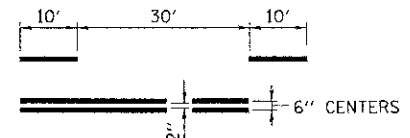

PAVEMENT MARKING LEGEND	
1	4" WHITE
2	4" YELLOW
3	6" WHITE
4	12" YELLOW
5	12" WHITE
6	4" DOUBLE YELLOW

- 2 4" SKIP-DASH YELLOW
- 6 4" DOUBLE YELLOW



USER NAME = has
ESCA PROJECT NO. 1020.04
PLOT SCALE = 0.0033 / IN.
PLOT DATE = 1/30/2013 2:14:24 PM

DESIGNED - JMS
DRAWN - RJT/HAS
CHECKED - JMS
DATE - 01/29/13

REVISED -
REVISED -
REVISED -
REVISED -

STATE OF ILLINOIS
DEPARTMENT OF TRANSPORTATION

PENNSYLVANIA AVENUE PAVEMENT MARKING

SCALE AS SHOWN SHEET NO. 1 OF 2 SHEETS STA. TO STA.

F.A. RTE.	SECTION	COUNTY	TOTAL SHEETS	SHEET NO.
VAR	12-00517-00-ST	CHAMPAIGN	22	19
CONTRACT NO. 91482				
FED. ROAD DIST. NO. ILLINOIS/FED. AID PROJECT AID				