

0' 20' 40'
SCALE: 1"=40'-0"

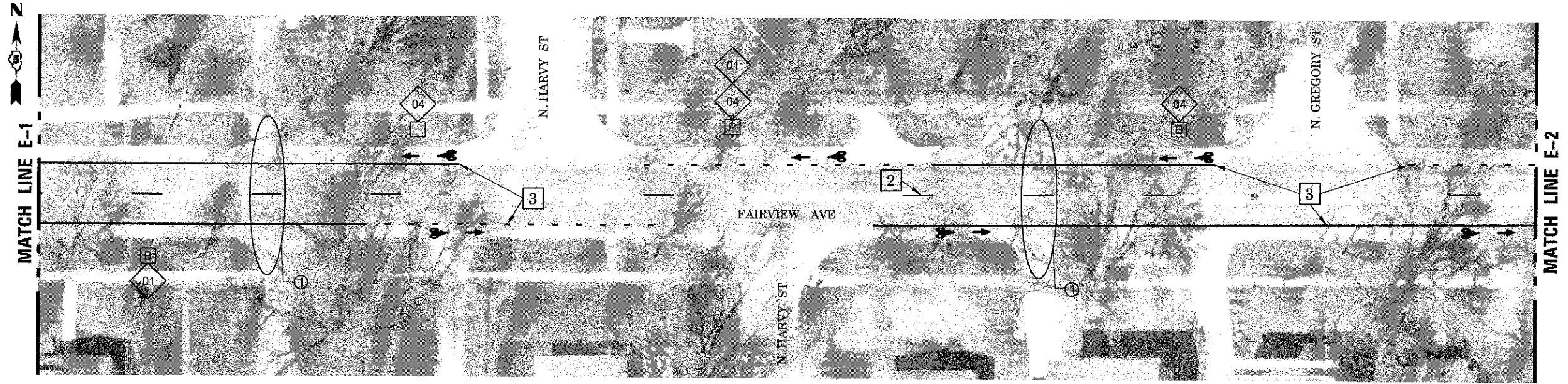

SIGN LEGEND					
01	BIKE ROUTE (D11-1)		06	BIKE ROUTE ARROW RIGHT (M6-1)	
02	BIKE LANE (R3-17)		07	BIKE ROUTE ARROW LEFT (M6-1)	
03	MAY USE FULL LANE (R4-11)		08	BIKE ROUTE ARROW AHEAD (M6-3)	
04	NO PARKING THIS SIDE OF STREET		09	AHEAD (R3-17aP)	
05	BIKE ROUTE ARROW LEFT AND RIGHT (M6-4)		10	ENDS (R3-17bP)	

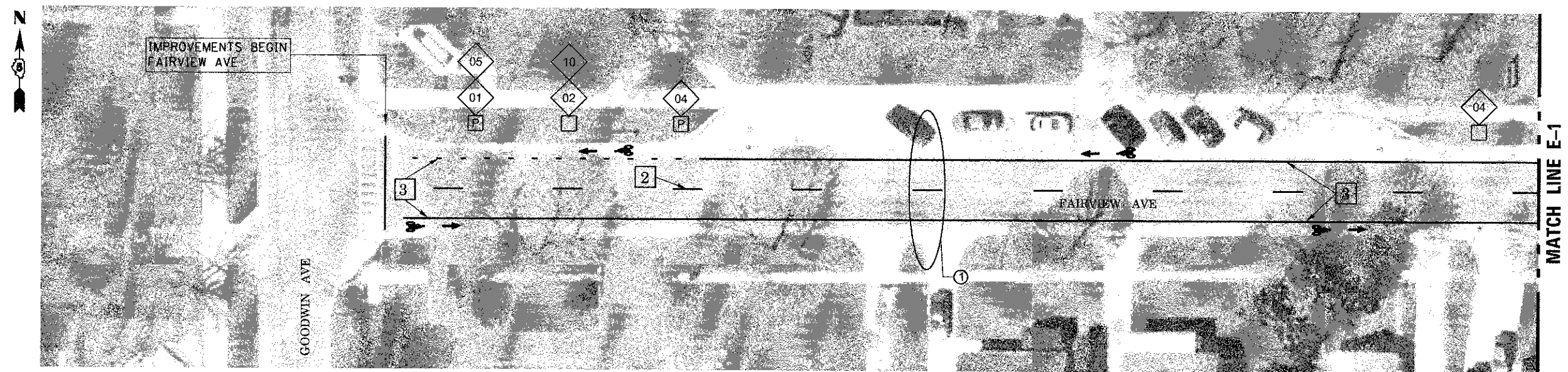
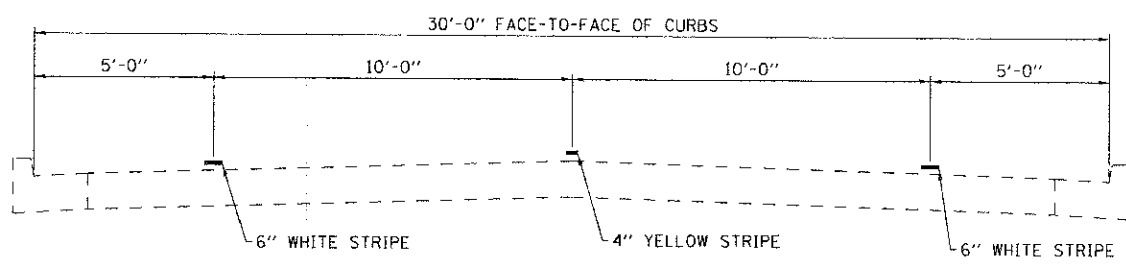

① TYPICAL FOR PAVEMENT MARKING FAIRVIEW AVENUE
GOODWIN AVENUE TO LINCOLN AVENUE

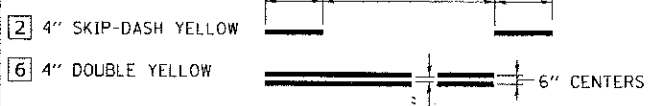

PAVEMENT MARKING LEGEND	
1	4" WHITE
2	4" YELLOW
3	6" WHITE
4	12" YELLOW
5	12" WHITE
6	4" DOUBLE YELLOW

PRINT DRIVER: PLOTTED BY: PLOT DATE: 1/30/2013 2:16:18 PM
 PROJECT NAME: FAIRVIEW AVENUE PAVEMENT MARKING
 FILE NAME: 12-00517-00-ST-01.dwg



USER NAME: jhas	DESIGNED: JMS	REVISED:
ESCA PROJECT NO. 10220.04	DRAWN: RJT/HAS	REVISED:
PLOT SCALE: 0.0833" / IN.	CHECKED: JMS	REVISED:
PLOT DATE: 1/30/2013 2:16:18 PM	DATE: 01/29/13	REVISED:

STATE OF ILLINOIS
DEPARTMENT OF TRANSPORTATION

FAIRVIEW AVENUE PAVEMENT MARKING	
SCALE AS SHOWN	SHEET NO. 1 OF 2 SHEETS
STA.	TO STA.

F.A. RTE. VAR	SECTION 12-00517-00-ST	COUNTY CHAMPAIGN	TOTAL SHEETS 22	SHEET NO. 21
CONTRACT NO. 91482				
FED. ROAD DIST. NO. ILLINOIS FED. AID PROJECT AID				