

DATE	
BY	
SAVED	
PLotted	
TEMPLATE	
AREAS	
CHECKED	
NO.	

DATE	
BY	
SAVED	
PLotted	
TEMPLATE	
AREAS	
CHECKED	
NO.	

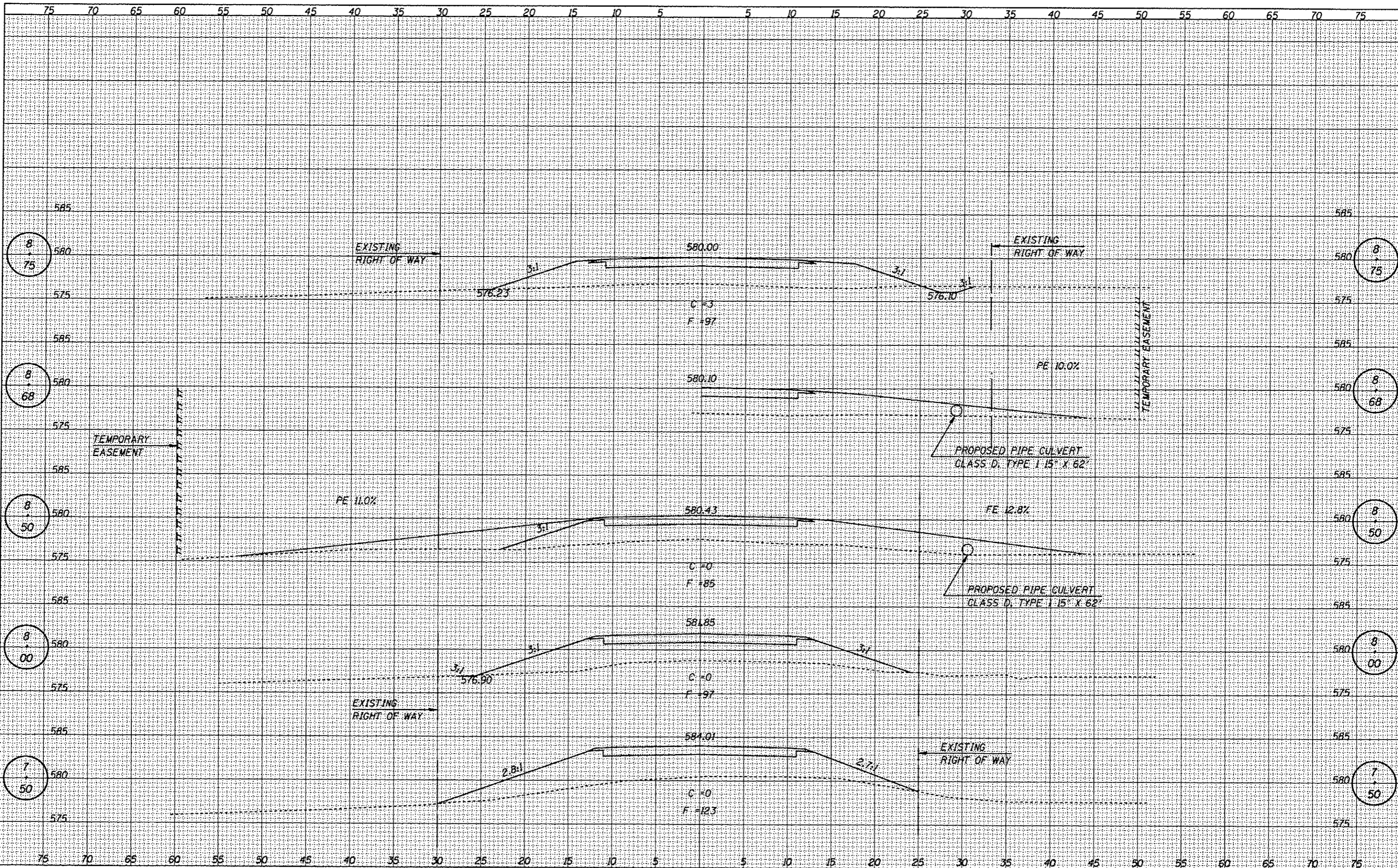

CEC Cummins Engineering Corporation
Civil and Structural Engineering

JOB # 2228
FILE NAME = 2228.dgn
PLOT SCALE = 10,0000 sf / in.
PLOT DATE = 1/3/2013

DESIGNED - NAK
DRAWN - AJH
CHECKED - NAK
DATE - 05/04/2009

REVISED -
REVISED -
REVISED -
REVISED -

**MACOUPIN COUNTY
CH 10 BRIDGE REPLACEMENT**

CROSS SECTIONS - CH 10

SCALE: SHEET NO. OF SHEETS STA. TO STA.

F.A.S. RTE.	SECTION	COUNTY	TOTAL SHEETS	SHEET NO.
CH 10	08-0092-00-BR	MACOUPIN	23	18
FED. ROAD DIST. NO.		ILLINOIS FED. AID PROJECT		CONTRACT NO.
				93595