

F.A.P. RTE.	SECTION	COUNTY	TOTAL SHEETS	SHEET NO.
332	(16,17,18)RS-2	LAWRENCE	40	1
		ILLINOIS	CONTRACT NO. 94977	

STATE OF ILLINOIS
DEPARTMENT OF TRANSPORTATION
DIVISION OF HIGHWAYS

PROPOSED HIGHWAY PLANS

F.A.P. ROUTE 332 (IL. RTE. 1)
SECTION (16,17,18)RS-2
PROJECT NHPP-0332(112)
RESURFACING (3P)
LAWRENCE COUNTY

C-97-025-03

FAP ROUTE 332 (IL RTE 1)
SECTION (16,17,18)RS-2
LAWRENCE COUNTY
ENDS STA. 440+73

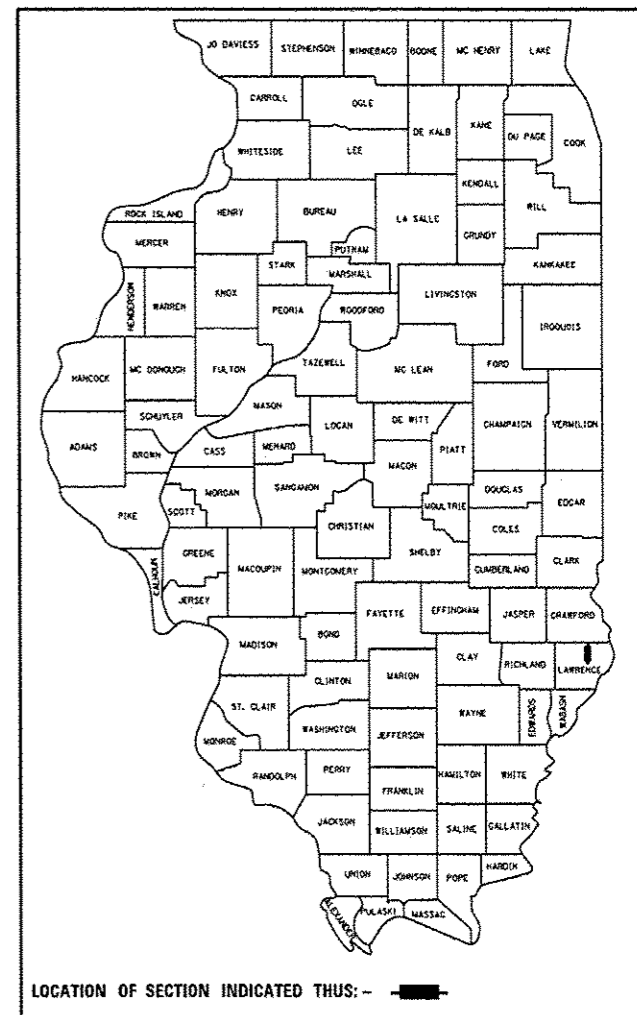

LOCATION OF SECTION INDICATED THUS: —

FAP ROUTE 332 (IL RTE 1)
SECTION (16,17,18)RS-2
LAWRENCE COUNTY
BEGINS STA. 23+85

FOR INDEX OF SHEETS, SEE SHEET NO. 2

STATION EQUATIONS:

- STA. 38+05.46 (BK) = STA. 38+15.72 (AH)
- STA. 64+73.00 (BK) = STA. 57+11.10 (AH)
- STA. 141+92.10 (BK) = STA. 142+10.78 (AH)
- STA. 299+15.58 (BK) = STA. 299+00.44 (AH)

PAVING OMISSIONS:

- STA. 54+73 TO STA. 63+18
- STA. 83+10 TO STA. 86+85
- STA. 253+20 TO STA. 255+40
- STA. 304+28 TO STA. 304+46

ADT = 4,297 (2009)

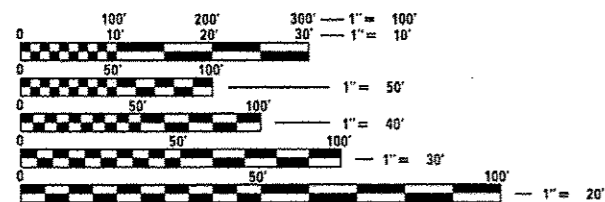

FULL SIZE PLANS HAVE BEEN PREPARED USING STANDARD ENGINEERING SCALES. REDUCED SIZED PLANS WILL NOT CONFORM TO STANDARD SCALES. IN MAKING MEASUREMENTS ON REDUCED PLANS, THE ABOVE SCALES MAY BE USED.

J.U.L.I.E.
JOINT UTILITY LOCATION INFORMATION FOR EXCAVATION
1-800-892-0123
OR 811

PROJECT ENGINEER: TOM RONAN
PROJECT MANAGER: BRETT WALKER
PHONE: (217)-342-8314
CONTRACT NO. 94977

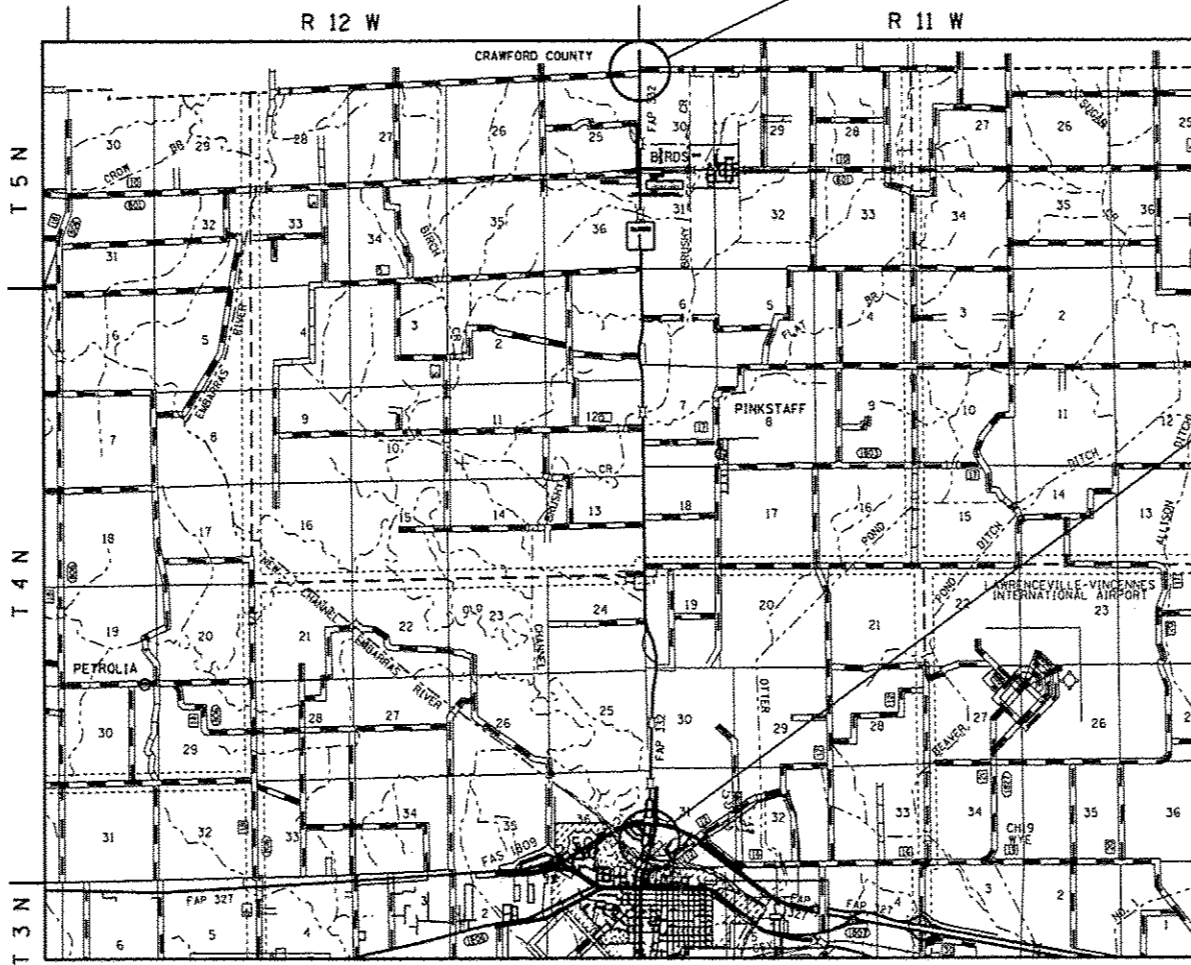

GROSS LENGTH = 42,437 FT. = 8.04 MILES
NET LENGTH = 40,978 FT. = 7.76 MILES

STATE OF ILLINOIS
DEPARTMENT OF TRANSPORTATION
DIVISION OF HIGHWAYS

SUBMITTED Oct 19 20 12
Roger L. Driskell, Inc.
DEPUTY DIRECTOR OF HIGHWAYS, REGION ENGINEER

March 22 20 13
John D. Baramy, P.E. / bc
ENGINEER OF DESIGN AND ENVIRONMENT

March 22 20 13
Omair Osman, P.E. / bc
DIRECTOR OF HIGHWAYS, CHIEF ENGINEER

PRINTED BY THE AUTHORITY
OF THE STATE OF ILLINOIS