

REFLECTIVE MARKER SCHEDULE

Marker	Station	Offset
R1	0+35.79	203.6 LT
R2	0+36.06	125.8 LT
R3	0+35.85	33.2 LT
R4	0+35.77	33.1 RT
R5	0+65.96	27.5 LT
R6	0+65.96	27.5 RT
R7	1+41.67	27.5 LT
R8	1+41.67	27.5 RT
R9	1+74.04	27.5 LT
R10	1+74.04	33.5 RT
R11	1+79.93	65.0 RT
R12	0+36.13	280.9 LT
R13	0+36.22	357.7 LT

THE LOCATION, SIZE AND TYPE OF MATERIAL OF EXISTING UNDERGROUND AND/OR ABOVEGROUND UTILITIES INDICATED ON THE PLANS IS NOT REPRESENTED AS BEING ACCURATE, SUFFICIENT OR COMPLETE. NEITHER THE OWNER NOR THE ENGINEER ASSUMES ANY RESPONSIBILITY WHATSOEVER IN RESPECT TO ACCURACY, COMPLETENESS, OR SUFFICIENCY OF THE INFORMATION. THERE IS NO GUARANTEE EITHER EXPRESSED OR IMPLIED, THAT THE LOCATIONS, SIZE AND TYPE OF MATERIAL OF EXISTING UNDERGROUND UTILITIES INDICATED ARE REPRESENTATIVE OF THOSE TO BE ENCOUNTERED IN THE CONSTRUCTION. IT SHALL BE THE CONTRACTOR'S RESPONSIBILITY TO DETERMINE THE ACTUAL LOCATION OF ALL SUCH FACILITIES, INCLUDING SERVICE CONNECTIONS TO UNDERGROUND UTILITIES. PRIOR TO CONSTRUCTION, THE CONTRACTOR SHALL NOTIFY THE UTILITY COMPANIES OF HIS OPERATIONAL PLANS AND SHALL OBTAIN FROM THE RESPECTIVE UTILITY COMPANIES DETAILED INFORMATION AND ASSISTANCE RELATIVE TO THE LOCATION OF THEIR FACILITIES AND THE WORKING SCHEDULE OF THE COMPANIES FOR REMOVAL OR ADJUSTMENT WHERE REQUIRED. IN THE EVENT AN UNEXPECTED UTILITY INTERFERENCE IS ENCOUNTERED DURING CONSTRUCTION, THE CONTRACTOR SHALL IMMEDIATELY NOTIFY THE UTILITY COMPANY OF JURISDICTION. THE OWNER'S REPRESENTATIVE AND/OR THE RESIDENT ENGINEER SHALL ALSO BE IMMEDIATELY NOTIFIED. ANY DAMAGE TO SUCH MAINS AND SERVICES SHALL BE RESTORED TO SERVICE AT ONCE AND PAID FOR BY THE CONTRACTOR AT NO ADDITIONAL COST TO THE CONTRACT.

ALL UTILITY CABLES AND LINES SHALL BE LOCATED BY THE RESPECTIVE UTILITY. CONTACT JULIE (JOINT UTILITY LOCATION INFORMATION FOR EXCAVATORS) FOR UTILITY INFORMATION, PHONE: 1-800-892-0123. CONTACT THE FAA (FEDERAL AVIATION ADMINISTRATION) FOR ASSISTANCE IN LOCATING FAA CABLES AND UTILITIES. LOCATION OF FAA POWER CONTROL AND COMMUNICATION CABLES SHALL BE COORDINATED WITH AND/OR LOCATED BY THE FAA. CONTACT AIRPORT DIRECTOR/MANAGER AND AIRPORT PERSONNEL FOR ASSISTANCE IN LOCATING UNDERGROUND AIRPORT CABLES AND/OR UTILITIES. ALSO COORDINATE WORK WITH ALL ABOVE GROUND UTILITIES.

LEGEND:

- PROPOSED 1/C #8 5KV FAA L-824 TYPE C CABLE
- PROPOSED REFLECTIVE MARKER
- EXISTING UNDERDRAIN
- EXISTING STORM SEWER
- EXISTING INLET

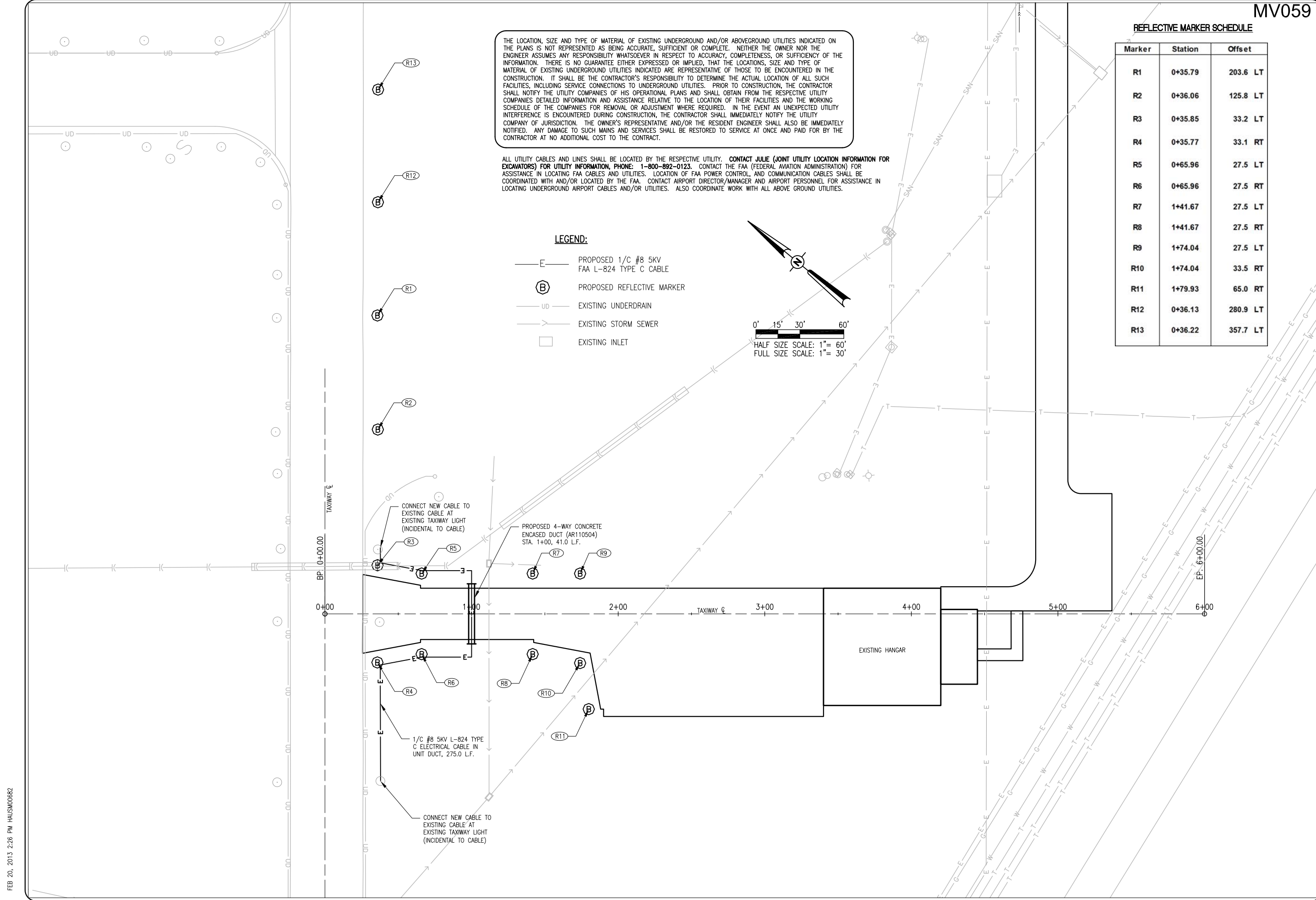
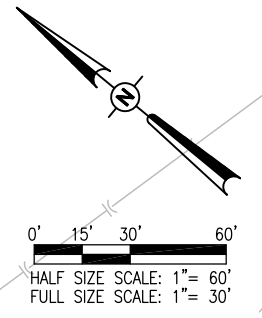

REVISION

DATE

MT. VERNON, ILLINOIS

SBG PROJ.: 3-17-0074-B27

IL PROJ.: MW-4197

Hanson Project No. 12A0044D

Filename 26-E-101-ELEC.DWG

Scale 1:30

Date 3/1/13

LAYOUT 12/14/12

DRAWN KMS 12/18/12

REVIEWED BSS 2/21/13

© Copyright Hanson Professional Services Inc. 2013
Hanson Professional Services Inc.
1525 South Main Street
Springfield, Illinois 62703-2886

CONSTRUCT APRON AND TAXIWAY IN SOUTH FRONTAL AREA

REFLECTIVE MARKER AND ELECTRICAL PLAN

26

26 of 32 sheets