

F.A.P. RTE.	SECTION	COUNTY	TOTAL SHEETS	SHEET NO.
335	2018-0146-I	MCHENRY	24	1
ILLINOIS			CONTRACT NO. 62H76	

04-26-2019 LETTING ITEM 026

STATE OF ILLINOIS  
DEPARTMENT OF TRANSPORTATION

**PROPOSED  
HIGHWAY PLANS**

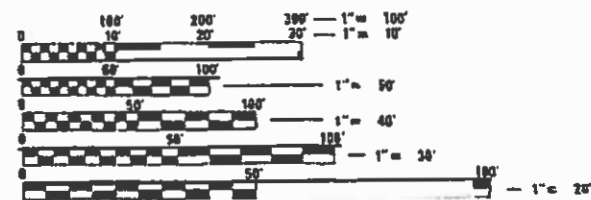
FAP 335 (IL 176)  
E. OF SMITH RD. TO FOX RIVER  
SECTION: 2018-0146-I  
PROJECT: NHPP-SQUM(357)  
ULTRA-THIN BONDED WEARING COURSE  
MCHENRY COUNTY

C-91-317-19

FOR INDEX OF SHEETS, SEE SHEET NO. 2

THIS PROJECT IS LOCATED IN  
THE CITY OF CRYSTAL LAKE AND  
VILLAGE OF PRAIRIE GROVE

TRAFFIC DATA:  
2017 ADT=15,400  
SPEED LIMIT  
=35 TO 50 MPH



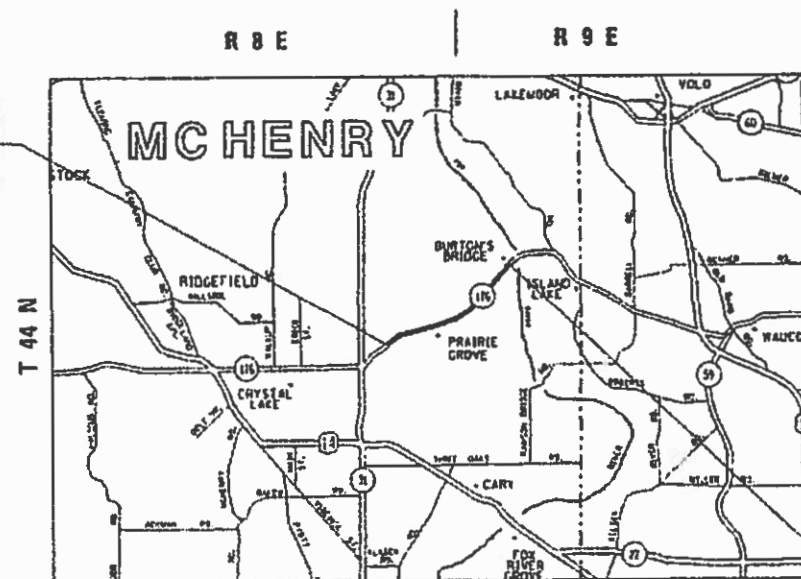
FULL SIZE PLANS HAVE BEEN PREPARED USING STANDARD  
ENGINEERING SCALES. REDUCED SIZED PLANS WILL NOT  
CONFORM TO STANDARD SCALES. IN MAKING MEASUREMENTS  
ON REDUCED PLANS, THE ABOVE SCALES MAY BE USED.

J.U.L.I.E.  
JOINT UTILITY LOCATION INFORMATION FOR EXCAVATION  
1-800-882-0123  
OR 811

PROJECT ENGINEER: DANIEL WILGREEN (847) 705-4240  
PROJECT MANAGER: FAWAD AQUEEL (847) 705-4247

CONTRACT NO. 62H76

PROJECT BEGINS  
STA 23+24.06



PROJECT ENDS  
STA 185+59.06

GROSS & NET LENGTH = 16,235 FOOT = 3.075 MILES

STATE OF ILLINOIS  
DEPARTMENT OF TRANSPORTATION

SUBMITTED January 24, 2019

*Anthony J. Prunty* / CAB  
REGIONAL ENGINEER

March 22, 2019

*Paul P. Chif*  
ENGINEER OF DESIGN AND ENVIRONMENT

March 22, 2019

*Paul P. Chif*  
DIRECTOR OF HIGHWAYS PROJECT IMPLEMENTATION

PRINTED BY THE AUTHORITY  
OF THE STATE OF ILLINOIS

**INDEX OF SHEETS**

**STATE STANDARDS**

**GENERAL NOTES**

SHEET NO.	DESCRIPTION
1	COVER SHEET
2	INDEX OF SHEETS, STATE STANDARDS, AND GENERAL NOTES
3-4	SUMMARY OF QUANTITIES
5-8	EXISTING AND PROPOSED TYPICAL SECTIONS
9-14	ROADWAY AND PAVEMENT MARKING PLAN
15	DETAILS FOR FRAMES AND LIDS ADJUSTMENT WITH MILLING (BD-8)
16	PAVEMENT PATCHING FOR HMA SURFACED PAVEMENT (BD-22)
17	CURB OR CURB AND GUTTER REMOVAL AND REPLACEMENT (BD-24)
18	BUTT JOINT AND HMA TAPER DETAILS
19	TRAFFIC CONTROL AND PROTECTION FOR SIDE ROADS, INTERSECTIONS, AND DRIVEWAYS (TC-10)
20	TYPICAL APPLICATIONS - RAISED REFLECTIVE PAVEMENT MARKERS (SNOW-PLOW RESISTANT) (TC-11)
21	DISTRICT ONE TYPICAL PAVEMENT MARKINGS (TC-13)
22	TRAFFIC CONTROL AND PROTECTION AT TURN BAYS (TO REMAIN OPEN TO TRAFFIC) (TC-14)
23	SHORT TERM PAVEMENT MARKING LETTERS AND SYMBOLS (TC-16)
24	ARTERIAL ROAD INFORMATION SIGN (TC-22)

STANDARD NO.	DESCRIPTION
000001-07	TYPICAL SYMBOLS, ABBREVIATIONS AND PATTERNS
442201-03	CLASS C AND D PATCHES
604001-04	FRAME AND LIDS, TYPE 1
606001-07	CONCRETE CURB TYPE B AND COMBINATION CONCRETE CURB AND GUTTER
630001-12	STEEL PLATE BEAM GUARDRAIL
630201-07	PCC BITSTB @ STEEL PLATE BEAM GRDRAIL
630301-09	SHOULDER WIDENING FOR TYPE 1 (SPECIAL) GUARDRAIL TERMINAL
701011-04	OFF-RD MOVING OPERATIONS, 2L, 2W, DAY ONLY
701301-04	LANE CLOSURE, 2L, 2W, SHORT TME OPERATIONS
701306-04	LANE CLOSURE, 2L, 2W, SLOW MOVING OPERATION - DAY ONLY
701311-03	LANE CLOSURE, 2L, 2W, MOVING OPERATIONS - DAY ONLY
701336-07	LANE CLOSURE, 2L, 2W, WORK AREA IN SERIES - 45 MPH OR MORE
701501-06	URBAN LANE CLOSURE, 2L, 2W, UNDIVIDED
701502-09	URBAN LANE CLOSURE, 2L, 2W, WITH BIDIRECTIONAL LEFT TURN LANE
701701-10	URBAN LANE CLOSURE, MULTILANE INTERSECTION
701901-08	TRAFFIC CONTROL DEVICES
725001-01	OBJECT AND TERMINAL MARKER
780001-05	TYPICAL PAVEMENT MARKINGS
782006	GUARDRAIL AND BARRIER WALL REFLECTOR MOUNTING DETAIL

- BEFORE STARTING ANY EXCAVATION, THE CONTRACTOR SHALL CALL "JULIE" AT (800) 892-0123 OR 811 FOR FIELD LOCATIONS OF BURIED ELECTRIC, TELEPHONE, AND GAS FACILITIES. (48 HOUR NOTIFICATION REQUIRED)
- THE CONTRACTOR SHALL COORDINATE CONSTRUCTION ACTIVITIES WITH UTILITY COMPANIES AND THE CITY OF CRYSTAL LAKE AND VILLAGE OF PRAIRIE GROVE.
- THE CONTRACTOR WILL NOT BE ALLOWED TO SET UP A YARD OR FIELD OFFICE ON STATE PROPERTY WITHOUT THE WRITTEN PERMISSION OF THE DEPARTMENT.
- BEFORE BEGINNING ANY WORK, THE CONTRACTOR SHALL RETAIN AND RECORD FOR FUTURE REFERENCE, ALL EXISTING PAVEMENT MARKING LINES (AND RAISED REFLECTIVE PAVEMENT MARKERS) IN ORDER THAT THESE LOCATIONS CAN BE RE-ESTABLISHED FOR STRIPING. EXACT LOCATIONS OF ALL PAVEMENT MARKINGS SHALL BE AS DIRECTED BY THE ENGINEER.
- THE CONTRACTOR SHALL CONTACT DISTRICT ONE ARTERIAL TRAFFIC CONTROL SUPERVISOR AT KALPANA.KANNAN-HOSADURGA@ILLINOIS.GOV A MINIMUM OF 72 HOURS IN ADVANCE OF BEGINNING WORK.
- THE RESIDENT ENGINEER SHALL CONTACT WALTER CZARNY, ARTERIAL TRAFFIC FIELD ENGINEER VIA EMAIL AT WALTER.CZARNY@ILLINOIS.GOV. A MINIMUM OF TWO (2) WEEKS PRIOR TO THE PLACEMENT OF PERMANENT PAVEMENT MARKINGS.
- FRAMES AND GRATES ADJUSTMENT OF PRIVATE UTILITIES WITHIN THE LIMITS OF THE IMPROVEMENTS SHALL BE DONE BY THEIR RESPECTIVE OWNERS AND ARE NOT PART OF THIS CONTRACT.
- IT SHALL BE THE CONTRACTOR'S RESPONSIBILITY TO VERIFY ALL DIMENSIONS AND CONDITIONS EXISTING IN THE FIELD PRIOR TO CONSTRUCTION AND ORDERING OF MATERIALS.
- ALL DAMAGE TO EXISTING PAVEMENT MARKINGS OR RAISED REFLECTIVE PAVEMENT MARKERS OUTSIDE THE REMOVAL LINE SHOWN ON THE PLANS SHALL BE REPLACED AT THE CONTRACTOR'S EXPENSE.
- ALL PAVEMENT PATCHING, CURB AND GUTTER REMOVAL AND REPLACEMENT, DRAINAGE ADJUSTMENT LOCATIONS WILL BE DETERMINED IN THE FIELD BY THE ENGINEER.
- THE CONTRACTOR SHALL BE REQUIRED TO PROVIDE ACCESS TO ABUTTING PROPERTY AT ALL TIMES DURING THE CONSTRUCTION OF THIS PROJECT.
- DO NOT SCALE PLANS FOR CONSTRUCTION DIMENSIONS.
- TEN (10) FOOT TRANSITIONS SHALL BE USED TO MATCH PROPOSED CURB AND GUTTER AND MEDIAN ITEMS OF WORK TO EXISTING CURBS AND GUTTER AND MEDIANS IN THE FIELD, UNLESS OTHERWISE SHOWN. THE TRANSITIONS SHALL BE PAID FOR AT THE CONTRACT UNIT PRICE FOR THE PROPOSED ITEMS OF WORK SPECIFIED.
- WHEN MILLED PAVEMENT IS OPEN TO TRAFFIC, THE MAXIMUM GRADE DIFFERENTIAL BETWEEN PASSES OF THE MILLING MACHINE SHALL NOT EXCEED 1 1/2 INCHES WHERE THE SPEED LIMIT IS 45 MPH OR LESS, AND 1 INCH WHERE THE SPEED LIMIT IS OVER 45 MPH. WITH WRITTEN APPROVAL FROM THE RESIDENT ENGINEER, A MAXIMUM GRADE DIFFERENTIAL OF 3 INCHES MAY BE ALLOWED IF THE EDGE OF THE MILLING IS SLOPED A MINIMUM OF 1:3 (V:H).
- DOUBLE LANE MARKERS ARE TO BE USED AS SHOWN ON THE DISTRICT ONE DETAIL "TYPICAL APPLICATIONS - RAISED REFLECTIVE PAVEMENT MARKERS (SNOW-PLOW RESISTANT)" SHOWN IN THE PLANS.
- PAVEMENT MARKING TAPE, TYPE III SHALL BE USED FOR SHORT TERM PAVEMENT MARKINGS ON ALL FINAL SURFACES.
- BUTT JOINTS WILL BE INSTALLED AT THE ENDS OF RESURFACING (WHERE RESURFACING MEETS EXISTING PAVEMENT) IN ACCORDANCE WITH THE "BUTT JOINT AND HMA TAPER DETAILS" SHEET INCLUDED IN THE PLANS, UNLESS OTHERWISE SPECIFIED.
- UNLESS OTHER CONDITIONS WARRANT EXTENDED LANE CLOSURE AS DETERMINED AND APPROVED IN WRITING BY THE ENGINEER OR AS PROVIDED FOR IN THE CONTRACT SPECIFICATIONS, OVERNIGHT CLOSURES SHALL NOT BE ALLOWED FOR REHABILITATION PROJECTS INVOLVING DAYTIME MILLING AND RESURFACING OPERATIONS AND CLASS D PATCHING.
- EXISTING BROKEN FRAMES AND LIDS SHALL BE REMOVED AND DISPOSED OF BY THE CONTRACTOR AND SHALL BE REPLACED AS DIRECTED BY THE ENGINEER. REPLACEMENT FRAMES AND LIDS WILL BE PAID FOR ACCORDING TO ARTICLE 109.04 OF THE STANDARD SPECIFICATIONS UNLESS A SEPARATE PAY ITEM HAS BEEN PROVIDED.

FILE NAME =	USER NAME = nafakhaj	DESIGNED -	REVISED - AJN 3/15/2019	<b>STATE OF ILLINOIS DEPARTMENT OF TRANSPORTATION</b>	<b>INDEX OF SHEETS, STATE STANDARDS, &amp; GENERAL NOTES IL. ROUTE 176 (SMITH ROAD TO FOX RIVER)</b>	F.A.P. RTE.	SECTION	COUNTY	TOTAL SHEETS	SHEET NO.
pw:\planroom.dot.illinois.gov\PIDOT\Documents\IDOT Offices\District 1\Projects\0111219\0111219\Design\MOTIF	ORAWN	CHECKED -	REVISED -			335	2018-0146-1	MCHENRY	24	2
Default	PLOT SCALE = 100.0000' / in.	DATE -	REVISED -			CONTRACT NO. 62H76				
	PLOT DATE = 3/15/2019					ILLINOIS FED. AID PROJECT				

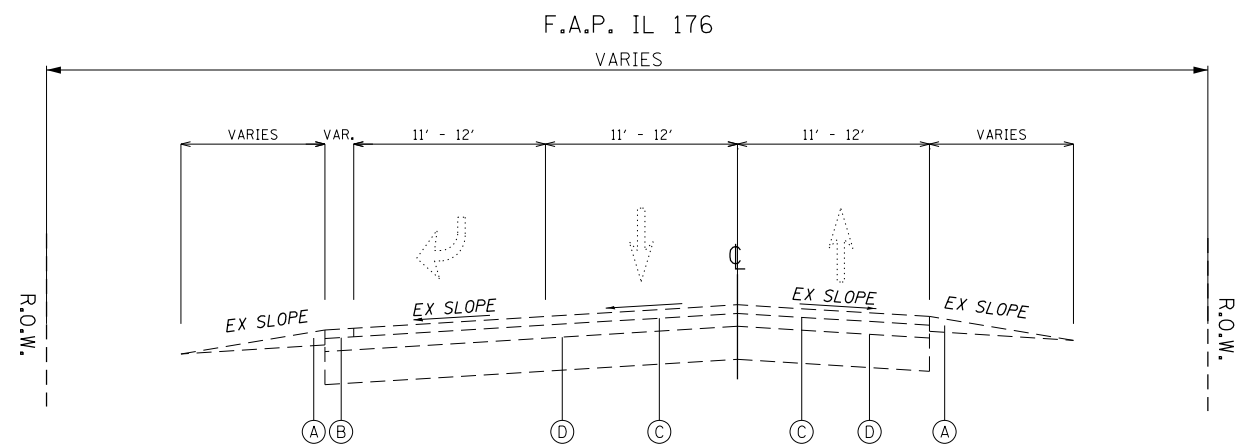
SUMMARY OF QUANTITIES			URBAN TOTAL QUANTITIES	CONSTRUCTION TYPE CODE				
CODE NO	ITEM	UNIT		80% FED 20% STATE 0005				
40600250	RAPID SETTING POLYMER MODIFIED EMULSION	POUND	93261	93261				
21101615	TOPSOIL FURNISH AND PLACE, 4"	SQ YD	17	17				
25200110	SODDING, SALT TOLERANT	SQ YD	17	17				
40600982	HOT-MIX ASPHALT SURFACE REMOVAL - BUTT JOINT	SO YD	1958	1958				
40601005	HOT-MIX ASPHALT REPLACEMENT OVER PATCHES	TON	182	182				
44002222	HOT-MIX ASPHALT REMOVAL OVER PATCHES, 5 1/2"	SQ YD	590	590				
44201749	CLASS D PATCHES, TYPE I, 9 INCH	SQ YD	30	30				
44201753	CLASS D PATCHES, TYPE II, 9 INCH	SQ YD	400	400				
44201757	CLASS D PATCHES, TYPE III, 9 INCH	SQ YD	100	100				
44201759	CLASS D PATCHES, TYPE IV, 9 INCH	SQ YD	60	60				
48102100	AGGREGATE WEDGE SHOULDER, TYPE B	TON	588	588				
* 63100167	TRAFFIC BARRIER TERMINAL, TYPE 1 (SPECIAL) TANGENT	EACH	2	2				
63200310	GUARDRAIL REMOVAL	FOOT	100	100				
67000400	ENGINEER'S FIELD OFFICE, TYPE A	CAL MO	6	6				
67100100	MOBILIZATION	L SUM	1	1				
70100460	TRAFFIC CONTROL AND PROTECTION, STANDARD 701306	L SUM	1	1				

SUMMARY OF QUANTITIES			URBAN TOTAL QUANTITIES	CONSTRUCTION TYPE CODE				
CODE NO	ITEM	UNIT		80% FED 20% STATE 0005				
70100600	TRAFFIC CONTROL AND PROTECTION, STANDARD 701336	L SUM	1	1				
70102622	TRAFFIC CONTROL AND PROTECTION, STANDARD 701502	L SUM	1	1				
70102635	TRAFFIC CONTROL AND PROTECTION, STANDARD 701701	L SUM	1	1				
70300210	TEMPORARY PAVEMENT MARKING LETTERS AND SYMBOLS	SO FT	546	546				
70300220	TEMPORARY PAVEMENT MARKING - LINE 4"	FOOT	64365	64365				
70300240	TEMPORARY PAVEMENT MARKING - LINE 6"	FOOT	2027	2027				
70300250	TEMPORARY PAVEMENT MARKING - LINE 8"	FOOT	617	617				
70300260	TEMPORARY PAVEMENT MARKING - LINE 12"	FOOT	667	667				
70300280	TEMPORARY PAVEMENT MARKING - LINE 24"	FOOT	245	245				
70300520	PAVEMENT MARKING TAPE, TYPE III 4"	FOOT	14923	14923				
* 72501000	TERMINAL MARKER - DIRECT APPLIED	EACH	2	2				
78000100	THERMOPLASTIC PAVEMENT MARKING - LETTERS AND SYMBOLS	SQ FT	546	546				
* 78000200	THERMOPLASTIC PAVEMENT MARKING - LINE 4"	FOOT	64365	64365				
* 78000400	THERMOPLASTIC PAVEMENT MARKING - LINE 6"	FOOT	2027	2027				
* *	SPECIALTY ITEM							

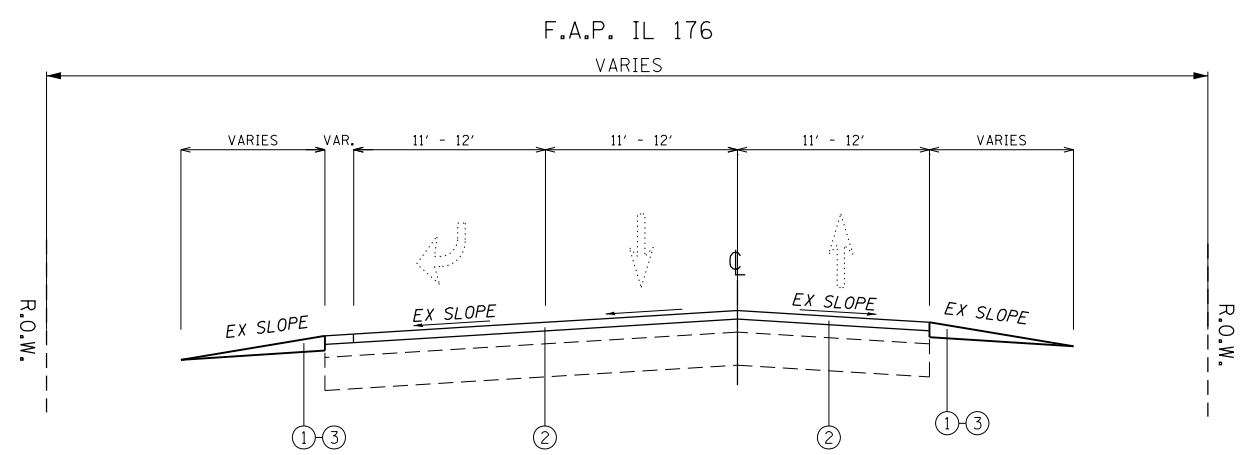
FILE NAME =	USER NAME = nafakha	DESIGNED -	REVISED -	<b>STATE OF ILLINOIS DEPARTMENT OF TRANSPORTATION</b>	<b>SUMMARY OF QUANTITIES</b>			F.A.P. RTE.	SECTION	COUNTY	TOTAL SHEETS	SHEET NO.
pw:\N\LOB\AE\BID\INT\EG\Illinois.gov\FWIDOT\Documents\DOT	Offices\District\Projects\DI11219\CADData\Desigr\MOTIF	DRAWN -	REVISED -					335	2018-0146-1	MCHENRY	24	3
	PLOT SCALE = 100,0000' / 1in	CHECKED -	REVISED -					CONTRACT NO. 62H76				
	PLOT DATE = 2/11/2019	DATE -	REVISED -					FED. ROAD DIST. NO. 1 ILLINOIS FED. AID PROJECT				

SUMMARY OF QUANTITIES			URBAN TOTAL QUANTITIES	CONSTRUCTION TYPE CODE					
CODE NO	ITEM	UNIT		80% FED 20% STATE 0005					
* 78000500	THERMOPLASTIC PAVEMENT MARKING - LINE 8"	FOOT	618	618					
* 78000600	THERMOPLASTIC PAVEMENT MARKING - LINE 12"	FOOT	667	667					
* 78000650	THERMOPLASTIC PAVEMENT MARKING - LINE 24"	FOOT	245	245					
* 78100100	RAISED REFLECTIVE PAVEMENT MARKER	EACH	718	718					
* 78200005	GUARDRAIL REFLECTORS, TYPE A	EACH	4	4					
78300200	RAISED REFLECTIVE PAVEMENT MARKER REMOVAL	EACH	488	488					
88600600	DETECTOR LOOP REPLACEMENT	FOOT	300	300					
X0326129	ULTRA-THIN HOT-MIX ASPHALT SURFACE COURSE	SO YD	54539	54539					
X2020110	GRADING AND SHAPING SHOULDERS	UNIT	235	235					
X4401198	HOT-MIX ASPHALT SURFACE REMOVAL, VARIABLE DEPTH	SQ YD	366	366					
X6030310	FRAMES AND LIDS TO BE ADJUSTED (SPECIAL)	EACH	3	3					
X7030005	TEMPORARY PAVEMENT MARKING REMOVAL	SO FT	29557	29557					
Z0004562	COMBINATION CONCRETE CURB AND GUTTER REMOVAL AND REPLACEMENT	FOOT	100	100					
* Z0018500	DRAINAGE STRUCTURES TO BE CLEANED	EACH	6	6					

SUMMARY OF QUANTITIES			URBAN TOTAL QUANTITIES	CONSTRUCTION TYPE CODE					
CODE NO	ITEM	UNIT		80% FED 20% STATE 0005					
Z0030850	TEMPORARY INFORMATION SIGNING	SO FT	52	52					
Z0034105	MATERIAL TRANSFER DEVICE	TON	2455	2455					
* *	SPECIALTY ITEM * 100% STATE								



**EXISTING TYPICAL SECTION**  
 STA 27+50 TO STA 38+20  
 STA 116+65 TO STA 118+60



**PROPOSED TYPICAL SECTION**  
 STA 27+50 TO STA 38+20  
 STA 116+65 TO STA 118+60

- LEGEND - EXISTING:**
- (A) EXISTING AGGREGATE SHOULDER, (VARIES)
  - (B) EXISTING H.M.A. SHOULDER, (VARIES)
  - (C) EXISTING H.M.A. SURFACE COURSE, 5 1/2" (±)
  - (D) EXISTING PCC BASE COURSE, 9" (±)

- LEGEND - PROPOSED**
- ① GRADING AND SHAPING SHOULDERS
  - ② ULTRA-THIN HMA SURFACE COURSE, MIX E, TYPE C, 90 LB/SQ YD
  - ③ AGGREGATE SHOULDERS, TYPE B
- 1 THE CONTRACTOR SHALL PATCH FIRST.

- NOTE 1: THE UNIT WEIGHT USED TO CALCULATE ALL HMA SURFACE MIXTURE QUANTITIES IS 112 LBS/SQ YD/IN.
- NOTE 2: THE "AC TYPE" FOR POLYMERIZED HMA MIXES SHALL BE "SBS/SBR PG 76-22" AND FOR NON-POLYMERIZED HMA THE "AC TYPE" SHALL BE "PG 64-22" UNLESS MODIFIED BY DISTRICT ONE SPECIAL PROVISIONS. FOR USE OF RECYCLED MATERIALS SEE SPECIAL PROVISIONS.
- NOTE 3: QUALITY MANAGEMENT PROGRAM (OMP) IDENTIFIES THE PARTICULAR QUALITY CONTROL SPECIFICATION THAT APPLIES TO THE HMA MIXTURE.
- NOTE 4: PATCH BEFORE RESURFACING
- NOTE 5: SEE ULTRA THIN BONDED WEARING COURSE SPECIAL PROVISION FOR ULTRA THIN HMA SURFACE COURSE, MIX E, TYPE C MIX SPECIFICATION.

HOT-MIX ASPHALT MIXTURE REQUIREMENTS		QUALITY MANAGEMENT PROGRAM (OMP)
MIXTURE TYPE	AIR VOIDS e <sub>Ndes</sub>	
<b>PATCHING</b>		
CLASS D PATCHES (HMA BINDER IL-19 mm)	4% AT 70 GYR.	QC/OA
HMA REPLACEMENT OVER PATCHES (HMA SURFACE COURSE, MIX "D", N70 IL 9.5mm)	4% AT 70 GYR.	QC/OA
OMP DESIGNATION: QUALITY CONTROL/QUALITY ASSURANCE (QC/OA); QUALITY CONTROL FOR PERFORMANCE (QCP)		

MODEL: Default  
 FILE: hma15c\_pavlabroom.dwg  
 PROJECT: 111219\Cadd\Drawings\DOT Office\Drawings\111219\Cadd\Drawings\Design\HOTIF

USER NAME = nafakha	DESIGNED -	REVISED - AJN 3/15/2019
PLOT SCALE = 100,0000' / in.	DRAWN -	REVISID -
PLOT DATE = 3/15/2019	CHECKED -	REVISID -
	DATE -	REVISID -

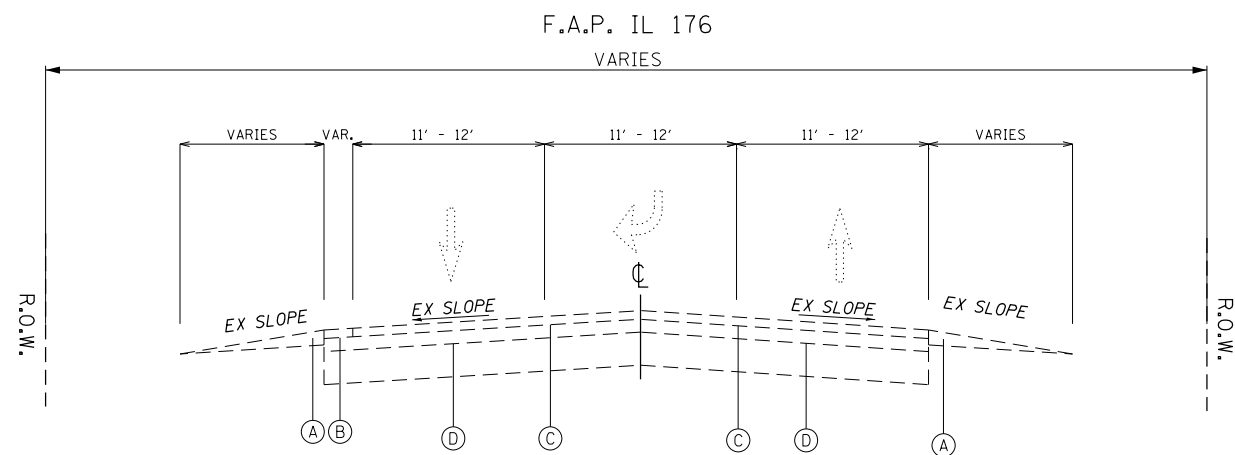
**STATE OF ILLINOIS  
 DEPARTMENT OF TRANSPORTATION**

**TYPICAL SECTION  
 IL. ROUTE 176 (SMITH ROAD TO FOX RIVER)**

SCALE: SHEET 5<sup>5</sup> OF 24 SHEETS STA. TO STA.

F.A.P. RTE. 335	SECTION 2018-0146-1	COUNTY MCHENRY	TOTAL SHEETS 24	SHEET NO. 5
ILLINOIS FED. AID PROJECT			CONTRACT NO. 62H76	





**EXISTING TYPICAL SECTION**

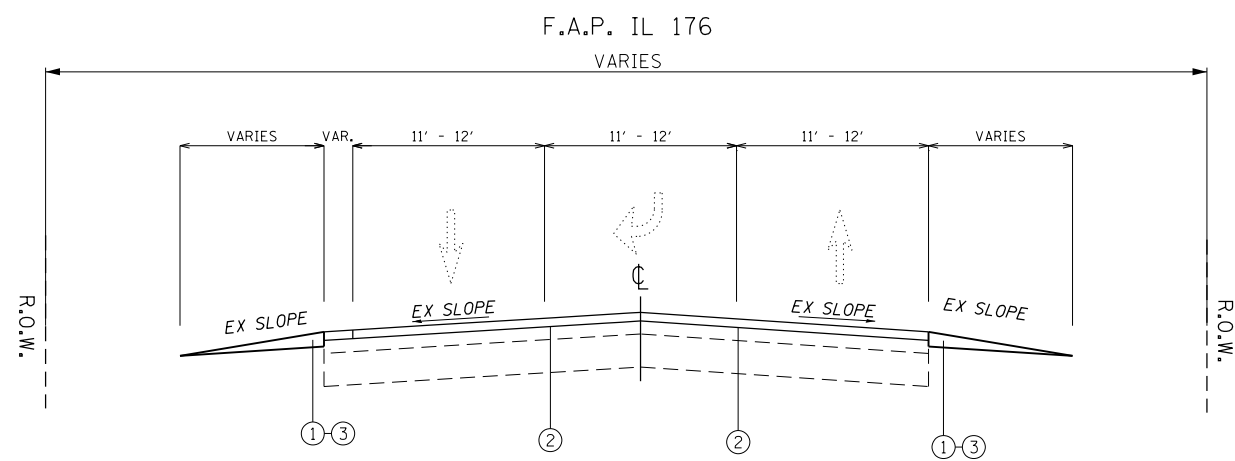
STA 68+10 TO STA 82+25

**LEGEND - EXISTING:**

- (A) EXISTING AGGREGATE SHOULDER, (VARIES)
- (B) EXISTING H.M.A. SHOULDER, (VARIES)
- (C) EXISTING H.M.A. SURFACE COURSE, 5 1/2" (±)
- (D) EXISTING PCC BASE COURSE, 9" (±)

**LEGEND - PROPOSED**

- (1) GRADING AND SHAPING SHOULDERS
- (2) ULTRA-THIN HMA SURFACE COURSE, MIX E, TYPE C, 90 LB/SQ YD
- (3) AGGREGATE SHOULDERS, TYPE B



**PROPOSED TYPICAL SECTION**

STA 68+10 TO STA 82+25

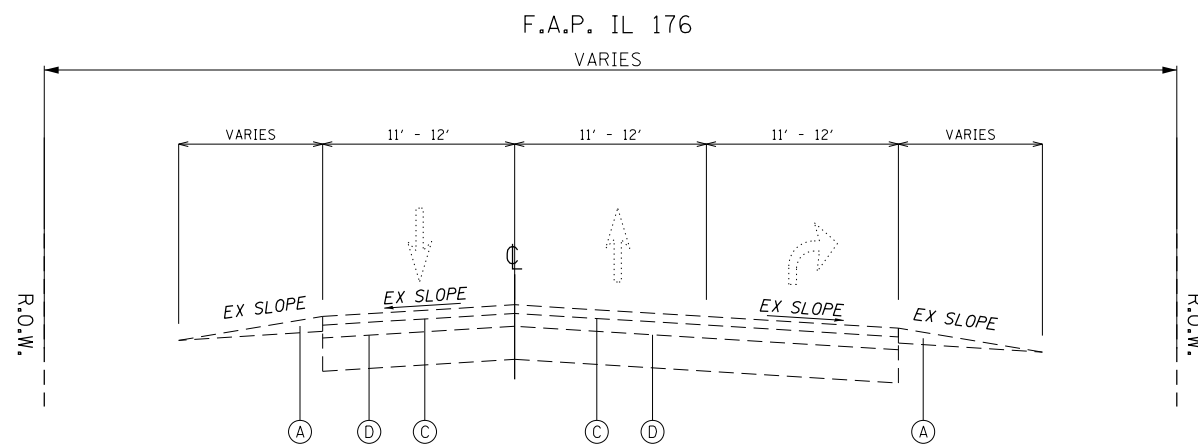
**STATE OF ILLINOIS  
DEPARTMENT OF TRANSPORTATION**

**TYPICAL SECTION  
IL. ROUTE 176 (SMITH ROAD TO FOX RIVER)**

F.A.P. RTE.	SECTION	COUNTY	TOTAL SHEETS	SHEET NO.
335	2018-0146-1	MCHENRY	24	7
<b>CONTRACT NO. 62H76</b>				
ILLINOIS		FED. AID PROJECT		

SCALE: SHEET 77 OF 244 SHEETS STA. TO STA.

USER NAME = nafakhaj	DESIGNED -	REVISED - AJN 3/15/2019
	DRAWN -	REVISED -
PLOT SCALE = 100,0000' / in.	CHECKED -	REVISED -
PLOT DATE = 3/15/2019	DATE -	REVISED -



**EXISTING TYPICAL SECTION**

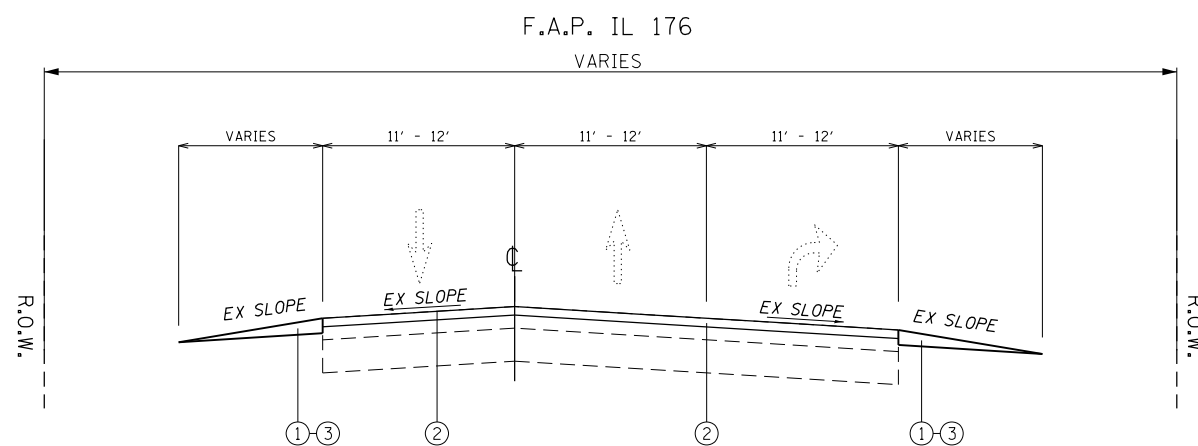
STA 138+45 TO STA 141+00

**LEGEND - EXISTING:**

- (A) EXISTING AGGREGATE SHOULDER, (VARIES)
- (B) EXISTING H.M.A. SHOULDER, (VARIES)
- (C) EXISTING H.M.A. SURFACE COURSE, 5 1/2" (±)
- (D) EXISTING PCC BASE COURSE, 9" (±)

**LEGEND - PROPOSED**

- (1) GRADING AND SHAPING SHOULDERS
- (2) ULTRA-THIN HMA SURFACE COURSE, MIX E, TYPE C, 90 LB/SQ YD
- (3) AGGREGATE SHOULDERS, TYPE B



**PROPOSED TYPICAL SECTION**

STA 138+45 TO STA 141+00

MODEL: Default  
 FILE: h:\mhc\p\pub\haronom.dwg  
 PROJECT: RWIDOT\Documents\DOT\_Offices\Director\_1\Projects\111219\CaddData\Design\MOTIF

USER NAME = nafakhaj	DESIGNED -	REVISED - AJN 3/15/2019
	DRAWN -	REVISED -
PLOT SCALE = 100,0000' / in.	CHECKED -	REVISED -
PLOT DATE = 3/15/2019	DATE -	REVISED -

**STATE OF ILLINOIS  
DEPARTMENT OF TRANSPORTATION**

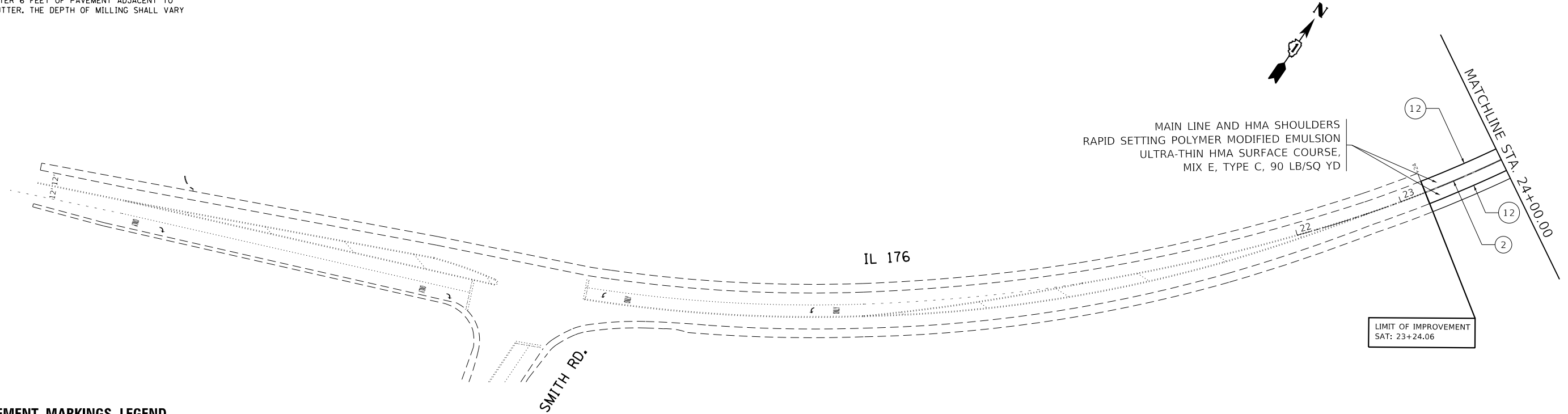
**TYPICAL SECTION  
IL. ROUTE 176 (SMITH ROAD TO FOX RIVER)**

SCALE: SHEET # OF 24 SHEETS STA. TO STA.

F.A.P. RTE.	SECTION	COUNTY	TOTAL SHEETS	SHEET NO.
335	2018-0146-1	MCHENRY	24	8
<b>CONTRACT NO. 62H76</b>				
		ILLINOIS	FED. AID PROJECT	



NOTE: HMA SURFACE REMOVAL, VARIABLE DEPTH SHALL BE PERFORMED ON THE OUTER 6 FEET OF PAVEMENT ADJACENT TO EXISTING CURB AND GUTTER. THE DEPTH OF MILLING SHALL VARY FROM 0" TO 1/8".

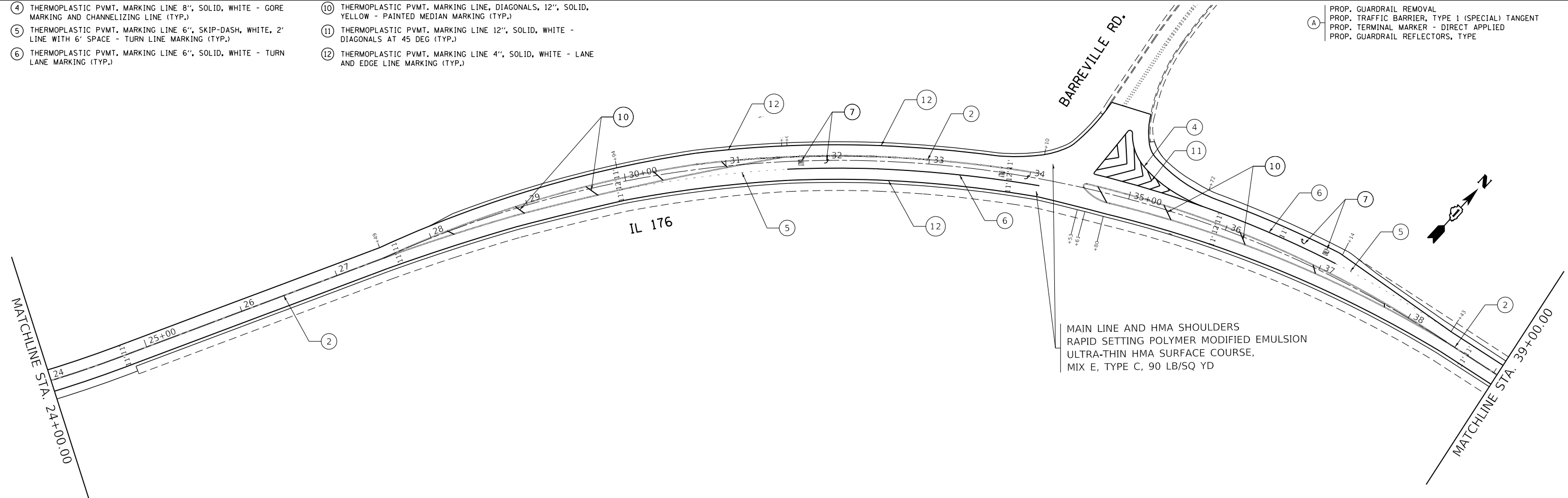


**PROPOSED PAVEMENT MARKINGS LEGEND**

- ① THERMOPLASTIC PVMT. MARKING LINE 4", SKIP-DASH, YELLOW, 10' LINE WITH 30' PASSING/NO PASSING ZONE CENTER LINES (TYP.)
- ② THERMOPLASTIC PVMT. MARKING LINE 4", SOLID, YELLOW, 2 @ 4", 11" C-C - CENTER LINE/PAINTED MEDIAN MARKING (TYP.)
- ③ THERMOPLASTIC PVMT. MARKING LINE 4", SOLID, YELLOW, 5/2" C-C - NO PASSING ZONE CENTER LINES (TYP.)
- ④ THERMOPLASTIC PVMT. MARKING LINE 8", SOLID, WHITE - GORE MARKING AND CHANNELIZING LINE (TYP.)
- ⑤ THERMOPLASTIC PVMT. MARKING LINE 6", SKIP-DASH, WHITE, 2' LINE WITH 6' SPACE - TURN LINE MARKING (TYP.)
- ⑥ THERMOPLASTIC PVMT. MARKING LINE 6", SOLID, WHITE - TURN LANE MARKING (TYP.)
- ⑦ THERMOPLASTIC PVMT. MARKING LETTERS & SYMBOLS, 8", SOLID, WHITE - PAVEMENT MARKING (TYP.)
- ⑧ THERMOPLASTIC PVMT. MARKING LINE 24", SOLID, WHITE - STOP LINES (TYP.)
- ⑨ THERMOPLASTIC PVMT. MARKING LINE 24", SOLID, WHITE, 6' LINES, 48" C-C - CROSSWALK MARKING (TYP.)
- ⑩ THERMOPLASTIC PVMT. MARKING LINE, DIAGONALS, 12", SOLID, YELLOW - PAINTED MEDIAN MARKING (TYP.)
- ⑪ THERMOPLASTIC PVMT. MARKING LINE 12", SOLID, WHITE - DIAGONALS AT 45 DEG (TYP.)
- ⑫ THERMOPLASTIC PVMT. MARKING LINE 4", SOLID, WHITE - LANE AND EDGE LINE MARKING (TYP.)

**PROPOSED ROADWAY LEGEND**

- Ⓐ PROP. GUARDRAIL REMOVAL
- Ⓐ PROP. TRAFFIC BARRIER, TYPE 1 (SPECIAL) TANGENT
- Ⓐ PROP. TERMINAL MARKER - DIRECT APPLIED
- Ⓐ PROP. GUARDRAIL REFLECTORS, TYPE



MODEL: Default  
FILE: h:\mhc\p\pub\baronm.d\illinois.gov\PWIDOT\Documents\DOT\_Offices\District 1\Projects\11219\CADD\Drawings\Design\MOTIF

USER NAME = nafakha	DESIGNED -	REVISED - AJN 3/15/2019
	DRAWN -	REVISED -
PLOT SCALE = 100.0000' / in.	CHECKED -	REVISED -
PLOT DATE = 3/15/2019	DATE -	REVISED -

**STATE OF ILLINOIS  
DEPARTMENT OF TRANSPORTATION**

**ROADWAY PLAN SHEETS  
IL. ROUTE 176 (SMITH ROAD TO FOX RIVER)**

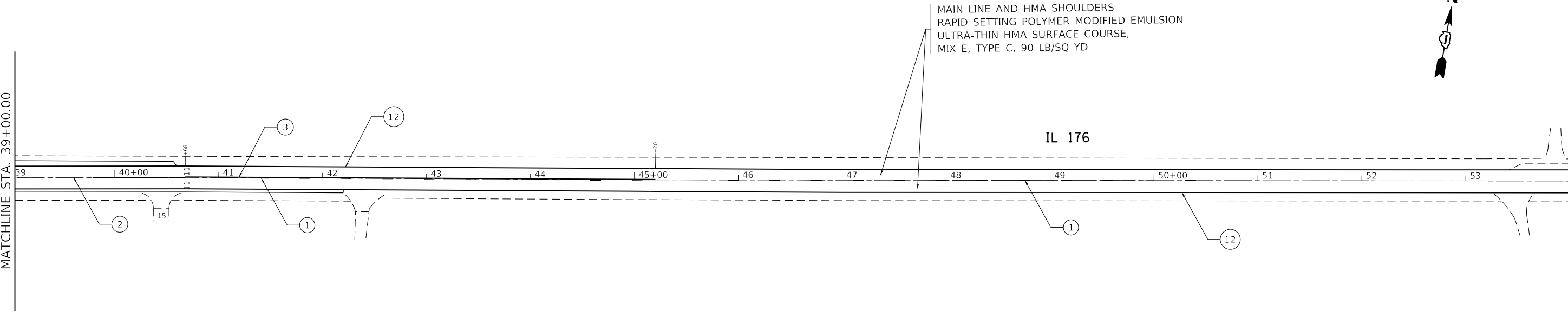
SCALE: 1"= 50' SHEET OF SHEETS STA. TO STA.

F.A.P. RTE. 335	SECTION 2018-0146-I	COUNTY MCHENRY	TOTAL SHEETS 24	SHEET NO. 9
			CONTRACT NO. 62H76	
		ILLINOIS FED. AID PROJECT		

NOTE: HMA SURFACE REMOVAL, VARIABLE DEPTH SHALL BE PERFORMED ON THE OUTER 6 FEET OF PAVEMENT ADJACENT TO EXISTING CURB AND GUTTER. THE DEPTH OF MILLING SHALL VARY FROM 0" TO 1/8".

MATCHLINE STA. 39+00.00

MATCHLINE STA. 54+00.00



**PROPOSED PAVEMENT MARKINGS LEGEND**

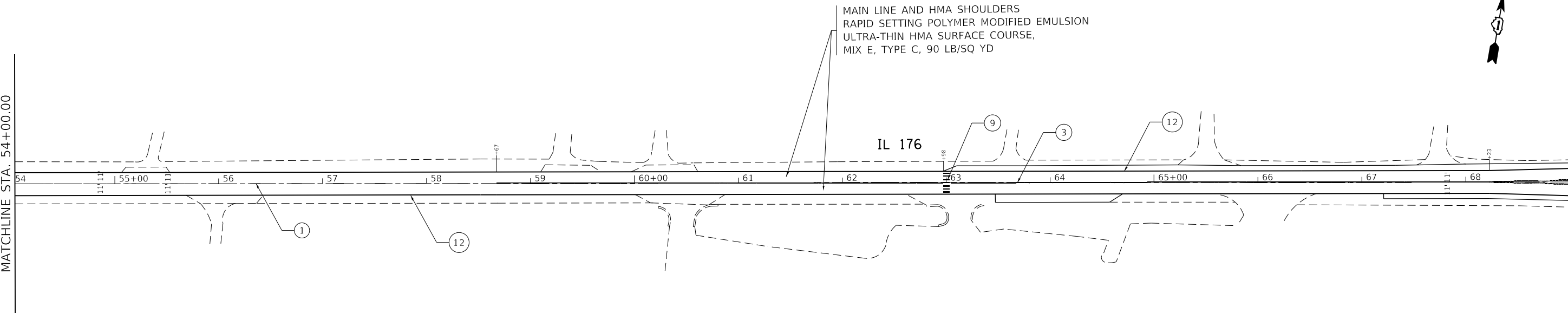
- ① THERMOPLASTIC PVMT. MARKING LINE 4", SKIP-DASH, YELLOW, 10' LINE WITH 30' PASSING/NO PASSING ZONE CENTER LINES (TYP.)
- ② THERMOPLASTIC PVMT. MARKING LINE 4", SOLID, YELLOW, 2 @ 4", 11" C-C - CENTER LINE/PAINTED MEDIAN MARKING (TYP.)
- ③ THERMOPLASTIC PVMT. MARKING LINE 4", SOLID, YELLOW, 5/2" C-C - NO PASSING ZONE CENTER LINES (TYP.)
- ④ THERMOPLASTIC PVMT. MARKING LINE 8", SOLID, WHITE - GORE MARKING AND CHANNELIZING LINE (TYP.)
- ⑤ THERMOPLASTIC PVMT. MARKING LINE 6", SKIP-DASH, WHITE, 2' LINE WITH 6' SPACE - TURN LINE MARKING (TYP.)
- ⑥ THERMOPLASTIC PVMT. MARKING LINE 6", SOLID, WHITE - TURN LANE MARKING (TYP.)
- ⑦ THERMOPLASTIC PVMT. MARKING LETTERS & SYMBOLS, 8", SOLID, WHITE - PAVEMENT MARKING (TYP.)
- ⑧ THERMOPLASTIC PVMT. MARKING LINE 24", SOLID, WHITE - STOP LINES (TYP.)
- ⑨ THERMOPLASTIC PVMT. MARKING LINE 24", SOLID, WHITE, 6' LINES, 48" C-C - CROSSWALK MARKING (TYP.)
- ⑩ THERMOPLASTIC PVMT. MARKING LINE, DIAGONALS, 12", SOLID, YELLOW - PAINTED MEDIAN MARKING (TYP.)
- ⑪ THERMOPLASTIC PVMT. MARKING LINE 12", SOLID, WHITE - DIAGONALS AT 45 DEG (TYP.)
- ⑫ THERMOPLASTIC PVMT. MARKING LINE 4", SOLID, WHITE - LANE AND EDGE LINE MARKING (TYP.)

**PROPOSED ROADWAY LEGEND**

- Ⓐ PROP. GUARDRAIL REMOVAL
- PROP. TRAFFIC BARRIER, TYPE 1 (SPECIAL) TANGENT
- PROP. TERMINAL MARKER - DIRECT APPLIED
- PROP. GUARDRAIL REFLECTORS, TYPE

MATCHLINE STA. 54+00.00

MATCHLINE STA. 69+00.00



MODEL: Default  
FILE: \\nas101\pub\planroom\dat\illinois\pwr\pww\DOT\Documents\DOT\_Offices\Dir\refc\_1\Projects\111219\CADD\Drawn\Design\MOTIF

USER NAME = nafakhaj	DESIGNED -	REVISED - AJN 3/15/2019
	DRAWN -	REVISED -
PLOT SCALE = 100,0000' / in.	CHECKED -	REVISED -
PLOT DATE = 3/15/2019	DATE -	REVISED -

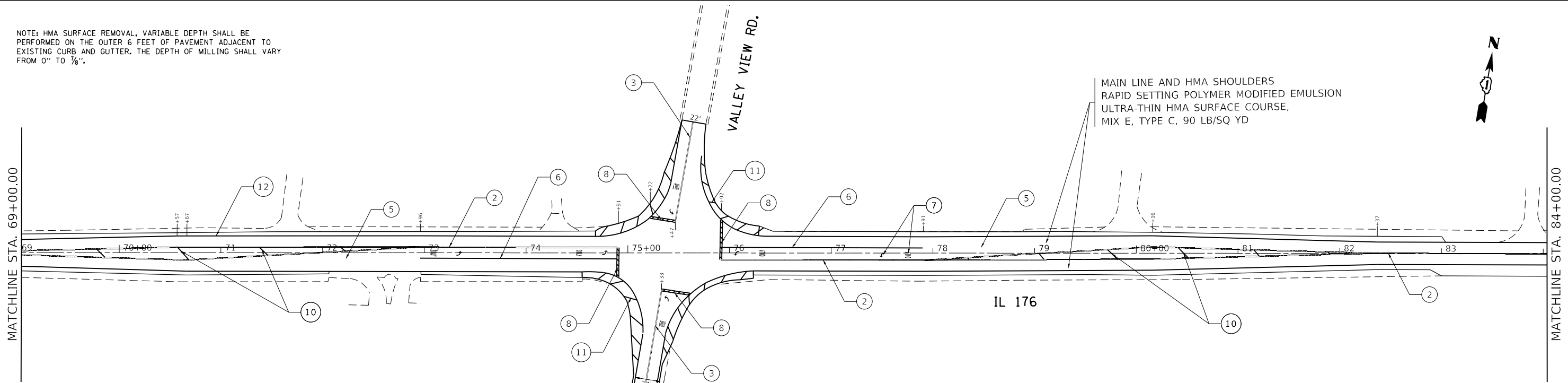
**STATE OF ILLINOIS  
DEPARTMENT OF TRANSPORTATION**

**ROADWAY PLAN SHEETS  
IL. ROUTE 176 (SMITH ROAD TO FOX RIVER)**

SCALE: 1"= 50' SHEET OF SHEETS STA. TO STA.

F.A.P. RTE.	SECTION	COUNTY	TOTAL SHEETS	SHEET NO.
335	2018-0146-I	MCHENRY	24	10
			CONTRACT NO. 62H76	
ILLINOIS FED. AID PROJECT				

NOTE: HMA SURFACE REMOVAL, VARIABLE DEPTH SHALL BE PERFORMED ON THE OUTER 6 FEET OF PAVEMENT ADJACENT TO EXISTING CURB AND GUTTER. THE DEPTH OF MILLING SHALL VARY FROM 0" TO 1/8".

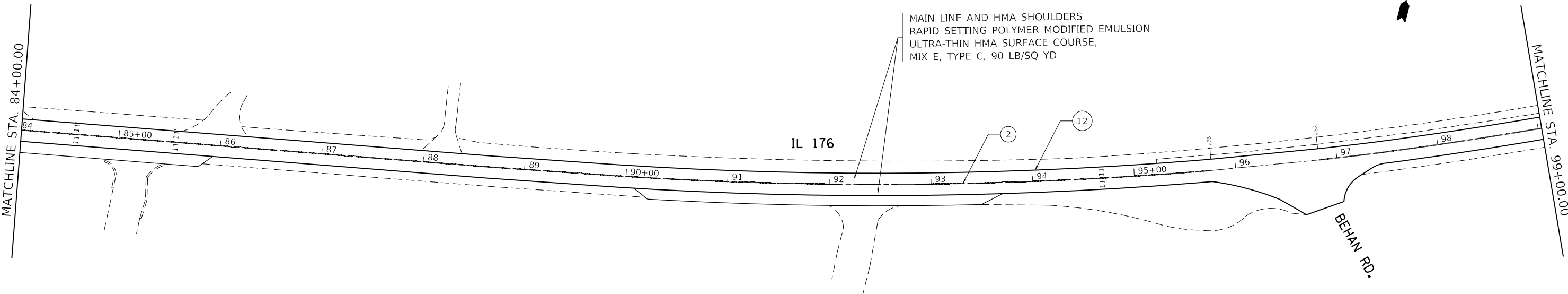


**PROPOSED PAVEMENT MARKINGS LEGEND**

- ① THERMOPLASTIC PVMT. MARKING LINE 4", SKIP-DASH, YELLOW, 10' LINE WITH 30' PASSING/NO PASSING ZONE CENTER LINES (TYP.)
- ② THERMOPLASTIC PVMT. MARKING LINE 4", SOLID, YELLOW, 2 @ 4", 11" C-C - CENTER LINE/PAINTED MEDIAN MARKING (TYP.)
- ③ THERMOPLASTIC PVMT. MARKING LINE 4", SOLID, YELLOW, 5/2" C-C - NO PASSING ZONE CENTER LINES (TYP.)
- ④ THERMOPLASTIC PVMT. MARKING LINE 8", SOLID, WHITE - GORE MARKING AND CHANNELIZING LINE (TYP.)
- ⑤ THERMOPLASTIC PVMT. MARKING LINE 6", SKIP-DASH, WHITE, 2' LINE WITH 6' SPACE - TURN LINE MARKING (TYP.)
- ⑥ THERMOPLASTIC PVMT. MARKING LINE 6", SOLID, WHITE - TURN LANE MARKING (TYP.)
- ⑦ THERMOPLASTIC PVMT. MARKING LETTERS & SYMBOLS, 8", SOLID, WHITE - PAVEMENT MARKING (TYP.)
- ⑧ THERMOPLASTIC PVMT. MARKING LINE 24", SOLID, WHITE - STOP LINES (TYP.)
- ⑨ THERMOPLASTIC PVMT. MARKING LINE 24", SOLID, WHITE, 6' LINES, 48" C-C - CROSSWALK MARKING (TYP.)
- ⑩ THERMOPLASTIC PVMT. MARKING LINE, DIAGONALS, 12", SOLID, YELLOW - PAINTED MEDIAN MARKING (TYP.)
- ⑪ THERMOPLASTIC PVMT. MARKING LINE 12", SOLID, WHITE - DIAGONALS AT 45 DEG (TYP.)
- ⑫ THERMOPLASTIC PVMT. MARKING LINE 4", SOLID, WHITE - LANE AND EDGE LINE MARKING (TYP.)

**PROPOSED ROADWAY LEGEND**

- Ⓐ PROP. GUARDRAIL REMOVAL
- PROP. TRAFFIC BARRIER, TYPE 1 (SPECIAL) TANGENT
- PROP. TERMINAL MARKER - DIRECT APPLIED
- PROP. GUARDRAIL REFLECTORS, TYPE



MODEL: Default  
FILE: h:\mhc\p\pub\haronom.dwg  
PROJECT: 111219\Cadd\Design\MOTIF

USER NAME = nafakhaj	DESIGNED -	REVISED - AJN 3/15/2019
	DRAWN -	REVISED -
PLOT SCALE = 100.0000' / in.	CHECKED -	REVISED -
PLOT DATE = 3/15/2019	DATE -	REVISED -

**STATE OF ILLINOIS  
DEPARTMENT OF TRANSPORTATION**

**ROADWAY PLAN SHEETS  
IL. ROUTE 176 (SMITH ROAD TO FOX RIVER)**

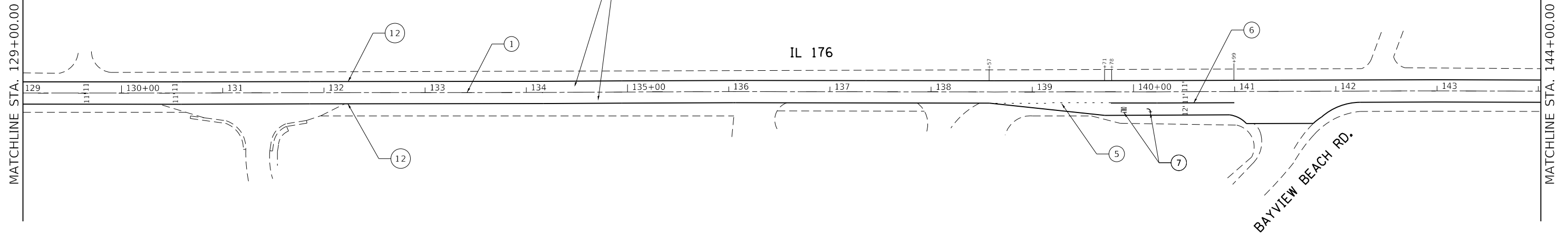
SCALE: 1"= 50'    SHEET    OF    SHEETS    STA.    TO    STA.

F.A.P. RTE.	SECTION	COUNTY	TOTAL SHEETS	SHEET NO.
335	2018-0146-I	MCHENRY	24	11
			CONTRACT NO. 62H76	
ILLINOIS FED. AID PROJECT				



NOTE: HMA SURFACE REMOVAL, VARIABLE DEPTH SHALL BE PERFORMED ON THE OUTER 6 FEET OF PAVEMENT ADJACENT TO EXISTING CURB AND GUTTER. THE DEPTH OF MILLING SHALL VARY FROM 0" TO 1/8".

MAIN LINE AND HMA SHOULDERS  
RAPID SETTING POLYMER MODIFIED EMULSION  
ULTRA-THIN HMA SURFACE COURSE,  
MIX E, TYPE C, 90 LB/SQ YD



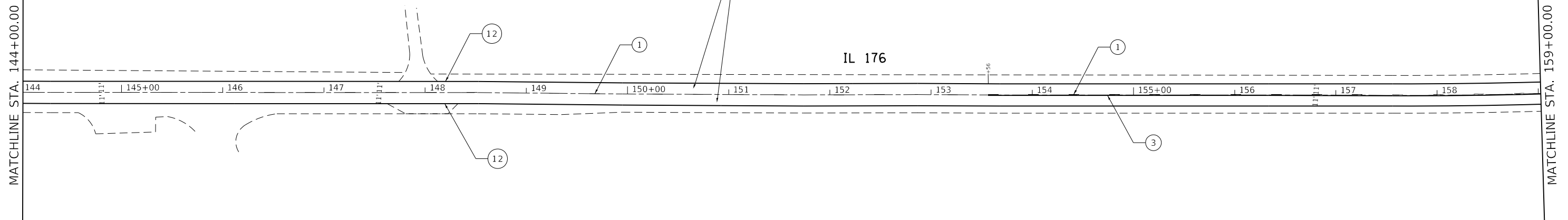
**PROPOSED PAVEMENT MARKINGS LEGEND**

- ① THERMOPLASTIC PVM. MARKING LINE 4", SKIP-DASH, YELLOW, 10' LINE WITH 30' PASSING/NO PASSING ZONE CENTER LINES (TYP.)
- ② THERMOPLASTIC PVM. MARKING LINE 4", SOLID, YELLOW, 2 @ 4", 11" C-C - CENTER LINE/PAINTED MEDIAN MARKING (TYP.)
- ③ THERMOPLASTIC PVM. MARKING LINE 4", SOLID, YELLOW, 5/2" C-C - NO PASSING ZONE CENTER LINES (TYP.)
- ④ THERMOPLASTIC PVM. MARKING LINE 8", SOLID, WHITE - GORE MARKING AND CHANNELIZING LINE (TYP.)
- ⑤ THERMOPLASTIC PVM. MARKING LINE 6", SKIP-DASH, WHITE, 2' LINE WITH 6' SPACE - TURN LINE MARKING (TYP.)
- ⑥ THERMOPLASTIC PVM. MARKING LINE 6", SOLID, WHITE - TURN LANE MARKING (TYP.)
- ⑦ THERMOPLASTIC PVM. MARKING LETTERS & SYMBOLS, 8", SOLID, WHITE - PAVEMENT MARKING (TYP.)
- ⑧ THERMOPLASTIC PVM. MARKING LINE 24", SOLID, WHITE - STOP LINES (TYP.)
- ⑨ THERMOPLASTIC PVM. MARKING LINE 24", SOLID, WHITE, 6' LINES, 48" C-C - CROSSWALK MARKING (TYP.)
- ⑩ THERMOPLASTIC PVM. MARKING LINE, DIAGONALS, 12", SOLID, YELLOW - PAINTED MEDIAN MARKING (TYP.)
- ⑪ THERMOPLASTIC PVM. MARKING LINE 12", SOLID, WHITE - DIAGONALS AT 45 DEG (TYP.)
- ⑫ THERMOPLASTIC PVM. MARKING LINE 4", SOLID, WHITE - LANE AND EDGE LINE MARKING (TYP.)

**PROPOSED ROADWAY LEGEND**

- Ⓐ PROP. GUARDRAIL REMOVAL
- PROP. TRAFFIC BARRIER, TYPE 1 (SPECIAL) TANGENT
- PROP. TERMINAL MARKER - DIRECT APPLIED
- PROP. GUARDRAIL REFLECTORS, TYPE

MAIN LINE AND HMA SHOULDERS  
RAPID SETTING POLYMER MODIFIED EMULSION  
ULTRA-THIN HMA SURFACE COURSE,  
MIX E, TYPE C, 90 LB/SQ YD



MODEL: Default  
FILE: h:\mhc\pub\planroom\dat\illinois.gov\PWIDOT\Documents\DOT\_Offices\District\_1\Projects\111219\Caddata\Design\MOTIF

USER NAME = nafakha	DESIGNED -	REVISED - AJN 3/15/2019
	DRAWN -	REVISED -
PLOT SCALE = 100,0000' / in.	CHECKED -	REVISED -
PLOT DATE = 3/15/2019	DATE -	REVISED -

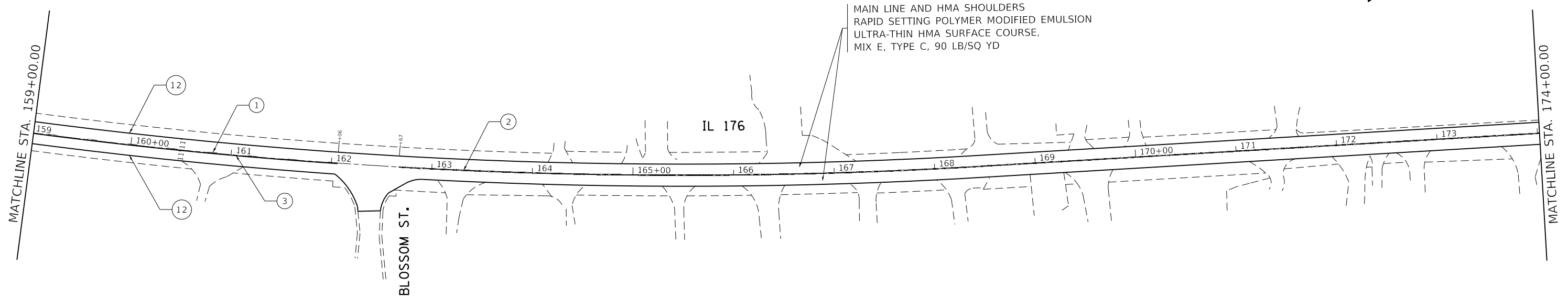
**STATE OF ILLINOIS  
DEPARTMENT OF TRANSPORTATION**

**ROADWAY PLAN SHEETS  
IL. ROUTE 176 (SMITH ROAD TO FOX RIVER)**

SCALE: 1"= 50' SHEET OF SHEETS STA. TO STA.

F.A.P. RTE.	SECTION	COUNTY	TOTAL SHEETS	SHEET NO.
335	2018-0146-I	MCHENRY	24	13
CONTRACT NO. 62H76			ILLINOIS FED. AID PROJECT	

NOTE: HMA SURFACE REMOVAL, VARIABLE DEPTH SHALL BE PERFORMED ON THE OUTER 6 FEET OF PAVEMENT ADJACENT TO EXISTING CURB AND GUTTER. THE DEPTH OF MILLING SHALL VARY FROM 0" TO 1/8".



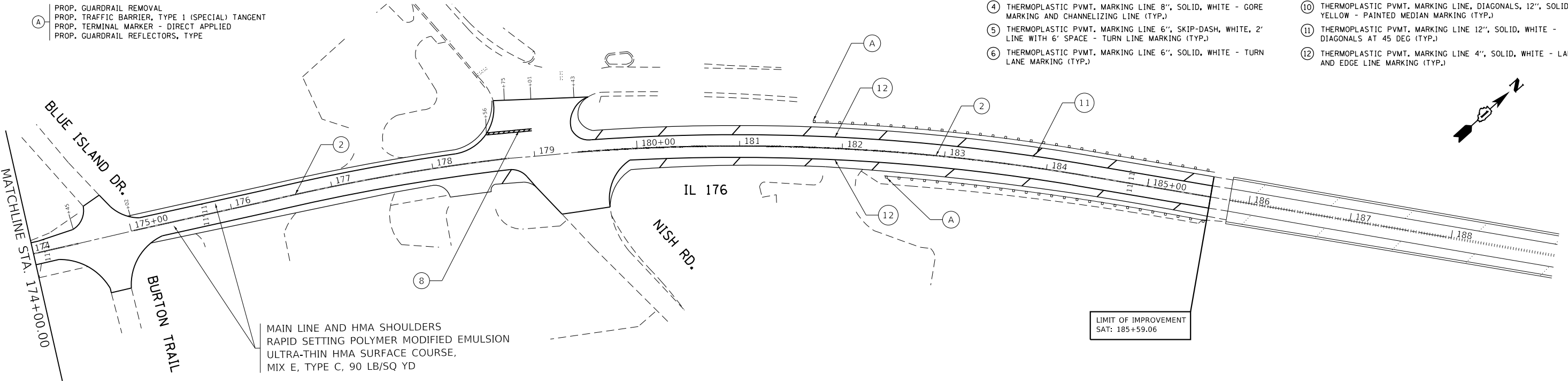
MAIN LINE AND HMA SHOULDERS  
RAPID SETTING POLYMER MODIFIED EMULSION  
ULTRA-THIN HMA SURFACE COURSE,  
MIX E, TYPE C, 90 LB/SQ YD

**PROPOSED ROADWAY LEGEND**

- (A) PROP. GUARDRAIL REMOVAL
- PROP. TRAFFIC BARRIER, TYPE 1 (SPECIAL) TANGENT
- PROP. TERMINAL MARKER - DIRECT APPLIED
- PROP. GUARDRAIL REFLECTORS, TYPE

**PROPOSED PAVEMENT MARKINGS LEGEND**

- (1) THERMOPLASTIC PVMT. MARKING LINE 4", SKIP-DASH, YELLOW, 10' LINE WITH 30' PASSING/NO PASSING ZONE CENTER LINES (TYP.)
- (2) THERMOPLASTIC PVMT. MARKING LINE 4", SOLID, YELLOW, 2 @ 4', 11" C-C - CENTER LINE/PAINTED MEDIAN MARKING (TYP.)
- (3) THERMOPLASTIC PVMT. MARKING LINE 4", SOLID, YELLOW, 5/2" C-C - NO PASSING ZONE CENTER LINES (TYP.)
- (4) THERMOPLASTIC PVMT. MARKING LINE 8", SOLID, WHITE - GORE MARKING AND CHANNELIZING LINE (TYP.)
- (5) THERMOPLASTIC PVMT. MARKING LINE 6", SKIP-DASH, WHITE, 2' LINE WITH 6' SPACE - TURN LINE MARKING (TYP.)
- (6) THERMOPLASTIC PVMT. MARKING LINE 6", SOLID, WHITE - TURN LANE MARKING (TYP.)
- (7) THERMOPLASTIC PVMT. MARKING LETTERS & SYMBOLS, 8", SOLID, WHITE - PAVEMENT MARKING (TYP.)
- (8) THERMOPLASTIC PVMT. MARKING LINE 24", SOLID, WHITE - STOP LINES (TYP.)
- (9) THERMOPLASTIC PVMT. MARKING LINE 24", SOLID, WHITE, 6' LINES, 48" C-C - CROSSWALK MARKING (TYP.)
- (10) THERMOPLASTIC PVMT. MARKING LINE, DIAGONALS, 12", SOLID, YELLOW - PAINTED MEDIAN MARKING (TYP.)
- (11) THERMOPLASTIC PVMT. MARKING LINE 12", SOLID, WHITE - DIAGONALS AT 45 DEG (TYP.)
- (12) THERMOPLASTIC PVMT. MARKING LINE 4", SOLID, WHITE - LANE AND EDGE LINE MARKING (TYP.)



MAIN LINE AND HMA SHOULDERS  
RAPID SETTING POLYMER MODIFIED EMULSION  
ULTRA-THIN HMA SURFACE COURSE,  
MIX E, TYPE C, 90 LB/SQ YD

LIMIT OF IMPROVEMENT  
SAT: 185+59.06

MODEL: Default  
FILE: h:\mhc\p\pub\harcam\dat\illinois\pwr\DOT\Documents\DOT\_Offices\Illinet\1\Projects\111219\Cadd\Drawings\Design\MOTIF

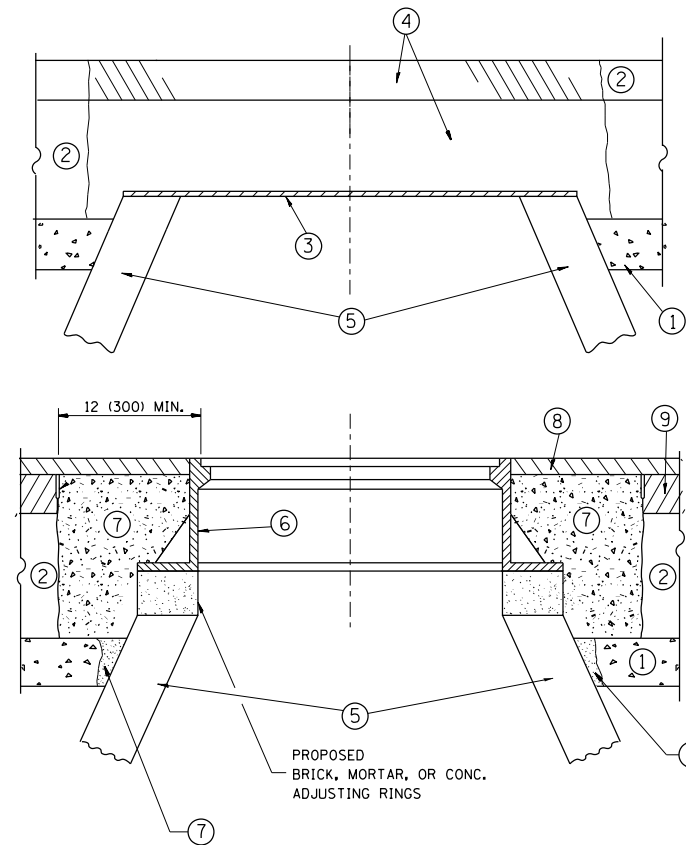
USER NAME = nafakha	DESIGNED -	REVISED - AJN 3/15/2019
PLOT SCALE = 100,0000' / in.	DRAWN -	REVISED -
PLOT DATE = 3/15/2019	CHECKED -	REVISED -
	DATE -	REVISED -

**STATE OF ILLINOIS  
DEPARTMENT OF TRANSPORTATION**

**ROADWAY PLAN SHEETS  
IL. ROUTE 176 (SMITH ROAD TO FOX RIVER)**

SCALE: 1"= 50' SHEET OF SHEETS STA. TO STA.

F.A.P. RTE. 335	SECTION 2018-0146-I	COUNTY MCHENRY	TOTAL SHEETS 24	SHEET NO. 14
CONTRACT NO. 62H76			ILLINOIS FED. AID PROJECT	



**CONSTRUCTION PROCEDURES**

**STAGE 1 (BEFORE PAVEMENT MILLING)**

- A) REMOVE A MINIMUM OF 12 (300) OF THE PAVEMENT FROM AROUND THE STRUCTURE.
- B) REMOVE THE EXISTING FRAME AND LID FROM THE STRUCTURE.
- C) COVER THE STRUCTURE OPENING WITH A 36 (900) DIAMETER METAL PLATE.
- D) BACKFILL WITH CRUSHED STONE AND A MINIMUM 1/2 (40) THICK HMA SURFACE MIX APPROVED BY THE ENGINEER.

**STAGE 2 (AFTER PAVEMENT MILLING)**

- A) REMOVE THE HMA SURFACE MIX AND CRUSHED STONE.
- B) INSTALL THE FRAME AND LID; ADJUST THE FRAME TO ITS FINAL SURFACE ELEVATION.
- C) THE SURROUNDING SPACE SHALL BE FILLED WITH CLASS PP-1\* CONCRETE TO THE ELEVATION OF THE SURFACE OF THE EXISTING BASE COURSE OR THE BINDER COURSE.

\* UNLESS OTHERWISE SPECIFIED IN THE PLANS.

THE PROCEDURE EXPLAINED ABOVE SHALL CONFORM TO THE APPLICABLE PORTIONS OF SECTIONS 353, 406, 602, AND 603 OF THE STANDARD SPECIFICATIONS EXCEPT THAT "THE CONTRACTOR SHALL ADJUST THE STRUCTURES TO THE FINISHED PAVEMENT ELEVATION NO MORE THAN 5 CALENDAR DAYS PRIOR TO PLACEMENT OF THE FINAL LIFT OF SURFACE UNLESS APPROVED BY THE ENGINEER."

**LEGEND**

- ① SUB-BASE GRANULAR MATERIAL
- ② EXISTING PAVEMENT
- ③ 36 (900) DIAMETER METAL PLATE
- ④ PROPOSED CRUSHED STONE AND HMA SURFACE MIX
- ⑤ EXISTING STRUCTURE
- ⑥ FRAME AND LID (SEE NOTES)
- ⑦ CLASS PP-1\* CONCRETE
- ⑧ PROPOSED HMA SURFACE COURSE
- ⑨ PROPOSED HMA BINDER COURSE

**LOCATION OF STRUCTURES:**

THE CONTRACTOR WILL BE REQUIRED TO KEEP A RECORD OF THE LOCATIONS OF THE BURIED STRUCTURES ACCORDING TO THE STATION AND DISTANCE LEFT OR RIGHT OF THE CENTERLINE OF PAVEMENT. UPON COMPLETION OF THE WORK, THE CONTRACTOR WILL DELIVER THE RECORD TO THE ENGINEER.

**BASIS OF PAYMENT:**

REMOVING FRAMES AND LIDS ON DRAINAGE AND UTILITY STRUCTURES IN THE PAVEMENT PRIOR TO MILLING, AND ADJUSTING TO FINAL GRADE PRIOR TO PLACING THE SURFACE COURSE, WILL BE PAID FOR AT THE CONTRACT UNIT PRICE EACH FOR "FRAMES AND LIDS TO BE ADJUSTED (SPECIAL)."

THIS WORK WILL NOT BE PAID FOR WHEN DRAINAGE AND UTILITY STRUCTURES ARE SPECIFIED FOR PAYMENT AS STRUCTURE RECONSTRUCTION.

NEW FRAMES AND LIDS, WHEN SPECIFIED, WILL BE PAID FOR SEPARATELY.

**NOTES:**

EXISTING BROKEN FRAMES AND LIDS SHALL BE REMOVED AND DISPOSED OF BY THE CONTRACTOR AND SHALL BE REPLACED AS DIRECTED BY THE ENGINEER. REPLACEMENT FRAMES AND LIDS WILL BE PAID FOR IN ACCORDANCE WITH ARTICLE 109.04 OF THE STANDARD SPECIFICATIONS UNLESS A SEPARATE PAY ITEM HAS BEEN PROVIDED.

IF THE EXISTING LIDS ARE OPEN, THE FRAME WILL BE ADJUSTED TO THE ELEVATION OF THE MILLED PAVEMENT SURFACE PRIOR TO THE MILLING OPERATION. THE FRAME WILL NOT BE REMOVED AND COVERED BY THE METAL PLATE.

CITY OF CHICAGO CASTINGS ARE THE PROPERTY OF THE CITY AND THE CONTRACTOR SHALL NOTIFY THE CITY FOR REMOVAL AND DISPOSITION OF THE CASTINGS.

THE METAL PLATE USED TO COVER THE STRUCTURE SHALL REMAIN THE PROPERTY OF THE CONTRACTOR.

WHEN STRUCTURES ARE TO BE ADJUSTED OR RECONSTRUCTED, THE LOWERING AND RAISING OF THE FRAMES AND LIDS WILL NOT BE PAID FOR SEPARATELY BUT WILL BE INCLUDED IN THE COST OF THE CORRESPONDING PAY ITEM.

**DETAILS FOR FRAMES AND LIDS ADJUSTMENT WITH MILLING**

ALL DIMENSIONS ARE IN INCHES (MILLIMETERS) UNLESS OTHERWISE SHOWN

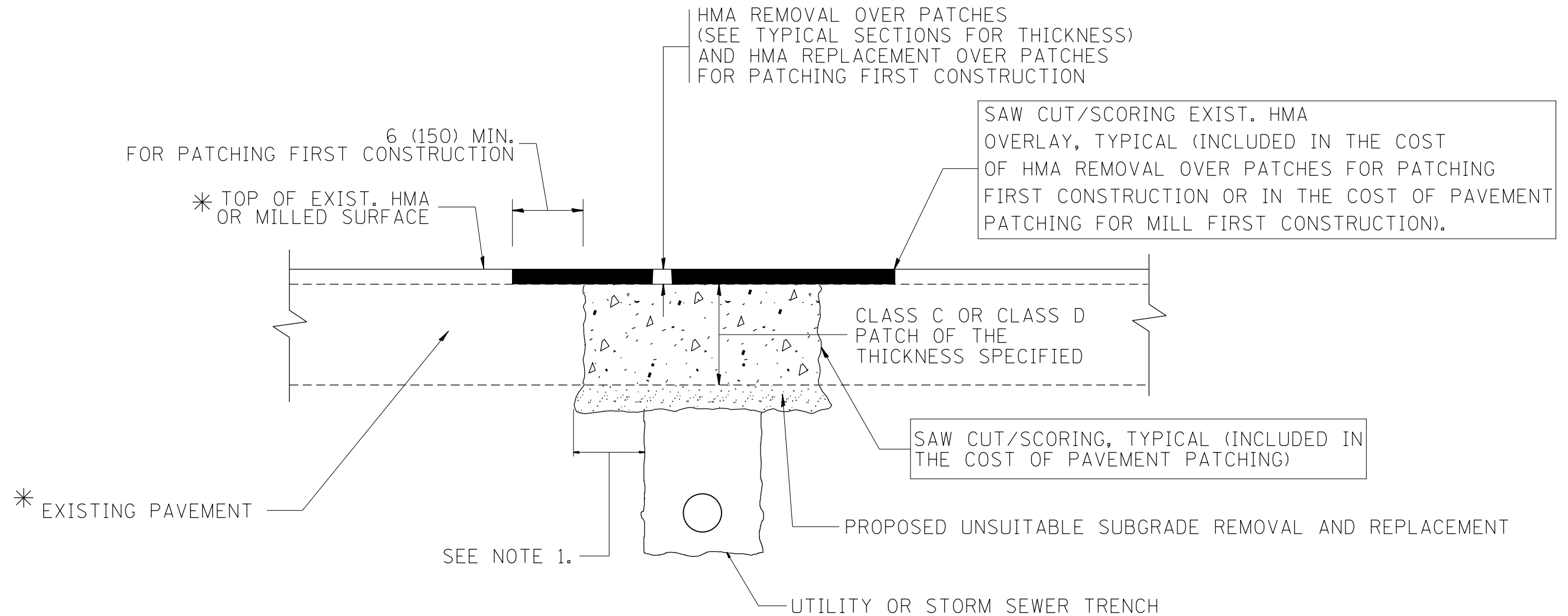
FILE NAME =	USER NAME = nafakhaj	DESIGNED - R. SHAH	REVISED - R. WIEDEMAN 05-14-04
pw\11084EBIDINTEG.illinois.gov\PIWIDOT\Documents\DOT Offices\District 1\Projects\DI1121\DRAMA\Design\MOTIF			REVISED - R. BORO 01-01-07
	PLOT SCALE = 100.0000' / in.	CHECKED -	REVISED - R. BORO 03-09-11
	PLOT DATE = 2/1/2019	DATE - 10-25-94	REVISED - R. BORO 12-06-11

**STATE OF ILLINOIS  
DEPARTMENT OF TRANSPORTATION**

**DETAILS FOR  
FRAMES AND LIDS ADJUSTMENT WITH MILLING**

SCALE: NONE SHEET NO. 1 OF 1 SHEETS STA. TO STA.

F.A.P. RTE.	SECTION	COUNTY	TOTAL SHEETS	SHEET NO.
335	2018-0146-1	MCHENRY	24	15
BD600-03 (BD-8)		CONTRACT NO. 62H76		
FED. ROAD DIST. NO. 1 ILLINOIS FED. AID PROJECT				



\* SEE TYPICAL SECTIONS FOR THICKNESS AND MATERIALS

**NOTES:**

1. THE WIDTH OF THE FULL DEPTH PATCH OVER A TRENCH SHALL BE 12 (300) WIDER ON EACH SIDE OF THE TRENCH.
2. FOR METHOD OF MEASUREMENT AND BASIS OF PAYMENT, SEE RECURRING SPECIAL PROVISION "PATCHING WITH HOT-MIX ASPHALT OVERLAY REMOVAL".

SEQUENCE OF CONSTRUCTION (PATCHING FIRST)

1. REMOVE THE EXISTING HMA MATERIAL OVER THE AREA TO BE PATCHED.
2. REMOVE AND REPLACE WITH CLASS C OR D PATCH.
3. REPLACE HMA MATERIAL OVER THE AREA TO BE PATCHED.

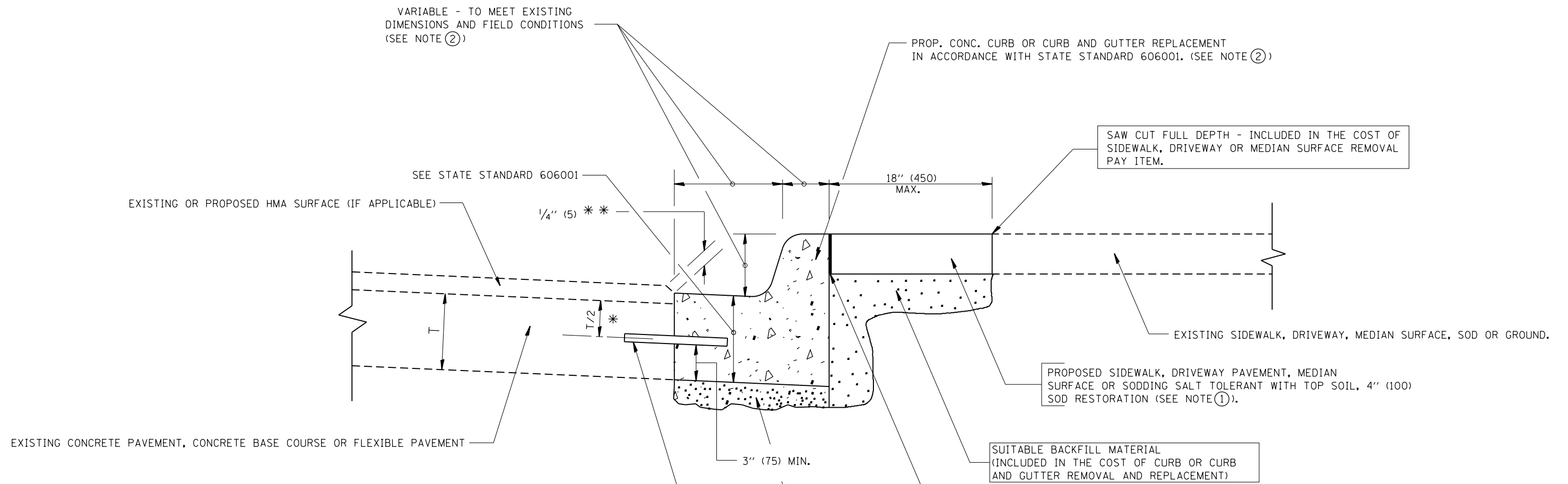
SEQUENCE OF CONSTRUCTION (MILLING FIRST)

1. MILL HMA FIRST IF THERE IS AT LEAST 4 1/2 INCHES OR MORE OF HMA MATERIAL ON TOP OF THE EXISTING PAVEMENT OR IF THE PAVEMENT IS FULL DEPTH HMA. A MINIMUM OF 2 INCHES OF HMA MATERIAL SHALL BE IN PLACE AFTER MILLING.
2. REMOVE AND REPLACE WITH FULL DEPTH CLASS D PATCHES TO TOP OF MILLED SURFACE.

ALL DIMENSIONS ARE IN INCHES (MILLIMETERS) UNLESS OTHERWISE SHOWN.

FILE NAME =	USER NAME = nafakhaj	DESIGNED - R. SHAH	REVISED - A. ABBAS 04-27-98	<b>STATE OF ILLINOIS DEPARTMENT OF TRANSPORTATION</b>	<b>PAVEMENT PATCHING FOR HMA SURFACED PAVEMENT</b>	F.A.P. RTE.	SECTION	COUNTY	TOTAL SHEETS	SHEET NO.
pw\11\084EBIDINTEG.illinois.gov\PWIDOT\Documents\DOT Offices\District 1\Projects\DI1121\DRAMA\Design\MOTIF	PLOT SCALE = 100.0000' / 1in.	CHECKED -	REVISED - R. BORO 01-01-07			335	2018-0146-1	MCHENRY	24	16
PLOT DATE = 2/1/2019	DATE - 10-25-94	REVISED - R. BORO 09-04-07	REVISED - K. ENG 10-27-08			<b>BD400-04 (BD-22)</b>		<b>CONTRACT NO. 62H76</b>		
						SCALE: NONE	SHEET NO. 1 OF 1 SHEETS	STA.	TO STA.	FED. ROAD DIST. NO. 1   ILLINOIS FED. AID PROJECT





- \* 3" (75) MINIMUM FROM TOP AND BOTTOM OF THE CONCRETE PAVEMENT OR BASE COURSE.
  - \*\* IF THE FINAL SURFACE OF THE PAVEMENT IS CONCRETE, THE GUTTER IS TO BE FLUSH WITH THE PAVEMENT.
- NOTE: ① SIDEWALK, DRIVEWAY PAVEMENT OR MEDIAN SURFACE SHALL BE SIMILAR TO THE MATERIAL BEING REMOVED AND WILL BE PAID FOR SEPARATELY.
- SODDING, SALT TOLERANT AND TOP SOIL, FURNISH AND PLACE 4" WILL BE PAID FOR SEPARATELY.
- ② FERTILIZER FOR THE PLACEMENT OF THE SOD IS NOT REQUIRED
  - ③ CURB OR CURB AND GUTTER REPLACEMENT SHALL MATCH THE SHAPE OF THE EXISTING CURB OR CURB AND GUTTER UNLESS OTHERWISE SPECIFIED.
  - ④ FOR CURB OR CURB AND GUTTER REMOVAL AND REPLACEMENT ADJACENT TO FLEXIBLE PAVEMENT DELETE EPOXY COATED TIE BARS.
  - ⑤ LONGITUDINAL BARS, IF ENCOUNTERED IN THE EXISTING CURB OR CURB AND GUTTER, ARE NOT TO BE REPLACED. CUTTING AND REMOVING LONGITUDINAL BARS SHALL BE INCLUDED IN THE COST OF CURB OR CURB AND GUTTER REMOVAL AND REPLACEMENT.
  - ⑥ THE COST OF HMA SURFACE REMOVAL IN THE EXISTING GUTTER FLAG SHALL BE INCLUDED IN THE COST OF THE CURB AND GUTTER REMOVAL AND REPLACEMENT.
  - ⑦ THE REMOVAL AND REPLACEMENT OF THE EXISTING CURB OR CURB AND GUTTER SHALL BE DONE IN ACCORDANCE WITH THE APPLICABLE PORTIONS OF SECTION 440 AND 606 OF THE STANDARD SPECIFICATIONS.
  - ⑧ THE LOCATIONS OF REMOVAL AND REPLACEMENT OF EXISTING CURB OR CURB AND GUTTER SHALL BE DETERMINED BY THE RESIDENT ENGINEER AT THE TIME OF CONSTRUCTION.

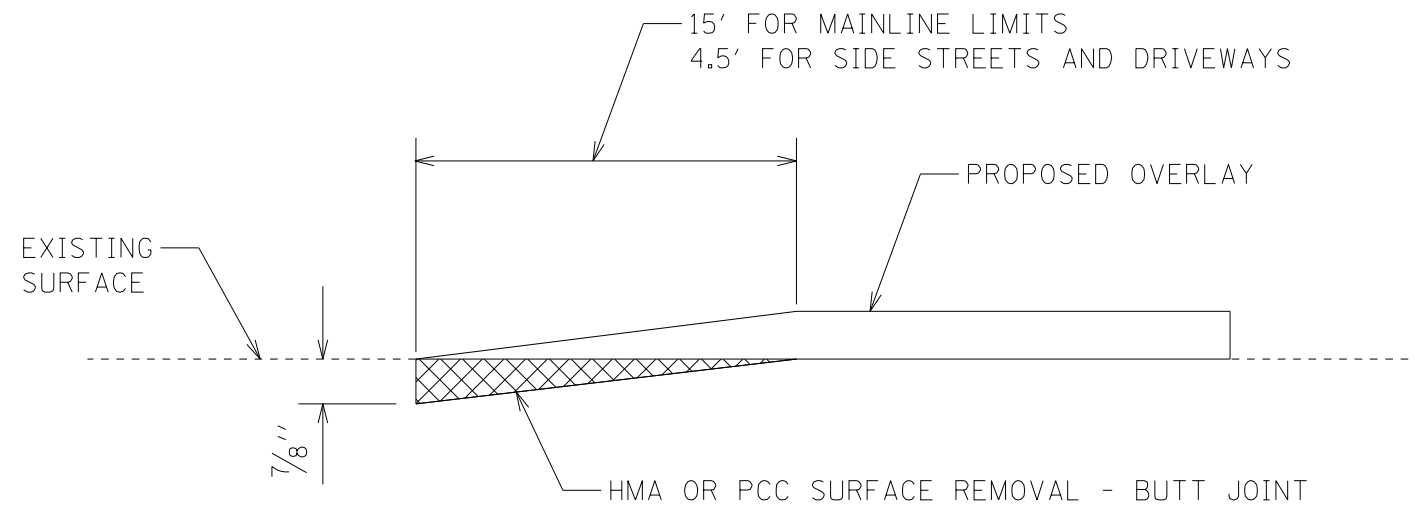
- PROPOSED 3/4" (20) PREFORMED EXPANSION JOINT AT CONCRETE SIDEWALKS, DRIVEWAYS, AND MEDIANS. (INCLUDED IN THE COST OF CURB OR CURB AND GUTTER REMOVAL AND REPLACEMENT.)
- UNSUITABLE SUB-BASE MATERIAL TO BE REMOVED, IF DIRECTED BY THE ENGINEER, SHALL BE REPLACED WITH EITHER SUB-BASE GRANULAR MATERIAL, TYPE B OR ADDITIONAL THICKNESS OF CONCRETE.
- REMOVAL AND REPLACEMENT 4" (100) OR LESS IS INCLUDED IN THE COST OF CURB OR CURB AND GUTTER REMOVAL AND REPLACEMENT.
- REMOVAL AND REPLACEMENT IN EXCESS OF 4" (100) WILL BE PAID FOR IN ACCORDANCE WITH ARTICLE 109.04 OF THE STANDARD SPECIFICATIONS.
- PROPOSED #6 (20) EPOXY COATED TIE BARS 24" (600) LONG AT 24" (600) CENTERS WILL NOT BE PAID FOR SEPARATELY. DELETE EPOXY COATED TIE BARS IF EXISTING TIE BARS ARE USABLE AS DETERMINED BY THE ENGINEER. (SEE NOTE ③).

**BASIS OF PAYMENT:**  
 THIS WORK WILL BE PAID FOR AT THE CONTRACT UNIT PRICE PER FOOT (METER) FOR "CURB REMOVAL AND REPLACEMENT" OR "COMBINATION CONCRETE CURB AND GUTTER REMOVAL AND REPLACEMENT".

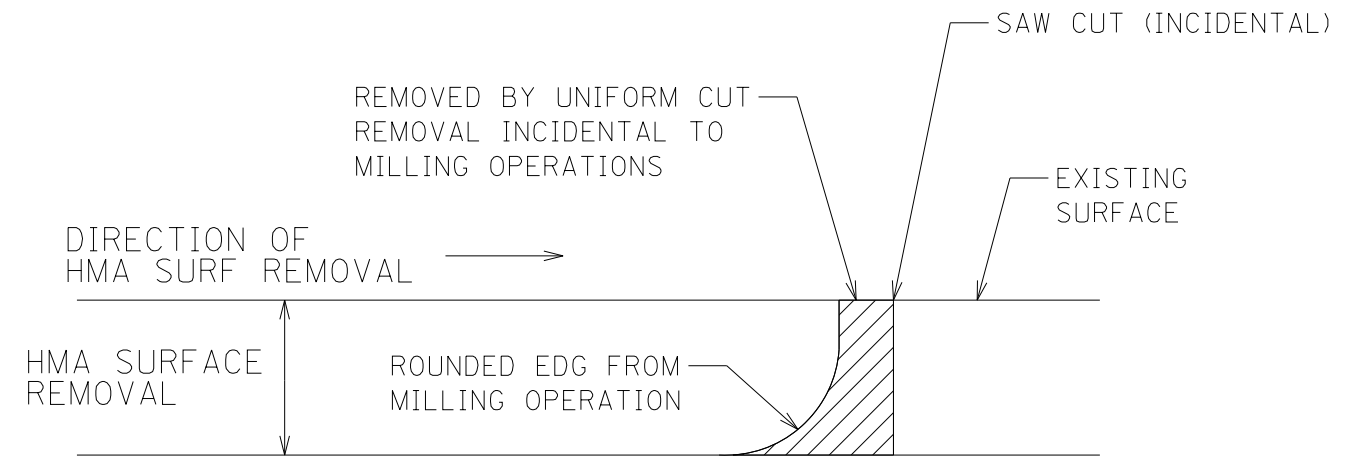
# CURB OR CURB AND GUTTER REMOVAL AND REPLACEMENT

ALL DIMENSIONS ARE IN INCHES (MILLIMETERS) UNLESS OTHERWISE SHOWN.

FILE NAME =	USER NAME = nafakhaj	DESIGNED - A. HOUSEH	REVISED - R. SHAH 10-03-96	<b>STATE OF ILLINOIS DEPARTMENT OF TRANSPORTATION</b>	<b>CURB OR CURB AND GUTTER REMOVAL AND REPLACEMENT</b>	F.A.P. RTE.	SECTION	COUNTY	TOTAL SHEETS	SHEET NO.	
			REVISED - A. ABBAS 03-21-97			335	2018-0146-1	MCHENRY	24	17	
			REVISED - M. GOMEZ 01-22-01			<b>BD600-06 (BD-24)</b>					
			REVISED - R. BORO 12-15-09			CONTRACT NO. 62H76					
				SCALE: NONE		SHEET NO. 1 OF 1 SHEETS		STA.		TO STA.	



**BUTT JOINT TAPER DETAIL**



NOTE: WHEN MILLING OPERATION PRODUCE A ROUNDED EDGE, THEN SAW CUT SHALL BE USED TO MANUFACTURE A PERPENDICULAR EDGE AS SHOWN IN THE DETAIL. THE ENGINEER SHALL BE THE SOLE JUDGE CONCERNING THE USE OF THIS DETAIL

**HMA DETAIL AT BUTT JOINTS**

MODEL: Default  
 FILE: hma19c\_pavementroom.dwg  
 PROJECT: RWIDOT\Documents\DOT\_Offices\District\_1\Projects\111219\CaddData\Design\MOTIF

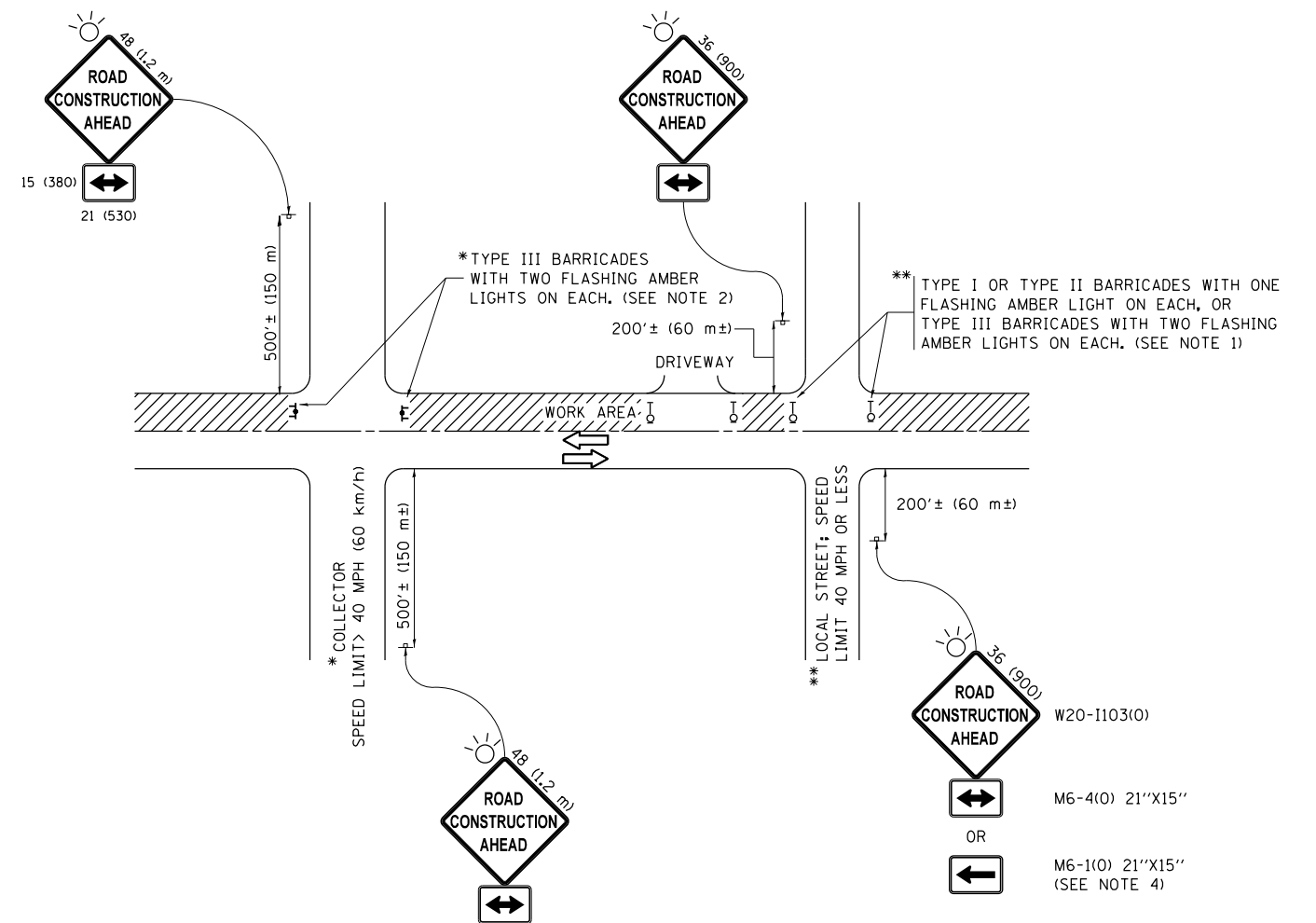
USER NAME = nafakha	DESIGNED -	REVISED - AJN 3/15/2019
	DRAWN -	REVISED -
PLOT SCALE = 100.0000' / in.	CHECKED -	REVISED -
PLOT DATE = 3/15/2019	DATE -	REVISED -

**STATE OF ILLINOIS  
 DEPARTMENT OF TRANSPORTATION**

**BUTT JOINT AND HMA TAPER DETAILS**

SCALE: SHEET OF SHEETS STA. TO STA.

F.A.P. RTE.	SECTION	COUNTY	TOTAL SHEETS	SHEET NO.
335	2018-0146-1	MCHENRY	24	18
ILLINOIS FED. AID PROJECT			CONTRACT NO. 62H76	



**NOTES:**

1. SIDE ROAD WITH A SPEED LIMIT OF 40 MPH (60 km/h) OR LESS AS SHOWN ON THE DRAWING AND AS DIRECTED BY THE ENGINEER:
  - a) ONE "ROAD CONSTRUCTION AHEAD" SIGN 36 x 36 (900x900) WITH A FLASHER MOUNTED ON IT APPROXIMATELY 200' (60 m) IN ADVANCE OF THE MAIN ROUTE.
  - b) THE CLOSED PORTION OF THE MAIN ROUTE SHALL BE PROTECTED BY BLOCKING WITH TYPE I, TYPE II OR TYPE III BARRICADES, 1/3 OF THE CROSS SECTION OF THE CLOSED PORTION.
2. SIDE ROAD WITH A SPEED LIMIT GREATER THAN 40 MPH (60 km/h) AS SHOWN ON THE DRAWING AND AS DIRECTED BY THE ENGINEER:
  - a) ONE "ROAD CONSTRUCTION AHEAD" SIGN 48 x 48 (1.2 m x 1.2 m) WITH A FLASHER MOUNTED ON IT APPROXIMATELY 500' (150 m) IN ADVANCE OF THE MAIN ROUTE.
  - b) THE CLOSED PORTION OF THE MAIN ROUTE SHALL BE PROTECTED BY BLOCKING WITH TYPE III BARRICADES, 1/2 OF THE CROSS SECTION OF THE CLOSED PORTION.
3. CONES MAY BE SUBSTITUTED FOR BARRICADES OR DRUMS AT HALF THE SPACING DURING DAY OPERATIONS. CONES SHALL BE A MINIMUM OF 28 (710) IN HEIGHT.
4. WHEN THE SIDE ROAD LIES BETWEEN THE BEGINNING OF THE MAINLINE SIGNING AND THE WORK ZONE, A SINGLE HEADED ARROW (M6-1) SHALL BE USED IN LIEU OF THE DOUBLE HEADED ARROW (M6-4).
5. WHEN WORK IS BEING PERFORMED ON A SIDE ROAD OR DRIVEWAY, FOLLOW THE APPLICABLE STANDARD(S). THE DIRECTIONAL ARROW (M6-1 OR M6-4) SHALL BE COVERED OR REMOVED WHEN NO LONGER CONSISTENT WITH THE TRAFFIC CONTROL SET-UP.
6. ADVANCE WARNING SIGNS ARE TO BE OMITTED ON DRIVEWAYS UNLESS OTHERWISE SPECIFIED IN THE PLANS OR BY THE ENGINEER.
7. THE TRAFFIC CONTROL AND PROTECTION FOR SIDE ROADS, INTERSECTIONS, AND DRIVEWAYS SHALL BE INCLUDED IN THE COST OF SPECIFIED TRAFFIC CONTROL STANDARDS OR ITEMS.

All dimensions are in inches (millimeters) unless otherwise shown.

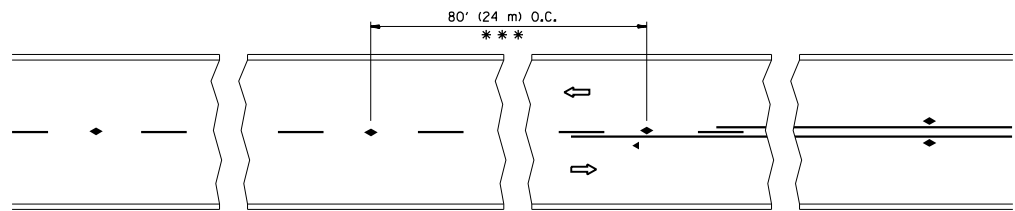
FILE NAME =	USER NAME = nafakhaj	DESIGNED - L.H.A.	REVISED - A. HOUSEH 10-15-96
pw:\IL\084EBIDINTEG\Illinois.gov\PWIDOT\Documents\IDOT Offices\District 1\Projects\DI1121\DRAMA\Design\MOTIF			REVISED - T. RAMMACHER 01-06-00
Default	PLOT SCALE = 100.0000' / in.	CHECKED -	REVISED - A. SCHUETZE 07-01-13
	PLOT DATE = 2/1/2019	DATE - 06-89	REVISED - A. SCHUETZE 09-15-16

**STATE OF ILLINOIS  
DEPARTMENT OF TRANSPORTATION**

**TRAFFIC CONTROL AND PROTECTION FOR  
SIDE ROADS, INTERSECTIONS, AND DRIVEWAYS**

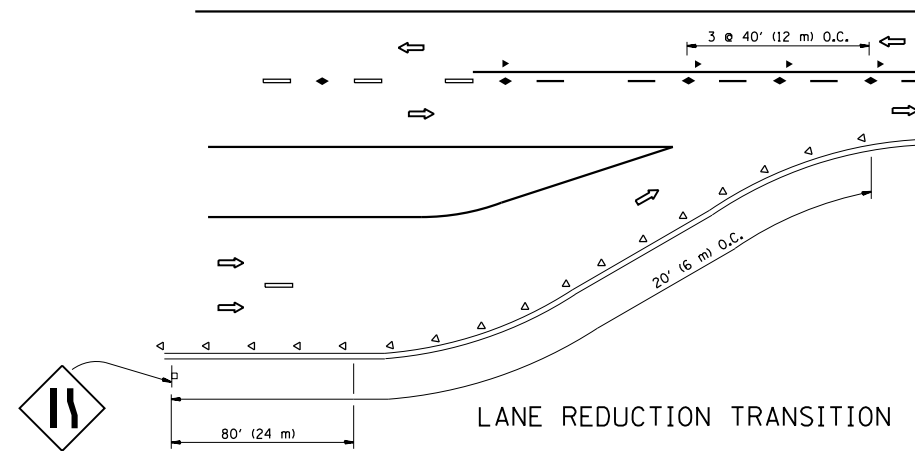
SCALE: NONE SHEET 1 OF 1 SHEETS STA. TO STA.

F.A.P. RTE.	SECTION	COUNTY	TOTAL SHEETS	SHEET NO.
335	2018-0146-1	MCHENRY	24	19
<b>TC-10</b>			<b>CONTRACT NO. 62H76</b>	
ILLINOIS FED. AID PROJECT				

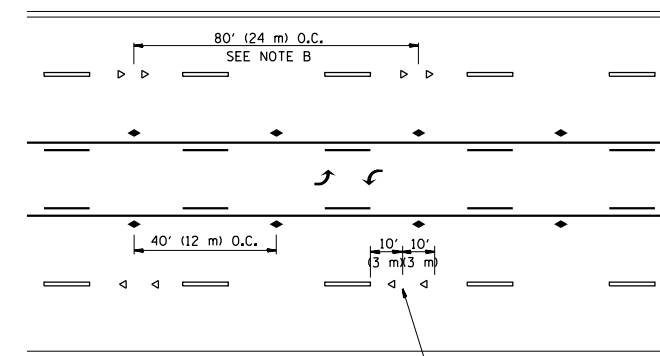


\*\*\* REDUCE TO 40' (12 m) O.C. ON CURVES WITH POSTED OR ADVISORY SPEED 45 M.P.H. (70 km/h) OR LESS.

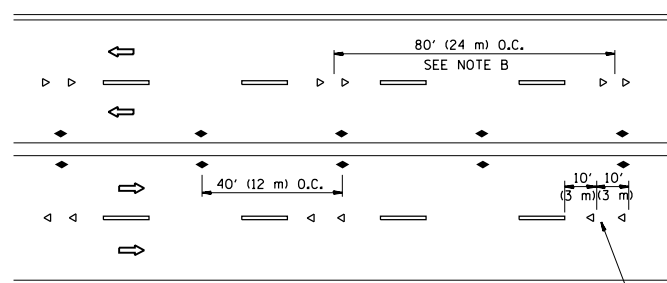
TWO-LANE/TWO-WAY



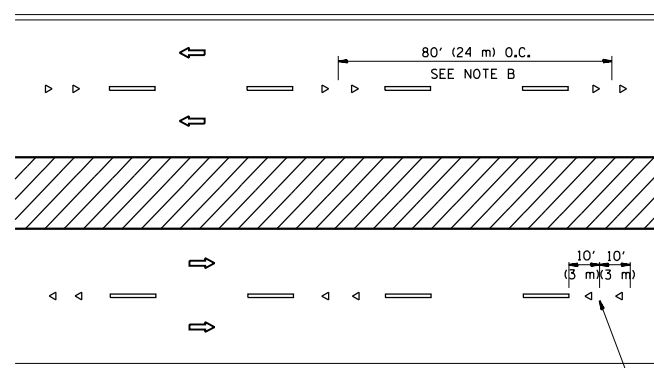
LANE REDUCTION TRANSITION



TWO-WAY LEFT TURN



MULTI-LANE/UNDIVIDED



MULTI-LANE/DIVIDED

GENERAL NOTES

1. MARKERS USED WITH DASHED LINES SHALL BE CENTERED IN THE GAP BETWEEN SEGMENTS.
2. MARKERS USED ADJACENT TO SOLID LINES SHALL BE OFFSET 2 TO 3 (50 TO 75) TOWARD TRAFFIC AS SHOWN.
3. MARKERS THROUGH TANGENTS LESS THAN 500' (150 m) IN LENGTH BETWEEN CURVES SHALL BE INSTALLED AT THE LESSER OF THE TWO CURVE SPACINGS.

SYMBOLS

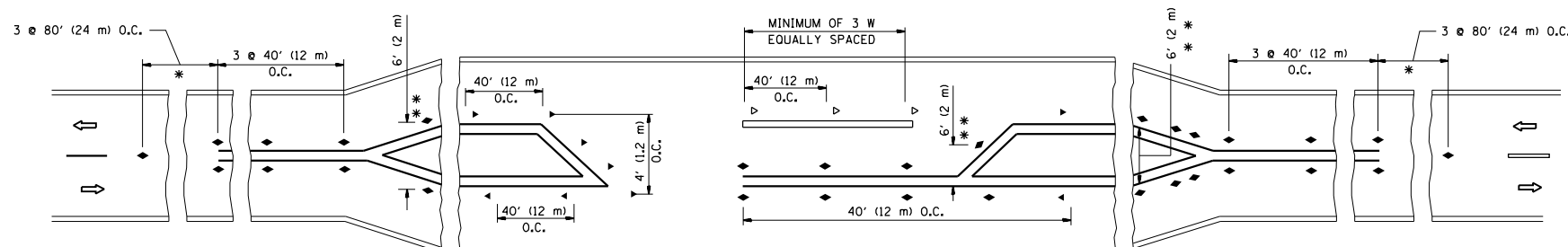
- YELLOW STRIPE
- WHITE STRIPE
- ◀ ONE-WAY AMBER MARKER
- ◀ ONE-WAY CRYSTAL MARKER (W/O)
- ◆ TWO-WAY AMBER MARKER

LANE MARKER NOTES

- A. USE DOUBLE LANE LINE MARKERS SPACED AS SHOWN.
- B. REDUCE TO 40' (12 m) O.C. ON CURVES WHERE ADVISORY SPEEDS ARE 10 M.P.H. (20 km/h) LOWER THAN POSTED SPEEDS.

DESIGN NOTES

1. DOUBLE LANE LINE MARKERS SHALL BE USED UNLESS SPECIFIED OTHERWISE.
2. EXCEPT AS SHOWN ON THE LANE REDUCTION TRANSITION AND FREEWAY EXIT RAMP DETAIL, MARKERS ARE NOT TO BE SPECIFIED ON RIGHT EDGE LINES.
3. THE EXACT MARKER LIMITS, SPACING, AND COLOR SHALL BE INCLUDED IN THE PLANS WHEN STANDARD SPECIFICATIONS ARE NOT BEING USED.
4. MARKERS SHOULD NOT BE USED ALONGSIDE CURBS EXCEPT FOR EXTREMELY SHORT SECTIONS OF CURBS WHERE NOT MORE THAN TWO MARKERS WOULD BE INVOLVED.



\* SEE TWO-LANE/TWO-WAY WHERE MARKERS CONTINUE  
 \*\* WHERE THE MEDIAN WIDTH IS 6' (2 m) OR LESS USE TWO-WAY MARKERS.

LEFT TURN

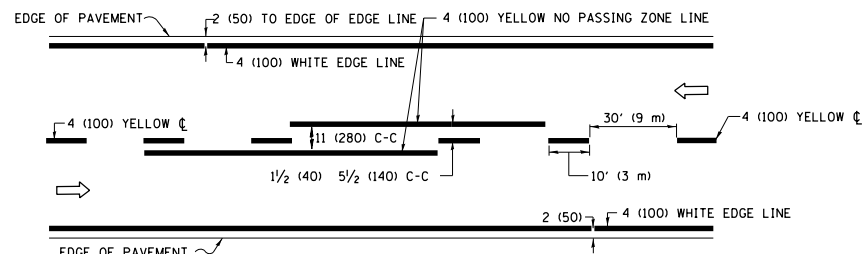
All dimensions are in inches (millimeters) unless otherwise shown.

FILE NAME =	USER NAME = nafakhaj	DESIGNED -	REVISED - T. RAMMACHER 09-19-94
pw:\11\084EBIDINTEG\illinois.gov\PWIDOT\Documents\IDOT Offices\District 1\Projects\DI1121\DRAMA\Design\MOTIF		CHECKED -	REVISED - T. RAMMACHER 03-12-99
		DATE -	REVISED - T. RAMMACHER 01-06-00
			REVISED - C. JUCIUS 09-09-09

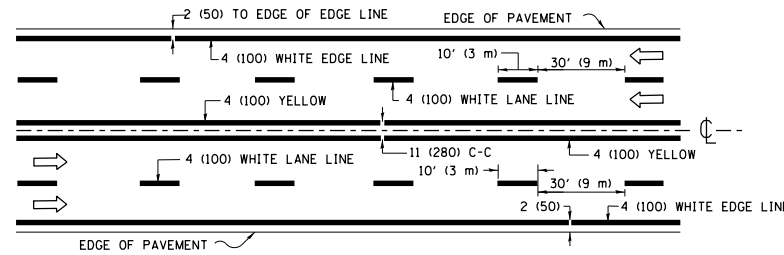
STATE OF ILLINOIS  
DEPARTMENT OF TRANSPORTATION

TYPICAL APPLICATIONS			
RAISED REFLECTIVE PAVEMENT MARKERS (SNOW-PLOW RESISTANT)			
SCALE: NONE	SHEET NO. 1 OF 1 SHEETS	STA.	TO STA.

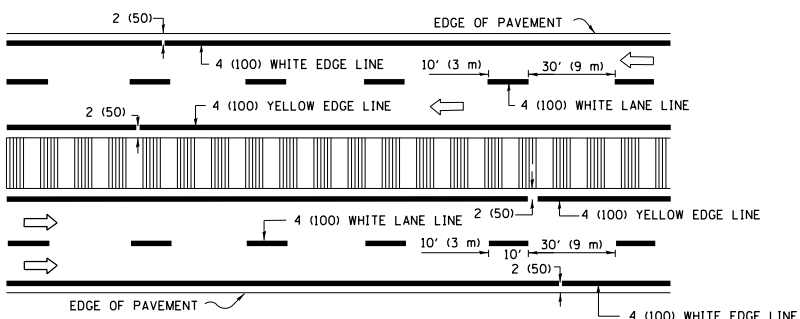
F.A.P. RTE.	SECTION	COUNTY	TOTAL SHEETS	SHEET NO.
335	2018-0146-1	MCHENRY	24	20
TC-11		CONTRACT NO. 62H76		
FED. ROAD DIST. NO. 1 ILLINOIS FED. AID PROJECT				



**2-LANE ROADWAY**

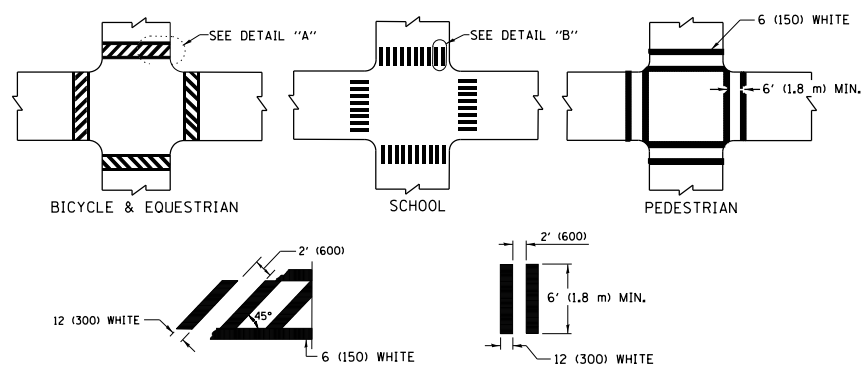


**MULTI-LANE UNDIVIDED**



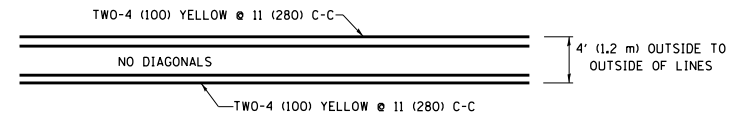
**MULTI-LANE DIVIDED WITH MEDIAN**

**TYPICAL LANE AND EDGE LINE MARKING**

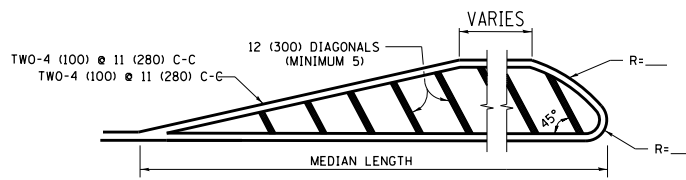


**TYPICAL CROSSWALK MARKING**

\* MARKINGS SHALL BE INSTALLED PARALLEL TO THE CENTERLINE OF THE ROAD WHICH IT CROSSES

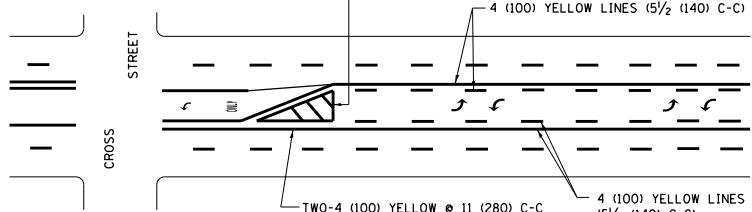


**4' (1.2 m) WIDE MEDIANS ONLY**



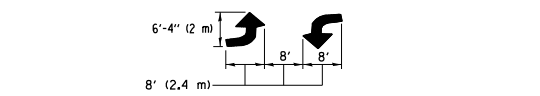
**MEDIANS OVER 4' (1.2 m) WIDE**

DIAGONAL LINE SPACING: 50' (15 m) C-C (LESS THAN 30MPH (50 km/h))  
75' (25 m) C-C 30MPH (50 km/h) TO 45MPH (70 km/h)  
150' (45 m) C-C (MORE THAN 45MPH (70 km/h))



**MEDIAN WITH TWO-WAY LEFT TURN LANE TYPICAL PAINTED MEDIAN MARKING**

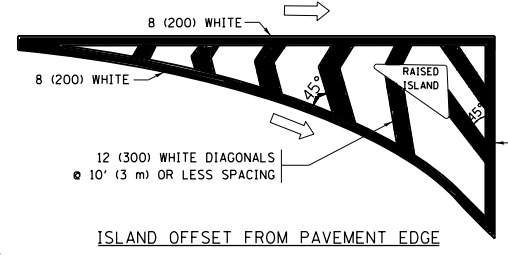
A MINIMUM OF TWO PAIRS OF TURN ARROWS SHALL BE USED, WHITE IN COLOR. ADDITIONAL PAIRS SHALL BE PLACED AT 200' (60 m) TO 300' (90 m) INTERVALS.



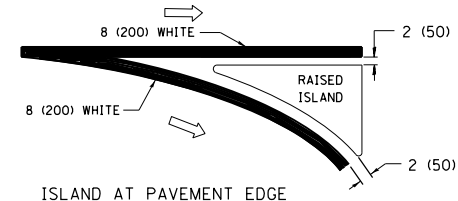
**TYPICAL LEFT (OR RIGHT) TURN LANE**

**TYPICAL TURN LANE MARKING**

FULL SIZE LETTERS 8" (2.4 m) AND ARROWS SHALL BE USED.  
AREA = 15.6 SQ. FT. (1.5 m<sup>2</sup>) ONLY AREA = 20.8 SQ. FT. (1.9 m<sup>2</sup>)  
\* TURN LANES IN EXCESS OF 400' (120 m) IN LENGTH MAY HAVE AN ADDITIONAL SET OF ARROW - "ONLY" INSTALLED MIDWAY BETWEEN THE OTHER TWO SETS OF ARROW - "ONLY".

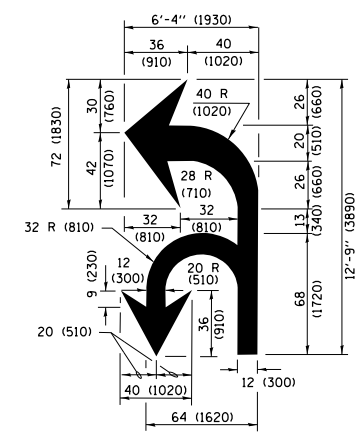


**ISLAND OFFSET FROM PAVEMENT EDGE**

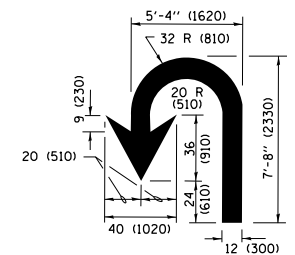


**ISLAND AT PAVEMENT EDGE**

**TYPICAL ISLAND MARKING**



**COMBINATION LEFT AND U-TURN**



**U-TURN**

**LANE REDUCTION TRANSITION**

\* LANE REDUCTION ARROWS REQUIRED AT SPEEDS OF 45 MPH OR GREATER OR WHEN SPECIFIED IN PLANS.

D(FT)	SPEED LIMIT
345	30
425	35
500	40
580	45
665	50
750	55

TYPE OF MARKING	WIDTH OF LINE	PATTERN	COLOR	SPACING /REMARKS
CENTERLINE ON 2 LANE PAVEMENT	4 (100)	SKIP-DASH	YELLOW	10' (3 m) LINE WITH 30' (9 m) SPACE
CENTERLINE ON MULTI-LANE UNDIVIDED PAVEMENT	2 @ 4 (100)	SOLID	YELLOW	11 (280) C-C
NO PASSING ZONE LINES FOR ONE DIRECTION FOR BOTH DIRECTIONS	4 (100) 2 @ 4 (100)	SOLID SOLID	YELLOW YELLOW	5/2 (140) C-C FROM SKIP-DASH CENTERLINE 11 (280) C-C OMIT SKIP-DASH CENTERLINE BETWEEN
LANE LINES	4 (100) 5 (125) ON FREEWAYS	SKIP-DASH SKIP-DASH	WHITE WHITE	10' (3 m) LINE WITH 30' (9 m) SPACE
DOTTED LINES (EXTENSIONS OF CENTER, LANE OR TURN LANE MARKINGS)	SAME AS LINE BEING EXTENDED	SKIP-DASH	SAME AS LINE BEING EXTENDED	2' (600) LINE WITH 6' (1.8 m) SPACE
EDGE LINES	4 (100)	SOLID	YELLOW-LEFT WHITE-RIGHT	OUTLINE MEDIANS IN YELLOW
TURN LANE MARKINGS	6 (150) LINE; FULL SIZE LETTERS & SYMBOLS (8' (2.4m))	SOLID	WHITE	SEE TYPICAL TURN LANE MARKING DETAIL
TWO WAY LEFT TURN MARKING	2 @ 4 (100) EACH DIRECTION 8' (2.4m) LEFT ARROW	SKIP-DASH AND SOLID IN PAIRS	YELLOW WHITE	10' (3 m) LINE WITH 30' (9 m) SPACE FOR SKIP-DASH; 5/2 (140) C-C BETWEEN SOLID LINE AND SKIP-DASH LINE SEE TYPICAL TWO-WAY LEFT TURN MARKING DETAIL
CROSSWALK LINES (PEDESTRIAN) A. DIAGONALS (BIKE & EQUESTRIAN) B. LONGITUDINAL BARS (SCHOOL)	2 @ 6 (150) 12 (300) @ 45° 12 (300) @ 90°	SOLID SOLID SOLID	WHITE WHITE WHITE	NOT LESS THAN 6' (1.8 m) APART 2' (600) APART 2' (600) APART SEE TYPICAL CROSSWALK MARKING DETAILS.
STOP LINES	24 (600)	SOLID	WHITE	PLACE 4' (1.2 m) IN ADVANCE OF AND PARALLEL TO CROSSWALK, IF PRESENT, OTHERWISE, PLACE AT DESIRED STOPPING POINT, PARALLEL TO CROSSROAD CENTERLINE, WHERE POSSIBLE.
PAINTED MEDIANS	2 @ 4 (100) WITH 12 (300) DIAGONALS @ 45° NO DIAGONALS USED FOR 4' (1.2 m) WIDE MEDIANS	SOLID	YELLOW; TWO WAY TRAFFIC WHITE; ONE WAY TRAFFIC	11 (280) C-C FOR THE DOUBLE LINE SEE TYPICAL PAINTED MEDIAN MARKING.
GORE MARKING AND CHANNELIZING LINES	8 (200) WITH 12 (300) DIAGONALS @ 45°	SOLID	WHITE	DIAGONALS: 15' (4.5 m) C-C (LESS THAN 30MPH (50 km/h)) 20' (6 m) C-C 30MPH (50 km/h) TO 45MPH (70 km/h) 30' (9 m) C-C (OVER 45MPH (70 km/h))
RAILROAD CROSSING	24 (600) TRANSVERSE LINES; "RR" IS 6' (1.8 m) LETTERS; 16 (400) LINE FOR "X"	SOLID	WHITE	SEE STATE STANDARD 780001 AREA OF: "R"=3.6 SQ. FT. (0.33 m <sup>2</sup> ) EACH "X"=54.0 SQ. FT. (5.0 m <sup>2</sup> )
SHOULDER DIAGONALS (REQUIRED FOR SHOULDERS ≥ 8')	12 (300) @ 45°	SOLID	WHITE - RIGHT YELLOW - LEFT	50' (15 m) C-C (LESS THAN 30MPH (50 km/h)) 75' (25 m) C-C 30 MPH (50 km/h) TO 45MPH (70 km/h) 150' (45 m) C-C (OVER 45MPH (70 km/h))
U TURN ARROW	SEE DETAIL	SOLID	WHITE	16.3 SF
2 ARROW COMBINATION LEFT AND U TURN	SEE DETAIL	SOLID	WHITE	30.4 SF

FOR FURTHER DETAILS ON PAVEMENT MARKING REFER TO STANDARD SPECIFICATIONS FOR ROAD AND BRIDGE CONSTRUCTION AND STATE STANDARD 780001.

All dimensions are in inches (millimeters) unless otherwise shown.

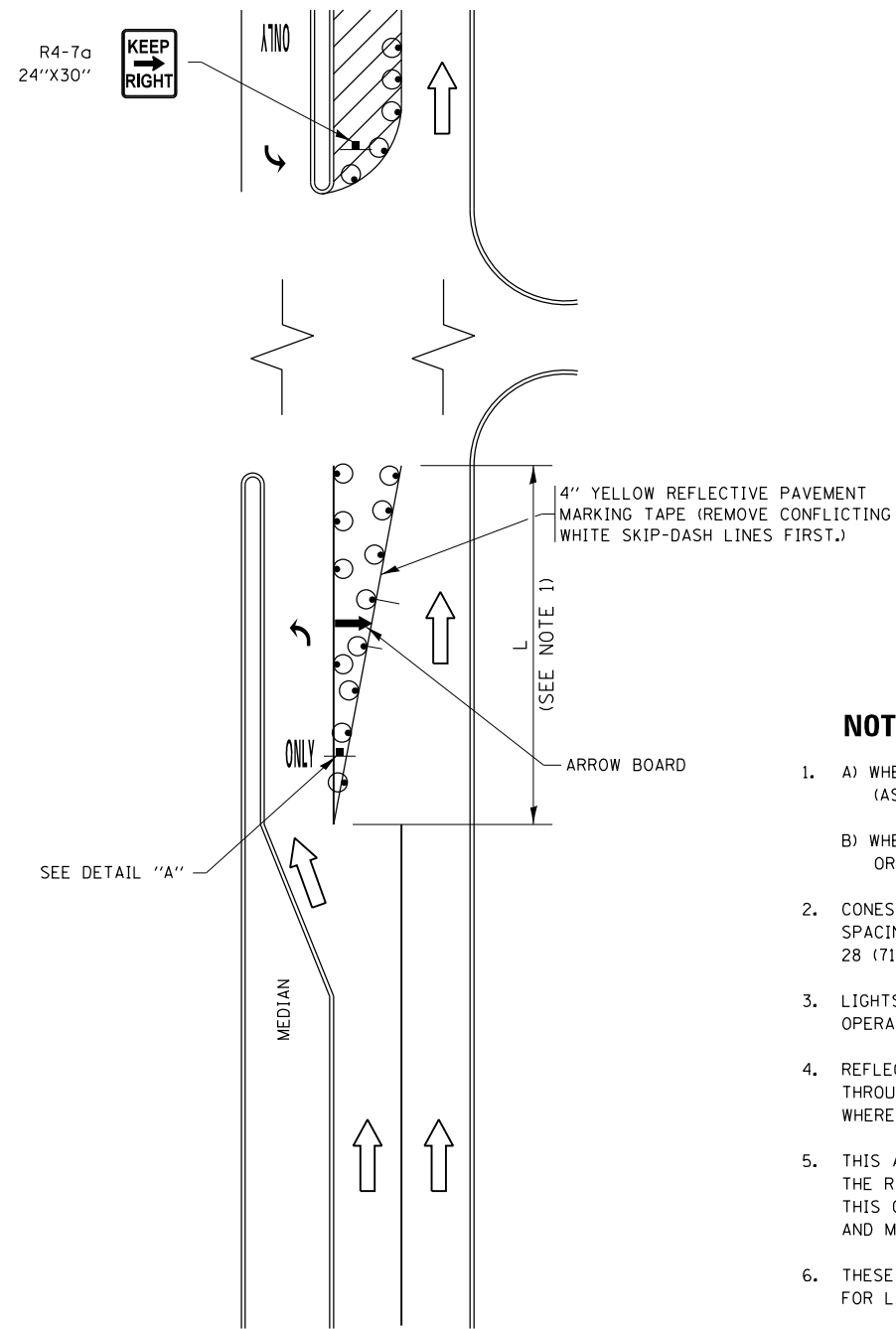
FILE NAME =	USER NAME = nafakha	DESIGNED - EVERS	REVISED - C. JUCIUS 09-09-09
pw\1\084EBIDINTEG\illinois.gov\PIWIDOT\Documents\DOT Offices\District 1\Projects\011212\DRAMA\Design\MOTIF		CHECKED -	REVISED - C. JUCIUS 07-01-13
Default	PLOT SCALE = 100.0000' / in.	DATE - 03-19-90	REVISED - C. JUCIUS 12-21-15
	PLOT DATE = 2/1/2019		REVISED - C. JUCIUS 04-12-16

**STATE OF ILLINOIS DEPARTMENT OF TRANSPORTATION**

<b>DISTRICT ONE TYPICAL PAVEMENT MARKINGS</b>			
SCALE: NONE	SHEET 1	OF 1 SHEETS	STA. TO STA.

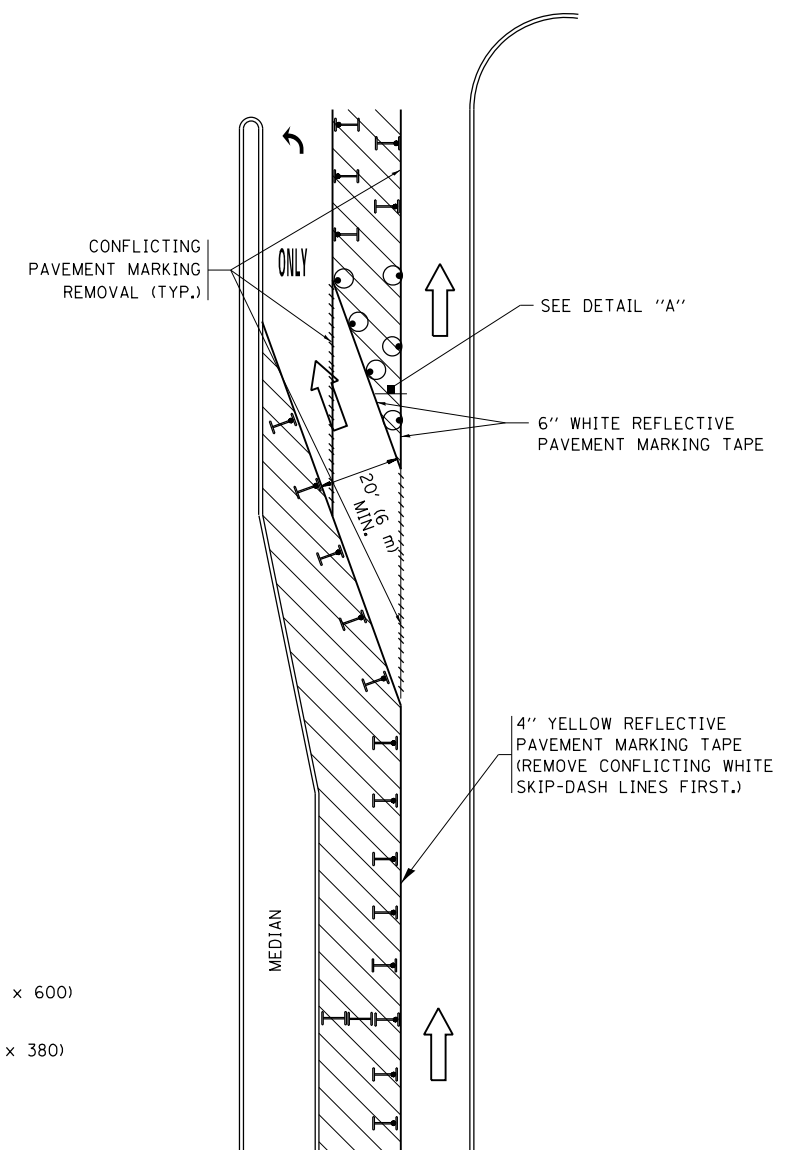
F.A.P. RTE.	SECTION	COUNTY	TOTAL SHEETS	SHEET NO.
335	2018-0146-1	MCHENRY	24	21
<b>TC-13</b>		<b>CONTRACT NO. 62H76</b>	ILLINOIS FED. AID PROJECT	

# TURN BAY ENTRANCE AT START OF LANE CLOSURE TAPER

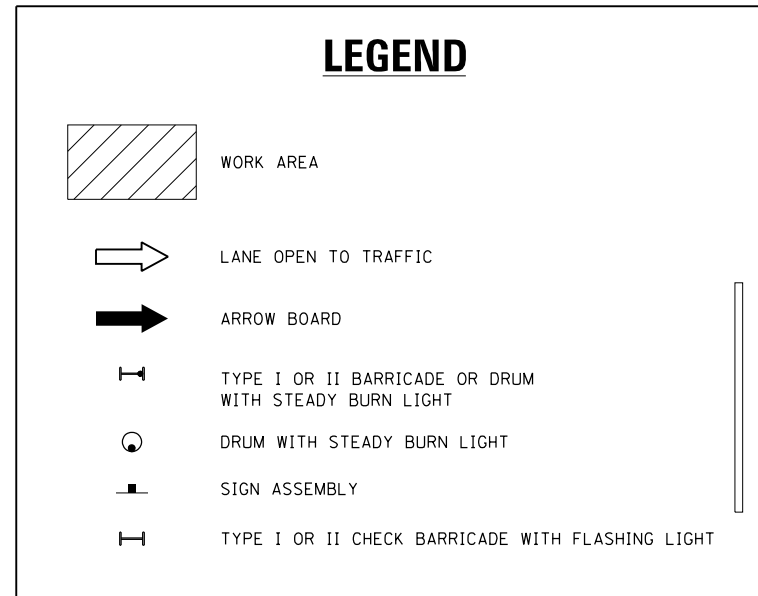


**FIGURE 1**

# TURN BAY ENTRANCE WITHIN A LANE CLOSURE

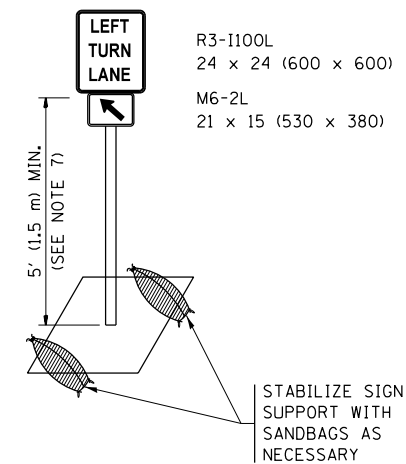


**FIGURE 2**



### NOTES:

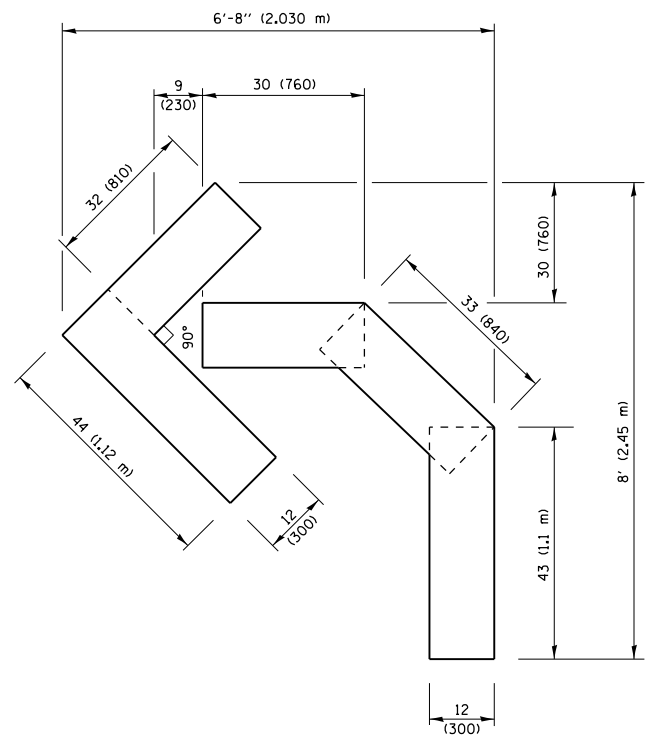
1. A) WHEN "L" IS  $\leq$  THE STORAGE LENGTH OF THE TURN LANE (AS SHOWN IN FIG. 1), USE FIGURE 1.  
B) WHEN "L" IS  $>$  THE STORAGE LENGTH OF THE TURN LANE OR THE TURN LANE IS WITHIN THE LANE CLOSURE, USE FIGURE 2.
2. CONES MAY BE SUBSTITUTED FOR BARRICADES OR DRUMS AT HALF THE SPACING DURING DAY OPERATIONS. CONES SHALL BE A MINIMUM OF 28 (710) IN HEIGHT.
3. LIGHTS WILL NOT BE REQUIRED ON BARRICADES OR DRUMS FOR DAY OPERATIONS. ALL LIGHTS SHALL BE MONODIRECTIONAL.
4. REFLECTIVE TEMPORARY PAVEMENT MARKINGS SHALL BE PLACED THROUGHOUT THE BARRICADED AREAS OF EACH TURN BAY AS SHOWN WHERE THE CLOSURE TIME IS GREATER THAN FOURTEEN (14) DAYS.
5. THIS APPLICATION ALSO APPLIES WHEN WORK IS BEING PERFORMED IN THE RIGHT LANE(S) AND THE RIGHT TURN BAY IS TO REMAIN OPEN. UNDER THIS CONDITION, "RIGHT TURN LANE" R3-1100R 24 x 24 (600 x 600) AND M6-2R 21 x 15 (530 x 380) SHALL BE USED.
6. THESE CONTROLS SHALL SUPPLEMENT MAINLINE TRAFFIC CONTROL FOR LANE CLOSURES.
7. THE SIGNS SHALL BE MOUNTED ABOVE THE BARRICADES/DRUMS ON SEPARATE SIGN SUPPORTS THAT MEET NCHRP 350 OR MASH PREQUIREMENTS.
8. TRAFFIC CONTROL AND PROTECTION AT TURN BAYS (TO REMAIN OPEN TO TRAFFIC) SHALL BE INCLUDED IN THE COST OF SPECIFIED TRAFFIC CONTROL STANDARDS OR ITEMS.



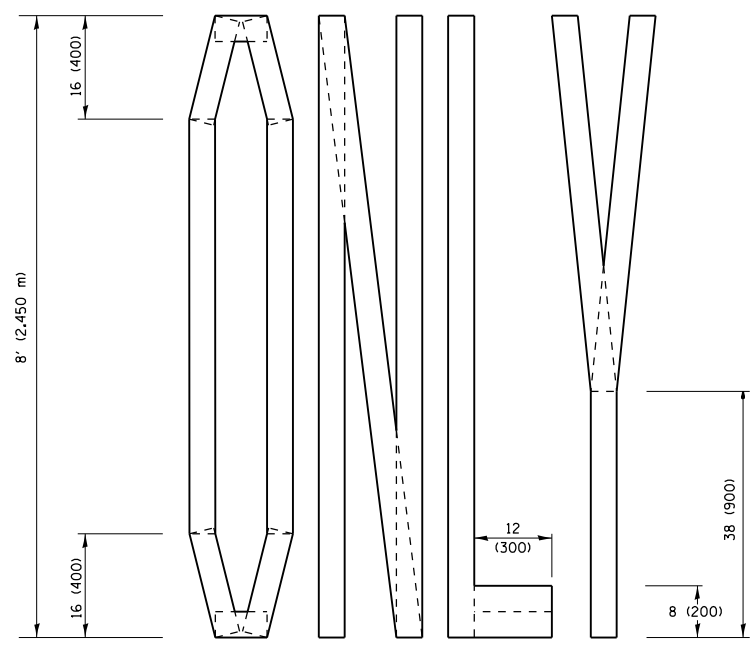
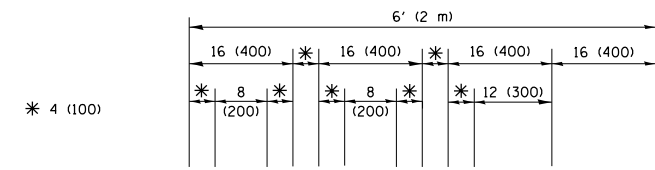
**DETAIL A**

All dimensions are in inches (millimeters) unless otherwise shown.

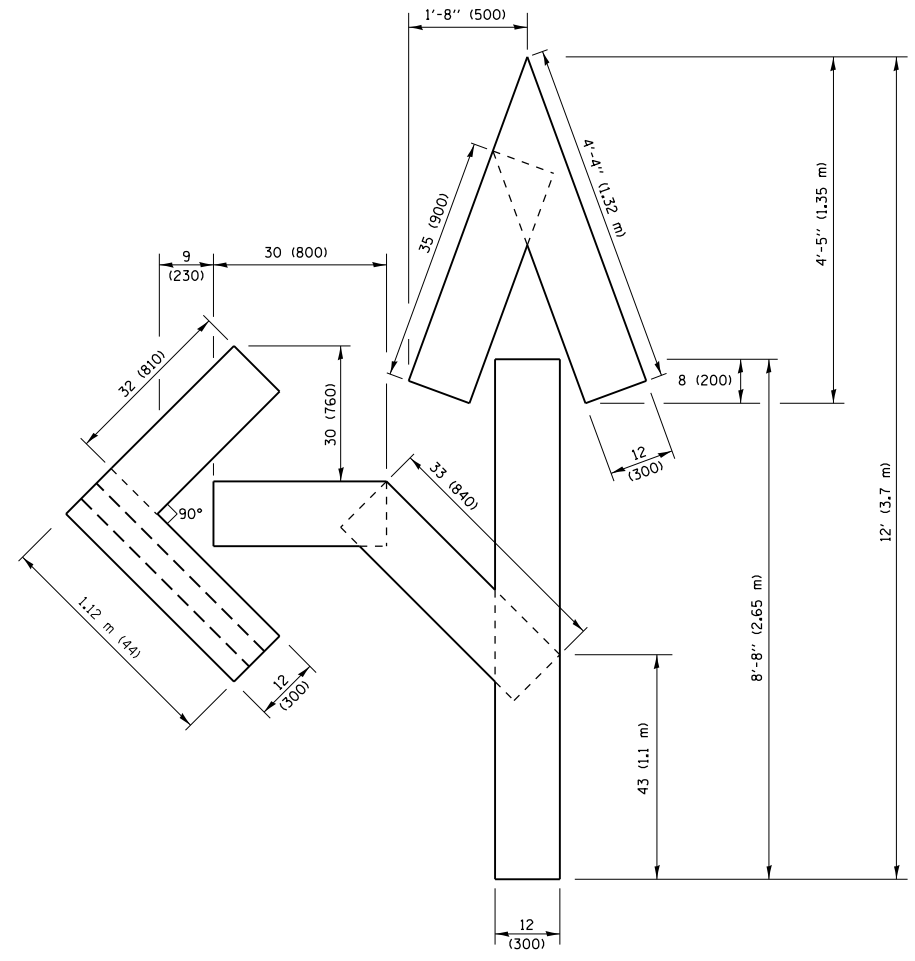
FILE NAME =	USER NAME = nafakha	REVISED - T. RAMMACHER 09-08-94	REVISED - R. BORO 09-14-09	<b>STATE OF ILLINOIS DEPARTMENT OF TRANSPORTATION</b>	<b>TRAFFIC CONTROL AND PROTECTION AT TURN BAYS (TO REMAIN OPEN TO TRAFFIC)</b>	F.A.P. R.T.E.	SECTION	COUNTY	TOTAL SHEETS	SHEET NO.
pw\1\084EBIDINTEG.illinois.gov\PIDOT\Documents\DOT Offices\District 1\Projects\DI1121\REVISED\Design\THOUSEH 11-07-95	REVISED - A. HOUSEH 11-07-95	REVISED - A. SCHUETZE 07-01-13	REVISED - A. SCHUETZE 07-01-13			335	2018-0146-1	MCHENRY	24	22
Default	PLOT SCALE = 100.0000' / in.	REVISED - A. HOUSEH 10-12-96	REVISED - A. SCHUETZE 09-15-16			<b>TC-14</b>		<b>CONTRACT NO. 62H76</b>		ILLINOIS FED. AID PROJECT
	PLOT DATE = 2/1/2019	REVISED - T. RAMMACHER 01-06-00	REVISED -	SCALE: NONE	SHEET 1 OF 1 SHEETS	STA.	TO STA.			



**QUANTITY**  
 4 (100) LINE = 45.5 ft. (13.9 m)  
 15.2 sq. ft. (1.41 sq. m)

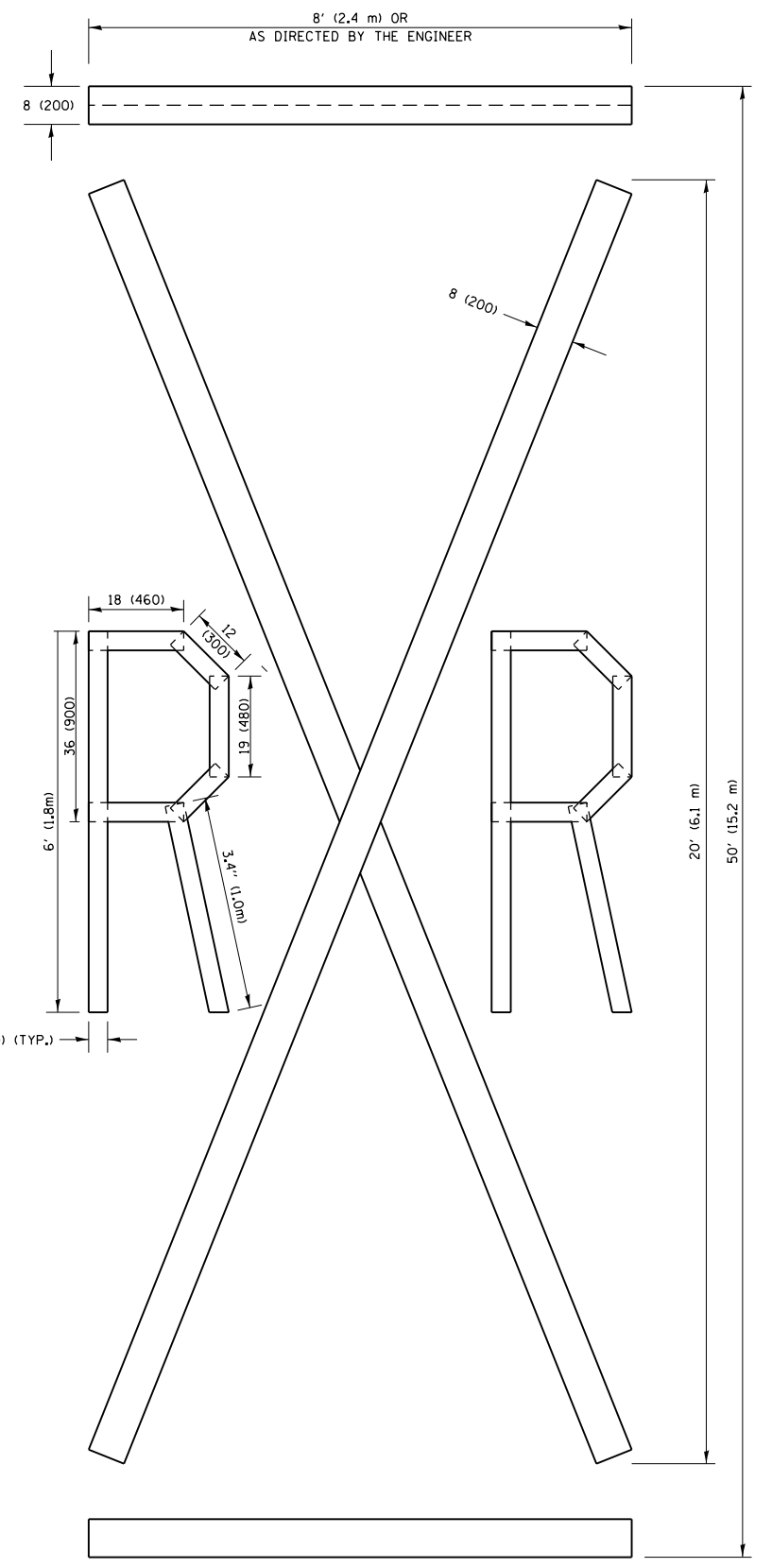


**QUANTITY**  
 4 (100) LINE = 64.1 ft. (19.5 m)  
 21.4 sq. ft. (1.99 sq. m)



**QUANTITY**  
 4 (100) LINE = 82.5 ft. (25.1 m)  
 27.5 sq. ft. (2.53 sq. m)

**NOTE:**  
 ALL QUANTITIES OF PLACEMENT ARE REPRESENTED IN LINEAR FEET OF 4" LINES TO MATCH THE 4" TEMPORARY TAPE PAY ITEM AND REPRESENTS THE TOTAL QUANTITY OF 4" TAPE REQUIRED.



**QUANTITY**  
 4 (100) LINE = 225.9 ft. (68.9 m)  
 75.3 sq. ft. (6.99 sq. m)

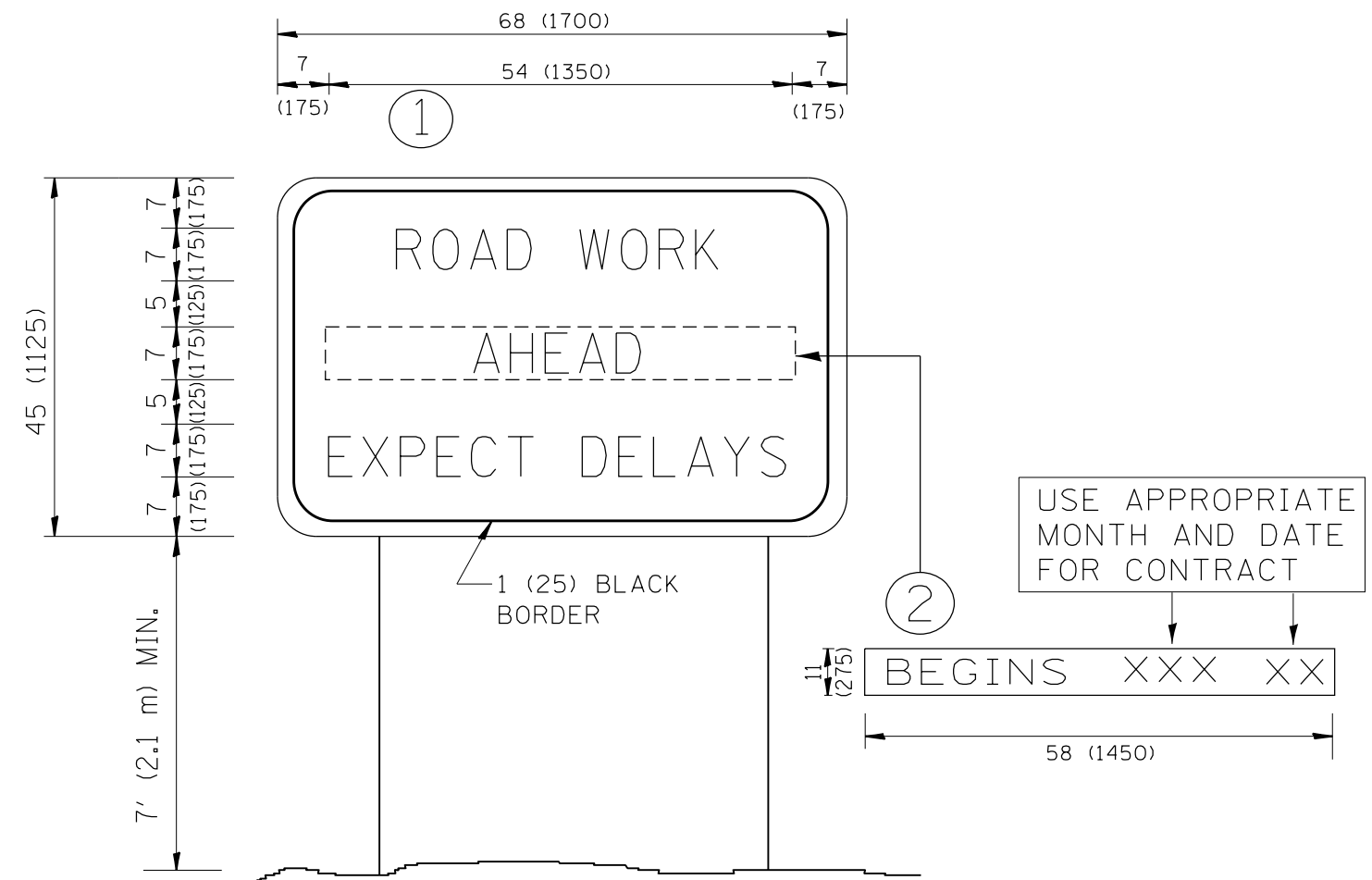
All dimensions are in inches (millimeters) unless otherwise shown.

FILE NAME =	USER NAME = nafakha	DESIGNED -	REVISED -T. RAMMACHER 03-02-98
p:\11\084EBIDINTEG\illinois.gov\PIWIDOT\Documents\DOT Offices\District 1\Projects\DI1121\DRAMA\Design\MOTIF		CHECKED -	REVISED -E. GOMEZ 08-28-00
		DATE - 09-18-94	REVISED -E. GOMEZ 08-28-00
			REVISED -A. SCHUETZE 09-15-16

**STATE OF ILLINOIS  
 DEPARTMENT OF TRANSPORTATION**

<b>SHORT TERM PAVEMENT MARKING LETTERS AND SYMBOLS</b>			
SCALE: NONE	SHEET NO. 1 OF 1 SHEETS	STA.	TO STA.

F.A.P. RTE.	SECTION	COUNTY	TOTAL SHEETS	SHEET NO.
335	2018-0146-1	MCHENRY	24	23
<b>TC-16</b>		<b>CONTRACT NO. 62H76</b>		
FED. ROAD DIST. NO. 1 ILLINOIS FED. AID PROJECT				



**NOTES:**

1. USE BLACK LETTERING ON ORANGE BACKGROUND.
2. ERECT SIGNS IN ADVANCE OF THE LOCATION FOR THE "ROAD CONSTRUCTION AHEAD" SIGN AT LOCATIONS AS DIRECTED BY THE ENGINEER.
3. ERECT SIGN ① WITH INSTALLED PANEL ② ONE WEEK PRIOR TO THE START OF CONSTRUCTION.
4. REMOVE PANEL ② SOON AFTER THE START OF CONSTRUCTION.
5. SEE SPECIAL PROVISION FOR "TEMPORARY INFORMATION SIGNING" FOR ADDITIONAL INFORMATION.
6. ONE SIGN ASSEMBLY EQUALS 25.70 SQ. FT. (2.3 SQ. M.)
7. SHALL BE PAID FOR AS TEMPORARY INFORMATION SIGNING.

ALL DIMENSIONS ARE IN INCHES (MILLIMETERS) UNLESS OTHERWISE SHOWN.

FILE NAME =	USER NAME = nafakhaj	DESIGNED -	REVISED - R. MIRS 09-15-97
p:\11\084EBIDINTEG.illinois.gov\PIWIDOT\Documents\DOT Offices\District 1\Projects\DI1121\DRAMA\Design\MOTIF		CHECKED -	REVISED - R. MIRS 12-11-97
		DATE -	REVISED - T. RAMMACHER 02-02-99
			REVISED - C. JUCIUS 01-31-07

**STATE OF ILLINOIS  
DEPARTMENT OF TRANSPORTATION**

**ARTERIAL ROAD  
INFORMATION SIGN**

SCALE: NONE SHEET NO. 1 OF 1 SHEETS STA. TO STA.

F.A.P. RTE.	SECTION	COUNTY	TOTAL SHEETS	SHEET NO.
335	2018-0146-1	MCHENRY	24	24
TC-22		CONTRACT NO. 62H76		
FED. ROAD DIST. NO. 1 ILLINOIS FED. AID PROJECT				