

Prop. Curve NBFDR1
P.I. STA = 2029+29.73
N = 1,838,902.75
E = 1,177,946.02
Δ = 90° 04' 24.06" (RT)
D = 3° 00' 56.04"
R = 1,900.00
L = 2,986.95
E = 788.73
T = 1,902.43
P.C. STA = 2010+27.29
N = 1,838,959.64
E = 1,179,847.60
P.T. STA = 2040+14.24
N = 1,840,804.40
E = 1,177,891.56

Prop. Curve SB9401
P.I. STA = 1160+15.97
N = 1,838,783.95
E = 1,177,299.83
Δ = 100° 48' 58.07" (RT)
D = 2° 59' 59.20"
R = 1,910.00
L = 3,360.79
E = 1,086.95
T = 2,309.46
P.C. STA = 1137+06.52
N = 1,838,851.99
E = 1,179,608.28
P.T. STA = 1170+67.30
N = 1,841,064.16
E = 1,177,666.20

Prop. Curve SB5700
P.I. STA = 133+70.06
N = 1,839,521.70
E = 1,177,054.03
Δ = 66° 11' 55.15" (LT)
D = 3° 02' 10.83"
R = 1,887.00
L = 2,180.21
E = 365.53
T = 1,230.09
P.C. STA = 121+39.97
N = 1,839,491.52
E = 1,175,824.31
P.T. STA = 143+20.18
N = 1,840,659.02
E = 1,177,522.68

Prop. Curve SB5701
P.I. STA = 149+37.75
N = 1,841,230.00
E = 1,177,757.97
Δ = 24° 02' 07.49" (LT)
D = 1° 58' 30.13"
R = 2,901.00
L = 1,216.96
E = 65.01
T = 617.56
P.C. STA = 143+20.18
N = 1,840,659.02
E = 1,177,522.68
P.T. STA = 155+37.15
N = 1,841,847.31
E = 1,177,740.29

Prop. Curve NB5705
P.I. STA = 249+87.51
N = 1,840,788.31
E = 1,177,892.02
Δ = 34° 03' 37.98" (LT)
D = 2° 55' 02.28"
R = 1,964.00
L = 1,167.54
E = 90.07
T = 601.59
P.C. STA = 243+85.92
N = 1,840,280.48
E = 1,177,569.49
P.T. STA = 255+53.46
N = 1,841,389.65
E = 1,177,874.80

SB I-94 (DAN RYAN EXPWY)
POT STA = 1205+00.00
N = 1,841,884.04
E = 1,177,763.25

MATCHLINE STA. 1237+00 SB DAN RYAN

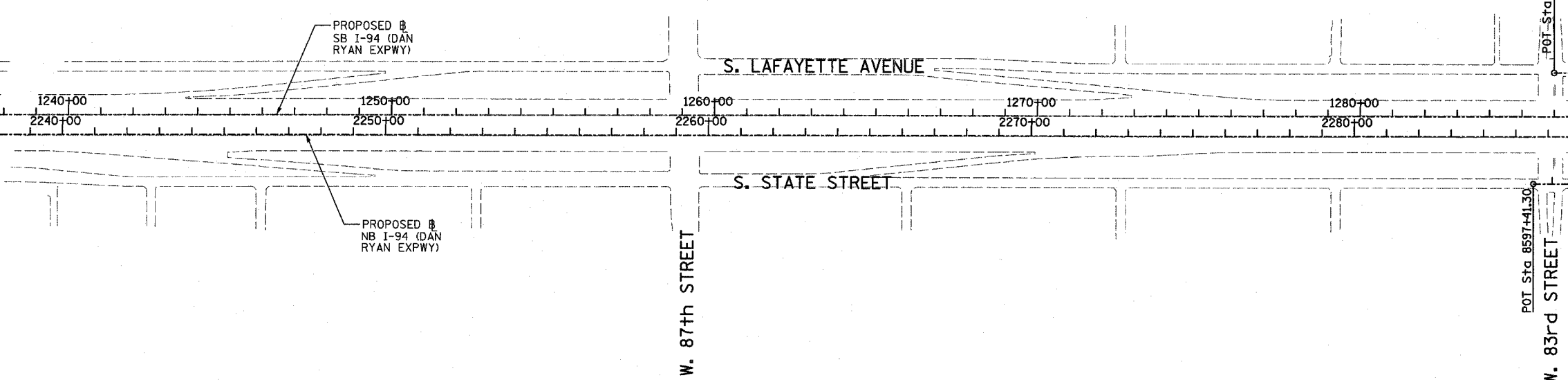

MATCHLINE STA. 1287+00 SB DAN RYAN
SEE SHEET 3 OF 3

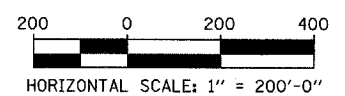

TYLIN INTERNATIONAL

REVISIONS	
NAME	DATE

ILLINOIS DEPARTMENT OF TRANSPORTATION
F.A.I. 94 (DAN RYAN EXPRESSWAY)
I-57 to 71st STREET

ALIGNMENT
SHEET 2 OF 3

SCALE: 1"=200'
DATE: JANUARY 9, 2007
DRAWN BY: JPM
CHECKED BY: DAK