

PROFILE SURVEYED BY DATE
 GRADES CHECKED BY
 ELEVATIONS NOTED BY
 STRUCTURE NOTATIONS CHECKED BY

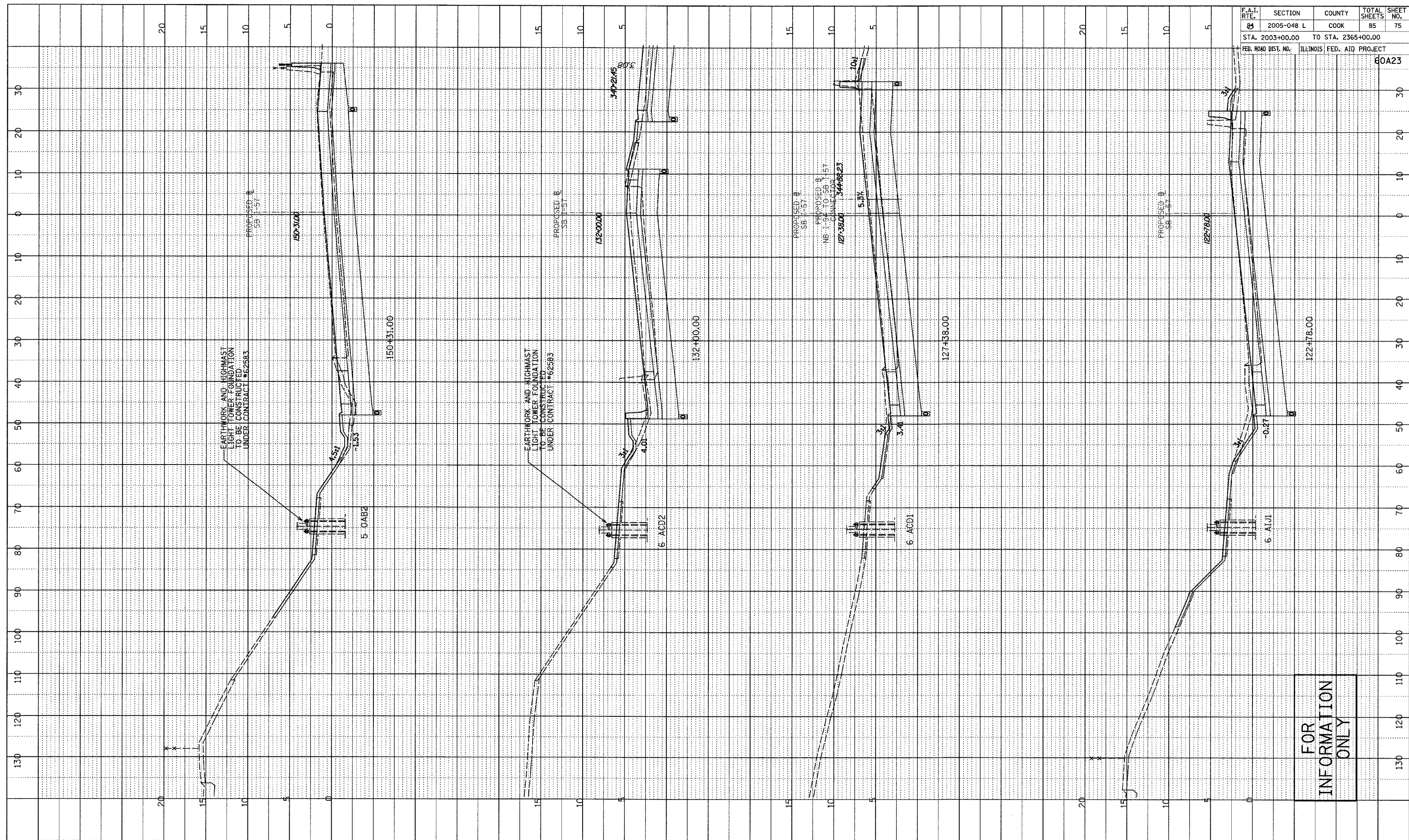

F.A.I. RTE.	SECTION	COUNTY	TOTAL SHEETS	SHEET NO.
8	2005-048 L	COOK	85	75
STA. 2003+00.00		TO STA. 2365+00.00		
FED. ROAD DIST. NO.		ILLINOIS FED. AID PROJECT		60A23

FOR INFORMATION ONLY

TYLIN INTERNATIONAL

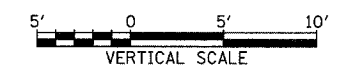
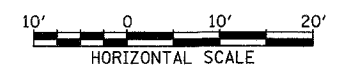

SOUTHBOUND I-57
STA. 122+78 TO STA. 150+31

D:\0231\road\400\gpr\40\div\ss\607.dwg