

PROFILE	DESIGNED	DATE
NOTE BOOK	PLOTTED	BY
NO.	GRADES CHECKED	
	STRUCTURE NOTATIONS CHKD	

F.A.I. RTE.	SECTION	COUNTY	TOTAL SHEETS	SHEET NO.
94	2005-048 L	COOK	85	82
STA. 2003+00.00		TO STA. 2365+00.00		
FED. ROAD DIST. NO.		ILLINOIS FED. AID PROJECT		

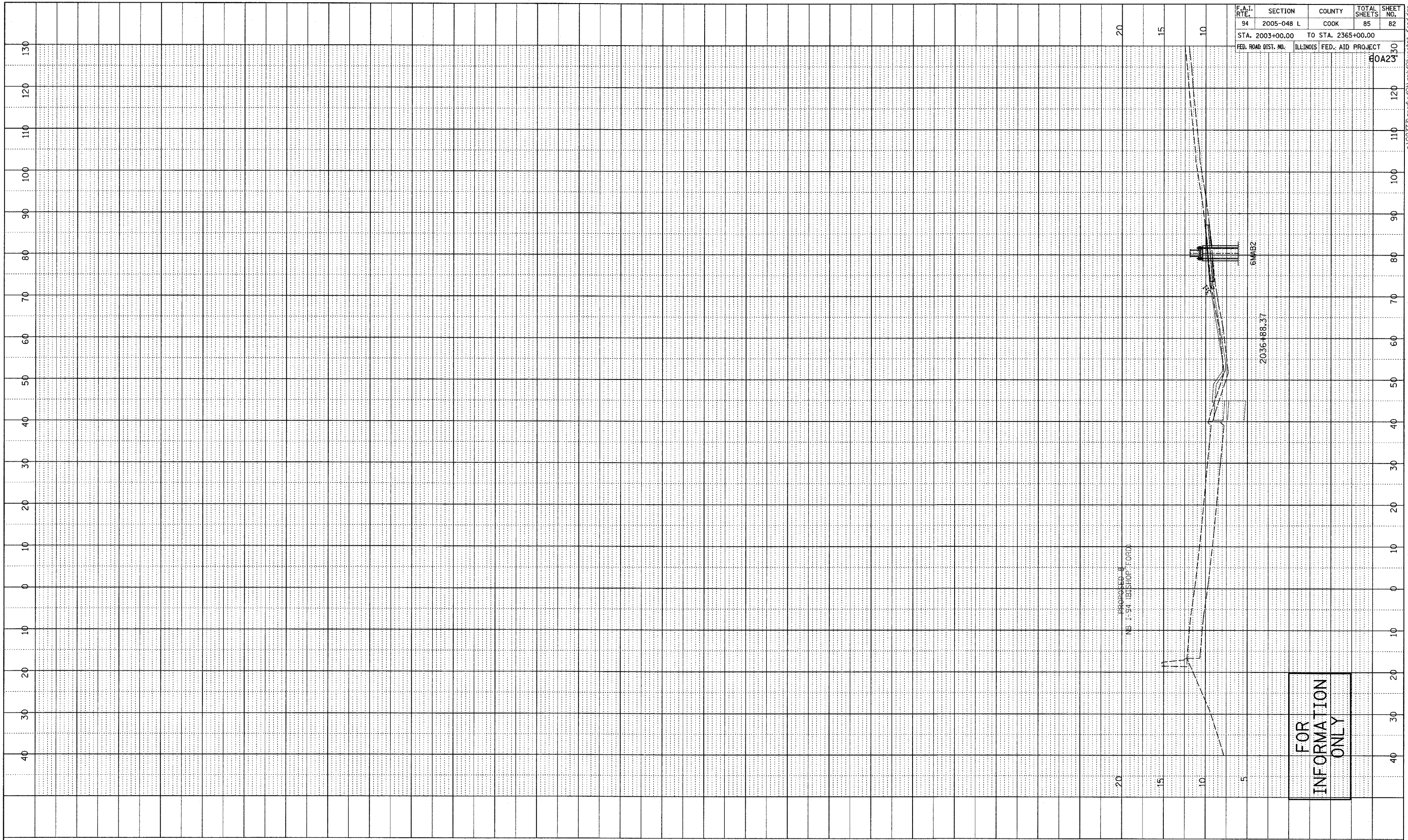

TYLIN INTERNATIONAL

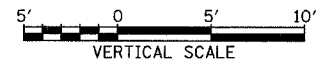

NORTHBOUND I-94 (BISHOP FORD FWY)
STA. 2036+88

FOR
INFORMATION
ONLY

I:\0273\road\408\gpk\08\sheet82.dgn